



**東 北 大 学**

TOHOKU UNIVERSITY

March 31, 2026

**October 2025 Admission  
FGL Program Undergraduate Courses  
General Education Guidebook**



<https://www.insc.tohoku.ac.jp/english/fgl-current-students/>  
(FGL website for Current Students)

April 2026  
Tohoku University

# Table of Contents

	Page
● Academic Calendar of 2025 General Education Program.....	3
● Class Schedule of General Education Subjects.....	4
<b>I General Education</b> .....	5
1. Tohoku University's Admission/Diploma/Curriculum Policies for the Undergraduate Program	
2. Goals and Mission of General Education	
3. Terms & Semesters	
4. Classes & Credits	
5. General Education System	
<b>II Registering for General Education Subjects</b> .....	7
1. Registration Schedule	
2. Registration Group	
3. Method of conducting classes (Online class system)	
4. Registration Procedures	
5. Notes on Registration and Checking Grades	
6. Taking multiple courses	
7. Using Student-owned Computers for Educational Activities	
8. Campus Wi-Fi	
9. Enrolling for Japanese Language	
<b>III Examinations, Grading and Reports</b> .....	11
1. Exam Schedule, Methods	
2. Notes on Examinations	
3. Makeup Examinations	
4. Grading	
5. GPA (Grade Point Average) System	
<b>IV Introduction to Class Contents</b> .....	13
1. Course Numbering Code	
2. Searching Syllabus Online	
● The Student Affairs Information System	
● QuickSyllabus	
<b>V General Education Class Information (FGL Program)</b> .....	19
1. List of Subjects	
2. Timetable	
<b>VI Other</b> .....	25
1. Medical Care Required due to Accidents in Class	
2. Using Educational Facilities	
3. Counseling Services	
4. Preventing Theft	
● Regulations on Tohoku University General Education Subjects.....	26
● Kawauchi Campus Map.....	31
1) Campus Map [Kawauchi], 2) Classroom, 3) Student Laboratories, 4) Multimedia Education and Research Complex, 5) Gymnasium, 6) Sub Arena, 7) Education and Student Support Center, Student Service, 8) International Exchange Building	

## Academic Calendar of 2026 General Education Program

### Spring Semester

Orientation for the 3rd semester (Specialized subjects for each department)	<p>【AMC】 April 3 (Fri.) 10:00-12:00 Katahira Campus South Multidisciplinary Research Laboratory 2, 4th floor, Seminar Room</p> <p>【IMAC-U】 April 2 (Thu) 13:30-16:45 Examination at Kawauchi Campus April 3 (Fri.) 10:00-11:00 Orientation at Aobayama Campus</p> <p>【AMB】 There will be no course orientation.</p>
Classes in 3 <sup>rd</sup> Semester	<p>April 8 (Wed.) – August 5 (Wed.), 2026</p> <p>&lt;1Q&gt;April 8 (Wed.) – June 5 (Fri.), 2026</p> <p>&lt;2Q&gt;June 8 (Mon.) – August 5 (Wed.), 2026</p>
Class Registration by website	April 8 (Wed.) – April 21 (Tue.), 2026
Drop / Withdrawal for Class Registration	April 22 (Wed.) – May 8 (Fri), 2026
Semester-end Vacation	August 6 (Thu.) – September 30 (Wed.), 2026

### Fall Semester

Classes in 4 <sup>th</sup> Semester	<p>October 1 (Thu.) – February 3 (Wed.), 2027</p> <p>&lt;3Q&gt;October 1 (Thu.) – December 1 (Tue.), 2026</p> <p>&lt;4Q&gt;November 30 (Mon.) – February 3 (Wed.), 2027</p>
Class Registration by website	October 1 (Thu.) – October 14 (Wed.), 2026
Drop / Withdrawal for Class Registration	October 15 (Thu.) – October 30 (Fri.), 2026
Classes canceled for University Festival	October 23 (Fri.), 2026
Winter Break	December 28 (Mon.), 2026 – January 1 (Fri.), 2027
Classes Canceled for Common Test for University Admissions	January 15 (Fri.), 2027
Semester-end Vacation	February 4 (Thu), 2027 – late March

### Class Timetable

Period	Class start/finish	Comments
1st Period	8:50 - 10:20	A chime will sound when classes start/finish.
2nd Period	10:30 - 12:00	
3rd Period	13:00 - 14:30	
4th Period	14:40 - 16:10	
5th Period	16:20 - 17:50	

# Class Schedule of AY2026 General Education Subjects

(from April, 2026 to March, 2027)

	8+8	8+8	8+8	8+8	8+8		
2026  Apr.	Sun	Mon	Tue	Wed	Thu	Fri	Sat
	...	...	...	1	2	3	4
	5	6	7	8	9	10	11
	12	13	14	15	16	17	18
	19	20	21	22	23	24	25
	26	27	28	29	30	...	...
	...	...	...	...	...	...	...
May.	Sun	Mon	Tue	Wed	Thu	Fri	Sat
	...	...	...	...	...	1	2
	3	4	5	6	7	8	9
	10	11	12	13	14	15	16
	17	18	19	20	21	22	23
	24	25	26	27	28	29	30
	31	...	...	...	...	...	...
Jun.	Sun	Mon	Tue	Wed	Thu	Fri	Sat
	...	1	2	3	4	5	6
	7	8	9	10	11	12	13
	14	15	16	17	18	19	20
	21	22	23	24	25	26	27
	28	29	30	...	...	...	...
	...	...	...	...	...	...	...
Jul.	Sun	Mon	Tue	Wed	Thu	Fri	Sat
	...	...	...	1	2	3	4
	5	6	7	8	9	10	11
	12	13	14	15	16	17	18
	19	20	21	22	23	24	25
	26	27	28	29	30	31	...
	...	...	...	...	...	...	...
Aug.	Sun	Mon	Tue	Wed	Thu	Fri	Sat
	...	...	...	...	...	...	1
	2	3	4	5	6	7	8
	9	10	11	12	13	14	15
	16	17	18	19	20	21	22
	23	24	25	26	27	28	29
	30	31	...	...	...	...	...
Sep.	Sun	Mon	Tue	Wed	Thu	Fri	Sat
	...	...	1	2	3	4	5
	6	7	8	9	10	11	12
	13	14	15	16	17	18	19
	20	21	22	23	24	25	26
	27	28	29	30	...	...	...
	...	...	...	...	...	...	...
Oct.	Sun	Mon	Tue	Wed	Thu	Fri	Sat
	...	...	...	...	1	2	3
	4	5	6	7	8	9	10
	11	12	13	14	15	16	17
	18	19	20	21	22	23	24
	25	26	27	28	29	30	31
	...	...	...	...	...	...	...
Nov.	Sun	Mon	Tue	Wed	Thu	Fri	Sat
	1	2	3	4	5	6	7
	8	9	10	11	12	13	14
	15	16	17	18	19	20	21
	22	23	24	25	26	27	28
	29	30	...	...	...	...	...
	...	...	...	...	...	...	...
Dec.	Sun	Mon	Tue	Wed	Thu	Fri	Sat
	...	...	1	2	3	4	5
	6	7	8	9	10	11	12
	13	14	15	16	17	18	19
	20	21	22	23	24	25	26
	27	28	29	30	31	...	...
	...	...	...	...	...	...	...
2027  Jan.	Sun	Mon	Tue	Wed	Thu	Fri	Sat
	...	...	...	...	...	1	2
	3	4	5	6	7	8	9
	10	11	12	13	14	15	16
	17	18	19	20	21	22	23
	24	25	26	27	28	29	30
	31	...	...	...	...	...	...
Feb.	Sun	Mon	Tue	Wed	Thu	Fri	Sat
	...	1	2	3	4	5	6
	7	8	9	10	11	12	13
	14	15	16	17	18	19	20
	21	22	23	24	25	26	27
	28	...	...	...	...	...	...
	...	...	...	...	...	...	...
Mar.	Sun	Mon	Tue	Wed	Thu	Fri	Sat
	...	1	2	3	4	5	6
	7	8	9	10	11	12	13
	14	15	16	17	18	19	20
	21	22	23	24	25	26	27
	28	29	30	31	...	...	...
	...	...	...	...	...	...	...

Normal Classes    No classes (holidays, etc.)    Indicates end of quarter

- : Makeup class for Monday will be held on May 7 and November 26.  
Makeup class for Tuesday will be held on May 8.  
Makeup class for Thursday will be held on August 4.  
Makeup class for Friday will be held on February 3.
- ◇: Class will be held on April 29 (Wed.) and October 12 (Mon.) although it is a national holiday.

note: Class will be held on June 22 (Mon.) although it is the Anniversary of the University Founding.

note: Class will be canceled:

- From July 29 (Wed.) to July 30 (Thu.) for the Campus Visit Days.
- On October 23 (Fri.) for the University Festival.
- On January 15 (Fri.) for the Common Test for University Admissions.

# I General Education

## 1. Tohoku University's Admission/Diploma/Curriculum Policies for the Undergraduate Program

### ○Admission Policy

Tohoku University seeks students who sympathize with the university's mission, and who possess either/both of the following:

- (1) The desire to significantly contribute as researchers by seriously addressing the issues facing 21st century human society or
- (2) The desire to significantly contribute to the development of society as high-level professionals with abundant knowledge and leadership, and the strength of will, bold academic curiosity, and fundamentally excellent academic abilities to realize this desire.

### ○Diploma Policy

Tohoku University confers the bachelor's degree on students who achieve the following goals.

- (1) Obtain knowledge in their specialized fields and a multifaceted perspective based on an interest in and broad knowledge of academia in general.
- (2) Obtain the education necessary to become accomplished adults, and be able to contribute to society using expertise specific to their fields of specialization.
- (3) Have the awareness and vision to assume leadership/core roles in the global community while developing fundamental abilities.

### ○Curriculum Policy

Tohoku University structures and implements its educational curriculum as follows to ensure that students meet the goals described in the Diploma Policy.

- (1) Offer a curriculum that creates organic links between General Education Subjects to foster broad knowledge and education, and Specialized Subjects to confer basic knowledge of specialized fields.
- (2) Following the principle of "Research First," promote the development of educational methods and establishment of educational systems while implementing active learning both in and out of class.
- (3) Develop the students' ability to learn independently by evaluating learning achievements and applying the results.

## 2. Goals and Mission of General Education

The goals of this university's General Education program are to foster students who possess specialized knowledge that they can use in practical society and advanced research, comprehensive, modern knowledge and deep compassion, and an international perspective. It will fulfill basic educational requirements, providing the foundations for specialized and/or graduate education, and confer the below fundamental basic abilities, knowledge, and expertise:

- 1) Basic knowledge and expertise needed for modern, international citizens to lead a social life
- 2) Basic accomplishments and skills that will provide core character-building for the modern world
- 3) Knowledge and skills related to a wide range of academic fields to aid understanding in specialized majors
- 4) Basic knowledge and skills required to study more specialized areas

To fulfill its mission, General Education has a curriculum comprising four subject categories: Foundations, Advanced Subjects, Languages, and Basics of Discipline. Each category is made up of classes arranged in subject groups, which are implemented to achieve the goals below.

Foundations	<ul style="list-style-type: none"> <li>▪ These subjects are comprised of Navigating Academia, Humanities, Social Sciences, Natural Sciences, and Transdisciplinary Subjects.</li> <li>▪ In the Navigating Academia, the basic attitude of those involved in academic research is developed through understanding of how academic research should be conducted. In the Humanities, Social Sciences, and Natural Sciences, humanities students focus on science courses, while science students focus on humanities courses, thereby creating students who are knowledgeable in both the sciences and the humanities. In the Transdisciplinary Subjects, students will not be confined to their own specialized fields, but will be exposed to a variety of fields, and will develop a foundation for the ability to solve problems through collaboration with people from various fields.</li> </ul>
Advanced Subjects	<ul style="list-style-type: none"> <li>▪ This group is composed of subjects dealing with Contemporary Competencies, and Cutting Edge Subjects.</li> <li>▪ Contemporary Competencies provide the knowledge/skills required of educated persons in the modern context, and foster the habit of taking ownership over problems</li> </ul>

	that require global effort to solve. Cutting Edge Subjects stimulate awareness of what it means to study at a comprehensive research university and motivate academic research by providing contact with cutting edge scholarship, regardless of field.
Languages	<ul style="list-style-type: none"> <li>• This category is composed of the Foreign Languages and Japanese groups.</li> <li>• It fosters language abilities and intercultural understanding necessary for modern/international/educated persons. It also aims to provide the English skills necessary for academic objectives, basic multilingual competence in the students' first and second foreign languages, and basic Japanese competence for international students.</li> </ul>
Basics of Discipline	<ul style="list-style-type: none"> <li>• This category is composed of the Basic Humanities, Basic Social Sciences, Basic Mathematics, Basic Physics, Basic Chemistry, Basic Biology, and Basic Earth and Space Science groups.</li> <li>• It is connected to the major fields of the undergraduate departments, and provides basic knowledge/skills needed for the relevant major.</li> </ul>

### 3. Terms & Semesters

Tohoku University uses a two-semester system, with the period of April 1 to September 30 defined as first semester, and October 1 to March 31 as second semester. The semester comprises the basic unit of the education curriculum; General Education lasts from the 2nd to 4th semesters. [FGL Students will begin classes from the 2nd Semester.](#)

1st Year	2nd Year				3rd & 4th Year
Fall	Spring		Fall		5th – 8 <sup>th</sup> /9 <sup>th</sup> Semester
2nd Semester	3rd Semester		4th Semester		
	1st Quarter	2nd Quarter	3rd Quarter	4th Quarter	

### 4. Classes & Credits

Each class is held 15 times (weeks) per semester, and consists of lectures, seminars, experiments, laboratory work, skill tests, or some combination of these. Some classes may be implemented in intensive lectures. The number of credits reflects the amount of academic work performed, with one credit requiring 45 hours of study. General Education subjects confer two credits in consideration of the methods used in class, educational effect, and amount of study required outside of class, as indicated below.

Class Format	Hours of Class	Content of Study
Lectures	30 hrs.	Students take 15 ninety-minute classes, a course of four-hour lectures, a 2-4 hour seminar, experiments, laboratory work, and skill tests, requiring 2 hours per class of preparation/review.
Seminars	30 - 60 hrs.	
Experiments, Laboratory Work, Skill Tests	60 - 90 hrs.	

General Education also uses different class format such as below.

- **Intercultural Collaborative Learning:** This is a learning activity and educational method in which learners from diverse linguistic and cultural backgrounds learn from each other through group work and projects. Learners are aware that there are different ways of thinking and approaches to things, and they have the opportunity to deepen their self-understanding by comparing themselves with others, which ultimately leads to the creation of new values. From this series of processes, students can not only improve their communication skills, but also grow internally by broadening their perspectives, acquiring critical thinking skills, and increasing their sense of self-efficacy. International co-curricular activities are a versatile educational method that can be applied to any field of study.

### 5. General Education System

General Education is for all students at the university. The Academic Affairs Council, which is composed of educators from every department, is responsible for planning and operating its subject categories and groups and performs overall coordination and supervision. The Institute for Excellence in Higher Education (IEHE) also provides support for its university-wide system. The IEHE was founded in April 2014 by merging five

independent educational organizations at Tohoku University in order to implement advanced liberal arts education and provide a higher level of student support. Instructors from each department of the faculties, graduate schools, research institutes/centers, and the university hospital are responsible for General Education classes, and take part in a supportive, cooperative university-wide class-management system to provide students an educational foundation with a broad perspective.

## II Registering for General Education Subjects

### 1. Registration Schedule

Students must register for classes in compliance with rules on required subjects (subjects which students must take), recommended subjects (classes that students are urged to take) and registration prerequisites (in cases where students cannot register for one class unless they have already completed another class) as per the student handbook for their faculty, and orientation.

**The number** of General Education subjects that are taught in English and open to Future Global Leadership Undergraduate Courses students is limited, so FGL students should register as per the Class Timetable for the FGL Courses.

#### Notes on General Education subjects Registration

- Classes that are not designated by your faculty's Student Guide will not be credited towards graduation requirements.
  - Please register for classes in the appropriate semester, as listed in your faculty's Student Guide. You cannot register for a class before the appropriate semester (advanced registration) as designated by the faculty (department/division).
  - Students cannot register for two subjects with the same subject name, even if the topics, instructors, semester, and day/time of the two subjects are different. The same applies to taking a subject with the same name as one for which the student has already received credit.
- Excluding courses subject to the multiple enrollment system. ( Please refer to “6. Taking multiple courses”.)

### 2. Registration Group

As class schedules are drawn up with consideration for class sizes in each faculty/year/division, in general you must register within groups created for your own faculty (own division). In principle, you cannot register for classes in groups other than those created for your own faculty (i.e. in other divisions).

Even in classes held for your own faculty, groups are sometimes further subdivided by Student ID Number.

For classes outside your division, it is possible that you will not be given permission to register due to the class content or class size.

### 3. Method of conducting classes (Online class system)

The classes will be conducted mainly in face-to-face classes held on campus, with an effective combination of online classes according to the content and characteristics of each class. Please refer to the FGL website to see if online classes are scheduled.

**FGL Website:** <https://www.insc.tohoku.ac.jp/english/fgl-current-students/>

#### ① Canvas LMS (Canvas Learning Management System, hereinafter Canvas LMS)

Canvas LMS allows you to view course materials, watch videos, participate in discussions, submit reports, and more online. You access Canvas LMS using your student email account (DC Mail) [account name: [string based on your name]@dc.tohoku.ac.jp]. For instructions on using Canvas LMS, please refer to the Information Services for Education Online Guide.

URL: <https://www.dc.tohoku.ac.jp>



#### ② Google Classroom

Google Classroom is an online class system provided by Google, Inc. To view videos and materials for classes using Google Classroom, each student must add his/her own classes within Google Classroom using a "Class Code" for Google Classroom. (Note: "Class codes" are not "course numbering" or "lecture codes" on the syllabus.) The class codes for Google Classroom are listed on the FGL website during the class registration period.

#### ③ Google Meet

Google Meet is a videoconferencing system that runs in a web browser and can be used with a DC Mail account.

#### ④ Microsoft Teams

This is a system that allows you to conduct video conferences using the Teams application or a web browser. Use the Microsoft 365 ID assigned to each student. Please see the guide below for details.

URL: <https://www.cds.tohoku.ac.jp/en/>

For other information, please check the Tohoku University Online Class Guide.

URL: <https://olg.cds.tohoku.ac.jp/home>

#### 4. Registration Procedures

To register for classes (and receive credits), it is necessary to complete the registration procedures on the Student Affairs Information System, which is called “UNIPA”.

**If you do not undergo Web-based registration, you will not receive credit for classes even if you attend the lectures and take the exams.**

The registration procedures are Web-based. In general, the classes you enter cannot be changed except during the Web-based registration confirmation/revision period. During this period, please check your registration details online, and make any necessary changes at the Student Affairs Division.

Web-based registration is performed separately for each semester. You can also check your grades and credits online.

You should inquire at the faculty office when registering for classes outside your division.

For classes for which you have registered, please check the syllabus and prepare for the online class system (Canvas LMS or Google Classroom) you plan to use.

#### 5. Notes on Registration and Checking Grades

##### (1) Web-based registration, confirmation/revision period

Spring Semester: April 8 (Wed.) – April 21 (Tue.)

Fall semester: October 1 (Thu.) – October 14 (Wed.)

- ① Course registration will be conducted via the Student Affairs Information System “UNIPA” website during the above period per semester. Access the portal site at the following URL and click on “Academic Affairs Information System” under the “System” tab.

**Student Affairs Information System: <https://slink.secioss.com/user/index.php?tenant=auth.tohoku.ac.jp>**

\*The Operation Manual is available from the following website.

<https://rp.auth.tohoku.ac.jp/gkms/manual/index.html>

\*It requires a Tohoku University ID and password to perform Web-based registration.

\*The server will receive heavy access on the final day of registration, so try to finish registering your classes before then.



\*Remember that “Google Classroom” is not official class registration. Please be sure to register both. So does canceling classes.

- ② Select the classes you wish to take on the course registration screen of the “UNIPA” Student Affairs Information System, and click the “Final Confirmation” button. After confirming that there are no course registration errors, be sure to click the “Submit” button. Please note that registration is not completed only by selecting classes.

\*If there is an error in your course registration, the error will be indicated in red in the check result column.

In this case, please correct the registration details, click the “Final Confirmation” button again, and confirm that there are no errors before clicking the “Submit” button.

- ③ Please register once during the first week of the registration period in order for the instructors to know the number of registered students.

\*Once you have registered for classes, you can change your registration as many times as you like during the course registration period. Please note that registration may be closed earlier at the instructors' judgment. If an instructor provides instructions on the syllabus or learning support systems such as Google Classroom, please follow it by completing course registration by the designated date, regardless of the deadline for web registration.

- ④ After the deadline, it is unable to change registration. Please confirm your registration carefully in advance.

- ⑤ If you have added classes to Google Classroom during the online registration period but did not register for them in the end, or if they were not approved due to course registration adjustments, please cancel your Google Classroom registration on your own. Also, please do not add classes to Google Classroom for which you have not registered. (This may cause confusion, such as differences between the actual number of students and the number of students registered in Google Classroom.)

#### 【Attention】

##### **Contact Information for Instructors in charge of classes (全学教育科目授業担当教員連絡先一覧)**

A Tohoku University ID is required to use this service. Please note that this list is available in Japanese only.

Contact information for Faculty Members in Charge of General Education Courses can be found on the “List of Contact Information for Faculty Members in Charge of General Education Courses” posted on the General Education website. Search for contact information by “Class code” and “Class subject”.

Faculty members' contact information is not available on the Student Affairs Information System (UNIPA) or the Tohoku University Syllabus Search System (Quick Syllabus).

If you have any questions, please contact the Educational Affairs Section. Be sure not to visit a faculty member's laboratory without prior notice.



## (2) Procedures for deregistering classes

Spring Semester: April 22 (Wed.) – May 8 (Fri.)

Fall semester: October 15 (Thu.) – October 30 (Fri.)

- ① If you wish to "deregister" a class for which you have finalized registration, you must ask the course instructor to get approval by email and submit class cancellation form during the designated period above.  
Use DC Mail account when you send an e-mail to the instructor as your identification.  
\*Class cancellation form will be informed by Academic Affairs Division in advance.
- ② **If you perform the required procedures, you will not be graded for that class, and your grades will show an "E" (deregistered) instead.**
- ③ **By registering for a class, you commit to taking that class and being graded on it. If you abandon a class before completing it, you will receive a D grade (Fail).**

## (3) Confirming grades

Spring Semester: will be announced on August 20 (Thu.)

Fall semester: will be announced on February 16 (Tue.)

- ① Please confirm your grades online using the "Assessment Inquiry" screen via Student Affairs Information System "UNIPA".
- ② For details on grading, please see "III Examinations, Grading and Reports."

## 6. Taking multiple courses

In General Education, students may take courses with the same title in the same semester by applying in advance for each course. It is also possible to repeat courses that have already been completed.

However, even if you take more than one course, only one of them will count toward graduation requirements, and the other courses are auditing courses.

Courses that can be taken more than once are those with different course titles (syllabus contents) as listed below.

- Courses in the Humanities and Social Sciences of the Foundation Subjects
- Sports A in the Health and Sports of the Transdisciplinary Subjects of the Foundation Subjects
- International Education of the Contemporary Competencies subjects of the Advanced subjects

Please note that if you wish to take multiple courses in the same semester, you must decide in advance which of them will count toward your graduation requirements before registering.

Registration for graduation requirement courses must be done online within the registration period. For auditing courses, applications will be accepted by e-mail to the Educational Affairs Division. For more information, please contact the Educational Affairs Division and see "(7) Education and Student Support Center, Student Services [A01]" for their location and window number.

## 7. Using Student-owned Computers for Educational Activities

At Tohoku University, PCs are used for daily learning activities such as class registration procedures, checking grades, viewing class plans/syllabuses, distributing lecture materials, writing and submitting assignment reports, and other communications.

Students are required to bring their laptop computers when instructed by the instructor during face-to-face classes. Please check the General Education class syllabi to see whether your classes require a computer.

## 8. Campus Wi-Fi

All campuses have Wi-Fi access points in key locations for wireless Internet service (eduroam). The laptop computer to be brought to the face-to-face classes must be set up for eduroam in advance.

For connection instructions and other details, please refer to "Online Guide: Information Services for Education in Tohoku University" (<https://www.dc.tohoku.ac.jp/guide/wifi/wifi.html>).



## 9. Enrolling for Japanese Language

Students on the FGL Courses are required to take 10 credits of Japanese language. Students who have taken the "Japanese Language Proficiency Test" or the "Examination for Japanese University Admission for International Students" and met certain conditions, specified elsewhere, may apply to have their test results recognized in place of coursework, and receive up to seven of the required 10 Japanese language credits.

International students at this university who have obtained a designated number of points on Japanese language tests etc. shall be considered to have completed a Japanese language class, and shall be awarded a predetermined number of credits upon application.

1. As per Articles 26-6 and 26-7 of the Tohoku University Faculty Regulations, and as elsewhere stipulated by the Minister of Education, Culture, Sports, Science and Technology, students who have obtained the specified number of points on the Japanese language tests etc., and students for whom it is recognized to be educationally beneficial by their faculty, shall be considered by this University to have completed a Japanese language class, and shall be awarded credits, as stipulated by the rules of their faculty.
2. Faculties that may approve these credits are as follows.  
Faculty of Science, School of Engineering, Faculty of Agriculture (students belonging to Future Global Leadership Undergraduate Courses)
3. Languages subjects for which these credits can be awarded are as follows.  
Japanese
4. Subjects for which credits can be awarded, Japanese language tests, criterion for recognition, and number of credits are as follows.  
Recognized subjects: Basic Japanese I, Basic Japanese II and Intermediate Japanese are certified in that order. The maximum number of approved credits is 7.  
Name of Test:
  - i) Japanese Language Proficiency Test—JLPT (Japan Educational Exchanges and Services)
  - ii) Examination for Japanese University Admission for International Students—EJU (Japan Student Services Organization)

Criterion and Number of Credits:

Criterion	Number of Credits	Score	Subject
JLPT N3 or higher	7	AA	Basic Japanese I(4 Credits)
		AA	Basic Japanese II(3 credits)
		AA	Intermediate Japanese(3 credits)
JLPT N4	7	AA	Basic Japanese I(4 Credits)
		AA	Basic Japanese II(3 credits)
JLPT N5	4	AA	Basic Japanese I(4 Credits)
EJU 220 points or higher (Not including Writing)	7	AA	Basic Japanese I(4 Credits)
		AA	Basic Japanese II(3 credits)
		AA	Intermediate Japanese(3 credits)
EJU 200 points or higher (Not including Writing)	7	AA	Basic Japanese I(4 Credits)
		AA	Basic Japanese II(3 credits)

5. Application Instructions
  - i) Documents required for the application are the application form and a copy of the test certificate or score sheet.
  - ii) The date entered on the test certificate or score sheet must be less than two years prior to the date of application.
6. Certification Procedure
  - i) Certification of credits will be performed by the Japanese Language Committee of the Academic Affairs Council (hereafter, Japanese Language Committee) based on a copy of the test certificate or score sheet.
  - ii) Results of screenings by the Japanese Language Committee will be reported to the Educational Records and Programs Committee of the Academic Affairs Council.
  - iii) Credits for applications submitted before the end of January or the end of June will be certified the same semester; credits for applications submitted after February 1 or July 1 will be certified the following semester
7. Any items necessary for credit certification, other than those specified in this agreement, will be specified by the Japanese Language Committee.

Enacted on January 5, 2011 (enforced on October 1, 2011)

\*Japanese class; Intermediate Japanese (3 credits)

Students who feel that the class does not match their Japanese abilities may instead select 3 subjects (3 credits) from the General Education Japanese A-J classes (1 credit each; aimed at advanced JLPT N1-level students). These subjects are held for privately financed international students belonging to degree courses taught in Japanese.

If you wish to do this, speak to your Japanese language instructor in advance to confirm that your abilities will be sufficient before registering. Inquire with the FGL staff or General Education Operating Section in the Educational Affairs Division for the Japanese A-J timetable.

## III Examinations, Grading and Reports

### 1. Exam Schedule, Methods

Examinations will be conducted by class instructors during the course. Please follow your instructor's directions when taking examinations. Information on examinations may be announced on Learning Management System (LMS), bulletin board and UNIPA so please check them carefully.

Grading methods for each subject are described in the syllabus.

### 2. Notes on Examinations

When submitting written exams and reports for General Education subjects, never engage in misconduct as described below. Also, please comply with all of the following Notes on Written Examinations. If any misconduct is detected in written examinations or reports, those involved will be subject to severe disciplinary measures.

#### <Notes on Written Examinations>

1. Follow the exam proctor's instructions and refrain from any misconduct.
2. Please fill seats in the exam room starting from the front row.
3. Place your student ID card on your desk during the examination.
4. Except for writing utensils, especially mobile devices such as smartphones or smartwatches, wearable devices, and pieces of paper, etc., should not be left on the desk or worn but should be put away in your bag. Those electronic devices should be turned off at that time. You may use a dictionary, etc. only if permitted to do so.
5. Writing mats may be used only if permitted by the proctor.

#### <Definition of Misconduct>

##### Written Examinations

- (1) Taking an exam in place of another person, or having another person take an exam in your place.
- (2) Using unauthorized textbooks, dictionaries, reference materials, notes, memos, etc. during the examination.
- (3) Peeking at other people's answers, showing others your answers, receiving answers from others, etc.
- (4) Exchanging answers with others.
- (5) Placing on your desk or wearing smartphones, smartwatches, other mobile or wearable devices, pieces of paper, etc., that the proctor has instructed to be stored in your bag.
- (6) Behavior that is contrary to the proctor's instructions and/or disrupts the fair administration of the examination.
- (7) Any other behavior that is deemed to be equivalent to the above.

##### Reports etc.

- (1) Plagiarism: Ex. intentionally quoting your own or another author's copyrighted work without specifying the source or using the content of another student's report.
- (2) Fabrication: Ex. creating nonexistent test results and data, quoting nonexistent (fictitious) sources
- (3) Alteration: Ex. deliberately altering data and processes, manufacturing inauthentic results
- (4) Any other activities forbidden by the class instructor for the reason that they would prevent accurate evaluation of learning achievements.

Ex. Follow the instructions of the instructor in charge regarding the use of Generative AI..

### 3. Makeup Examinations, etc.

If you are unable to take an examination, etc., due to illness, accident, or bereavement (loss of an immediate family member), you can apply through the Student Affairs Division to take a makeup examination within three days (including the day of the examination)) after the end of the relevant examination, excluding Saturdays, Sundays, and national holidays. The following documents are required.

- For illness: Doctor's diagnosis
- For accidents: Accident Report Form
- For bereavement: Corroborating documentation

### 4. Grading

Grading is described in the syllabus for each subject.

However, grading for General Education subjects is handled as follows.

## Grading of General Education Subjects.

(Grading)

1. Grading for General Education subjects is as follows.

Grade	Description of Evaluation	Criteria for Points (out of 100)	Benchmark for the achievement level of the target
AA	The student's performance was particularly exceptional.	90–100 points	Achieved learning objectives at an exceptionally high level.
A	The student's performance was excellent.	80–89 points	Achieved learning objectives at an excellent level.
B	The student's performance was above average.	70–79 points	Achieved learning objectives at a standard level.
C	The student passed.	60–69 points.	Achieved learning objectives
D	The student failed or quit the class.	59 points or below	Did not achieve learning objectives
E	The student deregistered as per the proscribed procedures.	—	—

Comments

- 1) Grading and evaluation will take into account examination performance, reports submitted, attendance, and registration status.
  - 2) The "AA" grade was implemented for incoming students in the 2004 academic year onward; for students who enrolled prior to 2004, there is no distinction between the "AA" and "A" grades.
  - 3) The grade designated as "E" will be given under the following conditions.
    - a) If the student deregisters at the Student Affairs Division during a designated period.
    - b) The student takes a leave of absence, or withdraws, from the university
  - 4) This grading system is effective as of the subjects taught in the 2013 academic year onward.
2. The syllabus will provide descriptions of educational goals (academic achievement goals) and specific evaluation methods for each subject; in general, absolute evaluations will be based on the correspondence of student performance with the educational goals set for each subject.
  3. Class instructors shall store student examination answer sheets for one year from the date of the examination, and reports, etc. for one year from their due date, to serve as a basis for grading and to respond to any requests for information disclosure from students. However, this requirement does not apply to reports that are returned to the students with grades/comments; in the case of examination answer sheets, it is recommended that the instructor store the original and return a copy. (Reference: Tohoku University Criteria on Length of Storage Period for Documents: One year or less for examination answer sheets and reports.)

(Accepting questions)

4. Students can receive an explanation of the grade evaluation from the class instructor of the class by requesting it to the Academic Affairs Division only within a designated period of time following the announcement of grades. However, if a student is unable, for legitimate reasons, to make this request during that period, the student can receive an explanation at a later time, as long as it is within the one-year storage period.

(Complaint)

5. If the student is unsatisfied with the grade, the student can file a petition with the chairperson of the Educational Records and Programs Committee of the Academic Affairs Council (hereafter "Educational Records and Programs Committee"), through the Academic Affairs Division only within a specified period. However, if a student is unable, for legitimate reasons, to make this request during that period, the student can file a petition at a later time, as long as it is within the one-year storage period.
6. Upon receiving a petition of dissatisfaction, the Educational Records and Programs Committee shall set up a subcommittee, composed of several members to investigate its validity.

(Publication of Grading)

7. The Grading Improvement Committee of the Academic Affairs Council shall compile and analyze grades and release their findings to the class instructors and students.

\* Designated period is within two weeks after the announcement of grades.

\* A petition of dissatisfaction should be filed when the student is still unsatisfied after hearing the class instructor's explanation regarding the grade, not when the student who failed the class wishes to take a makeup exam. Students should not visit instructor's office without an appointment.

## 5. GPA (Grade Point Average) System

The GPA system was adopted by Tohoku University to increase the students' academic motivation, contribute to the provision of appropriate learning guidance, promote rigorous grade evaluation, and improve the quality of learning. GPA is calculated using the method described below, although each faculty or graduate school may have its own rules.

### ➤ Grades and GP

Grade Points (GP) will be assigned in accordance with each faculty's regulations, faculty-specific regulations on registration, and the regulations on General Education, as per the following table.

Evaluation		GP
Letter Grade	Score	
AA	100-90	4.0
A	89-80	3.0
B	79-70	2.0
C	69-60	1.0
D	59-0	0.0

### ➤ GPA Categories and Calculation Method

Tohoku University has two types of GPA: one that indicates learning progress and achievements for the relevant semester (hereafter "semester GPA"), and one that indicates learning progress and achievements for the entire period of enrollment at the university (hereafter "cumulative GPA").

The semester and cumulative GPAs will be calculated with the below formulas, and the resulting numbers rounded to the 3rd decimal place.

$$\text{Semester GPA} = \frac{\text{Total of (GP for each class evaluated for the semester} \times \text{the number of credits for relevant classes)}}{\text{Total credits for the classes evaluated for the semester}}$$

$$\text{Cumulative GPA} = \frac{\text{Total of (GP for each class evaluated during the entire enrollment period} \times \text{the number of credits for relevant classes)}}{\text{Total credits for the classes evaluated for the entire enrollment period.}}$$

### ➤ Classes Affecting GPA

The below classes will be excluded from the student's semester and cumulative GPAs.

- 1) Classes for which the student has, by the prescribed date applied and received permission to cancel the registration.
- 2) Classes designated by the Chairperson of the Academic Affairs Council, or the Faculty Dean or Department Director.

## IV Introduction to Class Contents

### 1. Course Numbering Code

#### A) Course Numbering

Course Numbering is a system in which codes indicating a variety of information of each class, such as subject category and levels of difficulty, to clarify the curriculum structure.

By assigning codes and numbers to each class has a unique code to clarify its difficulty level/characteristics, significance, and the sequence in which courses should be taken, students can understand which classes they should register for, the role of each class within the undergraduate/graduate curriculum, and each course's objectives.

Also, clarifying course levels is expected to facilitate credit transfers with overseas universities.

#### B) Coding Method

Course Numbering at Tohoku University is organized as follows.

In general, the codes will be fixed for each class instead of being reassigned every academic year. However, codes may be reassigned in some cases, such as when there are major revisions to the class content.

#### a) Example of Course Numbering Code

A BC - (hyphen) DEF 1 23 G  
① ② ③ ④ ⑤ ⑥

#### b) Meanings of Each Segment of the Code:

- ① Hosting Faculty/School
- ② Department/Major (for General Education etc., subject category/group)
- ③ Academic Field
- ④ Level/Characteristics

- ⑤ Classification Number
- ⑥ Language Used in Class

**c) List of Each Segment Code**

① List of Hosting Faculty/School Codes (single letter)

These codes are the same as the letter that indicates the student's faculty/graduate school, shown as the third letter of the student ID number; General Education Subjects (faculty code: Z) and Teacher Training Subjects (faculty code: Q) were assigned letters not already in use.

Faculty/Graduate School	Faculty Code
Faculty of Science/Graduate School of Science	S
School of Engineering/Graduate School of Engineering	T
Faculty of Agriculture/Graduate School of Agricultural Science	A

Faculty/Graduate School	Faculty Code
General Education Subjects	Z
Teacher Training Subjects	Q

② List of Department/Major Codes (two letters) \*Those for only General Education are shown here.

General Education	Foundations	Navigating Academia	FA
		Humanities	FH
		Social Sciences	FS
		Natural Sciences	FN
		Transdisciplinary Subjects	FT
	Advanced Subjects	Contemporary Competencies	AC
		Cutting Edge Subjects	AE
	Languages	Foreign Languages	LF
		Japanese	LJ
	Basics of Discipline	Basics of Humanities	DU
		Basics of Social Sciences	DO
		Basics of Mathematics	DM
		Basics of Physics	DP
		Basics of Chemistry	DC
		Basics of Biology	DB
	Teacher Training Subjects	Basics of Earth and Space Science	DE
			TL

③ Academic Field Codes (three letters)

As shown in "III Course Numbering for General Education"

\*This code can be seen in the Quick Syllabus. Please refer to "2. Searching Syllabus Online" for details.

<https://qsl.cds.tohoku.ac.jp>

④ List of Levels/Characteristic Codes (one number) \*only General Education is shown here

Class Type/Group/Subject			Code
Foundations	Navigating Academia	Introduction to Academic Learning, Seminar on Each Discipline for Academic Learning	1
		Advanced General Education Course	2
	Humanities, Social Sciences, Natural Sciences		1
	Transdisciplinary Subjects	Integrated Experiments of Science, Health & Sports (Sports), Health & Sports (Lecture)	1
		Other than above	8
Advanced Subjects	Contemporary Competencies (Information Science and Technology Education)	Information and Data Literacy	1
	Contemporary Competencies (Subjects related to study abroad and internships)		9
	Other than above		8
Languages	Foreign Languages (English)	English I-A, I-B, II-A, II-B	1
		English III, III (e-learning)	2
	Foreign Languages (Languages for	Basic *** (Language) I, II	1
		Intermediate *** (Language) I, II, III, IV,	2

	Multilinguality)	Practical *** (Language) I, II	
	Other than above		1
Basics of Discipline			1
Teacher Training	Practical Seminar on Teaching Profession		4
Subjects	Other		1

⑤ Classification Number (two numbers)

Classification Numbers are assigned for Course Numbering administration purposes; they are not sequential.

⑥ Codes for Language Used in Class (one letter)

Languages used in classes will be coded as follows.

Language Used	Code
Japanese	J
English	E
Non-English foreign languages	F
Two or more languages	B

These codes will be assigned per class, in accordance with the syllabus for the relevant academic year.

(Ex.)

General Education Subject "Foundation of Calculus" CB12345(Japanese) ZDN-MAT104J

General Education Subject "Foundation of Calculus" CB67890 (English) ZDN-MAT104E

## 2. Searching Syllabus Online

Course syllabi can be viewed in the Student Affairs Information System “UNIPA”. It requires your Tohoku University ID and password to log into the system. While syllabi may additionally be viewed in other locations such as the university websites and the QuickSyllabus, the posting in the Student Affairs Information System is the most up-to-date information.

- **The Student Affairs Information System:**

Log in to the “UNIVERSAL PASSPORT (hereinafter referred to as UNIPA)” from the URL below.

<https://slink.secioss.com/user/index.php?tenant=authtohoku.ac.jp/>



### Top Page

Requires Tohoku University ID and password to log in.  
Contact the FGL Office if you have any questions.  
For more information on image-matrix authentication, please refer to the online guide.  
<https://sites.google.com/tohoku.ac.jp/oids-out/sso>

Off-campus access



One-time password  
or FIDO authentication (face, fingerprint, etc.)



On-campus access

→Select ‘UNIPA’ from the portal

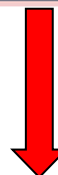

**Change the language to English.**

## Online syllabus search

Common Academic affairs WEBtest Mystep Job

Syllabus Timetable Class registration-related Assessment Qualification

Syllabus inquiry Student timetable Course registration Assessment inquiry Hope qualification registration

Display in daily basis Display in monthly Registered courses

Bulletin Change schedule MyStep

リンク

“Academic affairs” Tab → Syllabus → Click “Syllabus inquiry”

All day

There are no plans.

Add My Schedule

Events

There are no plans.

## You can specify detailed search criteria on the following screen.

Common Academic affairs WEBtest Mystep Job

Search for syllabus

Year and semester of entrance  All

Department  All

Course category  All

※When you specify the course category, please specify also the academic year of entrance and the department organization.

Administrative department  全学教育科目

Year and semester  2024  後期

Course  Partial search

Faculty  Partial search

Grade  All  1st Year  2nd Year  3rd Year  4th Year

Campus  All

Course style  All

Class frequency  Every week  Even weeks  Odd weeks  Intensive course  else

Class period category  Whole semester  後期前半  後期後半

Day of week  Mon  Tue  Wed  Thu  Fri  Sat  Sun

Period  Period 1  Period 2  Period 3  Period 4  Period 5  Period 6  Period 7

Course number

Keyword(s)

Target classes  Classes with tags  Classes that can be registered

Clear

Q Search

You can search by subject group (selected from ‘Course category’ after selecting ‘Year and semester of entrance’ and ‘Department’), Course and Faculty to narrow down your search.

Specify the “Administrative department” and “Year and semester”.

全学教育科目: General education  
理学部: Specialized subjects in Science  
工学部: " in Engineering  
農学部: " in Agriculture  
前期: Spring  
後期: Fall

You can also narrow down your search by “Day of week” and “Period”.

Finally, press the Search button. It is not necessary to enter all items. You can search by entering only a few items, such as a part of a course or the surname of the faculty.

## Search results will be displayed.

Day and period	Subject	Faculty	Class frequency	Year and semester	Credits
Mon2	<a href="#">CB12221.Physics A</a>	TAKESHI KOIKE	Every week	2024年度 後期	2.0Credits
Mon4	<a href="#">CB14209.Physics B</a>	MASAFUMI SHIRAI	Every week	2024年度 後期	2.0Credits
Mon4	<a href="#">CB14210.Physics B</a>	TADASHI ABUKAWA	Every week	2024年度 後期	2.0Credits
Mon4	<a href="#">CB14211.Physics B</a>	SHOZO SUTO	Every week	2024年度 後期	2.0Credits
Mon4	<a href="#">CB14212.Physics B</a>			2024年度 後期	2.0Credits
Mon4	<a href="#">CB14213.Physics B</a>			2024年度 後期	2.0Credits
Tue3	<a href="#">CB23238.Physics A</a>	TAKESHI KOIKE	Every week	2024年度 後期	2.0Credits
Tue4	<a href="#">CB24214 Foundations of Physics II</a>	SHOZO SUTO	Every week	2024年度 後期	2.0Credits
Tue4	<a href="#">CB24215 Foundations of Physics II</a>	HIROAKI OHNISHI	Every week	2024年度 後期	2.0Credits
Tue4	<a href="#">CB24216.Physics B</a>	SHIGEO MATSUYAM...	Every week	2024年度 後期	2.0Credits

Click "Subject" name to display the syllabus.

## Syllabus display screen

Syllabus inquiry		Print Out	
Subject	Physics A		
Day/Period	Tue.3Period	Place	川北キャンパスC103
Categories	全学教育科目学術基礎科目-基礎物理学		
Credit(s)	2.0Credits		
Object	国際学士コース（未履修）（*）		
Instructor (Position)	小池 武志 所属：高度教養教育・学生支援機構		
Term	2 セメスター		
Course Numbering	ZDP-PHY101E		
Language Used in Course	英語		
Course of Media Class			
Main Subjects	各学部の履修内規または学生便覧を参照。		
Class Subject	Introductory Physics		
Object and Summary of Class	This course is intended for students without any or little background in physics and calculus. Through Newtonian mechanics, important concepts in physics such as force, momentum, energy, angular momentum, and laws of conservation will be introduced. In addition, how these concepts are described in the language of mathematical equations, in particular, using calculus will be explored.		
Goal of Study	By the end of the course, you are expected to gain familiarity with Newton's laws of motion, momentum, and energy, and angular momentum as well as their conservation properties. In addition, you are expected to be able to draw a free-body diagram, derive an equation of motion, and solve it using simple vector algebra and		

\*Screen configurations are subject to change.

### ● Quick Syllabus

QuickSyllabus is a website that allows you to quickly search syllabi without logging in. The website is only available in Japanese, but the syllabus itself is available in English if the course is conducted in English. Note that the contact information of instructors is NOT posted in QuickSyllabus.

QuickSyllabus: <https://qsl.cds.tohoku.ac.jp>

## V General Education Class Information (FGL Program)

### 1. List of Subjects (2<sup>nd</sup>, 3<sup>rd</sup>, and 4<sup>th</sup> Semester Classes)

Category	Group 1	Group 2	Subject	Credits	Semester	Courses
Foundations	Navigating Academia	-	Introduction to Academic Learning	2	2	AMC IMAC-U AMB
	Humanities	-	History	2	2	AMC IMAC-U AMB
	Social Sciences	-	Economy and Society	2	2	AMC IMAC-U AMB
	Natural Sciences	Mathematics	Foundations of Linear Algebra	2	3	AMB
			Foundations of Calculus	2	2	AMB
	Transdisciplinary Subjects	Life	Life and Nature	2	2	AMC IMAC-U AMB
		Integrated Experiments of Science	Introductory Science Experiments	2	3	AMC IMAC-U AMB
		Health & Sports (Sports)	Sports A	1	3	IMAC-U
					4	AMC AMB
	Health & Sports (Lecture)	Health	2	4	AMC IMAC-U AMB	
Advanced Subjects	Contemporary Competencies	Information Science and Technology Education	Information and Data Literacy	2	2	AMC IMAC-U AMB
		International Education	Study-abroad Program A (Fundamentals of Interdisciplinary STEM Seminar)	1	2	AMC IMAC-U AMB
		Career Education	Special Lecture of Career Education (Digital Entrepreneurship Seminar)	2	4	AMC IMAC-U AMB
Languages	Japanese	Japanese	Basic Japanese I	4	2	AMC IMAC-U AMB
			Basic Japanese II	3	3	AMC IMAC-U AMB
			Intermediate Japanese	3	4	AMC IMAC-U AMB

Category	Group 1	Group 2	Subject	Credits	Semester	Courses
Basics of Discipline	Basics of Mathematics	-	Linear Algebra A	2	2	AMC IMAC-U
			Linear Algebra B	2	3	AMC IMAC-U
			Calculus A	2	2	AMC IMAC-U
			Calculus B	2	3	AMC IMAC-U
			Ordinary Differential Equations	2	4	AMC IMAC-U
			Probability & Statistics	2	4	AMC IMAC-U AMB
	Basics of Physics	-	Physics A	2	2	AMC IMAC-U AMB
			Physics B	2	3	AMC IMAC-U AMB
			Physics C	2	3	AMC IMAC-U AMB
	Basics of Chemistry	-	Chemistry A	2	2	AMC IMAC-U AMB
			Chemistry B	2	2	AMC IMAC-U AMB
			Chemistry C	2	3	AMC IMAC-U AMB
	Basics of Biology	-	Biology A	2	2	AMC IMAC-U AMB
			Biology B	2	3	AMC AMB
			Biology C	2	3	AMC AMB
	Basics of Earth and Space Science	-	Earth Material Science	2	2	AMC IMAC-U AMB

✘For subjects other than those listed above, please refer to the orientation for each course.

## 2. Timetable

ATTN: When you register for courses, be sure to select the English courses for FGL students that match the instructor names below.

### (1) AMC Course



General Education Subjects



Specialized Subjects

### 3<sup>rd</sup> Semester (April 2026– September 2026)

	8:50 - 10:20	10:30 - 12:00	13:00 - 14:30	14:40 - 16:10	16:20 - 17:50
Mon.		専門基礎化学 I <b>Special Class in Basic Chemistry I</b> Yuichi NEGISHI	生物化学概論 <b>General Biochemistry</b> Satoshi TAKAHASHI Eriko NANGO Fumi NAGATSUGI	専門基礎化学 III <b>Special Class in Basic Chemistry III</b> Kozo TOYOTA	CB11302 <b>Biology C</b> Satoshi KATAYAMA, etc South Multidisciplinary Research Laboratory 2, 4 <sup>th</sup> Floor, Seminar Room
Tue.	CB32303 <b>Basic Japanese II</b> Masako HAYASHI Yukiko SHUKURI <b>C103</b>	CB22304 <b>Biology B</b> Hsinjung HO <b>C203</b>	CB23311 <b>Calculus B</b> Xavier DAHAN <b>C203</b>		
Wed.	CB31320 <b>Chemistry C</b> Mott Derrick <b>C103</b>	CB32303 <b>Basic Japanese II</b> Masako HAYASHI Yukiko SHUKURI <b>A103</b>	CB33343 <b>Physics C</b> Takeshi KOIKE <b>R115</b>		
Thu.		CB42317 <b>Physics B</b> Dmytro FEDORYNENKO <b>C203</b>	CB43306 <b>Introductory Science Experiments</b> Itaru NAKAMURA, Satoshi TOMITA et al. <b>[A06] Student Laboratories</b>		CB32303 <b>Basic Japanese II</b> Masako HAYASHI Yukiko SHUKURI <b>A204</b>
Fri.		CB52302 <b>Linear Algebra B</b> Mohammad Samy Baladram <b>C203</b>	専門基礎化学 II・IV <b>Special Class in Basic Chemistry II, IV</b> Brian Keith, BREEDLOVE		

### 4<sup>th</sup> Semester (October 2026 – March 2027)

	8:50 - 10:20	10:30 - 12:00	13:00 - 14:30	14:40 - 16:10	16:20 - 17:50
Mon.		物理化学概論 B <b>General Physical Chemistry B</b> Hiroshi KUMIGASHIRA	物理化学演習 A <b>Exercises in Physical Chemistry A</b> Tsuyoshi TAKAOKA and other staff	無機分析化学概論 B <b>General Inorganic and Analytical Chemistry B</b> Brian Keith, BREEDLOVE	
Tue.	CB21401 <b>Probability &amp; Statistics</b> Xavier DAHAN <b>C204</b>	CB31404 <b>Intermediate Japanese</b> Yuna MIKODA Yukari AZUMI <b>C204</b>	CB23402 <b>Ordinary Differential Equations</b> Xavier DAHAN <b>C404</b>	日本の産業と科学技術 <b>Science, Technology and Industry in Japan</b> Yoshitaka KASUKABE, etc <b>A305</b>	CB25204 <b>Special Lecture of Career Education (Digital Entrepreneurship Seminar)</b> Takeshi KOIKE, etc <b>C103</b>
Wed.	CB31404 <b>Intermediate Japanese</b> Yuna MIKODA Yukari AZUMI <b>C204</b>	CB31404 <b>Intermediate Japanese</b> Yuna MIKODA Yukari AZUMI <b>C204</b>			
Thu.		生物化学 IA <b>Biochemistry IA</b> South Multidisciplinary Research 2 Satoshi TAKAHASHI	有機化学演習 A <b>Exercises in Organic Chemistry A</b> Fumi NAGATSUGI, Shin MIZUKAMI and other staff		
Fri.	無機分析化学概論 A <b>General Inorganic and Analytical Chemistry A</b> Brian Keith, BREEDLOVE	有機化学概論 A <b>General Organic Chemistry A</b> Shin MIZUKAMI	スポーツ A <b>Sports A*</b>		
Inter-Cent. S	CB88404 <b>Health</b> Yosuke YAMADA				

Notice: \*Students will choose one of the sports activities for Sports A.

\*Students will choose one of the Introductory Seminar.

## (2) IMAC-U Course

 General Education Subjects

 Specialized Subjects
3<sup>rd</sup> Semester (April 2026 – September 2026)

	8:50 - 10:20	10:30 - 12:00	13:00 - 14:30	14:40 - 16:10	16:20 - 17:50
Mon.	<2Q> 数学 II <b>Mathematics II</b> Fedorynenko DMYTRO Vergara Pulgar Andrea Alejandra	<1Q>力学 <b>Mechanics</b> Anna SUZUKI <2Q>数理解析学 <b>Numerical Analysis</b> Kanjuro MAKIHARA	<1Q>数学 I <b>Mathematics I</b> Masayuki TAKAHASHI	<1Q>数理情報学演習 <b>Exercises in Computer-Aided Problem Solving</b> Takayuki OKATANI Hiraku MATSUKUMA	
Tue.	CB32303 <b>Basic Japanese II</b> Masako HAYASHI Yukiko SHUKURI <b>C103</b>	スポーツ A <b>Sports A*</b>	CB23311 <b>Calculus B</b> Xavier DAHAN <b>C203</b>		
Wed.	CB31320 <b>Chemistry C</b> Mott Derrick <b>C103</b>	CB32303 <b>Basic Japanese II</b> Masako HAYASHI Yukiko SHUKURI <b>A103</b>	CB33343 <b>Physics C</b> Takeshi KOIKE <b>R115</b>	<1Q-2Q>数学物理学演習 II <b>Exercises in Mathematics and Physics II</b> Nguyen Van Toan	
Thu.		CB42317 <b>Physics B</b> Dmytro FEDORYNENKO <b>C203</b>	CB43306 <b>Introductory Science Experiments</b> Itaru NAKAMURA, Satoshi TOMITA et al. <b>[A06] Student Laboratories</b>	CB32303 <b>Basic Japanese II</b> Masako HAYASHI Yukiko SHUKURI <b>A204</b>	
Fri.	<1Q>力学 <b>Mechanics</b> Anna SUZUKI	CB52302 <b>Linear Algebra B</b> Mohammad Samy Baladram <b>C203</b>	<1Q>数学 I <b>Mathematics I</b> Masayuki TAKAHASHI <2Q>数学 II <b>Mathematics II</b> Fedorynenko DMYTRO Vergara Pulgar Andrea Alejandra	<1Q>数理情報学演習 <b>Exercises in Computer-Aided Problem Solving</b> Takayuki OKATANI Hikaru MATSUKUMA <2Q>数理解析学 <b>Numerical Analysis</b> Kanjuro MAKIHARA	

4<sup>th</sup> Semester (October 2026 – March 2027)

	8:50 - 10:20	10:30 - 12:00	13:00 - 14:30	14:40 - 16:10	16:20 - 17:50
Mon.	<3Q>量子力学 I <b>Quantum Mechanics</b> Wataru YASHIRO <4Q>材料力学 II <b>Mechanics of Materials II</b> Takeshi YAMAGUCHI Go YAMAMOTO	<3Q>機械力学 I <b>Mechanical Vibrations I</b> Mitsuhiro HAYASHIBE, Fedorynenko DMYTRO <4Q>制御工学 I <b>Control Engineering I</b> Dai OWAKI	<3Q>材料力学 I <b>Mechanics of Materials I</b> Tomonaga OKABE Yuji ICHIKAWA <4Q>流体力学 I <b>Fluid Mechanics I</b> Hiroki NAGAI		
Tue.	CB21401 <b>Probability &amp; Statistics</b> Xavier DAHAN <b>C204</b>	CB31404 <b>Intermediate Japanese</b> Yuna MIKODA Yukari AZUMI <b>C204</b>	CB23402 <b>Ordinary Differential Equations</b> Xavier DAHAN <b>C404</b>	日本の産業と科学技術 <b>Science, Technology and Industry in Japan</b> Yoshitaka KASUKABE, etc <b>A305</b>	CB25204 <b>Special Lecture of Career Education (Digital Entrepreneurship Seminar)</b> Takeshi KOIKE, etc <b>C103</b>
Wed.	CB31404 <b>Intermediate Japanese</b> Yuna MIKODA Yukari AZUMI <b>C204</b>	CB31404 <b>Intermediate Japanese</b> Yuna MIKODA Yukari AZUMI <b>C204</b>	<3Q-4Q>機械知能・航空研修 I <b>Seminar I</b>	<3Q>情報処理演習 <b>Practice of Information Processing</b> Makoto HIROTA <4Q>コンピューター実習 I <b>Computer Seminar I</b>	
Thu.	<3Q>量子力学 I <b>Quantum Mechanics</b> Wataru YASHIRO <4Q>材料力学 II <b>Mechanics of Materials II</b> Takeshi YAMAGUCHI Go YAMAMOTO	<3Q>熱力学 I <b>Thermodynamics I</b> Takashi TOKUMASU Akihiro HAYAKAWA <4Q>材料科学 I <b>Materials Science I</b> Kazuhisa SATO Yuji ICHIKAWA	<3Q>材料力学 I <b>Mechanics of Materials I</b> Tomonaga OKABE Yuji ICHIKAWA <4Q>流体力学 I <b>Fluid Mechanics I</b> Hiroki NAGAI		
Fri.	<3Q>熱力学 I <b>Thermodynamics I</b> Takashi TOKUMASU Akihiro HAYAKAWA <4Q>材料科学 I <b>Materials Science I</b> Kazuhisa SATO Yuji ICHIKAWA	<3Q>機械力学 <b>Mechanical Vibrations I</b> Mitsuhiro HAYASHIBE, Fedorynenko DMYTRO <4Q>制御工学 I <b>Control Engineering I</b> Dai OWAKI	<3Q-4Q>機械知能・航空研修 I <b>Seminar I</b>		
Manufacturing Engineering	創造工学研修 <b>Team-Based Engineering for Invention</b> Instructor and students will arrange and decide the schedule of this lesson.				
Health	CB88404 <b>Health</b> Yosuke YAMADA				

Notice: \*See the IMAC-U timetable for details of Specialized Subject Classes.

\*Students will choose one of the sports activities for Sports A.

\*Students will choose one of Introductory Seminar.

**(3) AMB Course**

General Education Subjects

Specialized Subjects

**3<sup>rd</sup> Semester (April 2026 – September 2026)**

	8:50 - 10:20	10:30 - 12:00	13:00 - 14:30	14:40 - 16:10	16:20 - 17:50
Mon.					CB11302 <b>Biology C</b> Satoshi KATAYAMA, etc <b>*Online</b>
Tue.	CB32303 <b>Basic Japanese II</b> Masako HAYASHI Yukiko SHUKURI <b>C103</b>	CB22304 <b>Biology B</b> Hsinjung HO <b>C203</b>	CB23311 <b>Calculus B</b> Xavier DAHAN <b>C203</b>	CB24335 <b>Foundations of Linear Algebra</b> Ying CHEN <b>C203</b>	
Wed.	CB31320 <b>Chemistry C</b> Mott Derrick <b>C103</b>	CB32303 <b>Basic Japanese II</b> Masako HAYASHI Yukiko SHUKURI <b>A103</b>	CB33343 <b>Physics C</b> Takeshi KOIKE <b>R115</b>		
Thu.		CB42317 <b>Physics B</b> Dmytro FEDORYNENKO <b>C203</b>	CB43306 <b>Introductory Science Experiments</b> Itaru NAKAMURA, Satoshi TOMITA et al. <b>[A06] Student Laboratories</b>		CB32303 <b>Basic Japanese II</b> Masako HAYASHI Yukiko SHUKURI <b>A204</b>
Fri.	(1Q)水圏無脊椎動物学 <b>Aquatic Invertebrate Biology</b> Lecture Room 8		現代における農と農学 <b>Modern Agriculture and Agricultural Science</b>	陸圏・水圏環境コミュニケーション論 <b>Introduction to Aquatic Production / Introduction to Natural and Agricultural Production</b>	
Intensive course	臨海実習 <b>Practice on Marine Bio-resources Science</b>				

Notice: \*Classroom or location is not specified. Students should connect individually following instructor's directions.

**4<sup>th</sup> Semester (October 2026– March 2027)**

	8:50 - 10:20	10:30 - 12:00	13:00 - 14:30	14:40 - 16:10	16:20 - 17:50
Mon.			<3Q>水産遺伝伝育種学 <b>Fish Genetics and Breeding science</b> Lecture Room 8		
Tue.	CB21401 <b>Probability &amp; Statistics</b> Xavier DAHAN <b>C204</b>	CB31404 <b>Intermediate Japanese</b> Yuna MIKODA Yukari AZUMI <b>C204</b>	CB23402 <b>Ordinary Differential Equations</b> Xavier DAHAN <b>C404</b>	日本の産業と科学技術 <b>Science, Technology and Industry in Japan</b> Yoshitaka KASUKABE, etc <b>A305</b>	CB25204 <b>Special Lecture of Career Education (Digital Entrepreneurship Seminar)</b> Takeshi KOIKE, etc <b>C103</b>
Wed.	CB31404 <b>Intermediate Japanese</b> Yuna MIKODA Yukari AZUMI <b>C204</b>	CB31404 <b>Intermediate Japanese</b> Yuna MIKODA Yukari AZUMI <b>C204</b>			
Thu.	<4Q>海洋生物学 <b>Marine Biology</b> Lecture Room 8				
Fri.		水産科学概論 <b>Introduction to Fisheries Science</b> Lecture Room 8	スポーツ A <b>Sports A*</b>		
Intensive Course	CB88404 <b>Health</b> Yosuke YAMADA				

Notice: \*Students will choose one of the sports activities for Sports A.

\*Students will choose one of the Introductory Seminar.

**Cooperative Innovation Program in Science, Engineering, and Agriculture  
for Leading Sustainable and Diverse Industry and Society by Digital Globalization**

The FGL program has been selected by MEXT for a new program aimed at government-sponsored students. As a result, starting in FY 2024, FGL will be able to accept 8 government-sponsored students each year for three years. The objective of this program is to create an educational system based on cooperation between three undergraduate schools that will foster leaders in the field of global sustainable and diverse industry and society while driving innovation in university education.

Those who enter FGL as government-sponsored students will also belong to this new program. Therefore, in addition to the curricula of their undergraduate schools, the government-sponsored students will have to fulfill the requirements of this program as well. The program requirements (i.e. requirements for receiving government sponsorship) consist of nine or ten credits in the below six subjects. For details of each subject, please see the syllabus. From 1. to 4. below are General Education subjects.

1. Introduction to Academic Learning [2 credits] — General Education Subjects
2. Life and Nature (Study of Nature, Life and Technology) [2 credits] — General Education Subjects
3. Study Abroad Program A [1 credit] — General Education Subjects
4. Digital Entrepreneurship Seminar [2 credits] — General Education Subjects
5. Science, Technology, and Industry in Japan [1 credit] — Specialized Subjects
6. Multidisciplinary Internship [1 credit] — Specialized Subjects

## VI Other

### 1. Medical Care Required due to Accidents in Class

Students who suffer accidents during class should contact the Student Health Care Center and make arrangements to receive medical care. For contact information, refer to 3(2).

### 2. Using Educational Facilities

(1) ICL Rooms	ICL(Information and Communication Learning) Rooms at the Multimedia Education and Research Complex may be used for self-study during times when classes are not scheduled.
(2) ICL academic Lounge	These rooms on the 1st and 2nd floors of Lecture Building B are available for conversation or group work to deepen international exchange, as well as for voluntary discussions during classes. Please note that when this room is used for classes such as Intercultural Collaborative Learning, classes take priority and the room will not be available for other use.
(3)SLA Lounge	The SLA (Student Learning Advisor) Lounge is located on the first floor of the Multimedia Education and Research Complex and can be used for self-study or breaks. This facility operates Learning Support Center by SLA where senior students provide subject-specific assistance with questions and advice. For details, please visit the SLA Support website.

### 3.Counseling Services

Students requiring counseling from someone other than their class instructors or department staff should contact the below counseling services. The details of counseling will be kept strictly confidential. (No Charge)

(1) Center for Counseling and Disability Services	<ul style="list-style-type: none"> <li>▪ Center for Counseling and Disability Services provides consulting regarding problems that arise during student life. Appropriate solutions will be discussed with the student.</li> <li>▪ Location: Kawauchi Kita Campus, Tel: 022-795-7833</li> <li>▪ Hours: Mon. - Fri. 9:30 - 17:00</li> </ul> <p><a href="https://www.ccds.ihe.tohoku.ac.jp/front-2-2/counseling_office/sso_english/">https://www.ccds.ihe.tohoku.ac.jp/front-2-2/counseling_office/sso_english/</a></p>
(2) Student Health Care Center	<ul style="list-style-type: none"> <li>▪ The goal of the Student Health Care Center is to maintain and improve student health. Students who have questions, concerns or anxiety about their physical or psychological health should make use of this facility. The first aid offices at Katahira, Schools of Medicine/Dentistry, School of Engineering, and Faculty of Agriculture also provide medical consulting and care.</li> <li>▪ Location: Kawauchi Kita Campus, Tel: 022-795-7829</li> <li>▪ Hours: Weekdays 9:00 - 11:30, 13:00 - 16:15</li> </ul> <p><a href="https://www.health.ihe.tohoku.ac.jp/eng_front/">https://www.health.ihe.tohoku.ac.jp/eng_front/</a></p>
(3) University-wide Harassment Counseling Center	<ul style="list-style-type: none"> <li>▪ Location: Kawauchi Kita Campus University Counseling Center</li> <li>▪ Tel: 022-795-7812 (Only available in Japanese)</li> <li>▪ Hours: Mon. - Fri., 9:30 - 17:00</li> </ul>
(4) Counseling by Phone (Provided through off-campus organization)	<ul style="list-style-type: none"> <li>▪ Counseling regarding sexual harassment, health, mental health</li> <li>▪ Toll-free hotline: 0120-7830-59</li> <li>▪ Hours: Mon., Wed., Fri., Sat., Sun. 10:00 - 21:00 Tue., Thu. 10:00 - 22:00 (Not available on national holidays, Dec. 31 – Jan. 3)</li> </ul> <p>【English Support】 <a href="https://sites.google.com/tohoku.ac.jp/external-consul/english">https://sites.google.com/tohoku.ac.jp/external-consul/english</a></p>

### 4. Preventing Theft

(1) Incidences of theft in lecture halls and gymnasiums are fairly common. Do not leave bags etc. unattended in classrooms or study rooms, even for short periods of time. In the event of theft, report the incident to your Educational Affairs Division or Student Support Division.

(2) There are numerous incidents of bicycle theft on the Kawauchi Campus. When parking bicycles, be sure to lock them securely and park them in designated bicycle parking areas, and do not leave them unattended for long periods of time.

● **Regulations on Tohoku University General Education Subjects**

April 1, 1993 Reg. 91

(Purport)

Article 1: These regulations specify items necessary to General Education Subjects and subjects related to education (does not include those established by the faculties; hereafter "General Education Subjects") in compliance with Article 26-2 of the Tohoku University Faculty Regulations (enacted December 18, 1952; hereafter "the Regulations").

(General Education Subjects)

Article 2: Categories of General Education Subjects are as follows.

Category	Group	
Foundations	Navigating Academia, Humanities, Social Sciences	
	Natural Sciences	Mathematics, Physics, Chemistry, Biology, Earth and Space Science
	Transdisciplinary Subjects	Society, Energy, Life, Environment, Information, Integrated Experiments of Science, Health & Sports (Sports), Health & Sports (Lecture)
Advanced Subjects	Contemporary Competencies	Information Science and Technology Education, International Education, Career Education, Global Issues
	Cutting Edge Subjects	Current Topics, Frontier Topics
Languages	Foreign Languages	English, Languages for Multilinguality, Languages for Further Multilinguality
	Japanese	
Basics of Discipline	Basics of Humanities, Basics of Social Sciences, Basics of Mathematics, Basics of Physics, Basics of Chemistry, Basics of Biology, Basics of Earth and Space Science	

(Course Subjects and Credits)

Article 3: Course subjects for General Education subjects and credits are as shown in Tables 1 and 2.

(Calculation of Credits)

Article 4: Calculation of credits for General Education course subjects are as follows.

I 1 (one) credit will be awarded per 15 hours of class time.

II 1 (one) credit will be awarded per 15 to 30 hours of seminar.

III 1 (one) credit will be awarded per 30 to 45 hours of experiments, laboratory work, and practical training.

(Registration Procedures)

Article 5: Students must inform the Chairperson of the Academic Affairs Council (hereafter, "the Chairperson") of the subjects for which they intend to register by the designated date.

(Examinations)

Article 6: Accreditation for course subjects for which students register will depend on examinations; those who pass their examinations shall receive the designated number of credits.

2 For course subjects in which examinations can be given, the above article only applies to those who have enrolled in the class via the designated procedures.

(Makeup Examinations and Retesting)

Article 7: If, due to unavoidable circumstances, a student is unable to take a course subject's examination, a makeup test for that subject shall be conducted.

2. There will be no retesting for students who failed a course subject's examination.

(Grading Scale)

Article 8: Course Subjects shall be evaluated as per the scale below. However, depending on the course subject, the grade may be specified as just "Pass" or "Fail."

AA The student's performance was particularly exceptional.

A The student's performance was excellent.

B The student's performance was above average.

C The student passed.

D The student failed.

2. Of the above grades, AA, A, B, and C are passing grades, while D is a failing grade.

3. Students who fail to attend a class for which they have submitted registration as per Article 5 above, shall receive a D grade on that Course Subjects

(Special Auditing Students)

Article 9: Students of other universities, junior colleges, or technical colleges who wish to enroll in General Education subjects may be permitted to enroll as Special Auditing Students, pursuant to agreements with that other university, junior college, or technical college.

(Miscellaneous Provisions)

Article 10: Any items necessary for General Education subjects, other than those specified in these regulations, will be specified by the Academic Affairs Council.

Supplementary Regulations Omitted.

Table 1: General Education Subjects

Category	Group	Subject	Total class hours	Credits	Comments	
Foundations	Navigating Academia	Introduction to Academic Learning	30	2		
		Seminar on Each Discipline for Academic Learning	30	1		
		Advanced General Education Course	15~30	1		
	Humanities		Logic	30		2
			Philosophy	30		2
			Ethics	30		2
			Literature	30		2
			Religious Studies	30		2
			Fine Art	30		2
			Education	30		2
			History	30		2
			Linguistics and Japanese Language Sciences	30		2
			Psychology	30		2
			Cultural Anthropology	30		2
			Sociology	30		2
	Social Sciences		Economy and Society	30		2
			Japanese Constitutional Law	30		2
			Law	30		2
			Politics	30		2
			Politics and Economics in the Information Society	30		2
			Law, Politics and Society	30		2
	Natural Sciences	Mathematics	Introduction to Linear Algebra	30		2
			Foundations of Linear Algebra	30		2
			Introduction to Calculus	30		2
			Foundations of Calculus	30		2
			Introduction to Statistics	30		2
			Foundations of Probability & Statistics	30		2
		Physics	Introduction to Physics	30		2
			Foundations of Physics I	30		2
			Foundations of Physics II	30		2
		Chemistry	Introduction to Chemistry	30		2
		Biology	Introduction to Biology	30		2
		Earth and Space Science	Introduction to Astronomy	30		2
			Introduction to Environmental Earth Science	30		2
			Introduction to Geography	30		2
		Transdisciplinary Subjects	Society	Inclusive Society		30
Energy			Energy, Resources and Sustainability	30	2	
Life			Life and Nature	30	2	
Environment			Nature and Environment	30	2	
Information	Information Science and Technology in Human Life and Society		30	2		
	Introduction to Area Studies on Northeast Asia		30	2		
Integrated Experiments of Science	Introductory Science Experiments		60	2		
	Introductory Science Experiments for the Humanities		60	2		
Health & Sports (Sports)	Sports A		30	1		
	Sports B		30	1		
Health & Sports (Lecture)	Health		30	2		
	Sports and Health Sciences	30	2			

Category	Group		Subject	Total class hours	Credits	Comments
Advanced Subjects	Contemporary Competencies	Information Science and Technology Education	Information and Data Literacy	30	2	Course subjects to be taught will be determined yearly.
			Introduction to Data Science and Artificial Intelligence	30	2	
			Introduction to Algorithms for Machine Learning	30	2	
			Hands-on Machine Learning I	30	2	
			Hands-on Machine Learning II	30	2	
			Special Lecture of Information Science and Technology Education	30	2	
		International Education	Understanding International Issues	30	2	
			PBL in Global Issues	30	2	
			Special Topics on Global Issues	30	2	
			Understanding Culture	30	2	
			Exploring Culture and Society	30	2	
			Multicultural Communication	30	2	
			PBL in Multicultural Environment	30	2	
			Special Topics on Multicultural Society	30	2	
			Global Seminar	30	2	
			Global Career	30	2	
			Global Leadership Development through PBL	30	2	
			Special Topics on Global Leadership	30	2	
			Study-abroad Semester	15~30	1	
				30~60	2	
				60~90	3	
				90~120	4	
				120~150	5	
		150~180		6		
		Study-abroad Program A	45	1		
		Study-abroad Program B	90	2		
		Faculty-led Program A	45	1		
		Faculty-led Program B	90	2		
		International Exploration A	45	1		
		International Exploration B	90	2		
	Career Education	Introduction to Entrepreneurial Skills	30	2		
		Workshop for Designing Your Future	30	2		
		Career Design A	30	2		
		Career Design B	30	2		
		Career Design C	30	2		
		Career Design D	30	2		
		Preparation Course for Career Practical Training and Internship	15	1		
		Career Practical Training and Internship A	15	1		
		Career Practical Training and Internship B	30	2		
		Transferable Skills Workshop	30	2		
		Special Lecture of Career Education	30	2		
	Global Issues	Sustainability and Social Co-Creation	30	2		
		Global Governance and Sustainable Development in SDGs	30	2		
Resilient Design for the Sustainable Society		30	2			
Sustainable Development For Society		30	2			
System Design Towards a Sustainable Society		30	2			
Gender Co-Creation Society		30	2			
Cutting Edge Subjects	Current Topics	7.5	0.5	Course subjects to be taught will be determined yearly.		
		15~30	1			
	30~60	2				
Frontier Topics		30	2			

Category	Group		Subject	Total class hours	Credits	Comments		
Languages	Foreign Languages	English	English I-A	30	1			
			English I-B	30	1			
			English II-A	30	1			
			English II-B	30	1			
			English III	30	1			
			English III (e-learning)	30	1			
		Foreign Languages	Foreign Languages		Basic German I		60	2
					Basic German II		60	2
					Intermediate German I		30	2
					Intermediate German II		30	2
					Intermediate German III		30	2
					Intermediate German IV		30	2
					Basic French I		60	2
					Basic French II		60	2
					Intermediate French I		30	2
					Intermediate French II		30	2
					Intermediate French III		30	2
					Intermediate French IV		30	2
					Practical French I		30	2
					Practical French II		30	2
					Basic Russian I		60	2
					Basic Russian II		60	2
					Intermediate Russian I		30	2
					Intermediate Russian II		30	2
					Intermediate Russian III		30	2
					Intermediate Russian IV		30	2
					Basic Spanish I		60	2
					Basic Spanish II		60	2
					Intermediate Spanish I		30	2
					Intermediate Spanish II		30	2
					Practical Spanish I		30	2
					Practical Spanish II		30	2
					Basic Chinese I		60	2
					Basic Chinese II		60	2
					Intermediate Chinese I		30	2
					Intermediate Chinese II		30	2
		Intermediate Chinese III	30	2				
		Intermediate Chinese IV	30	2				
		Basic Korean I	60	2				
		Basic Korean II	60	2				
		Intermediate Korean I	30	2				
		Intermediate Korean II	30	2				
		Intermediate Korean III	30	2				
		Intermediate Korean IV	30	2				
		Other Languages	Other Languages		Greek I		30	2
					Greek II		30	2
					Sanskrit I		30	2
					Sanskrit II		30	2
					Latin I		30	2
					Latin II		30	2
					Italian I		30	2
					Italian II		30	2
					Czech I		30	2
					Czech II		30	2
					Arabic I		30	2
					Arabic II		30	2
					Japanese		Japanese	
Japanese B	30					1		
Japanese C	30	1						
Japanese D	30	1						
Japanese E	30	1						
Japanese F	30	1						
Japanese G	30	1						
Japanese H	30	1						
Japanese I	30	1						
Japanese J	30	1						
Basic Japanese I	120	4						
Basic Japanese II	90	3						
Intermediate Japanese	90	3						

These subjects are for international students.

These subjects are for the FGL Undergraduate Courses.

Category	Group	Subject	Total class hours	Credits	Comments	
Basics of Discipline	Basics of Humanities		30	2	The dean of each faculty shall determine annually which courses may be taken by students of other faculties as General Education Subjects.	
	Basics of Social Sciences		30	2		
	Basics of Mathematics	Linear Algebra A		30	2	
		Linear Algebra B		30	2	
		Calculus A		30	2	
		Calculus B		30	2	
		Ordinary Differential Equations		30	2	
		Complex Function Theory		30	2	
		Probability & Statistics		30	2	
	Basics of Physics	Physics A		30	2	
		Physics B		30	2	
		Physics C		30	2	
		Basic Mathematics for Physics		30	2	
	Basics of Chemistry	Chemistry A		30	2	
		Chemistry B		30	2	
		Chemistry C		30	2	
	Basics of Biology	Biology A		30	2	
		Biology B		30	2	
		Biology C		30	2	
	Basics of Earth and Space Science	Earth System Science		30	2	
		Earth Material Science		30	2	
		Geography		30	2	
		Astronomy		30	2	
Geophysics			30	2		

# ● Kawauchi Campus Map

## (1) Campus Map

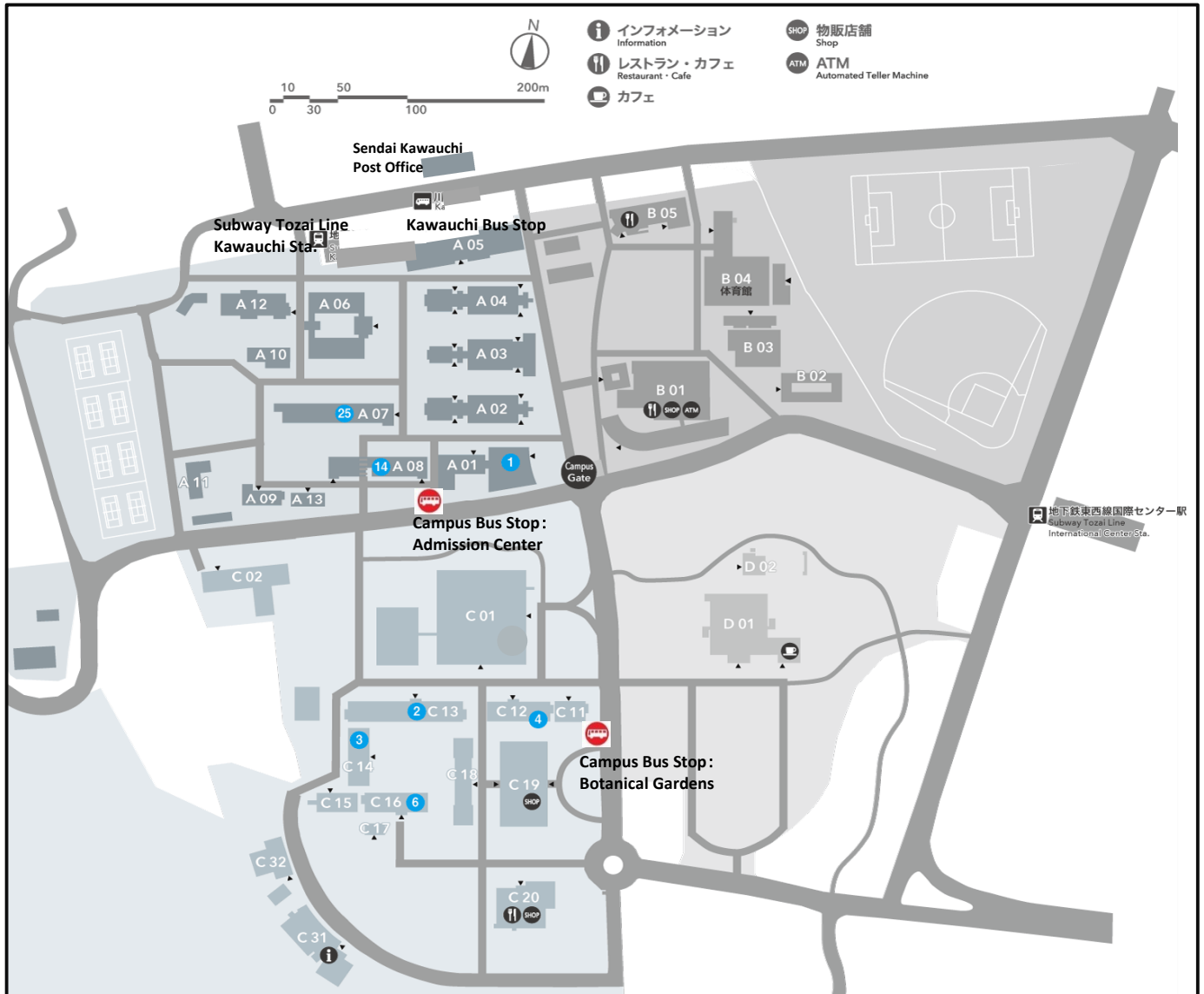

A 01	Education and Student Support Center
A 02	Lecture Rooms A
A 03	Lecture Rooms B
A 04	Lecture Rooms C
A 05	Multimedia Education and Research Complex
A 06	Student Laboratories
A 07	Center for Northeast Asian Studies, Office, Kawakita Research Forum
A 08	Graduate School of International Cultural Studies, Office
A 09	Student Health Care Center
A 10	Disability Services Office
A 12	International Exchange Building
A 13	Counseling Office
B 01	Sky KAWAUCHI Forest
B 02	Kawauchi Circle and Club Building
B 03	Kawauchi Extracurricular Activity Shared Facilities (Kawauchi Hall)
B 04	Kawauchi Gymnasium (Kawauchi Arena)
B 05	Kawauchi Sub Arena
C 01	Tohoku University Library
C 02	Admission Center
C 12	Graduate School / School of Law, Office
C 13	Graduate School / Faculty of Arts and Letters, Office
C 14	Graduate School / Faculty of Education, Office, New Humanities Building
C 16	Graduate School / Faculty of Economics and Management, Office
C 18	Lecture Rooms
C 19	Multidisciplinary Research Building, International Oasis
C 20	Welfare Facilities (Maple Park Kawauchi)
C 31	Botanical Gardens (Garden Hall)
D 01	Centennial Hall (Kawauchi Hagi Hall)

## (2) Classroom

( ) = the seating capacity

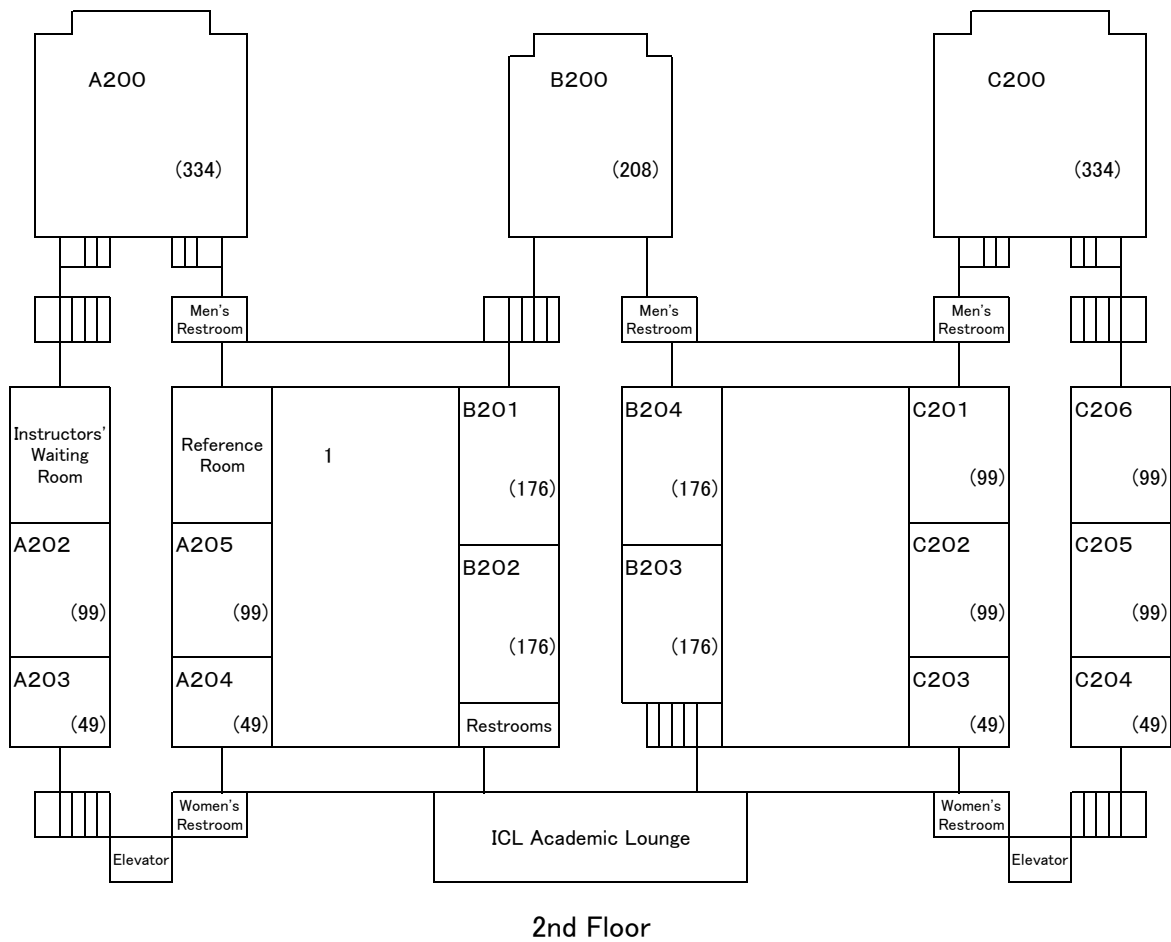
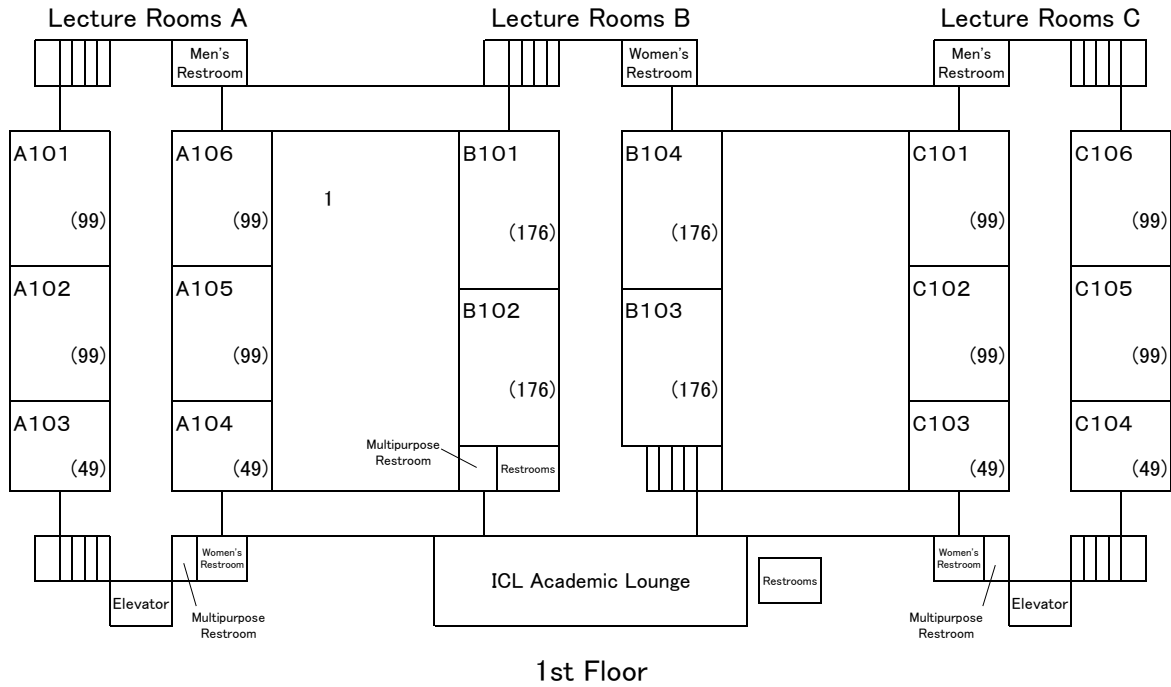

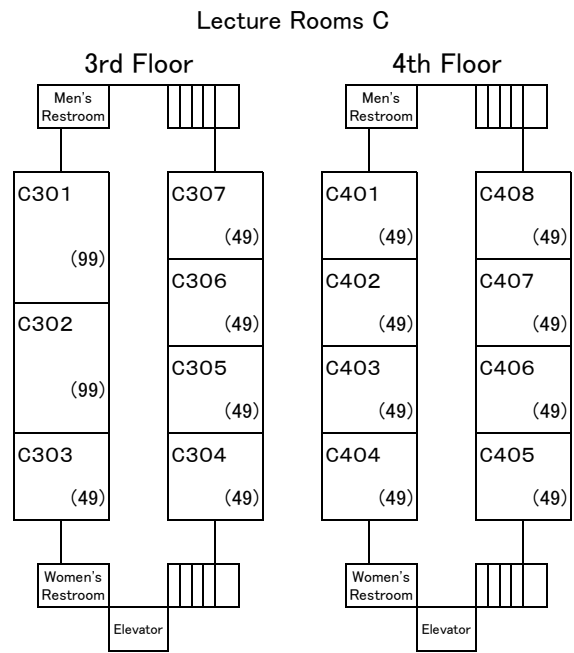
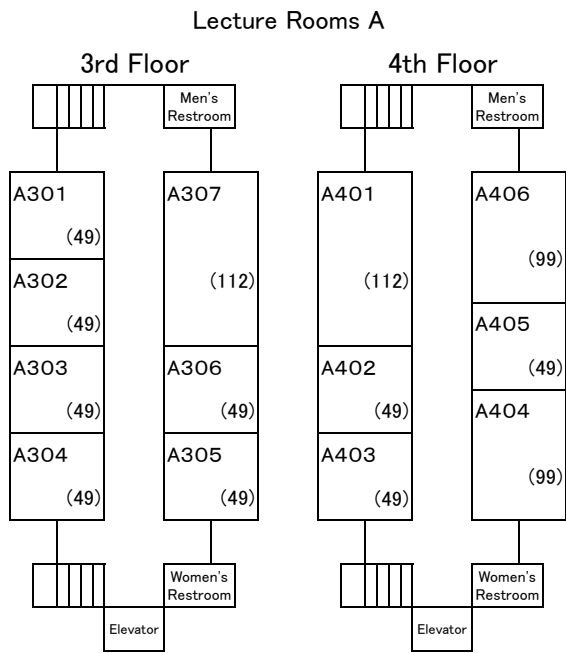

### (3) Student Laboratories

#### 1st Floor

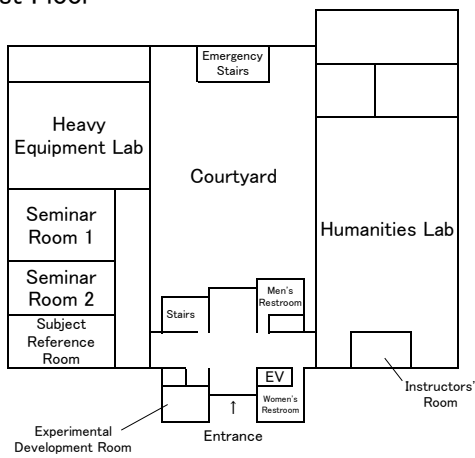

#### 2nd Floor

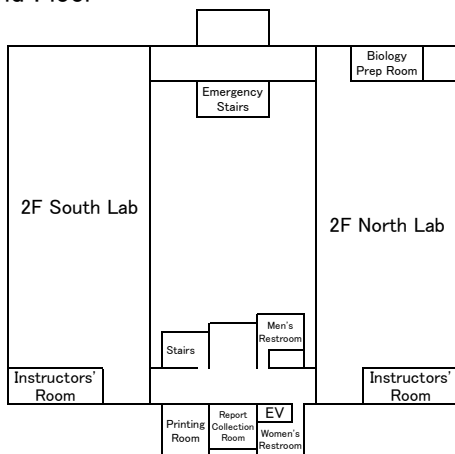

#### 3rd Floor

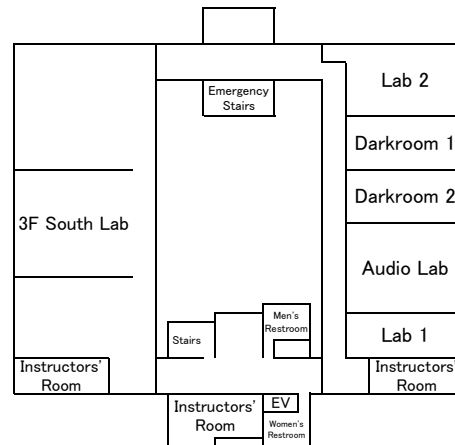

### (4) Multimedia Education and Research Complex

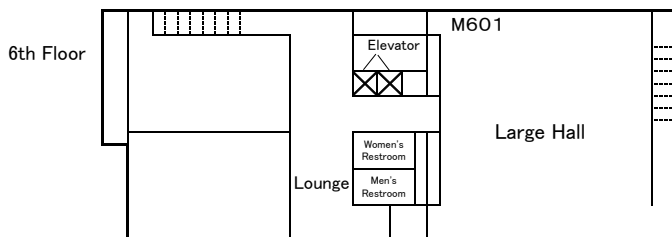
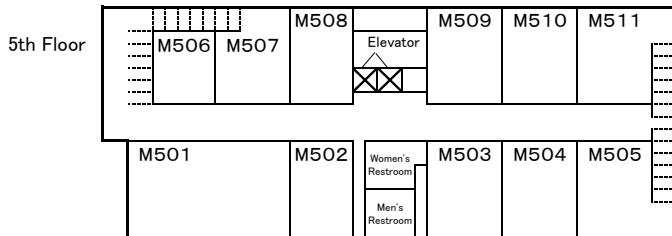
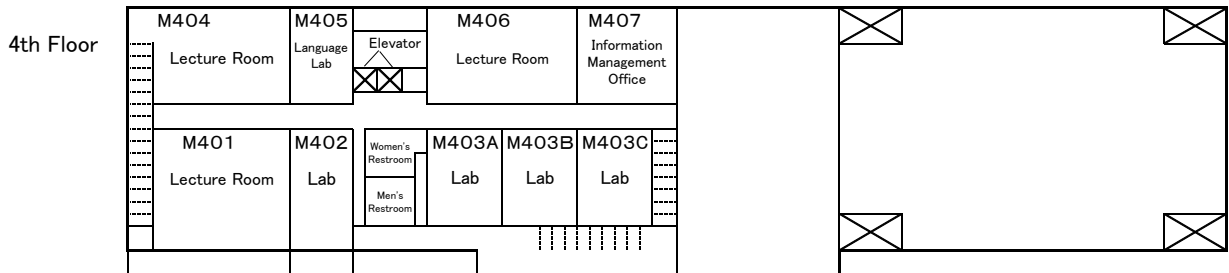
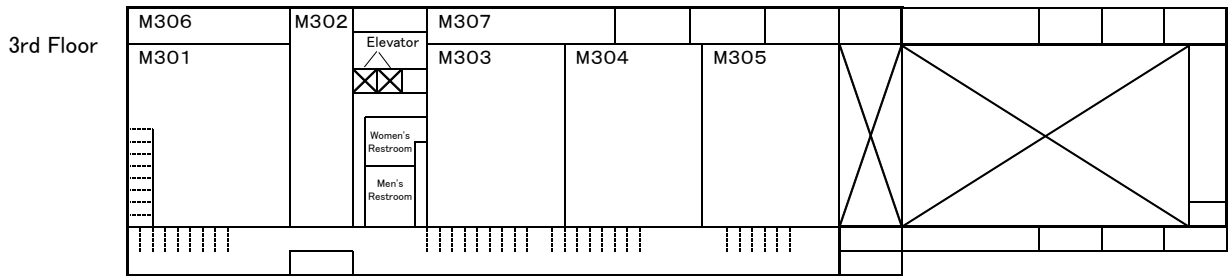
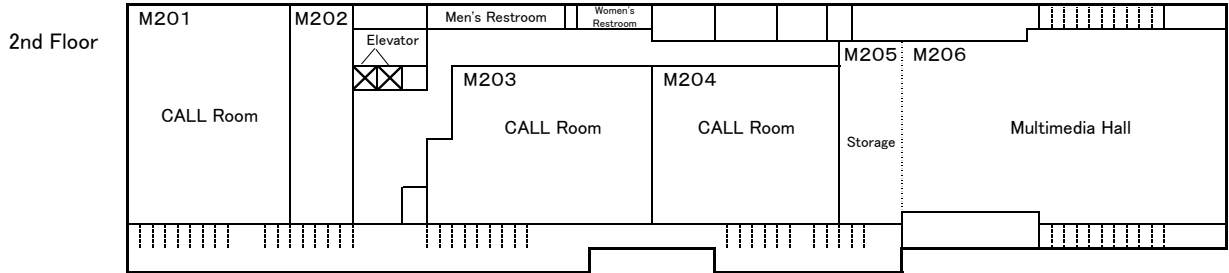
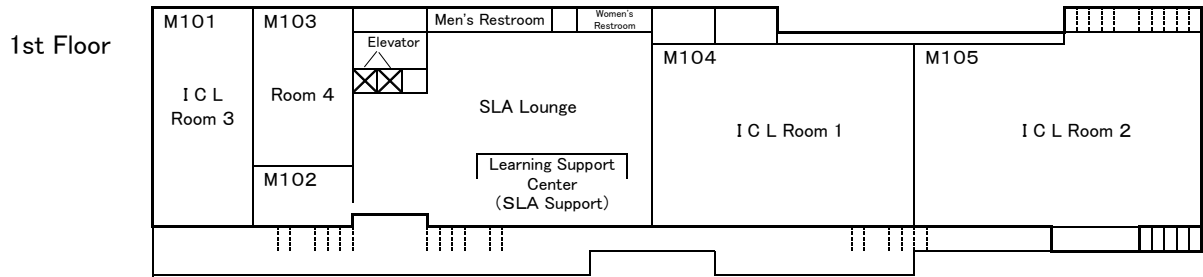

## (5) Gymnasium

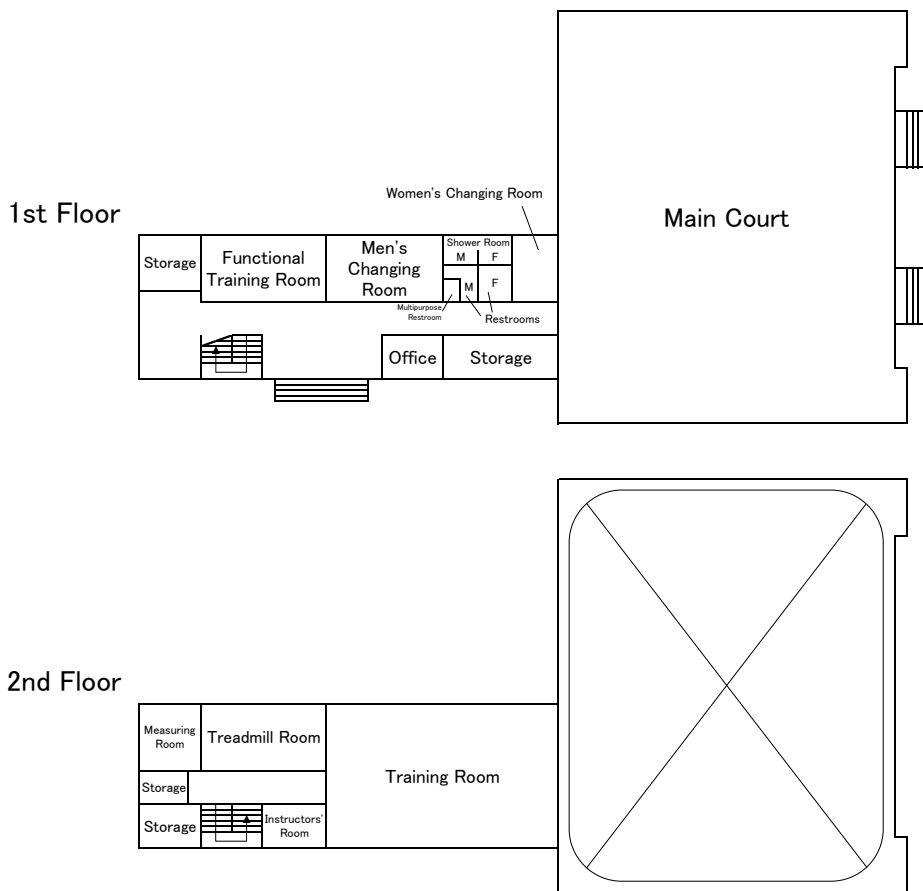

## (6) Sub Arena

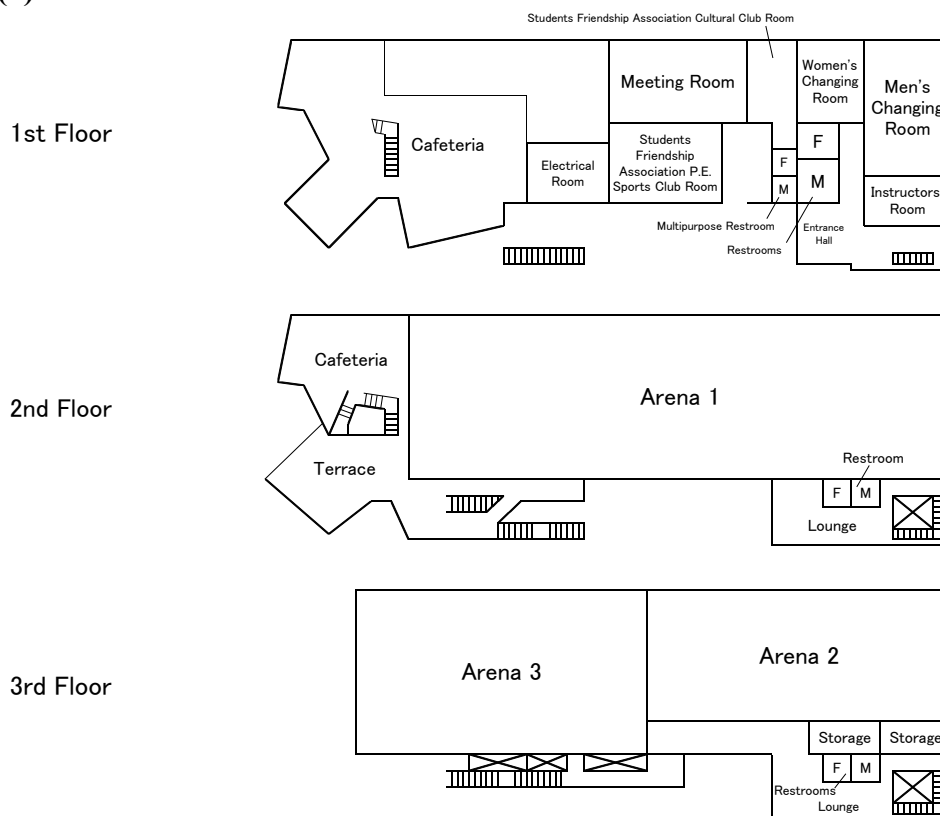

**(7) Education and Student Support Center, Student Services [A01]**

<b>Student Support Division (1<sup>st</sup> floor)</b>	
1	Support Planning Section -Lost & Found -Change of personal information (address, contact information etc.) -Thefts/crimes/accidents -Enrollment/invoicing for personal accident (Gakkensai) & liability (Inbound Futai-Gakuso) insurance -National Pension Plan
2	Activities Support Section -Circles/clubs -Equipment loan
3	Student Life Support Section -University House, dormitories
4	Financial Support Section -Waiver or deferment of entrance fee/tuition -Scholarships (for Japanese students) -Student Commuter Certificate
	International Student Help Desk
<b>Educational Affairs Division (2<sup>nd</sup> floor)</b>	
5	Educational Records and Programs Section Educational Programs Section General Education Planning Section Liberal Education Operating Section -General Education classes
<b>Student Exchange Division (2<sup>nd</sup> floor)</b>	
6-A	General Affairs Section
<b>6-B</b>	<b>-Future Global Leadership Undergraduate Courses (= FGL Office)</b> -Special curriculum (Japanese language) for international students -Scholarships (Japanese Government Scholarship, Honors Scholarship etc.)
6-C	Incoming Student Exchange Section -Incoming student exchange programs -Double Degree (Joint Education) Program (incoming)
6-D	Global Programs Section -TGL Program -Outgoing overseas programs (Study Abroad Program (SAP)/exchanges/COLABS) -English language learning -Scholarships for outgoing studies abroad
<b>Center for Career Support (3<sup>rd</sup> floor)</b>	
7	Careers Advisory Section -Counseling and information on student career paths and job-finding -Internships and part-time employment

3<sup>rd</sup> floor of the West Wing: **Global Learning Center**

### (8) International Exchange Building [A12]

The offices of professors' who teach General Education Subjects are located on the second floor of the International Exchange Building.

