



東 北 大 学

TOHOKU UNIVERSITY

September 14, 2022

**October 2022 Admission
FGL Program Undergraduate Courses
General Education Guidebook**

October 2022
Tohoku University

Table of Contents

	Page
● Academic Calendar of 2022 General Education Program.....	3
● Class Schedule of General Education Subjects.....	4
I General Education.....	5
1. Tohoku University's Admission/Diploma/Curriculum Policies for the Undergraduate Program	
2. Goals and Mission of General Education	
3. Terms & Semesters	
4. Classes & Credits	
5. General Education System	
II Registering for General Education Subjects.....	7
1. Registration Schedule	
2. Registration Group	
3. Registration Procedures	
4. Notes on Registration and Checking Grades	
5. Using Student-owned Computers for Educational Activities	
6. Campus Wi-Fi	
7. Internet School of Tohoku University (ISTU)	
8. Enrolling for Japanese Language	
III Examinations, Grading and Reports.....	11
1. Exam Schedule, Methods	
2. Notes on Examinations	
3. Makeup Examinations	
4. Grading	
5. GPA (Grade Point Average) System	
IV Introduction to Class Contents.....	13
1. Course Numbering Code	
2. Searching Syllabus Online	
1) Search by course, 2) Search by instructor, 3) Full-text search	
V General Education Class Information (FGL Program).....	20
1. List of Subjects	
2. Timetable	
VI Other.....	24
1. Medical Care Required due to Accidents in Class	
2. Using Educational Facilities	
3. Counseling Services	
4. Preventing Theft	
● Regulations on Tohoku University General Education Subjects.....	25
● Kawauchi Campus Map.....	30
1) Campus Map [Kawauchi], 2) Classroom, 3) Laboratories, 4) Multimedia Education and Research Complex, 5) Gymnasium, 6) Sub Arena, 7) Education and Student Support Center, Student Service, 8) International Exchange Building	

Academic Calendar of 2022 General Education Program

Fall Semester

Orientation for FGL Undergraduate Courses	September 27 (Tue.) at 9:00 (A101)
Entrance Ceremony Course Orientation	September 29 (Thu.) at 11:00 – 11:30 (B200) AMC orientation : 10:00-10:50 (A202) IMAC-U orientation : 13:00-14:30 (A202) AMB orientation : 10:00-10:40 (A203)
Classes in 2 nd Semester	October 3 (Mon.) – February 3 (Fri.), 2023 <3Q>October 3 (Mon.) – December 2 (Fri.), 2022 <4Q>November 28 (Mon.) – February 3 (Fri.), 2023
Class Registration by website	October 3 (Mon.) – October 14 (Fri.), 2022
Drop / Withdrawal for Class Registration	October 17 (Mon.) – October 31 (Mon.), 2022
Winter Break	December 28 (Wed.), 2022 – January 3 (Tue.), 2023
No classes due to National Center Test for University Admissions	January 13 (Fri.), 2023
Term-end Vacation	February 6 (Mon.), 2023 – late March

Class Timetable

Period	Class start/finish	Comments
1st Period	8:50 - 10:20	A chime will sound when classes start/finish.
2nd Period	10:30 - 12:00	
3rd Period	13:00 - 14:30	
4th Period	14:40 - 16:10	
5th Period	16:20 - 17:50	

2022-2023 Academic Calendar

General Education Subjects

April 2022						
Su	M	Tu	W	Th	F	Sa
					1	2
3	4	5	6	7	8	9
10	11	12	13	14	15	16
17	18	19	20	21	22	23
24	25	26	27	28	29	30

May 2022						
Su	M	Tu	W	Th	F	Sa
1	2	3	4	5	6	7
8	9	10	11	12	13	14
15	16	17	18	19	20	21
22	23	24	25	26	27	28
29	30	31				

June 2022						
Su	M	Tu	W	Th	F	Sa
			1	2	3	4
5	6	7	8	9	10	11
12	13	14	15	16	17	18
19	20	21	22	23	24	25
26	27	28	29	30		

July 2022						
Su	M	Tu	W	Th	F	Sa
					1	2
3	4	5	6	7	8	9
10	11	12	13	14	15	16
17	18	19	20	21	22	23
24	25	26	27	28	29	30
31						

August 2022						
Su	M	Tu	W	Th	F	Sa
	1	2	3	4	5	6
7	8	9	10	11	12	13
14	15	16	17	18	19	20
21	22	23	24	25	26	27
28	29	30	31			

September 2022						
Su	M	Tu	W	Th	F	Sa
				1	2	3
4	5	6	7	8	9	10
11	12	13	14	15	16	17
18	19	20	21	22	23	24
25	26	27	28	29	30	

October 2022						
Su	M	Tu	W	Th	F	Sa
						1
2	3	4	5	6	7	8
9	10	11	12	13	14	15
16	17	18	19	20	21	22
23	24	25	26	27	28	29
30	31					







November 2022						
Su	M	Tu	W	Th	F	Sa
		1	2	3	4	5
6	7	8	9	10	11	12
13	14	15	16	17	18	19
20	21	22	23	24	25	26
27	28	29	30			

December 2022						
Su	M	Tu	W	Th	F	Sa
				1	2	3
4	5	6	7	8	9	10
11	12	13	14	15	16	17
18	19	20	21	22	23	24
25	26	27	28	29	30	31

January 2023						
Su	M	Tu	W	Th	F	Sa
1	2	3	4	5	6	7
8	9	10	11	12	13	14
15	16	17	18	19	20	21
22	23	24	25	26	27	28
29	30	31				

February 2023						
Su	M	Tu	W	Th	F	Sa
			1	2	3	4
5	6	7	8	9	10	11
12	13	14	15	16	17	18
19	20	21	22	23	24	25
26	27	28				

March 2023						
Su	M	Tu	W	Th	F	Sa
			1	2	3	4
5	6	7	8	9	10	11
12	13	14	15	16	17	18
19	20	21	22	23	24	25
26	27	28	29	30	31	

-  Classes are held
-  No classes
-  Make up classes for Wednesday will be held on August 8.
-  Make up classes for Thursday will be held on August 9
-  Make up classes for Friday will be held on December 27.
-  Inservice Courses

Apr 11	First day of Spring Semester
Aug 9	Last day of Spring Semester

Oct 3	First day of Fall Semester
Oct 28 - Oct 30	University Festival - no class
Dec 28 - Jan 3	All offices are closed due to New Year's holidays
Feb 3	Last day of Fall Semester

I General Education

1. Tohoku University's Admission/Diploma/Curriculum Policies for the Undergraduate Program

○Admission Policy

Tohoku University seeks students who sympathize with the university's mission, and who possess either/both of the following:

- (1) The desire to significantly contribute as researchers by seriously addressing the issues facing 21st century human society or
- (2) The desire to significantly contribute to the development of society as high-level professionals with abundant knowledge and leadership, and the strength of will, bold academic curiosity, and fundamentally excellent academic abilities to realize this desire.

○Diploma Policy

Tohoku University confers the bachelor's degree on students who achieve the following goals.

- (1) Obtain knowledge in their specialized fields and a multifaceted perspective based on an interest in and broad knowledge of academia in general.
- (2) Obtain the education necessary to become accomplished adults, and be able to contribute to society using expertise specific to their fields of specialization.
- (3) Have the awareness and vision to assume leadership/core roles in the global community while developing fundamental abilities.

○Curriculum Policy

Tohoku University structures and implements its educational curriculum as follows to ensure that students meet the goals described in the Diploma Policy.

- (1) Offer a curriculum that creates organic links between General Education Subjects to foster broad knowledge and education, and Specialized Subjects to confer basic knowledge of specialized fields.
- (2) Following the principle of "Research First," promote the development of educational methods and establishment of educational systems while implementing active learning both in and out of class.
- (3) Develop the students' ability to learn independently by evaluating learning achievements and applying the results.

2. Goals and Mission of General Education

The goals of this university's General Education program are to foster students who possess specialized knowledge that they can use in practical society and advanced research, comprehensive, modern knowledge and deep compassion, and an international perspective. It will fulfill basic educational requirements, providing the foundations for specialized and/or graduate education, and confer the below fundamental basic abilities, knowledge, and expertise:

- 1) Basic knowledge and expertise needed for modern, international citizens to lead a social life
- 2) Basic accomplishments and skills that will provide core character-building for the modern world
- 3) Knowledge and skills related to a wide range of academic fields to aid understanding in specialized majors
- 4) Basic knowledge and skills required to study more specialized areas

To fulfill its mission, General Education has a curriculum comprising four subject categories: Foundations, Advanced Subjects, Languages, and Basics of Discipline. Each category is made up of classes arranged in subject groups, which are implemented to achieve the goals below.

Foundations	<ul style="list-style-type: none"> ▪ These subjects are comprised of Navigating Academia, Humanities, Social Sciences, Natural Sciences, Transdisciplinary Subjects. ▪ In the Navigating Academia, the basic attitude of those involved in academic research is developed through understandings of how academic research should be conducted. In the Humanities, Social Sciences, and Natural Sciences, humanities students focus on science courses, while science students focus on humanities courses, thereby creating students who are knowledgeable in both the sciences and the humanities. In the Transdisciplinary Subjects, students will not be confined to their own specialized fields, but will be exposed to a variety of fields, and will develop a foundation for the ability to solve problems through collaboration with people from various fields.
Advanced Subjects	<ul style="list-style-type: none"> ▪ This group is composed of subjects dealing with Contemporary Competencies, and

	<p>Cutting Edge Subjects.</p> <ul style="list-style-type: none"> Contemporary Competencies provide the knowledge/skills required of educated persons in the modern context, and foster the habit of taking ownership over problems that require global effort to solve. Cutting Edge Subjects stimulate awareness of what it means to study at a comprehensive research university and motivate academic research by providing contact with cutting edge scholarship, regardless of field.
Languages	<ul style="list-style-type: none"> This category is composed of the Foreign Languages and Japanese groups. It fosters language abilities and intercultural understanding necessary for modern/international/educated persons. It also aims to provide the English skills necessary for academic objectives, basic multilingual competence in the students' first and second foreign languages, and basic Japanese competence for international students.
Basics of Discipline	<ul style="list-style-type: none"> This category is composed of the Basic Humanities, Basic Social Sciences, Basic Mathematics, Basic Physics, Basic Chemistry, Basic Biology, and Basic Earth and Space Science groups. It is connected to the major fields of the undergraduate departments, and provides basic knowledge/skills needed for the relevant major.

3. Terms & Semesters

Tohoku University uses a two-semester system, with the period of April 1 to September 30 defined as first semester, and October 1 to March 31 as second semester. The semester comprises the basic unit of the education curriculum; General Education lasts from the 2nd to 4th semesters. **FGL Students will begin classes from the 2nd Semester.**

1st Year	2nd Year				3rd & 4th Year
Fall	Spring		Fall		5th – 8 th /9 th Semester
2nd Semester	3rd Semester		4th Semester		
	1st Quarter	2nd Quarter	3rd Quarter	4th Quarter	

4. Classes & Credits

Each class is held 15 times (weeks) per semester, and consists of lectures, seminars, experiments, laboratory work, skill tests, or some combination of these. Some classes may be implemented in intensive lectures. The number of credits reflects the amount of academic work performed, with one credit requiring 45 hours of study. General Education subjects confer two credits in consideration of the methods used in class, educational effect, and amount of study required outside of class, as indicated below.

Class Format	Hours of Class	Content of Study
Lectures	30 hrs.	Students take 15 ninety-minute classes, a course of four-hour lectures, a 2-4 hour seminar, experiments, laboratory work, and skill tests, requiring 2 hours per class of preparation/review.
Seminars	30 - 60 hrs.	
Experiments, Laboratory Work, Skill Tests	60 - 90 hrs.	

General Education also uses different class format such as below.

- International Coeducational Seminar: "International Coeducation" fosters an attitude of acceptance and understanding for diversity among students of varying languages and cultures through collaborative group work and projects. It provides learning experiences that make students reexamine their own values and build new ones. International Coeducational Seminars provide these learning opportunities in a small-group seminar format.

5. General Education System

General Education is for all students at the university. The Academic Affairs Council, which is composed of educators from every department, is responsible for planning and operating its subject categories and groups and performs overall coordination and supervision. The Institute for Excellence in Higher Education (IEHE) also provides support for its university-wide system. The IEHE was founded in April 2014 by merging five independent educational organizations at Tohoku University in order to implement advanced liberal arts education and provide a higher level of student support. Instructors from each department of the faculties, graduate schools, research institutes/centers, and the university hospital are responsible for General Education classes, and take part in a supportive, cooperative university-wide class-management system to provide students an educational foundation with a broad perspective.

II Registering for General Education Subjects

1. Registration Schedule

Students must register for classes in compliance with rules on required subjects (subjects which students must take), recommended subjects (classes that students are urged to take) and registration prerequisites (in cases where students cannot register for one class unless they have already completed another class) as per the student handbook for their faculty, class timetables, and this guidebook.

The number of General Education subjects that are taught in English and open to Future Global Leadership Undergraduate Courses students is limited, so FGL students should register as per the Class Timetable for the FGL Courses.

Notes on General Education subjects Registration

- Classes that are not designated by your faculty's Student Guide will not be credited towards graduation requirements.
- Please register for classes in the appropriate semester, as listed in your faculty's Student Handbook. You cannot register for a class before the appropriate semester (advanced registration) as designated by the faculty (department/division).
- Students cannot register for two subjects with the same subject name, even if the topics, instructors, semester, and day/time of the two subjects are different. The same applies to taking a subject with the same name as one for which the student has already received credit.

2. Registration Group

- ① As class schedules are drawn up with consideration for class sizes in each faculty/year/division, in general you must register within groups created for your own faculty (own division). In principle, you cannot register for classes in groups other than those created for your own faculty (i.e. in other divisions).
- ② Even in classes held for your own faculty, groups are sometimes further subdivided by Student ID Number.
- ③ For classes outside your division, it is possible that you will not be given permission to register due to the class content or class size.

3. Registration Procedures

- 1) In order to register for classes (and receive credits), it is necessary to complete the registration procedures. If you do not complete these procedures, you will not be able to receive credit.
- 2) The registration procedures are Web-based. In general, the classes you enter cannot be changed except during the Web-based registration confirmation/revision period. During this period, please check your registration details online, and make any necessary changes at the Student Affairs Division.
- 3) Web-based registration is performed separately for each semester. You can also check your grades and credits online.
- 4) You should inquire at the FGL office when registering for classes outside your division.

4. Notes on Registration and Checking Grades

(1) Web-based registration, confirmation/revision period

Fall semester: October 3 (Mon.) – October 14 (Fri.)

- ① In order to take courses (receive credit), you need to complete registration. **If you do not undergo Web-based registration, you will not receive credit for classes even if you attend the lectures and take the exams.**
 - ② Course registration will be conducted via the Student Affairs Information System website during the above period per semester.
Student Affairs Information System: <https://www.srp.tohoku.ac.jp/>
*Operation Manual is available from the following website.
https://www.srp.tohoku.ac.jp/gkms/manual/img/manual_students_en.pdf
- 
- *It requires a Tohoku University ID and password to perform Web-based registration.
 - *The server will receive heavy access on the final day of registration, so try to finish registering your classes before then.
 - *Remember that “Google Classroom” is not official class registration. Please be sure to register both. So does canceling classes.
- ③ Be sure to click the "Confirm Entry" button on the Web-based registration page.
*After registering, you can make changes as many times as needed until the end of this registration period.
 - ④ After the deadline, it is unable to change registration. Please confirm your registration carefully in advance.
 - ⑤ Please be sure to register and confirm your course registration as early as possible, as the system connection may not always be successful due to heavy access on the deadline.

(2) Procedures for deregistering classes

Fall semester: October 17 (Mon.) – October 31 (Mon.)

- ① If you wish to "deregister" a class for which you have finalized registration, you must ask the course instructor to get approval by email and submit class cancellation form during the designated period above.
Use DC Mail account when you send an e-mail to the instructor as your identification.
*Class cancellation form will be informed by Academic Affairs Division in advance.
- ② **If you perform the required procedures, you will not be graded for that class, and your grades will show an "E" (deregistered) instead.**
- ③ By registering for a class, you commit to taking that class and being graded on it. **If you abandon a class before completing it, you will receive a D grade (Fail).**

(3) Confirming grades

Fall semester: will be announced on February 15 (Wed.)

- ① Please confirm your grades online using the "Grades Inquiry" screen via Student Affairs Information System. If you set a "Private key for the SRP image-matrix authentication" from the campus network, you will be able to check your grades from off-campus using the SRP. (For details, see: <https://www.dc.tohoku.ac.jp/guide/srp/srp-e.html>)
- ② For details on grading, please see "III Examinations, Grading and Reports."

5. Using Student-owned Computers for Educational Activities

For some time, Tohoku University has used CALL materials for foreign language education and learning management, and we encourage students to use their own laptop computers for educational purposes in order to improve the educational reach of the ICT-based on-demand lectures we offer. Please check the General Education class syllabi to see whether your classes require a computer.

6. Campus Wi-Fi

All campuses have Wi-Fi access points in key locations for wireless Internet service (via eduroam). For connection instructions and other details, please refer to "Online Guide: Information Services for Education in Tohoku University" (<https://www.dc.tohoku.ac.jp/guide/wifi/wifi-e.html>).



7. Internet School of Tohoku University (ISTU)

ISTU is a web service that can be accessed with your Tohoku University ID and password to obtain educational/study support over the Internet. You can use it to access class materials etc. distributed by your instructors as digital files and digital content in a variety of formats, including streaming video, to further your studies.

The service offers various educational/learning features, such as submitting reports as digital files, implementing comprehension tests, sending announcements from the instructor to students, and conducting discussions on online forums.

To learn more about ISTU, please refer to "Online Guide: Information Services for Education in Tohoku University." (<https://www.dc.tohoku.ac.jp/guide/istu/istu4g-e.html>)



8. Enrolling for Japanese Language

Students on the FGL Courses are required to take 10 credits of Japanese language. Students who have taken the "Japanese Language Proficiency Test" or the "Examination for Japanese University Admission for International Students" and met certain conditions, specified elsewhere, may apply to have their test results recognized in place of coursework, and receive up to seven of the required 10 Japanese language credits.

International students at this university who have obtained a designated number of points on Japanese language tests etc. shall be considered to have completed a Japanese language class, and shall be awarded a predetermined number of credits upon application.

Agreement on Credit Awards for Japanese Language Tests etc. Academic Affairs Council January 5, 2011

1. As per Articles 26-6 and 26-7 of the Tohoku University Faculty Regulations, and as elsewhere stipulated by the Minister of Education, Culture, Sports, Science and Technology, students who have obtained the specified number of points on the Japanese language tests etc., and students for whom it is recognized to be educationally beneficial by their faculty, shall be considered by this University to have completed a Japanese language class, and shall be awarded credits, as stipulated by the rules of their faculty.
2. Faculties that may approve these credits are as follows.
Faculty of Science, School of Engineering, Faculty of Agriculture (students belonging to Future Global Leadership Undergraduate Courses)
3. Foreign language subjects for which these credits can be awarded are as follows.
Japanese
4. Japanese language tests for which credits can be awarded, criterion for recognition, and number of credits are as follows.
Subject: Japanese
Name of Test:
 - i) Japanese Language Proficiency Test—JLPT (Japan Educational Exchanges and Services)
 - ii) Examination for Japanese University Admission for International Students—EJU (Japan Student Services Organization)

Criterion and Number of Credits:

Criterion	Number of Credits	Score	Subject
JLPT N3 or higher	7	AA	Basic Japanese I(4 Credits)
		AA	Basic Japanese II(3 credits)
		AA	Intermediate Japanese(3 credits)
JLPT N4	7	AA	Basic Japanese I(4 Credits)
		AA	Basic Japanese II(3 credits)
JLPT N5	4	AA	Basic Japanese I(4 Credits)
EJU 220 points or higher (Not including Writing)	7	AA	Basic Japanese I(4 Credits)
		AA	Basic Japanese II(3 credits)
		AA	Intermediate Japanese(3 credits)
EJU 200 points or higher (Not including Writing)	7	AA	Basic Japanese I(4 Credits)
		AA	Basic Japanese II(3 credits)

5. Application Instructions
 - i) Documents required for the application are the application form and a copy of the test certificate or score sheet.
 - ii) The date entered on the test certificate or score sheet must be less than two years prior to the date of application.
6. Certification Procedure
 - i) Certification of credits will be performed by the Japanese Language Committee of the Academic Affairs Council (hereafter, Japanese Language Committee) based on a copy of the test certificate or score sheet.
 - ii) Results of screenings by the Japanese Language Committee will be reported to the Educational Records and Programs Committee of the Academic Affairs Council.
 - iii) Credits for applications submitted before the end of January or the end of June will be certified the same semester; credits for applications submitted after February 1 or July 1 will be certified the following semester
7. Any items necessary for credit certification, other than those specified in this agreement, will be specified by the Japanese Language Committee.

Enacted on January 5, 2011 (enforced on October 1, 2011)
Revised on January 31, 2022 (enforced on April 1, 2022)

*Japanese class; Intermediate Japanese (3 credits)

Students who feel that the class does not match their Japanese abilities may instead select 3 subjects (3 credits) from the General Education Japanese A-J classes (1 credit each; aimed at advanced JLPT N1-level students). These subjects are held for privately financed international students belonging to degree courses taught in Japanese.

If you wish to do this, speak to your Japanese language instructor in advance to confirm that your abilities will be sufficient before registering. Inquire with the FGL staff in the Student Exchange Division or General Education Operating Section in the Educational Affairs Division for the Japanese A-J timetable.

III Examinations, Grading and Reports

1. Exam Schedule, Methods

Examinations will be conducted by class instructors during the course. Please follow your instructor's directions when taking examinations. Information on examinations may sometimes be announced on bulletin board so please check them carefully.

Grading methods for each subject are described in the syllabus.

2. Notes on Examinations

Please observe the following when taking examinations. Engaging in misconduct, such as using unauthorized textbooks, dictionaries, reference materials, notes, memos etc., looking at other students' answers, or exchanging answers during the examination will be severely punished (**indefinite suspension etc.**) as a violation of student regulations. **Do not, under any circumstance, engage in such activities.**

- (1) Follow the instructions given by the supervising instructor in the examination room.
- (2) In the examination room, fill seats from the front of the room, and place your Student ID on your desk during the examination.
- (3) Do not place anything else on your desk except writing utensils and other items explicitly permitted by the supervising instructor. (Confirm in advance whether notes/references can be used.)
- (4) If you require a desk mat/underlay when writing, ask for permission from the supervising instructor.

3. Makeup Examinations

If you are unable to take an examination due to illness, accident, or bereavement (loss of an immediate family member), you can apply through the Student Affairs Division to take a makeup examination for up to three days after the end of the relevant examination, excluding Saturdays, Sundays, and national holidays. The following documents are required.

- For illness: Doctor's diagnosis
- For accidents: Accident Report Form
- For bereavement: Corroborating documentation

4. Grading

Grading is described in the syllabus for each subject.

However, grading for General Education subjects is handled as follows.

(Grading)

1. Grading for General Education subjects is as follows.

Grade	Description of Evaluation	Criteria for Points (out of 100)
AA	The student's performance was particularly exceptional.	90 – 100 points
A	The student's performance was excellent.	80 – 89 points
B	The student's performance was above average.	70 – 79 points
C	The student passed.	60 – 69 points.
D	The student failed or quit the class.	59 points or below
E	The student deregistered as per the proscribed procedures.	—

Comments

- 1) Grading and evaluation will take into account examination performance, reports submitted, attendance, and registration status.
 - 2) The "AA" grade was implemented for incoming students in the 2004 academic year onward; for students who enrolled prior to 2004, there is no distinction between the "AA" and "A" grades.
 - 3) The grade designated as "E" will be given under the following conditions.
 - a) If the student deregisters at the Student Affairs Division during a designated period.
 - b) The student takes a leave of absence, or withdraws, from the university
 - 4) This grading system is effective as of the subjects taught in the 2013 academic year onward.
2. The syllabus will provide descriptions of educational goals (academic achievement goals) and specific evaluation methods for each subject; in general, absolute evaluations will be based on the correspondence of student performance with the educational goals set for each subject.
3. Class instructors shall store student examination answer sheets for one year from the date of the examination, and reports, etc. for one year from their due date, to serve as a basis for grading and to respond to any requests for information disclosure from students. However, this requirement does not apply to reports that are returned to the students with grades/comments; in the case of examination answer

sheets, it is recommended that the instructor store the original and return a copy. (Reference: Tohoku University Criteria on Length of Storage Period for Documents: One year or less for examination answer sheets and reports.)

(Accepting questions)

4. Students can receive an explanation of the grade evaluation from the class instructor of the class by requesting it to the Academic Affairs Division only within a designated period of time following the announcement of grades. However, if a student is unable, for legitimate reasons, to make this request during that period, the student can receive an explanation at a later time, as long as it is within the one-year storage period.

(Complaint)

5. If the student is unsatisfied with the grade, the student can file a petition with the chairperson of the Educational Records and Programs Committee of the Academic Affairs Council (hereafter "Educational Records and Programs Committee"), through the Academic Affairs Division only within a specified period. However, if a student is unable, for legitimate reasons, to make this request during that period, the student can file a petition at a later time, as long as it is within the one-year storage period.

6. Upon receiving a petition of dissatisfaction, the Educational Records and Programs Committee shall set up a subcommittee, composed of several members to investigate its validity.

(Publication of Grading)

7. The Grading Improvement Committee of the Academic Affairs Council shall compile and analyze grades and release their findings to the class instructors and students.

* Designated period is within two weeks after the announcement of grades.

* A petition of dissatisfaction should be filed when the student is still unsatisfied after hearing the class instructor's explanation regarding the grade, not when the student who failed the class wishes to take a makeup exam. Students should not visit instructor's office without an appointment.

5. GPA (Grade Point Average) System

In FY 2016, the GPA system was adopted by Tohoku University to increase the students' academic motivation, contribute to the provision of appropriate learning guidance, promote rigorous grade evaluation, and improve the quality of learning. The GPA system will be applied to undergraduate curriculum students who enter in FY 2016 and later.

Discretion on how to utilize GPA is left up to the individual faculties.

➤ Grades and GP

Grade Points (GP) will be assigned in accordance with each faculty's regulations, faculty-specific regulations on registration, and the regulations on General Education, as per the following table.

Evaluation		GP
Letter Grade	Score	
AA	100-90	4.0
A	89-80	3.0
B	79-70	2.0
C	69-60	1.0
D	59-0	0.0

➤ GPA Categories and Calculation Method

Tohoku University has two types of GPA: one that indicates learning progress and achievements for the relevant semester (hereafter "semester GPA"), and one that indicates learning progress and achievements for the entire period of enrollment at the university (hereafter "cumulative GPA").

The semester and cumulative GPAs will be calculated with the below formulas, and the resulting numbers rounded to the 3rd decimal place.

$$\text{Semester GPA} = \frac{\text{Total of (GP for each class evaluated for the semester} \times \text{the number of credits for relevant classes)}}{\text{Total credits for the classes evaluated for the semester}}$$

$$\text{Cumulative GPA} = \frac{\text{Total of (GP for each class evaluated during the entire enrollment period} \times \text{the number of credits for relevant classes)}}{\text{Total credits for the classes evaluated for the entire enrollment period}}$$

➤ **Classes Affecting GPA**

The below classes will be excluded from the student's semester and cumulative GPAs.

- 1) Classes for which the student has, by the prescribed date, applied, and received permission, to deregister.
- 2) Classes designated by the Chairperson of the Academic Affairs Council, or the Faculty Dean or Department Director.

IV Introduction to Class Contents

1. Course Numbering Code

A) Course Numbering

Course Numbering is a system in which codes indicating a variety of information of each class, such as subject category and levels of difficulty, to clarify the curriculum structure.

By assigning codes and numbers to each class has a unique code to clarify its difficulty level/characteristics, significance, and the sequence in which courses should be taken, students can understand which classes they should register for, the role of each class within the undergraduate/graduate curriculum, and each course's objectives.

Also, clarifying course levels is expected to facilitate credit transfers with overseas universities.

B) Coding Method

Course Numbering at Tohoku University is organized as follows.

In general, the codes will be fixed for each class instead of being reassigned every academic year. However, codes may be reassigned in some cases, such as when there are major revisions to the class content.

a) Example of Course Numbering Code

A BC - (hyphen) DEF 1 23 G
 ①② ③ ④ ⑤ ⑥

b) Meanings of Each Segment of the Code:

- ① Hosting Faculty/School
- ② Department/Major (for General Education etc., subject category/group)
- ③ Academic Field
- ④ Level/Characteristics
- ⑤ Classification Number
- ⑥ Language Used in Class

c) List of Each Segment Code

① List of Hosting Faculty/School Codes (single letter)

These codes are the same as the letter that indicates the student's faculty/graduate school, shown as the third letter of the student ID number; General Education Subjects (faculty code: Z) and Teacher Training Subjects (faculty code: Q) were assigned letters not already in use.

Faculty/Graduate School	Faculty Code
Faculty of Science/Graduate School of Science	S
School of Engineering/Graduate School of Engineering	T
Faculty of Agriculture/Graduate School of Agricultural Science	A

Faculty/Graduate School	Faculty Code
General Education Subjects	Z
Teacher Training Subjects	Q

② List of Department/Major Codes (two letters) *Those for only General Education are shown here.

General Education	Foundations	Navigating Academia	FA
		Humanities	FH
		Social Sciences	FS
		Natural Sciences	FN
		Transdisciplinary Subjects	FT
	Advanced Subjects	Contemporary Competencies	AC
		Cutting Edge Subjects	AE
	Languages	Foreign Languages	LF
		Japanese	LJ

Basics of Discipline	Basics of Humanities	DU
	Basics of Social Sciences	DO
	Basics of Mathematics	DM
	Basics of Physics	DP
	Basics of Chemistry	DC
	Basics of Biology	DB
	Basics of Earth and Space Science	DE
Teacher Training Subjects		TL

③ Academic Field Codes (three letters)

As shown in "III Course Numbering for General Education"

④ List of Levels/Characteristic Codes (one number) *only General Education is shown here

Class Type/Group/Subject			Code
Foundations	Navigating Academia	Introduction to Academic Learning, Seminar on Each Discipline for Academic Learning	1
		Advanced General Education Course	2
	Humanities, Social Sciences, Natural Sciences		1
	Transdisciplinary Subjects	Integrated Experiments of Science, Health & Sports (Sports), Health & Sports (Lecture)	1
		Other than above	8
Advanced Subjects	Contemporary Competencies (Information Science and Technology Education)	Information and Data Literacy	1
	Contemporary Competencies (Subjects related to study abroad and internships)		9
	Other than above		8
Languages	Foreign Languages (English)	English I-A, I-B, II-A, II-B	1
		English III, III (e-learning)	2
	Foreign Languages (Languages for Multilinguality)	Basic *** (Language) I, II	1
		Intermediate *** (Language) I, II, III, IV, Practical *** (Language) I, II	2
	Other than above		1
Basics of Discipline			1
Teacher Training Subjects			1

⑤ Classification Number (two numbers)

Classification Numbers are assigned for Course Numbering administration purposes; they are not sequential.

⑥ Codes for Language Used in Class (one letter)

Languages used in classes will be coded as follows.

Language Used	Code
Japanese	J
English	E
Non-English foreign languages	F
Two or more languages	B

These codes will be assigned per class instructor, in accordance with the syllabus for the relevant academic year.

(Ex.)

General Education Subject "Foundation of Calculus" taught by Professor XX (Japanese) ZDN-MAT104J

General Education Subject "Foundation of Calculus" taught by Associate Professor YY (English) ZDN-MAT104E

2. Searching Syllabus Online

Course syllabi can be viewed in the Student Affairs Information System. It requires your Tohoku University ID and password to log into the system. While syllabi may additionally be viewed in other locations such as the university websites and the QuickSyllabus, the posting in the Student Affairs Information System is the most up-to-date information.

The Student Affairs Information System:

PC, smartphone: <https://www.srp.tohoku.ac.jp/>

Top Page *These images are the ones as of February 2019. They may differ from the actual pages.

Requires Tohoku University ID and password to log in. Contact the FGL Office if you have any questions.
For more information on image-matrix authentication, please refer to the online guide (<https://www.dc.tohoku.ac.jp/guide/srp/srp.html>).

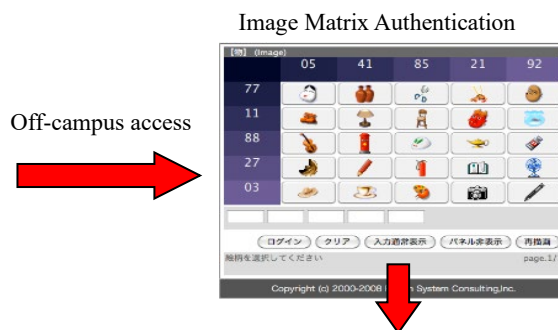

Change the language to English.

コンテンツ名	横幅	横位置	縦位置	幅可変
講義のお知らせ			2	<input checked="" type="checkbox"/>
お知らせ表示(全体)			1	<input checked="" type="checkbox"/>
お知らせ表示(個人宛)			2	<input checked="" type="checkbox"/>
スケジュール表示(日)			1	<input checked="" type="checkbox"/>
スケジュール表示(週間)	3	0	0	<input type="checkbox"/>

After selecting "English", click the button "更新 (update)". To change the language, you are required to log out, and then log in again. Click “ログアウト (log out)” on the top right.

言語設定

言語 Japanese English

推奨設定に戻す クリア 更新

- キャビネット一覧
- 個人種別選択
- パスワード設定
- 配置/言語設定
- オフラインメール

リンク

- センター
- 教育系情報システム
- 全学教育シラバス

Online syllabus search

HOME | School Affairs | Courses/Grades | Student Services | Job-search Support | **Syllabus** <<Usage Time 7:00>>

Search from Course

Search Condition

Search by selecting school year to search a syllabus and specifying each search conditions

Selection screen for the types of search will be displayed on the right:

- Search from Course
- Search by Instructor
- Search Entire Text
- Online Manual

School Year	2022	School Year					
Curriculum	--Not Selectd--	<input type="checkbox"/> Exc					
Field and Category	--Not Selectd--	(If you want to specify a field and category, you must select Curriculum.)					
Target Grade	--Not Selectd--	(If you want to specify a target grade, you must select curriculum.)					
Course Name	<input type="text"/>						
Instructor in Charge	<input type="text"/>						
Class Starting Time	--Not Selectd--						
	Mon	Tue	Wed	Thu	Fri	Sat	Other
1	<input type="checkbox"/>	<input type="checkbox"/>	<input type="checkbox"/>	<input type="checkbox"/>	<input type="checkbox"/>	<input type="checkbox"/>	<input type="checkbox"/>
1(First half)	<input type="checkbox"/>	<input type="checkbox"/>	<input type="checkbox"/>	<input type="checkbox"/>	<input type="checkbox"/>	<input type="checkbox"/>	<input type="checkbox"/>
1(Second half)	<input type="checkbox"/>	<input type="checkbox"/>	<input type="checkbox"/>	<input type="checkbox"/>	<input type="checkbox"/>	<input type="checkbox"/>	<input type="checkbox"/>
2	<input type="checkbox"/>	<input type="checkbox"/>	<input type="checkbox"/>	<input type="checkbox"/>	<input type="checkbox"/>	<input type="checkbox"/>	<input type="checkbox"/>
2(First half)	<input type="checkbox"/>	<input type="checkbox"/>	<input type="checkbox"/>	<input type="checkbox"/>	<input type="checkbox"/>	<input type="checkbox"/>	<input type="checkbox"/>
2(Second half)	<input type="checkbox"/>	<input type="checkbox"/>	<input type="checkbox"/>	<input type="checkbox"/>	<input type="checkbox"/>	<input type="checkbox"/>	<input type="checkbox"/>

(1) Search by Course

When planning registration this allows you to efficiently check the timetable, search for only subjects for which you are eligible to register, and browse them by day/class time. Use “Search from Course” to do this.

Search from Course

Search Condition

Search by selecting school year to search a syllabus and specifying each search conditions

Search Syllabus

School Year	2022▼ School Year																																																																																																																
Curriculum	--Not Selectd-- <input type="checkbox"/> Excluding Other Department																																																																																																																
Field and Category	--Not Selectd-- ▼ <small>(If you want to specify a field and category, you must select Curriculum.)</small>																																																																																																																
Target Year	--Not Selectd-- ▼ <small>(If you want to specify a target grade, you must select curriculum.)</small>																																																																																																																
Course Name	<input type="text"/>																																																																																																																
Instructor in Charge	<input type="text"/>																																																																																																																
Class Starting Time	--Not Selectd-- ▼																																																																																																																
Subject Numbering	<input type="text"/> P																																																																																																																
Faculty	--Not Selectd--																																																																																																																
Department	--Not Selectd-- ▼																																																																																																																
Academic Disciplines	--Not Selectd-- ▼																																																																																																																
Level	--Not Selectd-- ▼																																																																																																																
Used Language	--Not Selectd-- ▼																																																																																																																
Class Period	<table border="1" style="width: 100%; border-collapse: collapse; text-align: center;"> <thead> <tr> <th></th> <th>Mon</th> <th>Tue</th> <th>Wed</th> <th>Thu</th> <th>Fri</th> <th>Sat</th> <th>Other</th> </tr> </thead> <tbody> <tr> <td>1</td> <td><input type="checkbox"/></td> <td><input type="checkbox"/></td> <td><input type="checkbox"/></td> <td><input type="checkbox"/></td> <td><input type="checkbox"/></td> <td><input type="checkbox"/></td> <td><input type="checkbox"/></td> </tr> <tr> <td>4(Second half)</td> <td><input type="checkbox"/></td> <td><input type="checkbox"/></td> <td><input type="checkbox"/></td> <td><input type="checkbox"/></td> <td><input type="checkbox"/></td> <td><input type="checkbox"/></td> <td><input type="checkbox"/></td> </tr> <tr> <td>5</td> <td><input type="checkbox"/></td> <td><input type="checkbox"/></td> <td><input type="checkbox"/></td> <td><input type="checkbox"/></td> <td><input type="checkbox"/></td> <td><input type="checkbox"/></td> <td><input type="checkbox"/></td> </tr> <tr> <td>5(First half)</td> <td><input type="checkbox"/></td> <td><input type="checkbox"/></td> <td><input type="checkbox"/></td> <td><input type="checkbox"/></td> <td><input type="checkbox"/></td> <td><input type="checkbox"/></td> <td><input type="checkbox"/></td> </tr> <tr> <td>5(Second half)</td> <td><input type="checkbox"/></td> <td><input type="checkbox"/></td> <td><input type="checkbox"/></td> <td><input type="checkbox"/></td> <td><input type="checkbox"/></td> <td><input type="checkbox"/></td> <td><input type="checkbox"/></td> </tr> <tr> <td>6</td> <td><input type="checkbox"/></td> <td><input type="checkbox"/></td> <td><input type="checkbox"/></td> <td><input type="checkbox"/></td> <td><input type="checkbox"/></td> <td><input type="checkbox"/></td> <td><input type="checkbox"/></td> </tr> <tr> <td>6(First half)</td> <td><input type="checkbox"/></td> <td><input type="checkbox"/></td> <td><input type="checkbox"/></td> <td><input type="checkbox"/></td> <td><input type="checkbox"/></td> <td><input type="checkbox"/></td> <td><input type="checkbox"/></td> </tr> <tr> <td>6(Second half)</td> <td><input type="checkbox"/></td> <td><input type="checkbox"/></td> <td><input type="checkbox"/></td> <td><input type="checkbox"/></td> <td><input type="checkbox"/></td> <td><input type="checkbox"/></td> <td><input type="checkbox"/></td> </tr> <tr> <td>7</td> <td><input type="checkbox"/></td> <td><input type="checkbox"/></td> <td><input type="checkbox"/></td> <td><input type="checkbox"/></td> <td><input type="checkbox"/></td> <td><input type="checkbox"/></td> <td><input type="checkbox"/></td> </tr> <tr> <td>7(First half)</td> <td><input type="checkbox"/></td> <td><input type="checkbox"/></td> <td><input type="checkbox"/></td> <td><input type="checkbox"/></td> <td><input type="checkbox"/></td> <td><input type="checkbox"/></td> <td><input type="checkbox"/></td> </tr> <tr> <td>7(Second half)</td> <td><input type="checkbox"/></td> <td><input type="checkbox"/></td> <td><input type="checkbox"/></td> <td><input type="checkbox"/></td> <td><input type="checkbox"/></td> <td><input type="checkbox"/></td> <td><input type="checkbox"/></td> </tr> <tr> <td>Team lecture</td> <td><input type="checkbox"/></td> <td><input type="checkbox"/></td> <td><input type="checkbox"/></td> <td><input type="checkbox"/></td> <td><input type="checkbox"/></td> <td><input type="checkbox"/></td> <td><input type="checkbox"/></td> </tr> <tr> <td>Other</td> <td><input type="checkbox"/></td> <td><input type="checkbox"/></td> <td><input type="checkbox"/></td> <td><input type="checkbox"/></td> <td><input type="checkbox"/></td> <td><input type="checkbox"/></td> <td><input type="checkbox"/></td> </tr> </tbody> </table> <p><small>(If you want to specify the class period, you must select the class starting time.)</small></p>		Mon	Tue	Wed	Thu	Fri	Sat	Other	1	<input type="checkbox"/>	<input type="checkbox"/>	<input type="checkbox"/>	<input type="checkbox"/>	<input type="checkbox"/>	<input type="checkbox"/>	<input type="checkbox"/>	4(Second half)	<input type="checkbox"/>	<input type="checkbox"/>	<input type="checkbox"/>	<input type="checkbox"/>	<input type="checkbox"/>	<input type="checkbox"/>	<input type="checkbox"/>	5	<input type="checkbox"/>	<input type="checkbox"/>	<input type="checkbox"/>	<input type="checkbox"/>	<input type="checkbox"/>	<input type="checkbox"/>	<input type="checkbox"/>	5(First half)	<input type="checkbox"/>	<input type="checkbox"/>	<input type="checkbox"/>	<input type="checkbox"/>	<input type="checkbox"/>	<input type="checkbox"/>	<input type="checkbox"/>	5(Second half)	<input type="checkbox"/>	<input type="checkbox"/>	<input type="checkbox"/>	<input type="checkbox"/>	<input type="checkbox"/>	<input type="checkbox"/>	<input type="checkbox"/>	6	<input type="checkbox"/>	<input type="checkbox"/>	<input type="checkbox"/>	<input type="checkbox"/>	<input type="checkbox"/>	<input type="checkbox"/>	<input type="checkbox"/>	6(First half)	<input type="checkbox"/>	<input type="checkbox"/>	<input type="checkbox"/>	<input type="checkbox"/>	<input type="checkbox"/>	<input type="checkbox"/>	<input type="checkbox"/>	6(Second half)	<input type="checkbox"/>	<input type="checkbox"/>	<input type="checkbox"/>	<input type="checkbox"/>	<input type="checkbox"/>	<input type="checkbox"/>	<input type="checkbox"/>	7	<input type="checkbox"/>	<input type="checkbox"/>	<input type="checkbox"/>	<input type="checkbox"/>	<input type="checkbox"/>	<input type="checkbox"/>	<input type="checkbox"/>	7(First half)	<input type="checkbox"/>	<input type="checkbox"/>	<input type="checkbox"/>	<input type="checkbox"/>	<input type="checkbox"/>	<input type="checkbox"/>	<input type="checkbox"/>	7(Second half)	<input type="checkbox"/>	<input type="checkbox"/>	<input type="checkbox"/>	<input type="checkbox"/>	<input type="checkbox"/>	<input type="checkbox"/>	<input type="checkbox"/>	Team lecture	<input type="checkbox"/>	<input type="checkbox"/>	<input type="checkbox"/>	<input type="checkbox"/>	<input type="checkbox"/>	<input type="checkbox"/>	<input type="checkbox"/>	Other	<input type="checkbox"/>	<input type="checkbox"/>	<input type="checkbox"/>	<input type="checkbox"/>	<input type="checkbox"/>	<input type="checkbox"/>	<input type="checkbox"/>
	Mon	Tue	Wed	Thu	Fri	Sat	Other																																																																																																										
1	<input type="checkbox"/>	<input type="checkbox"/>	<input type="checkbox"/>	<input type="checkbox"/>	<input type="checkbox"/>	<input type="checkbox"/>	<input type="checkbox"/>																																																																																																										
4(Second half)	<input type="checkbox"/>	<input type="checkbox"/>	<input type="checkbox"/>	<input type="checkbox"/>	<input type="checkbox"/>	<input type="checkbox"/>	<input type="checkbox"/>																																																																																																										
5	<input type="checkbox"/>	<input type="checkbox"/>	<input type="checkbox"/>	<input type="checkbox"/>	<input type="checkbox"/>	<input type="checkbox"/>	<input type="checkbox"/>																																																																																																										
5(First half)	<input type="checkbox"/>	<input type="checkbox"/>	<input type="checkbox"/>	<input type="checkbox"/>	<input type="checkbox"/>	<input type="checkbox"/>	<input type="checkbox"/>																																																																																																										
5(Second half)	<input type="checkbox"/>	<input type="checkbox"/>	<input type="checkbox"/>	<input type="checkbox"/>	<input type="checkbox"/>	<input type="checkbox"/>	<input type="checkbox"/>																																																																																																										
6	<input type="checkbox"/>	<input type="checkbox"/>	<input type="checkbox"/>	<input type="checkbox"/>	<input type="checkbox"/>	<input type="checkbox"/>	<input type="checkbox"/>																																																																																																										
6(First half)	<input type="checkbox"/>	<input type="checkbox"/>	<input type="checkbox"/>	<input type="checkbox"/>	<input type="checkbox"/>	<input type="checkbox"/>	<input type="checkbox"/>																																																																																																										
6(Second half)	<input type="checkbox"/>	<input type="checkbox"/>	<input type="checkbox"/>	<input type="checkbox"/>	<input type="checkbox"/>	<input type="checkbox"/>	<input type="checkbox"/>																																																																																																										
7	<input type="checkbox"/>	<input type="checkbox"/>	<input type="checkbox"/>	<input type="checkbox"/>	<input type="checkbox"/>	<input type="checkbox"/>	<input type="checkbox"/>																																																																																																										
7(First half)	<input type="checkbox"/>	<input type="checkbox"/>	<input type="checkbox"/>	<input type="checkbox"/>	<input type="checkbox"/>	<input type="checkbox"/>	<input type="checkbox"/>																																																																																																										
7(Second half)	<input type="checkbox"/>	<input type="checkbox"/>	<input type="checkbox"/>	<input type="checkbox"/>	<input type="checkbox"/>	<input type="checkbox"/>	<input type="checkbox"/>																																																																																																										
Team lecture	<input type="checkbox"/>	<input type="checkbox"/>	<input type="checkbox"/>	<input type="checkbox"/>	<input type="checkbox"/>	<input type="checkbox"/>	<input type="checkbox"/>																																																																																																										
Other	<input type="checkbox"/>	<input type="checkbox"/>	<input type="checkbox"/>	<input type="checkbox"/>	<input type="checkbox"/>	<input type="checkbox"/>	<input type="checkbox"/>																																																																																																										

Search Syllabus

You can narrow the search results by curriculum, course name, instructor name, etc. Instructor name must be entered in **all capital letters**.

Select the day/time, e.g. 1 x Tue for classes held in first period on Tuesdays. When the class period is checked, the class starting time also must be selected.

After making your selections, click the search button. A list of classes for which you are eligible to register will be displayed as per your search criteria.

A list of classes will be displayed as per the search criteria.

Search from Course

[Return to Previous Screen](#)

Course List

Click the course name which you want to refer to a syllabus.

1-10/28 1 2 3 Next 10>> 10 ▾

No	Course Code	Course Name	Class Starting Period	Instructor in Charge
1	CB22119	Logic	Spring Semester Tue 2	KAZUHISA SHINOZAWA
2	CB22307	Sports A		HIGE
3	CB22308	Sports A		I
4	CB22309	Sports A	Spring Semester Tue 2	AKIRA TAMAGAWA
5	CB22310	Sports A	Spring Semester Tue 2	AKIRA SATO
6	CB22311	Sports A	Spring Semester Tue 2	TOSHIHIKO FUJIMOTO
7	CB22130	Physics A	Spring Semester Tue 2	TOMOHIKO IWASAKI
8	CB22131	Physics A	Spring Semester Tue 2	MASATOSHI ITOH
9	CB22132	Physics A	Spring Semester Tue 2	YOSHIRO HIRAYAMA
10	CB22120	Philosophy	Spring Semester Tue 2	ICHIRO MORI

You can view a class's syllabus by clicking the class title.

1-10/28 1 2 3 Next 10>> 10 ▾

Syllabus Screen

Browse Syllabus

[Return to Search Result List](#)

[Add to Your Favorite](#)

Subject	Biology B
Day/Period/Place	Spring Semester Tue 2 川北キャンパスA204
Categories	General Education Subjects - Expansion Subjects-Biology
Credit(s)	2
Object	国際学士コース(*)
Instructor (Position)	ROBERT MARTIN 所属:高度教養教育・学生支援機構
Term	3セメスター
Course Numbering	ZDN-BIO112E
Language Used in Course	English

Class Subject	Essential Biochemistry
Object and Summary of Class	Biochemistry is a vast field that covers the structure, function, and interconversion of the biomolecules that characterize living systems. The main objective of this course is for the student to acquire a fundamental understanding about biomolecules, proteins, enzymes, and catalysis as well as getting an overview of some of the central metabolic pathways.

(2) Search by Instructor

This allows you to search by class instructor. If you know the instructor name, this search is the easiest way to view the syllabus.

Search by Instructor

Search Condition

 Select a year that you want to search syllabus and search instructor.

School Year	<input type="text" value="2022"/>
Name	<input type="text" value="ROBERT"/>
Full-time/Part-time	<input type="checkbox"/> Full-time <input type="checkbox"/> Part-time

Instructor name must be entered in **all capital letters**.

(3) Full-Text Search

This allows you to search for words/text contained in the syllabi.

Search Entire Text

Search Condition

 [Search Entire Text] then, you can search for summary of class for which you can't search by [Search from Course] and [Search by Instructor]. Select a year that you want to search syllabus and enter the search keyword.

School Year	<input type="text" value="2022"/>
Search Keyword	<input type="text" value="organic chemistry"/>

Multiple keywords can be entered with a space between words.

- **QuickSyllabus**

QuickSyllabus is a website that allows you to quickly search syllabi without logging in. The website is only available in Japanese, but the syllabus itself is available in English if the course is conducted in English. Note that the contact information of instructors is NOT posted in QuickSyllabus.

QuickSyllabus: <https://qsl.cds.tohoku.ac.jp>

V General Education Class Information (FGL Program)

1. List of Subjects (2nd, 3rd, and 4th Semester Classes)

Category	Group 1	Group 2	Subject	Credits	Semester	Courses	
Foundations	Navigating Academia	-	*Introduction to Academic Learning	2	2	AMC IMAC-U AMB	
	Humanities	-	Sociology	2	2	AMC IMAC-U AMB	
	Social Sciences	-	Economy and Society	2	2	AMC IMAC-U AMB	
	Natural Sciences	Mathematics	Foundations of Linear Algebra	2	3	AMB	
			Foundations of Calculus	2	2	AMB	
	Transdisciplinary Subjects	Life	Life and Nature	2	2	AMC IMAC-U AMB	
			Integrated Experiments of Science	2	3	AMC IMAC-U AMB	
			Health & Sports (Sports)	Sports A	1	3	IMAC-U
					4	AMC AMB	
	Health & Sports (Lecture)	Health	2	4	AMC IMAC-U AMB		
Advanced Subjects	Contemporary Competencies	Information Science and Technology Education	Information and Data Literacy	2	2	AMC IMAC-U AMB	
		International Education	*Study-abroad Program A (Fundamentals of Interdisciplinary STEM Seminar)	1	2	AMC IMAC-U AMB	
		Career Education	*Special Lecture of Career Education (Digital Entrepreneurship Seminar)	2	4	AMC IMAC-U AMB	
Languages	Japanese	Japanese	Basic Japanese I	4	2	AMC IMAC-U AMB	
			Basic Japanese II	3	3	AMC IMAC-U AMB	
			Intermediate Japanese	3	4	AMC IMAC-U AMB	

Category	Group 1	Group 2	Subject	Credits	Semester	Courses
Basics of Discipline	Basics of Mathematics	-	Linear Algebra A	2	2	AMC IMAC-U
			Linear Algebra B	2	3	AMC IMAC-U
			Calculus A	2	2	AMC IMAC-U
			Calculus B	2	3	AMC IMAC-U
			Ordinary Differential Equations	2	4	AMC IMAC-U
			Probability & Statistics	2	4	AMC IMAC-U AMB
	Basics of Physics	-	Physics A	2	2	AMC IMAC-U AMB
			Physics B	2	3	AMC IMAC-U AMB
			Physics C	2	3	AMC IMAC-U AMB
	Basics of Chemistry	-	Chemistry A	2	2	AMC IMAC-U AMB
			Chemistry B	2	2	AMC IMAC-U AMB
			Chemistry C	2	3	AMC IMAC-U AMB
	Basics of Biology	-	Biology A	2	2	AMC IMAC-U AMB
			Biology B	2	3	AMC AMB
			Biology C	2	3	AMC AMB
	Basics of Earth and Space Science	-	Earth Material Science	2	2	AMC IMAC-U AMB

※For subjects other than those listed above, please refer to the orientation for each course.

2. Timetable

ATTN: When you register for courses, be sure to select the English courses for FGL students that match instructor names below.

2nd Semester (October 2022 - March 2023)

 General Education Subjects

 Specialized Subjects

AMC Course

	8:50 - 10:20	10:30 - 12:00	13:00 - 14:30	14:40 - 16:10	16:20 - 17:50
Mon.		物理学 A Physics A Takeshi KOIKE R115	化学 B Chemistry B Mott DERRICK R115	Basic Japanese 1 Atsuko UCHIYAMA A203	
Tue.	社会学 Sociology Jing LIU C203	生命と自然 Life and Nature Satoshi KATAYAMA C203	線形代数学 A Linear Algebra A Marcin SCHROEDER C204		Basic Japanese 1 Masako HAYASHI A203
Wed.	経済と社会 Economy and Society Jeremy Ryan SEPTEMBER C103	化学 A Chemistry A Mott DERRICK R115	HR 13:30- AMC Classroom	Introduction to Basic Chemistry 14:30- AMC Course Professors Laboratory of Katakira Campus	
Thu.	情報とデータの基礎 Information and Data Literacy Xavier DAHAN M101	Basic Japanese 1 Natsue SUGAYA C204	地球物質科学 Mineralogy, Petrology & Geochemistry Brian BREEDLOVE R115	生命科学 A Biology A Toshiharu ICHINOSE and other instructors C204	
Fri.		解析学 A Calculus A Xavier DAHAN R115	Basic Japanese 1 Natsue SUGAYA C204	学問論 Introduction of Academic Learning Yumiko Watanabe, etc. R115	

IMAC-U Course

	8:50 - 10:20	10:30 - 12:00	13:00 - 14:30	14:40 - 16:10	16:20 - 17:50
Mon.		物理学 A Physics A Takeshi KOIKE R115	化学 B Chemistry B Mott DERRICK R115	Basic Japanese 1 Atsuko UCHIYAMA A203	
Tue.	社会学 Sociology Jing LIU C203	生命と自然 Life and Nature Satoshi KATAYAMA C203	線形代数学 A Linear Algebra A Marcin SCHROEDER C204		Basic Japanese 1 Masako HAYASHI A203
Wed.	経済と社会 Economy and Society Jeremy Ryan SEPTEMBER C103	化学 A Chemistry A Mott DERRICK R115		数学物理学演習 I Exercises in Mathematics and Physics I Ying CHEN C204	
Thu.	情報とデータの基礎 Information and Data Literacy Xavier DAHAN M101	Basic Japanese 1 Natsue SUGAYA C204	地球物質科学 Mineralogy, Petrology & Geochemistry Brian BREEDLOVE R115	生命科学 A Biology A Toshiharu ICHINOSE and other instructors C204	
Fri.		解析学 A Calculus A Xavier DAHAN R115	Basic Japanese 1 Natsue SUGAYA C204	学問論 Introduction of Academic Learning Yumiko Watanabe, etc. R115	

AMB Course

	8:50 - 10:20	10:30 - 12:00	13:00 - 14:30	14:40 - 16:10	16:20 - 17:50
Mon.			化学 B Chemistry B Mott DERRICK R115	Basic Japanese 1 Atsuko UCHIYAMA A203	
Tue.	社会学 Sociology Jing LIU C203	生命と自然 Life and Nature Satoshi KATAYAMA C203	線形代数 A Linear Algebra A Marcin SCHROEDER C204	解析学概論 Foundations of Calculus Xavier DAHAN R115	Basic Japanese 1 Masako HAYASHI A203
Wed.	経済と社会 Economy and Society Jeremy Ryan SEPTEMBER C103	化学 A Chemistry A Mott DERRICK R115	(Lab Tour on Aobayama Campus)		
Thu.	情報とデータの基礎 Information and Data Literacy Xavier DAHAN M101	Basic Japanese 1 Natsue SUGAYA C204	地球物質科学 Mineralogy, Petrology & Geochemistry Brian BREEDLOVE R115	生命科学 A Biology A Toshiharu ICHINOSE and other instructors C204	
Fri.	物理学 A Physics A Takeshi KOIKE R115	生理・生態学概論 Introduction to Physiology and Ecology Cheryl AMES A104	Basic Japanese 1 Natsue SUGAYA C204	学問論 Introduction of Academic Learning Yumiko Watanabe, etc. R115	

2. Syllabus (2nd Semester)

– Available on the FGL Current Students website or Student Affairs Information System.

Cooperative Innovation Program in Science, Engineering, and Agriculture for Leading Sustainable and Diverse Industry and Society by Digital Globalization

The FGL program has been selected by MEXT for a new program aimed at government-sponsored students. As a result, starting in FY 2021, FGL will be able to accept 8 government-sponsored students each year for three years. The objective of this program is to create an educational system based on cooperation between three undergraduate schools that will foster leaders in the field of global sustainable and diverse industry and society while driving innovation in university education.

Those who enter FGL as government-sponsored students will also belong to this new program. Therefore, in addition to the curricula of their undergraduate schools, the government-sponsored students will have to fulfill the requirements of this program as well. The program requirements (i.e. requirements for receiving government sponsorship) consist of nine or ten credits in the below six subjects. For details of each subject, please see the syllabus. (From 1. to 3. below are General Education subjects. In the above table, they are indicated by an asterisk (*) to the right of the subject names.)

1. Study Abroad Program A [1 credit] — General Education Subjects
2. Introduction to Academic Learning [2 credits] — General Education Subjects
3. Life and Nature (Study of Nature, Life and Technology) [2 credits] — General Education Subjects
4. Science, Technology, and Industry in Japan [1 credit] — Specialized Subjects
5. Multidisciplinary Internship [1 credit] — Specialized Subjects
6. Digital Entrepreneurship Seminar [2 credits] — General Education Subjects

VI Other

1. Medical Care Required due to Accidents in Class

Students who suffer accidents during class should contact the Student Health Care Center and make arrangements to receive medical care.

2. Using Educational Facilities

Some facilities on campus may be closed or offer limited service to prevent the spread of COVID-19. Please check the university websites or inquire the FGL office for the latest information.

(1) ICL Rooms	ICL Rooms at the Multimedia Education and Research Complex can be used for self-study any time they are not being used for classes.
(2) Lounge	There is a lounge in Building B on the 1st floor. You may use it for taking online classes or resting in the time between classes etc.
(3) Study Room	The Study Room is in Building B on the 2nd floor. It is open from 8:30 to 18:00. Please refrain from making noise in the Study Room. On each desk, there is an outlet that you can use to charge your laptop.
(4) SLA Lounge	There is a SLA (Student Learning Adviser) desk, where students can go for consulting near the entrance hall on the 1st floor of the Multimedia Education and Research Complex. Older students will answer questions and provide advice on various subjects. Please see the Center for Learning Support website for details.

3. Counseling Services

Students requiring counseling from someone other than their class instructors or department staff should contact the below counseling services. The details of counseling will be kept strictly confidential. (No Charge)

(1) Center for Counseling and Disability Services	<ul style="list-style-type: none">▪ Center for Counseling and disability Services provides consulting regarding problems that arise during student life. Appropriate solutions will be discussed with the student.▪ Location: Kawauchi Kita Campus, Tel: 795-7833▪ Hours: Mon. - Fri. 9:30 - 17:00
(2) Student Health Care Center	<ul style="list-style-type: none">▪ The goal of the Student Health Care Center is to maintain and improve student health. Students who have questions, concerns or anxiety about their physical or psychological health should make use of this facility. The first aid offices at Katahira, Schools of Medicine/Dentistry, School of Engineering, and Faculty of Agriculture also provide medical consulting and care.▪ Location: Kawauchi Kita Campus, Tel: 795-7829▪ Hours: Weekdays 9:00 - 11:30, 13:00 - 16:15
(3) University-wide Harassment Counseling Center	<ul style="list-style-type: none">▪ Location: Kawauchi Kita Campus University Counseling Center, Tel: 022-795-7812▪ Hours: Mon. - Fri., 9:30 - 17:00
(4) Counseling by Phone (Provided through off-campus organization)	<ul style="list-style-type: none">▪ Counseling regarding sexual harassment, health, mental health▪ Toll-free hotline: 0120-7830-59▪ Hours: Mon., Wed., Fri., Sat., Sun. 10:00 - 21:00 Tue., Thu. 10:00 - 22:00 (not available on national holidays, Dec. 31 – Jan. 3)

4. Preventing Theft

(1) Incidences of theft in lecture halls and gymnasiums are fairly common. Do not leave bags etc. unattended in classrooms or study rooms, even for short periods of time. In the event of theft, report the incident to your Student Affairs Division or Student Services Division.

(2) There are numerous incidences of bicycle theft on Kawauchi Campus. When parking bicycles, lock them securely and do not leave them unattended for long periods of time.

● **Regulations on Tohoku University General Education Subjects**

April 1, 1993 Reg. 91

(Purport)

Article 1: These regulations specify items necessary to General Education Subjects and subjects related to education (does not include those established by the faculties; hereafter "General Education Subjects") in compliance with Article 26-2 of the Tohoku University Faculty Regulations (enacted December 18, 1952; hereafter "the Regulations").

(General Education Subjects)

Article 2: Categories of General Education Subjects are as follows.

Category	Group	
Foundations	Navigating Academia, Humanities, Social Sciences	
	Natural Sciences	Mathematics, Physics, Chemistry, Biology, Earth and Space Science
	Transdisciplinary Subjects	Society, Energy, Life, Environment, Information, Integrated Experiments of Science, Health & Sports (Sports), Health & Sports (Lecture)
Advanced Subjects	Contemporary Competencies	Information Science and Technology Education, International Education, Career Education, Global Issues
	Cutting Edge Subjects	Current Topics, Frontier Topics
Languages	Foreign Languages	English, Languages for Multilinguality, Languages for Further Multilinguality
	Japanese	
Basics of Discipline	Basics of Humanities, Basics of Social Sciences, Basics of Mathematics, Basics of Physics, Basics of Chemistry, Basics of Biology, Basics of Earth and Space Science	

(Course Subjects and Credits)

Article 3: Course subjects for General Education subjects and credits are as shown in Tables 1 and 2.

(Calculation of Credits)

Article 4: Calculation of credits for General Education course subjects are as follows.

I 1 (one) credit will be awarded per 15 hours of class time.

II 1 (one) credit will be awarded per 15 to 30 hours of seminar.

III 1 (one) credit will be awarded per 30 to 45 hours of experiments, laboratory work, and practical training.

(Registration Procedures)

Article 5: Students must inform the Chairperson of the Academic Affairs Council (hereafter, "the Chairperson") of the subjects for which they intend to register by the designated date.

(Examinations)

Article 6: Accreditation for course subjects for which students register will depend on examinations; those who pass their examinations shall receive the designated number of credits.

2 Regardless of the previous item, performance in classes consisting of experiments, laboratory work and practical training shall be graded based on daily performance instead of examinations.

3 For course subjects in which examinations can be given, the above article only applies to those who have enrolled in the class via the designated procedures.

(Makeup Examinations and Retesting)

Article 7: If, due to unavoidable circumstances, a student is unable to take a course subject's examination, a makeup test for that subject shall be conducted.

3. There will be no retesting for students who failed a course subject's examination.

(Grading Scale)

Article 8: Examination performance shall be evaluated as per the below scale. However, depending on the course subject, the grade may be specified as just "Pass" or "Fail."

AA The student's performance was particularly exceptional.

A The student's performance was excellent.

B The student's performance was above average.

C The student passed.

D The student failed.

2. Of the above grades, AA, A, B, and C are passing grades, while D is a failing grade.

3. Students who fail to attend a class for which they have submitted registration as per Article 5 above, shall receive a D grade on that class's examinations.

(Special Auditing Students)

Article 9: Students of other universities, junior colleges, or technical colleges who wish to enroll in General Education subjects may be permitted to enroll as Special Auditing Students, pursuant to agreements with that other university, junior college, or technical college.

(Miscellaneous Provisions)

Article 10: Any items necessary for General Education subjects, other than those specified in these regulations, will be specified by the Academic Affairs Council.

Supplementary Regulations Omitted

Table 1: General Education Subjects

Category	Group	Subject	Total class hours	Credits	Comments		
Foundations	Navigating Academia	Introduction to Academic Learning	30	2			
		Seminar on Each Discipline for Academic Learning	30	1			
		Advanced General Education Course	15~30	1			
	Humanities		Logic	30	2		
			Philosophy	30	2		
			Ethics	30	2		
			Literature	30	2		
			Religious Studies	30	2		
			Fine Art	30	2		
			Education	30	2		
			History	30	2		
			Linguistics and Japanese Language Sciences	30	2		
			Psychology	30	2		
			Cultural Anthropology	30	2		
	Sociology	30	2				
	Social Sciences		Economy and Society	30	2		
			Japanese Constitutional Law	30	2		
			Law	30	2		
			Politics	30	2		
			Politics and Economics in the Information Society	30	2		
			Law, Politics and Society	30	2		
	Natural Sciences	Mathematics	Introduction to Linear Algebra	30	2		
			Foundations of Linear Algebra	30	2		
			Introduction to Calculus	30	2		
			Foundations of Calculus	30	2		
			Introduction to Statistics	30	2		
			Foundations of Probability & Statistics	30	2		
		Physics		Introduction to Physics	30	2	
				Foundations of Physics I	30	2	
				Foundations of Physics II	30	2	
		Chemistry		Introduction to Chemistry	30	2	
		Biology		Introduction to Biology	30	2	
		Earth and Space Science		Introduction to Astronomy	30	2	
Introduction to Environmental Earth Science				30	2		
Introduction to Geography				30	2		
Transdisciplinary Subjects		Society	Inclusive Society	30	2		
	Energy	Energy, Resources and Sustainability	30	2			
	Life	Life and Nature	30	2			
	Environment	Nature and Environment	30	2			
	Information		Information Science and Technology in Human Life and Society	30	2		
			Introduction to Area Studies on Northeast Asia	30	2		
	Integrated Experiments of Science		Introductory Science Experiments	60	2		
			Introductory Science Experiments for the Humanities	60	2		
	Health & Sports (Sports)		Sports A	30	1		
			Sports B	30	1		
	Health & Sports (Lecture)		Health	30	2		
Sports and Health Sciences			30	2			

Category	Group		Subject	Total class hours	Credits	Comments
Advanced Subjects	Contemporary Competencies	Information Science and Technology Education	Information and Data Literacy	30	2	
			Introduction to Data Science and Artificial Intelligence	30	2	
			Introduction to Algorithms for Machine Learning	30	2	
			Hands-on Machine Learning I	30	2	
			Hands-on Machine Learning II	30	2	
			Special Lecture of Information Science and Technology Education	30	2	
		International Education	Understanding International Issues	30	2	
			PBL in Global Issues	30	2	
			Special Topics on Global Issues	30	2	
			Understanding Culture	30	2	
			Exploring Culture and Society	30	2	
			Multicultural Communication	30	2	
			PBL in Multicultural Environment	30	2	
			Special Topics on Multicultural Society	30	2	
			Global Seminar	30	2	
			Global Career	30	2	
			Global Leadership Development through PBL	30	2	
			Special Topics on Global Leadership	30	2	
			Study-abroad Semester	15~30	1	
				30~60	2	
	60~90			3		
	90~120			4		
	120~150			5		
	150~180			6		
	Study-abroad Program A	45	1			
	Study-abroad Program B	90	2			
	Faculty-led Program A	45	1			
	Faculty-led Program B	90	2			
	International Exploration A	45	1			
	International Exploration B	90	2			
	Career Education	Introduction to Entrepreneurial Skills	30	2		
		Introduction to Social Entrepreneurs and Non-Profit Organizations	30	2		
		Career Design A	30	2		
		Career Design B	30	2		
		Career Design C	30	2		
		Career Design D	30	2		
		Internship Preparation Course	15	1		
		Internship Practice Course A	15	1		
		Internship Practice Course B	30	2		
		Transferable Skills Workshop	30	2		
		Special Lecture of Career Education	30	2		Course subjects to be taught will be determined yearly.
		Global Issues	Sustainability and Social Co-Creation	30		2
	Global Governance and Sustainable Development in SDGs		30	2		
	Resilient Design for the Sustainable Society		30	2		
	Sustainable Development For Society		30	2		
	System Design Towards a Sustainable Society		30	2		
	Gender Co-Creation Society		30	2		
Cutting Edge Subjects	Current Topics		7.5	0.5		
			15~30	1		
	Frontier Topics		30~60	2		Course subjects to be taught will be determined yearly.
			30	2		

Category	Group		Subject	Total class hours	Credits	Comments			
Languages	Foreign Languages	English	English I-A	30	1				
			English I-B	30	1				
			English II-A	30	1				
			English II-B	30	1				
			English III	30	1				
			English III (e-learning)	30	1				
		Foreign Languages		Basic German	Basic German I		60	2	
					Basic German II		60	2	
					Intermediate German I		30	2	
					Intermediate German II		30	2	
					Intermediate German III		30	2	
					Intermediate German IV		30	2	
				Basic French	Basic French I		60	2	
					Basic French II		60	2	
					Intermediate French I		30	2	
					Intermediate French II		30	2	
					Intermediate French III		30	2	
					Intermediate French IV		30	2	
				Practical French	Practical French I		30	2	
					Practical French II		30	2	
					Basic Russian		Basic Russian I	60	2
							Basic Russian II	60	2
							Intermediate Russian I	30	2
							Intermediate Russian II	30	2
				Intermediate Russian	Intermediate Russian III		30	2	
					Intermediate Russian IV		30	2	
					Basic Spanish		Basic Spanish I	60	2
							Basic Spanish II	60	2
				Intermediate Spanish	Intermediate Spanish I		30	2	
					Intermediate Spanish II		30	2	
	Practical Spanish			Practical Spanish I	30		2		
				Practical Spanish II	30		2		
	Other Languages				Basic Chinese		Basic Chinese I	60	2
							Basic Chinese II	60	2
					Intermediate Chinese		Intermediate Chinese I	30	2
							Intermediate Chinese II	30	2
		Intermediate Chinese	Intermediate Chinese III		30		2		
			Intermediate Chinese IV		30		2		
		Basic Korean	Basic Korean I		60		2		
			Basic Korean II		60		2		
		Intermediate Korean	Intermediate Korean I		30		2		
			Intermediate Korean II		30		2		
		Intermediate Korean	Intermediate Korean III		30		2		
			Intermediate Korean IV		30		2		
	Other Languages		Greek	Greek I	30		2		
				Greek II	30		2		
			Sanskrit	Sanskrit I	30		2		
				Sanskrit II	30		2		
			Latin	Latin I	30		2		
				Latin II	30		2		
			Mongolian	Mongolian I	30		2		
				Mongolian II	30		2		
Italian			Italian I	30	2				
			Italian II	30	2				
Czech			Czech I	30	2				
			Czech II	30	2				
Arabic			Arabic I	30	2				
			Arabic II	30	2				
Japanese		Japanese	Japanese A	30	1				
			Japanese B	30	1				
			Japanese C	30	1				
			Japanese D	30	1				
			Japanese E	30	1				
			Japanese F	30	1				
			Japanese G	30	1				
			Japanese H	30	1				
			Japanese I	30	1				
			Japanese J	30	1				
		Basic Japanese	Basic Japanese I	120	4				
			Basic Japanese II	90	3				
			Intermediate Japanese	90	3				

Category	Group	Subject	Total class hours	Credits	Comments	
Basics of Discipline	Basics of Humanities		30	2	The dean of each faculty shall determine annually which courses may be taken by students of other faculties as General Education Subjects.	
	Basics of Social Sciences		30	2		
	Basics of Mathematics	Linear Algebra A		30	2	
		Linear Algebra B		30	2	
		Calculus A		30	2	
		Calculus B		30	2	
		Ordinary Differential Equations		30	2	
		Complex Function Theory		30	2	
		Probability & Statistics		30	2	
	Basics of Physics	Physics A		30	2	
		Physics B		30	2	
		Physics C		30	2	
		Basic Mathematics for Physics		30	2	
	Basics of Chemistry	Chemistry A		30	2	
		Chemistry B		30	2	
		Chemistry C		30	2	
	Basics of Biology	Biology A		30	2	
		Biology B		30	2	
		Biology C		30	2	
	Basics of Earth and Space Science	Earth System Science		30	2	
		Earth Material Science		30	2	
Geography			30	2		
Astronomy			30	2		
Geophysics			30	2		

● Kawauchi Campus Map

(1) Campus Map

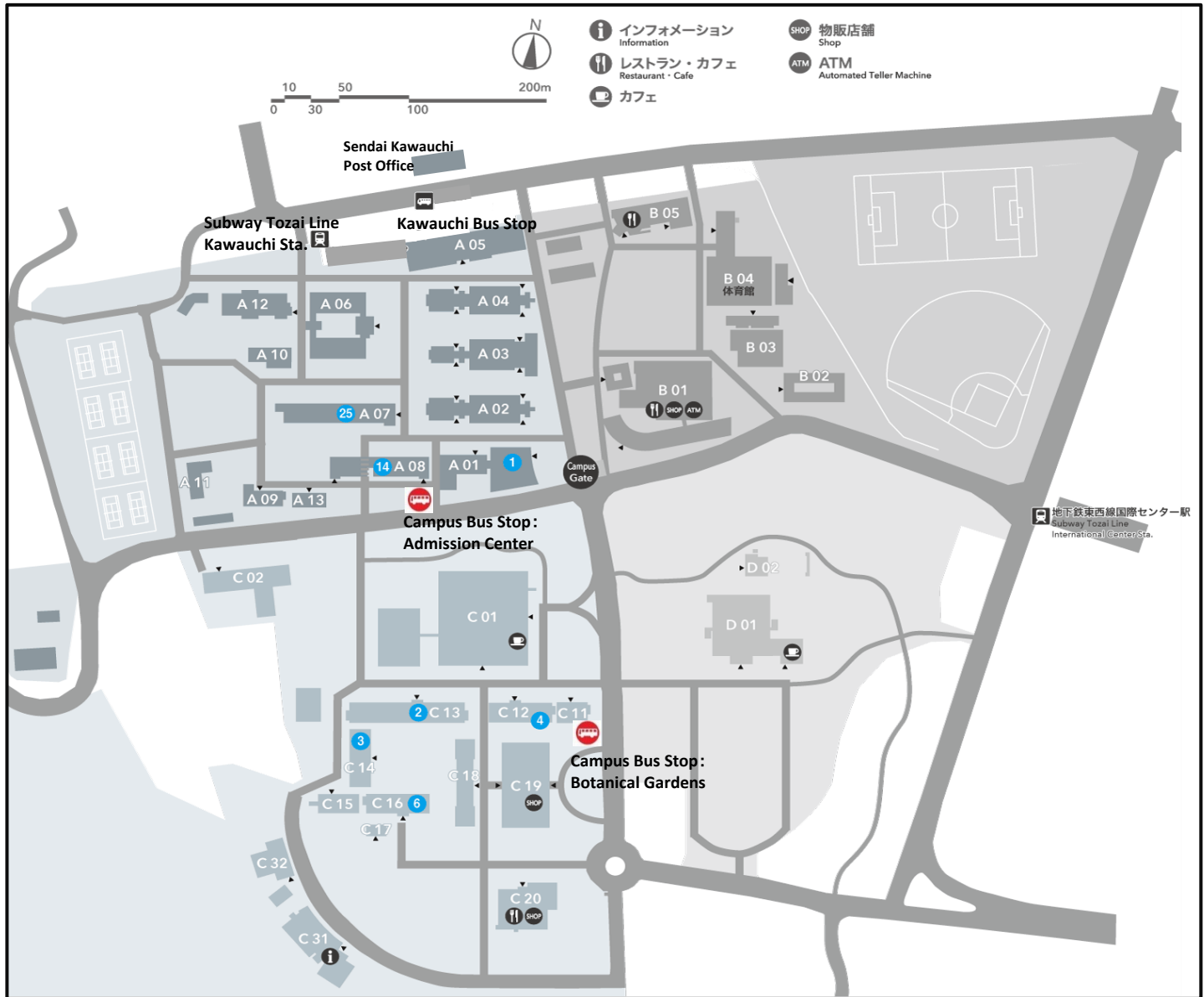

A 01	Education and Student Support Center
A 02	Lecture Rooms A
A 03	Lecture Rooms B
A 04	Lecture Rooms C
A 05	Multimedia Education and Research Complex
A 06	Student Laboratories
A 07	Center for Northeast Asian Studies, Office, Kawakita Research Forum
A 08	Graduate School of International Cultural Studies, Office
A 09	Student Health Care Center
A 10	Disability Services Office
A 12	International Exchange Building
A 13	Counseling Office
B 01	Kawauchi Welfare Facilities
B 02	Kawauchi Circle and Club Building
B 03	Kawauchi Extracurricular Activity Shared Facilities (Kawauchi Hall)
B 04	Kawauchi Gymnasium (Kawauchi Arena)
B 05	Kawauchi Sub Arena
C 01	Tohoku University Library
C 02	Admission Center
C 12	Graduate School / School of Law, Office
C 13	Graduate School / Faculty of Arts and Letters, Office
C 14	Graduate School / Faculty of Education, Office, New Humanities Building
C 16	Graduate School / Faculty of Economics and Management, Office
C 18	Lecture Rooms
C 19	Multidisciplinary Research Building, International Oasis
C 20	Welfare Facilities (Maple Park Kawauchi)
C 31	Botanical Gardens (Garden Hall)
D 01	Centennial Hall (Kawauchi Hagi Hall)

(2) Classroom

() = the seating capacity

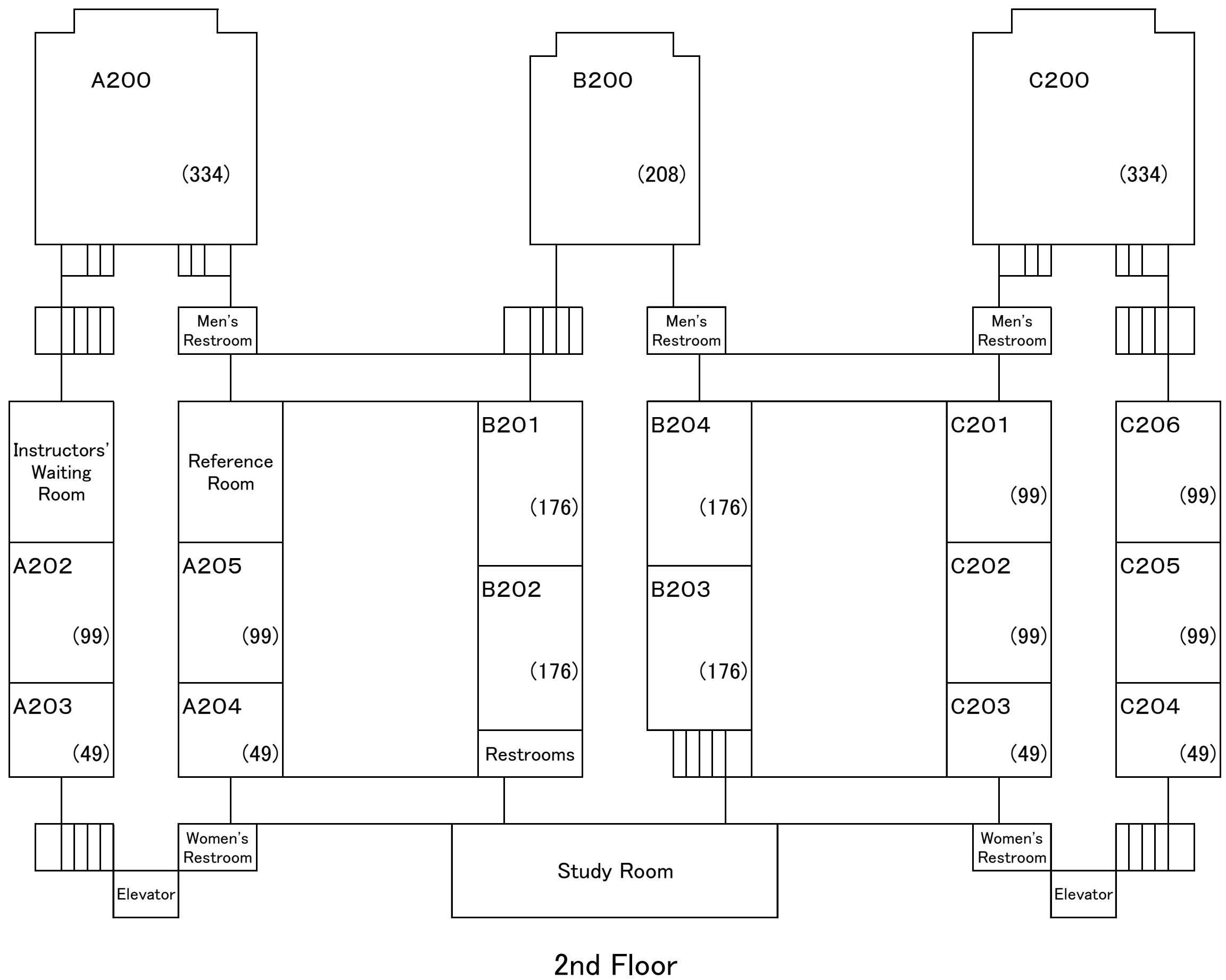
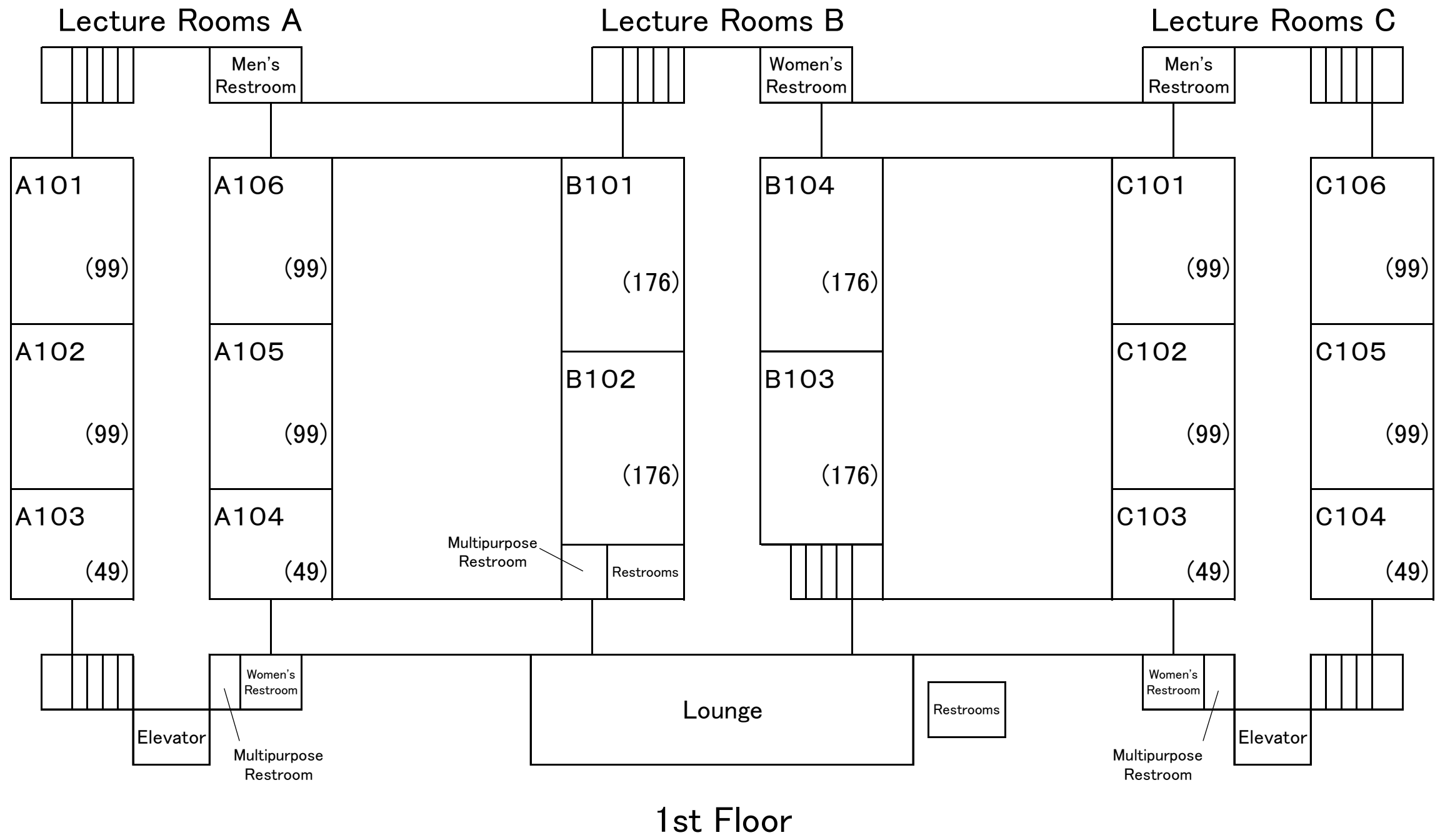

Lecture Rooms A

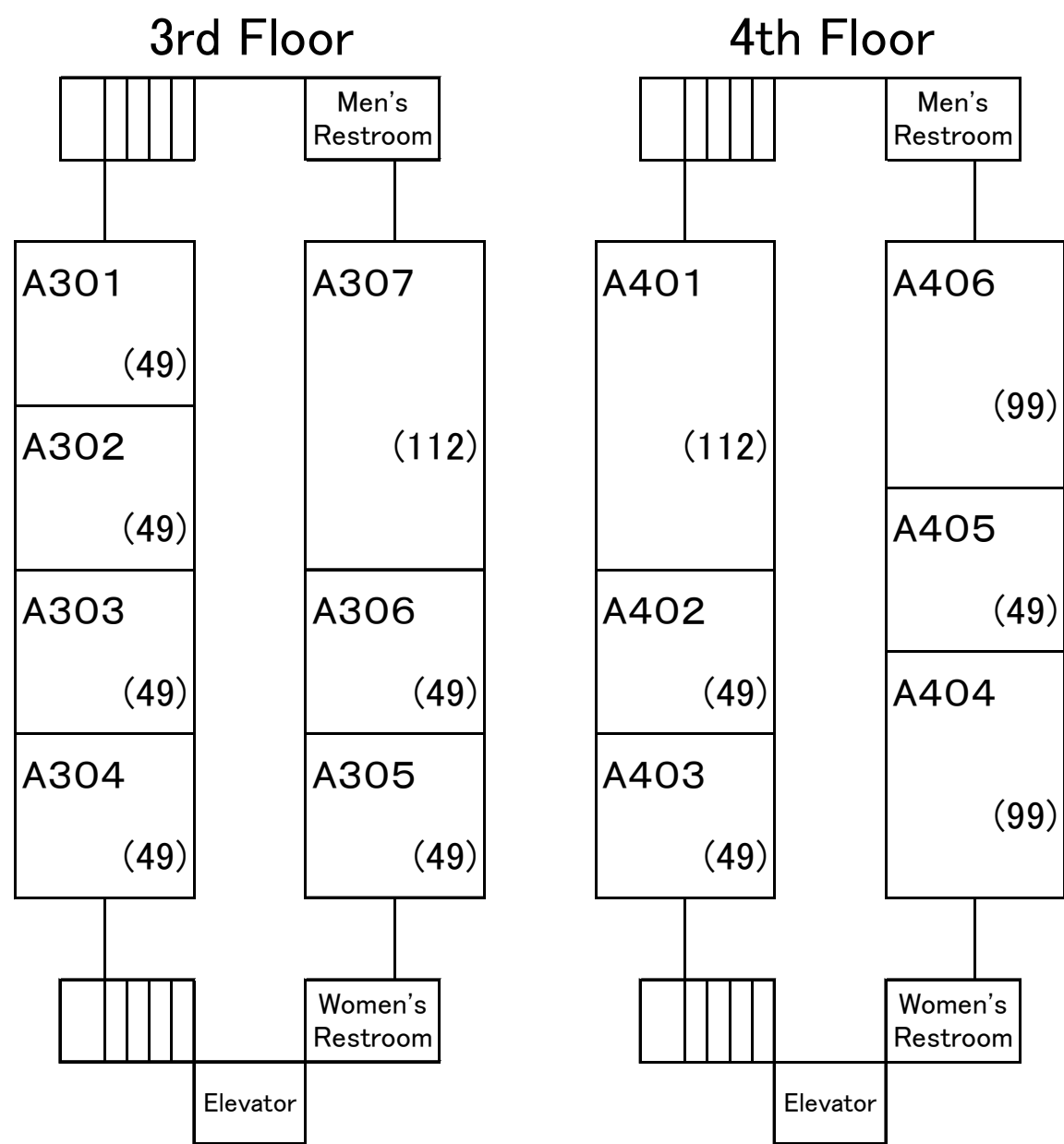

Lecture Rooms C

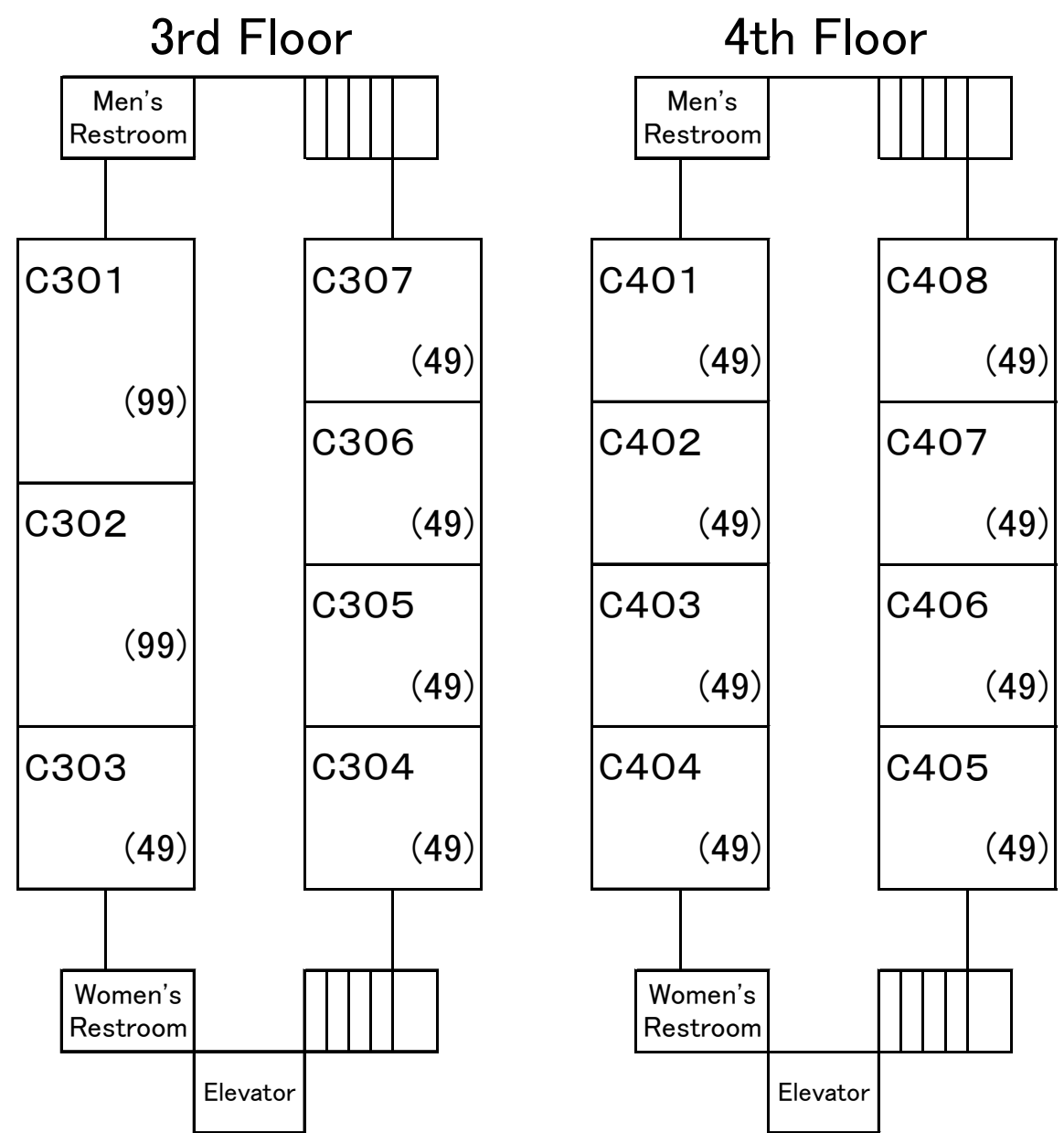

(3) Student Laboratories

1st Floor

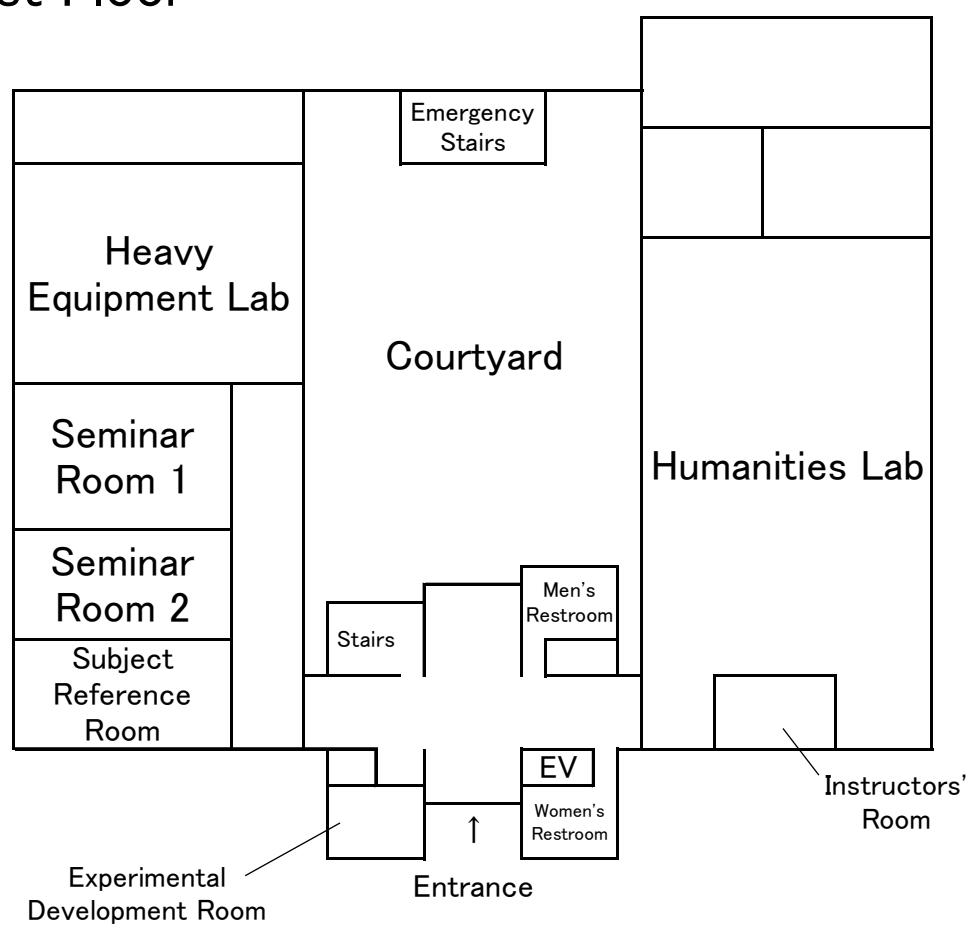

2nd Floor

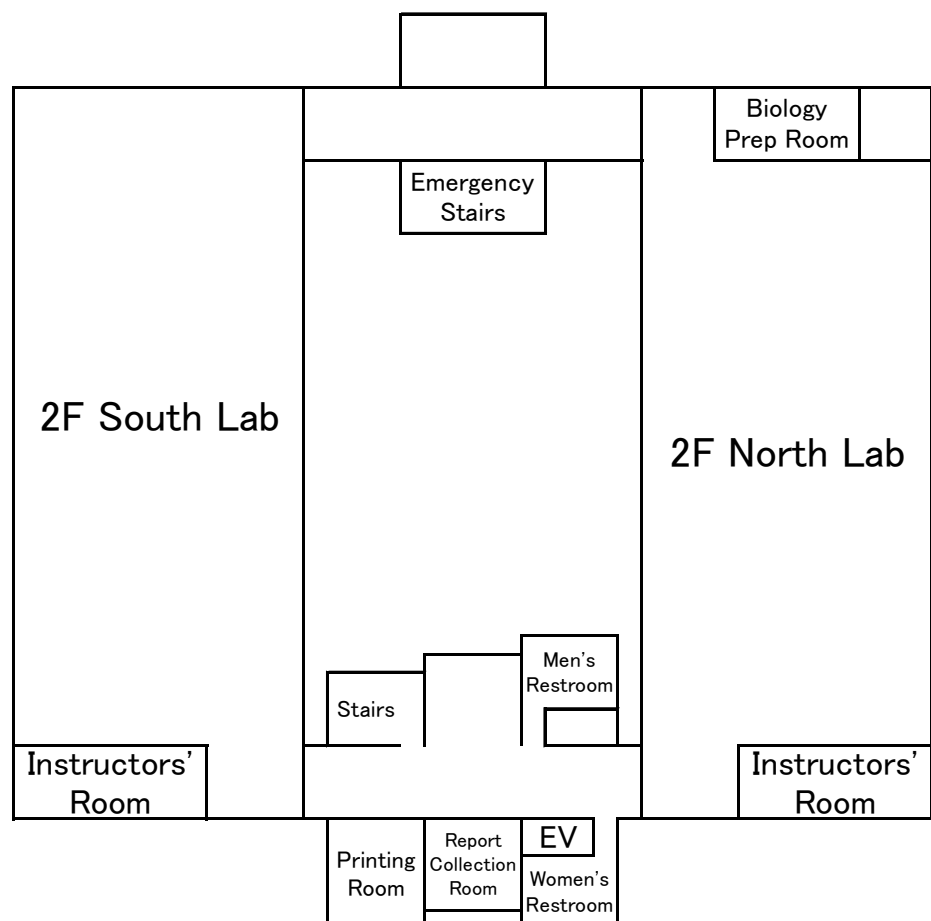

3rd Floor

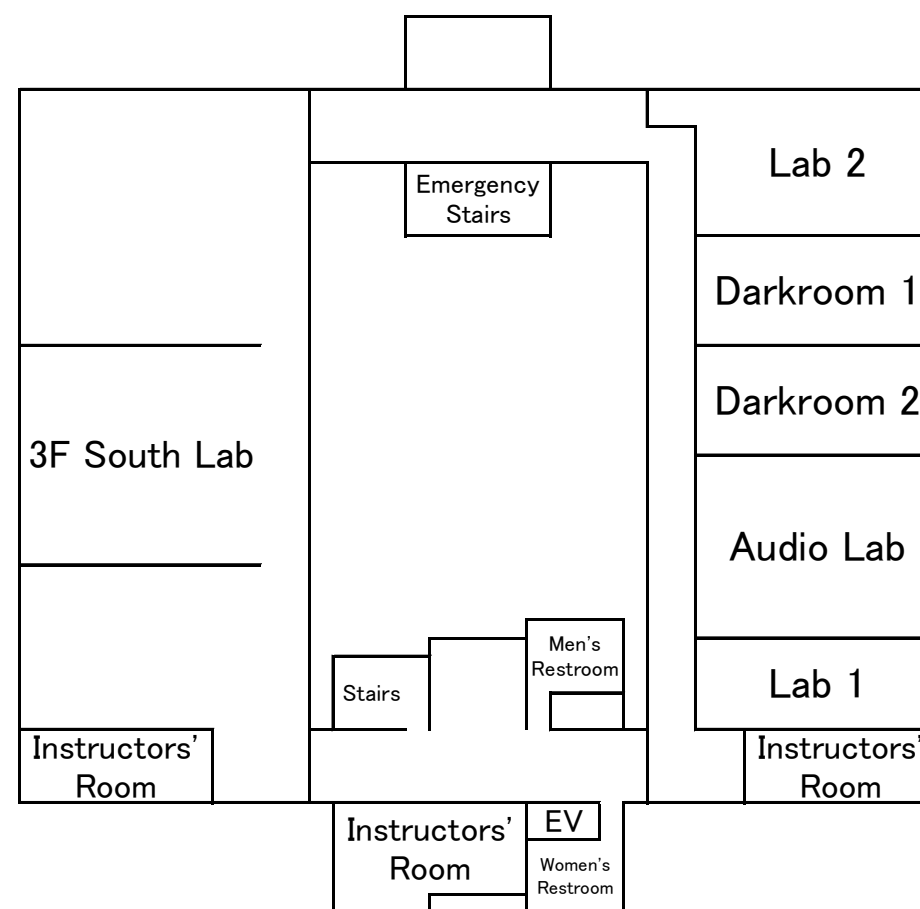

(4) Multimedia Education and Research Complex

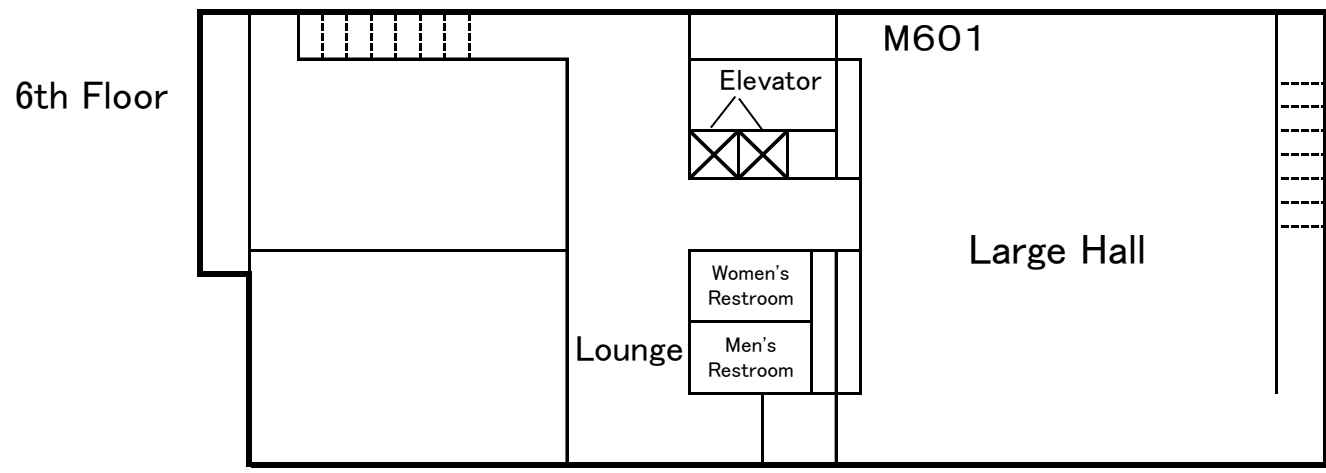
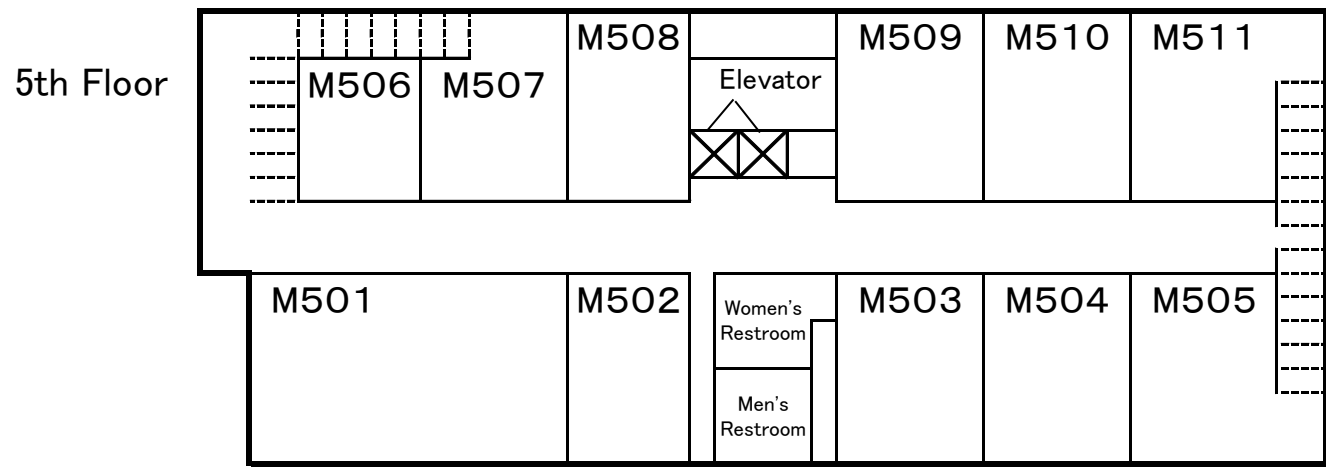
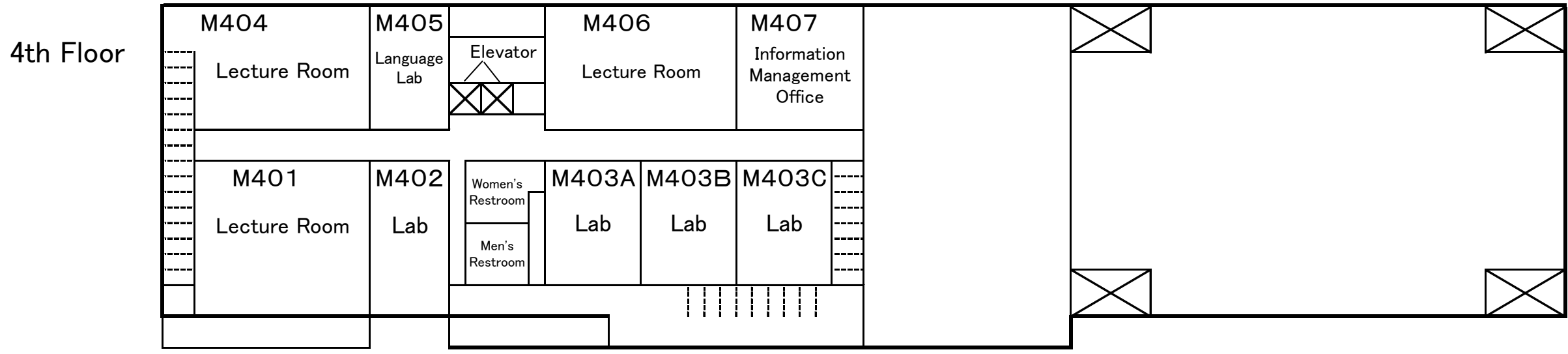
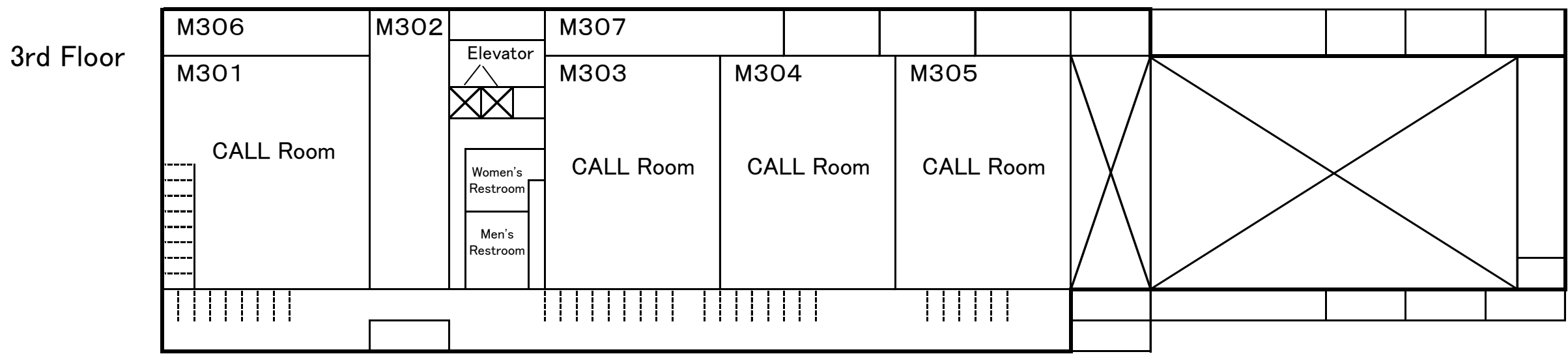
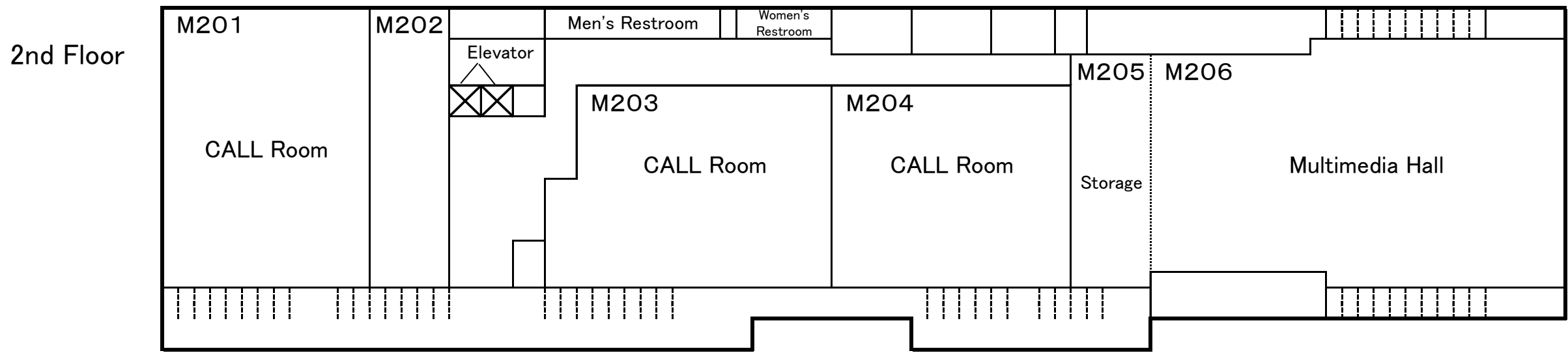
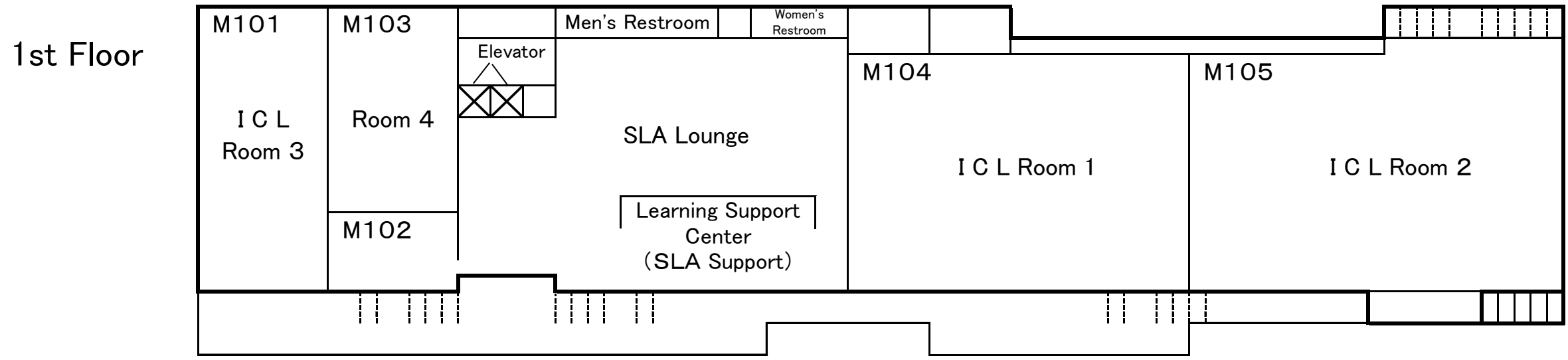

(5) Gymnasium

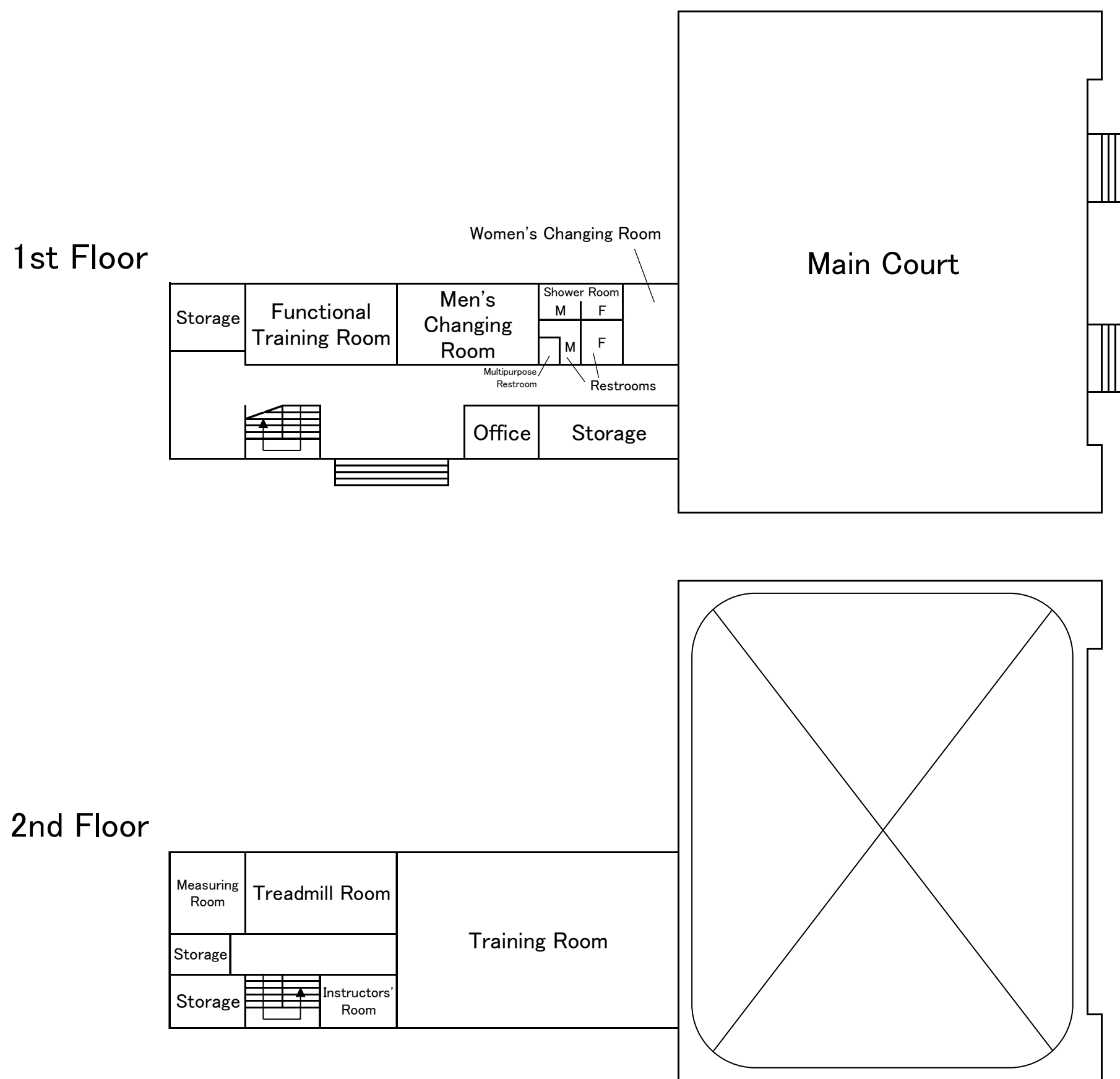

(6) Sub Arena

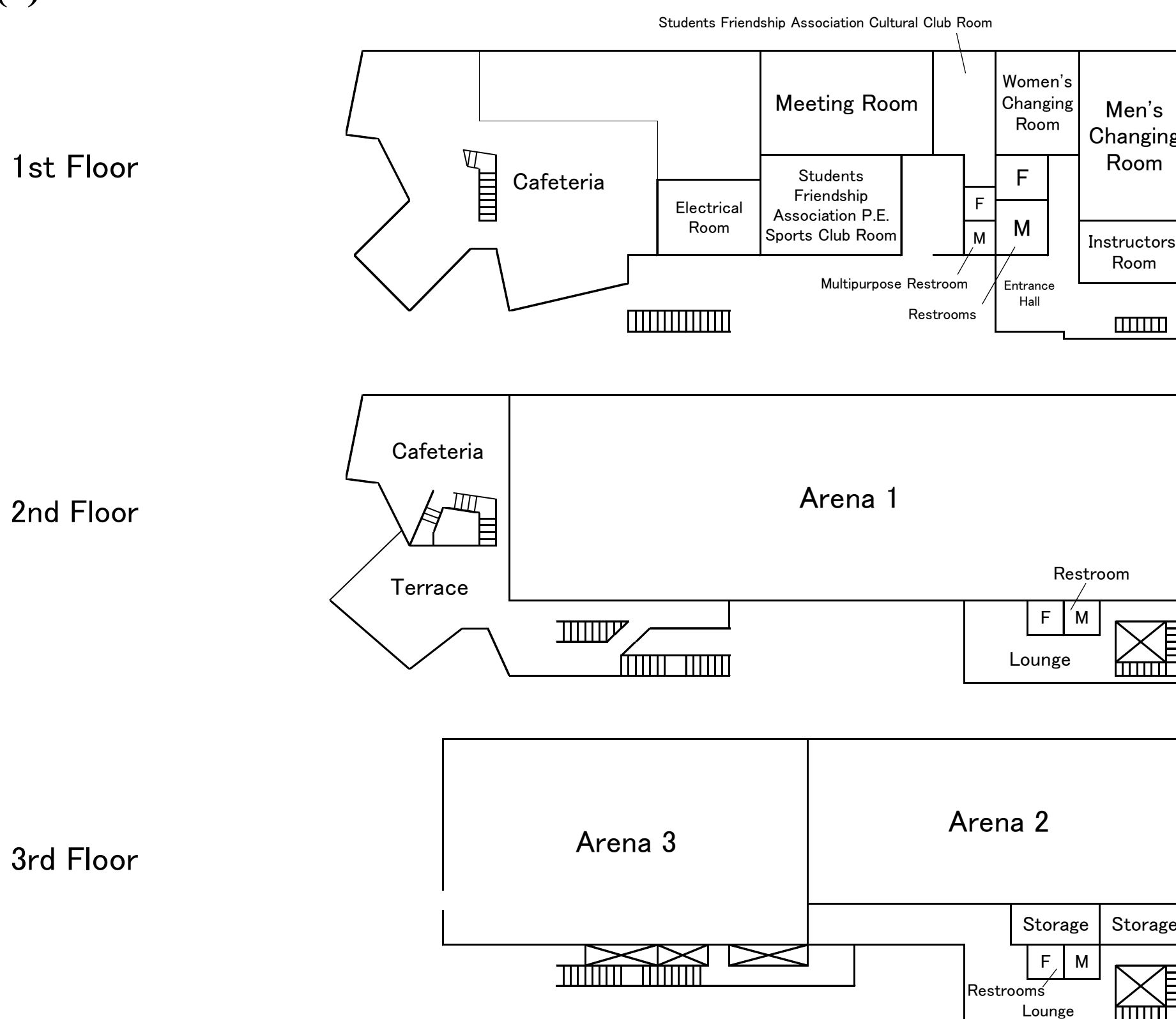

(7) Education and Student Support Center, Student Services [A01]

Student Support Division (1st floor)	
1	Support Planning Section -Lost & Found -Change of personal information (address, contact information etc.) -Thefts/crimes/accidents
2	Activity Support Section -Circles/clubs -Equipment loan
3	Life Support Section -University House, dormitories -Enrollment/invoicing for personal accident (Gakkensai) & liability (Inbound futai-gakuso) insurance -National Pension Plan
4	Financial Support Section -Waiver or deferment of entrance fee/tuition -Scholarships (for Japanese students) -Student Commuter Certificate
Educational Affairs Division (2nd floor)	
5	Educational Records and Programs Section Educational Programs Section General Education Planning Section Liberal Education Operating Section -General Education classes
Student Exchange Division (2nd floor)	
6-A	General Affairs Section -Tohoku University International House/University House
6-B	International Education Section -Future Global Leadership Undergraduate Courses (= FGL Office) -Special curriculum (Japanese language) for international students -Scholarships (Japanese Government Scholarship, Honors Scholarship etc.)
6-C	Incoming Student Exchange Section -Incoming student exchange programs -Double Degree (Joint Education) Program (incoming)
6-D	Global Programs Section -TGL Program -Outgoing overseas programs (Study Abroad Program (SAP)/exchanges/COLABS) -English language learning -Scholarships for outgoing studies abroad
7	International Support Office -Resident Status, private apartments
Center for Career Support (3rd floor)	
8	Careers Advisory Section -Counseling and information on student career paths and job-finding -Internships and part-time employment

3rd floor of the West Wing: **Global Learning Center**

(8) International Exchange Building [A12]

The offices of professors' who teach General Education Subjects are located on the second floor of the International Exchange Building.

