



東 北 大 学

TOHOKU UNIVERSITY

April 1, 2022

**October 2021 Admission
FGL Program Undergraduate Courses
General Education Guidebook**

April 2022
Tohoku University

Table of Contents

	Page
● Academic Calendar of 2022 General Education Program.....	3
● Class Schedule of General Education Subjects.....	4
I General Education.....	5
1. Tohoku University's Admission/Diploma/Curriculum Policies for the Undergraduate Program	
2. Goals and Mission of General Education	
3. Terms & Semesters	
4. Classes & Credits	
5. General Education System	
II Registering for General Education Subjects.....	7
1. Registration Schedule	
2. Registration Group	
3. Registration Procedures	
4. Notes on Registration and Checking Grades	
5. Using Student-owned Computers for Educational Activities	
6. Campus Wi-Fi	
7. Internet School of Tohoku University (ISTU)	
8. Enrolling for Japanese Language	
III Examinations, Grading and Reports.....	11
1. Exam Schedule, Methods	
2. Notes on Examinations	
3. Makeup Examinations	
4. Grading	
5. GPA (Grade Point Average) System	
IV Introduction to Class Contents.....	13
1. Course Numbering Code	
2. Searching Syllabus Online	
1) Search by course, 2) Search by instructor, 3) Full-text search	
V General Education Class Information (FGL Program).....	20
1. List of Subjects	
2. Timetable	
VI Other.....	25
1. Medical Care Required due to Accidents in Class	
2. Using Educational Facilities	
3. Counseling Services	
4. Preventing Theft	
● Regulations on Tohoku University General Education Subjects.....	26
● Kawauchi Campus Map.....	31
1) Campus Map [Kawauchi], 2) Classroom, 3) Laboratories, 4) Multimedia Education and Research Complex, 5) Gymnasium, 6) Sub Arena, 7) Education and Student Support Center, Student Service, 8) International Exchange Building	

Academic Calendar of 2022 General Education Program

Spring Semester

Orientation for the third semester (Specialized subjects for each department)	【AMC】 April 8 (Fri.) Online orientation 【IMAC-U】 April 1 (Fri.) Online orientation 【AMB】 There will be no course orientation.
Classes in 3 rd Semester	April 11 (Mon.) – August 9 (Tue.), 2022 <1Q>April 11 (Mon.) – June 10 (Fri.), 2022 <2Q>June 6 (Mon.) – August 9 (Tue.), 2022
Class Registration by website	April 11 (Mon.) – April 22 (Fri.), 2022
Drop / Withdrawal for Class Registration	April 25 (Mon.) – May 13 (Fri), 2022
Medical Checkup	April 21(Thu.) – April 22(Fri.), 2022 or May 6 (Fri.) – May 25 (Wed.), 2022
Term-end Vacation	August 10 (Wed.) – September 30 (Fri.), 2022

Fall Semester

Classes in 4 th Semester	October 3 (Mon.) – February 3 (Fri), 2023 <3Q>October 3 (Mon.) – December 2 (Fri.), 2022 <4Q>November 28 (Mon.) – February 3 (Fri.), 2023
Class Registration by website	October 3 (Mon.) – October 14 (Fri.), 2022
Drop / Withdrawal for Class Registration	October 17 (Mon.) – October 31 (Mon.), 2022
Winter Break	December 28 (Wed.), 2022 – January 3 (Tue.), 2023
No classes due to National Center Test for University Admissions	January 13 (Fri.), 2023
Term-end Vacation	February 6 (Mon.), 2023 – late March

Class Timetable

Period	Class start/finish	Comments
1st Period	8:50 - 10:20	A chime will sound when classes start/finish.
2nd Period	10:30 - 12:00	
3rd Period	13:00 - 14:30	
4th Period	14:40 - 16:10	
5th Period	16:20 - 17:50	

2022-2023 Academic Calendar

General Education Subjects

April 2022						
Su	M	Tu	W	Th	F	Sa
					1	2
3	4	5	6	7	8	9
10	11	12	13	14	15	16
17	18	19	20	21	22	23
24	25	26	27	28	29	30

May 2022						
Su	M	Tu	W	Th	F	Sa
1	2	3	4	5	6	7
8	9	10	11	12	13	14
15	16	17	18	19	20	21
22	23	24	25	26	27	28
29	30	31				

June 2022						
Su	M	Tu	W	Th	F	Sa
			1	2	3	4
5	6	7	8	9	10	11
12	13	14	15	16	17	18
19	20	21	22	23	24	25
26	27	28	29	30		

July 2022						
Su	M	Tu	W	Th	F	Sa
					1	2
3	4	5	6	7	8	9
10	11	12	13	14	15	16
17	18	19	20	21	22	23
24	25	26	27	28	29	30
31						

August 2022						
Su	M	Tu	W	Th	F	Sa
	1	2	3	4	5	6
7	8	9	10	11	12	13
14	15	16	17	18	19	20
21	22	23	24	25	26	27
28	29	30	31			

September 2022						
Su	M	Tu	W	Th	F	Sa
				1	2	3
4	5	6	7	8	9	10
11	12	13	14	15	16	17
18	19	20	21	22	23	24
25	26	27	28	29	30	

October 2022						
Su	M	Tu	W	Th	F	Sa
						1
2	3	4	5	6	7	8
9	10	11	12	13	14	15
16	17	18	19	20	21	22
23	24	25	26	27	28	29
30	31					







November 2022						
Su	M	Tu	W	Th	F	Sa
		1	2	3	4	5
6	7	8	9	10	11	12
13	14	15	16	17	18	19
20	21	22	23	24	25	26
27	28	29	30			

December 2022						
Su	M	Tu	W	Th	F	Sa
				1	2	3
4	5	6	7	8	9	10
11	12	13	14	15	16	17
18	19	20	21	22	23	24
25	26	27	28	29	30	31

January 2023						
Su	M	Tu	W	Th	F	Sa
1	2	3	4	5	6	7
8	9	10	11	12	13	14
15	16	17	18	19	20	21
22	23	24	25	26	27	28
29	30	31				

February 2023						
Su	M	Tu	W	Th	F	Sa
			1	2	3	4
5	6	7	8	9	10	11
12	13	14	15	16	17	18
19	20	21	22	23	24	25
26	27	28				

March 2023						
Su	M	Tu	W	Th	F	Sa
			1	2	3	4
5	6	7	8	9	10	11
12	13	14	15	16	17	18
19	20	21	22	23	24	25
26	27	28	29	30	31	

-  Classes are held
-  No classes
-  Make up classes for Wednesday will be held on August 8.
-  Make up classes for Thursday will be held on August 9
-  Make up classes for Friday will be held on December 27.
-  Insetive Courses

Apr 11	First day of Spring Semester
Aug 9	Last day of Spring Semester

Oct 3	First day of Fall Semester
Oct 28 - Oct 30	University Festival - no class
Dec 28 - Jan 3	All offices are closed due to New Year's holidays
Feb 6	Last day of Fall Semester

I General Education

1. Tohoku University's Admission/Diploma/Curriculum Policies for the Undergraduate Program

○Admission Policy

Tohoku University seeks students who sympathize with the university's mission, and who possess either/both of the following:

- (1) The desire to significantly contribute as researchers by seriously addressing the issues facing 21st century human society or
- (2) The desire to significantly contribute to the development of society as high-level professionals with abundant knowledge and leadership, and the strength of will, bold academic curiosity, and fundamentally excellent academic abilities to realize this desire.

○Diploma Policy

Tohoku University confers the bachelor's degree on students who achieve the following goals.

- (1) Obtain knowledge in their specialized fields and a multifaceted perspective based on an interest in and broad knowledge of academia in general.
- (2) Obtain the education necessary to become accomplished adults, and be able to contribute to society using expertise specific to their fields of specialization.
- (3) Have the awareness and vision to assume leadership/core roles in the global community while developing fundamental abilities.

○Curriculum Policy

Tohoku University structures and implements its educational curriculum as follows to ensure that students meet the goals described in the Diploma Policy.

- (1) Offer a curriculum that creates organic links between General Education Subjects to foster broad knowledge and education, and Specialized Subjects to confer basic knowledge of specialized fields.
- (2) Following the principle of "Research First," promote the development of educational methods and establishment of educational systems while implementing active learning both in and out of class.
- (3) Develop the students' ability to learn independently by evaluating learning achievements and applying the results.

2. Goals and Mission of General Education

The goals of this university's General Education program are to foster students who possess specialized knowledge that they can use in practical society and advanced research, comprehensive, modern knowledge and deep compassion, and an international perspective. It will fulfill basic educational requirements, providing the foundations for specialized and/or graduate education, and confer the below fundamental basic abilities, knowledge and expertise:

- 1) Basic knowledge and expertise needed for modern, international citizens to lead a social life
- 2) Basic accomplishments and skills that will provide core character-building for the modern world
- 3) Knowledge and skills related to a wide range of academic fields in order to aid understanding in specialized majors
- 4) Basic knowledge and skills required to study more specialized areas

In order to achieve these goals, the General Education curriculum is composed of three subject types: Core Subjects, Expansion Subjects, and Common Subjects. Classes comprising each subject group shall be carried out to meet the following goals:

Core Subjects	<ul style="list-style-type: none"> ▪ These subjects are comprised of Human Studies, Social Studies and Science Studies. ▪ Students, regardless of major, will acquire knowledge and expertise related to topical themes in the fields of ethics, culture, linguistic expression, gender, economics, social studies, politics, history, life sciences and environmental studies. Through this they will gain a wide understanding of and flexible, multifaceted perspective on various phenomena in humanities, sociology and natural science, and cultivate knowledge and expertise that will form the foundations of their intellectual endeavors, backed by a rich set of abilities and human compassion.
Expansion Subjects	<ul style="list-style-type: none"> ▪ These subjects are comprised of human sciences, social sciences, natural sciences (composed of six groups in mathematics, physics, chemistry, biology, earth and space science, scientific experiments), and integrated sciences. ▪ The expansion subjects will build on the fundamental knowledge and expertise acquired in the core subjects to provide students with the perspective and learning needed to develop

	foundational knowledge related to humanities, sociology, and natural sciences and find multidisciplinary solutions to topical problems. In addition, classes will introduce students to the academic careers of various researchers, thus increasing their interest in academia, providing them with the scholastic and human foundations for further specialized/graduate education.
Common Subjects	<ul style="list-style-type: none"> • Common Subjects are comprised of Small-Group Freshmen Seminar(Introductory Seminar) , foreign languages, information science, and health/physical education, in addition to international student subjects designed especially for international students. • Common subjects will foster abilities and basic education and expertise that are indispensable for living in the modern world, such as subjective judgment abilities based on social ethics, decision-making and communication skills, international communication abilities and cultural understanding, basic knowledge and skills related to information science, and the knowledge and expertise needed to maintain and improve mental and physical wellness. These subjects aim to provide students with abilities and expertise that will form the starting point for self-advancement.

3. Terms & Semesters

Tohoku University uses a two-semester system, with the period of April 1 to September 30 defined as first semester, and October 1 to March 31 as second semester. The semester comprises the basic unit of the education curriculum; General Education lasts from the 2nd to 4th semesters. **FGL Students will begin classes from the 2nd Semester.**

1st Year	2nd Year				3rd & 4th Year
Fall	Spring		Fall		5th – 8 th /9 th Semester
2nd Semester	3rd Semester		4th Semester		
	1st Quarter	2nd Quarter	3rd Quarter	4th Quarter	

4. Classes & Credits

Each class is held 15 times (weeks) per semester, and consists of lectures, seminars, experiments, laboratory work, skill tests, or some combination of these. Some classes may be implemented in intensive lectures. The number of credits reflects the amount of academic work performed, with one credit requiring 45 hours of study. General Education subjects confer two credits in consideration of the methods used in class, educational effect, and amount of study required outside of class, as indicated below.

Class Format	Hours of Class	Content of Study
Lectures	30 hrs.	Students take 15 ninety-minute classes, a course of four-hour lectures, a 2-4 hour seminar, experiments, laboratory work, and skill tests, requiring 2 hours per class of preparation/review.
Seminars	30 - 60 hrs.	
Experiments, Laboratory Work, Skill Tests	60 - 90 hrs.	

General Education uses the below 3 subject/class formats.

- **Introductory Seminar:** These subjects were established to introduce new students to university-level education and research, and provide them with a "shift in learning" from "high school education" to "university education." Class sizes are small (20 students or less) and incorporate autonomous learning. Students are expected to participate actively.
- **Advanced Seminar:** These build on the autonomous learning methods that students learn in the Introductory Seminars. The classes incorporate active learning through seminars, practical training, experiments, and fieldwork. They cover a wide variety of subject types and groups.
- **International Coeducational Seminar:** "International Coeducation" fosters an attitude of acceptance and understanding for diversity among students of varying languages and cultures through collaborative group work and projects. It provides learning experiences that make students reexamine their own values, and build new ones. International Coeducational Seminars provide these learning opportunities in a small-group seminar format.

5. General Education System

General Education is for all students at the university. The Academic Affairs Council, which is composed of educators from every department, is responsible for planning and operating its subject categories and groups and performs overall coordination and supervision. The Institute for Excellence in Higher Education (IEHE) also provides support for its university-wide system. The IEHE was founded in April 2014 by merging five independent educational organizations at Tohoku University in order to implement advanced liberal arts education and provide a higher level of student support. Instructors from each department of the faculties, graduate schools, research institutes/centers, and the university hospital are responsible for General Education classes, and take part in a supportive, cooperative university-wide class-management system to provide students an educational foundation with a broad perspective.

II Registering for General Education Subjects

1. Registration Schedule

Students must register for classes in compliance with rules on required subjects (subjects which students must take), recommended subjects (classes that students are urged to take) and registration prerequisites (in cases where students cannot register for one class unless they have already completed another class) as per the student handbook for their faculty, class timetables, and this guidebook.

The number of General Education subjects that are taught in English and open to Future Global Leadership Undergraduate Courses students is limited, so FGL students should register as per the Class Timetable for the FGL Courses.

Students wishing to take classes that are not listed on the FGL Class Timetable must have sufficient Japanese ability. Please contact the Student Affairs Division in advance.

Notes on General Education subjects Registration

- Classes that are not designated by your faculty's Student Guide will not be credited towards graduation requirements.
- Please register for classes in the appropriate semester, as listed in your faculty's Student Handbook. You cannot register for a class before the appropriate semester (advanced registration) as designated by the faculty (department/division).
- Students cannot register for two subjects with the same subject name, even if the topics, instructors, semester, and day/time of the two subjects are different. The same applies to taking a subject with the same name as one for which the student has already received credit.

2. Registration Group

- ① As class schedules are drawn up with consideration for class sizes in each faculty/year/division, in general you must register within groups created for your own faculty (own division). In principle, you cannot register for classes in groups other than those created for your own faculty (i.e. in other divisions).
- ② Even in classes held for your own faculty, groups are sometimes further subdivided by Student ID Number.
- ③ For classes outside your division, it is possible that you will not be given permission to register due to the class content or class size.

3. Registration Procedures

- 1) In order to register for classes (and receive credits), it is necessary to complete the registration procedures. If you do not complete these procedures, you will not be able to receive credit.
- 2) The registration procedures are Web-based. In general, the classes you enter cannot be changed except during the Web-based registration confirmation/revision period. During this period, please check your registration details online, and make any necessary changes at the Student Affairs Division.
- 3) Web-based registration is performed separately for each semester. You can also check your grades and credits online.
- 4) You should inquire at the FGL office when registering for classes outside your division.

4. Notes on Registration and Checking Grades

(1) Web-based registration, confirmation/revision period

Spring semester: April 11 (Mon.) – April 22 (Fri.)

Fall semester: October 3 (Mon.) – October 14 (Fri.)

- ① In order to take courses (receive credit), you need to complete registration. **If you do not undergo Web-based registration, you will not receive credit for classes even if you attend the lectures and take the exams.**
- ② Course registration will be conducted via the Student Affairs Information System website during the above period per semester.

Student Affairs Information System: <https://www.srp.tohoku.ac.jp/>

*Operation Manual is available from the following website.

https://www.srp.tohoku.ac.jp/gkms/manual/img/manual_students_en.pdf



*It requires a Tohoku University ID and password to perform Web-based registration.

*The server will receive heavy access on the final day of registration, so try to finish registering your classes before then.

*Remember that “Google Classroom” is not official class registration. Please be sure to register both. So does canceling classes.

- ③ Be sure to click the "Confirm Entry" button on the Web-based registration page.
*After registering, you can make changes as many times as needed until the end of this registration period.
- ④ After the deadline, it is unable to change registration. Please confirm your registration carefully in advance.
- ⑤ Please be sure to register and confirm your course registration as early as possible, as the system connection may not always be successful due to heavy access on the deadline.

(2) Procedures for deregistering classes

Spring semester: April 25 (Mon.) – May 13 (Fri.)

Fall semester: October 17 (Mon.) – October 31 (Mon.)

- ① If you wish to "deregister" a class for which you have finalized registration, you must ask the course instructor to get approval by email and submit class cancellation form during the designated period above.
Use DC Mail account when you send an e-mail to the instructor as your identification.
*Class cancellation form will be informed by Academic Affairs Division in advance.
- ② **If you perform the required procedures, you will not be graded for that class, and your grades will show an "E" (deregistered) instead.**
- ③ By registering for a class, you commit to taking that class and being graded on it. **If you abandon a class before completing it, you will receive a D grade (Fail).**

(3) Confirming grades

Spring semester: will be announced on August 24 (Wed.)

Fall semester: will be announced on February 15 (Wed.)

- ① Please confirm your grades online using the "Grades Inquiry" screen via Student Affairs Information System. If you set a "Private key for the SRP image-matrix authentication" from the campus network, you will be able to check your grades from off-campus using the SRP. (For details, see: <https://www.dc.tohoku.ac.jp/guide/srp/srp-e.html>)
- ② For details on grading, please see "III Examinations, Grading and Reports."

5. Using Student-owned Computers for Educational Activities

For some time, Tohoku University has used CALL materials for foreign language education and learning management, and we encourage students to use their own laptop computers for educational purposes in order to improve the educational reach of the ICT-based on-demand lectures we offer. Please check the General Education class syllabi to see whether your classes require a computer.



6. Campus Wi-Fi

All campuses have Wi-Fi access points in key locations for wireless Internet service (via eduroam). For connection instructions and other details, please refer to "Online Guide: Information Services for Education in Tohoku University" (<https://www.dc.tohoku.ac.jp/guide/wifi/wifi-e.html>).

7. Internet School of Tohoku University (ISTU)

ISTU is a web service that can be accessed with your Tohoku University ID and password to obtain educational/study support over the Internet. You can use it to access class materials etc. distributed by your instructors as digital files and digital content in a variety of formats, including streaming video, to further your studies.

The service offers various educational/learning features, such as submitting reports as digital files, implementing comprehension tests, sending announcements from the instructor to students, and conducting discussions on online forums.

To learn more about ISTU, please refer to "Online Guide: Information Services for Education in Tohoku University."

<https://www.dc.tohoku.ac.jp/guide/istu/istu4g-e.html>



8. Enrolling for Japanese Language

Students on the FGL Courses are required to take 10 credits of Japanese language. Students who have taken the "Japanese Language Proficiency Test" or the "Examination for Japanese University Admission for International Students" and met certain conditions, specified elsewhere, may apply to have their test results recognized in place of coursework, and receive up to seven of the required 10 Japanese language credits.

International students at this university who have obtained a designated number of points on Japanese language tests etc. shall be considered to have completed a Japanese language class, and shall be awarded a predetermined number of credits upon application.

Agreement on Credit Awards for Japanese Language Tests etc. Academic Affairs Council January 5, 2011

1. As per Articles 26-6 and 26-7 of the Tohoku University Faculty Regulations, and as elsewhere stipulated by the Minister of Education, Culture, Sports, Science and Technology, students who have obtained the specified number of points on the Japanese language tests etc., and students for whom it is recognized to be educationally beneficial by their faculty, shall be considered by this University to have completed a Japanese language class, and shall be awarded credits, as stipulated by the rules of their faculty.
2. Faculties that may approve these credits are as follows.
Faculty of Science, School of Engineering, Faculty of Agriculture (students belonging to Future Global Leadership Undergraduate Courses)
3. Foreign language subjects for which these credits can be awarded are as follows.
Japanese
4. Japanese language tests for which credits can be awarded, criterion for recognition, and number of credits are as follows.
Subject: Japanese
Name of Test:
 - i) Japanese Language Proficiency Test—JLPT (Japan Educational Exchanges and Services)
 - ii) Examination for Japanese University Admission for International Students—EJU (Japan Student Services Organization)

Criterion and Number of Credits:

Criterion	Number of Credits	Score	Subject
JLPT N3 or higher	7	AA	Basic Japanese 1 (4 Credits)
		AA	Basic Japanese 2 (3 credits)
		AA	Intermediate Japanese (3 credits)
JLPT N4	7	AA	Basic Japanese 1 (4 Credits)
		AA	Basic Japanese 2 (3 credits)
JLPT N5	4	AA	Basic Japanese 1 (4 Credits)
EJU 220 points or higher (Not including Writing)	7	AA	Basic Japanese 1 (4 Credits)
		AA	Basic Japanese 2 (3 credits)
		AA	Intermediate Japanese (3 credits)
EJU 200 points or higher (Not including Writing)	7	AA	Basic Japanese 1 (4 Credits)
		AA	Basic Japanese 2 (3 credits)

5. Application Instructions
 - i) Documents required for the application are the application form and a copy of the test certificate or score sheet.
 - ii) The date entered on the test certificate or score sheet must be less than two years prior to the date of application.
6. Certification Procedure
 - i) Certification of credits will be performed by the Foreign Language Committee of the Academic Affairs Council (hereafter, Foreign Language Committee) based on a copy of the test certificate or score sheet.
 - ii) Results of screenings by the Foreign Language Committee will be reported to the Educational Records and Programs Committee of the Academic Affairs Council.
 - iii) Credits for applications submitted before the end of January or the end of June will be certified the same semester; credits for applications submitted after February 1 or July 1 will be certified the following semester
7. Any items necessary for credit certification, other than those specified in this agreement, will be specified by the Foreign Language Committee.

Supplementary Regulation Ratified on October 1, 2011
Supplementary Regulations (Revised October 5, 2015)
Made effective October 1, 2015; ratified on October 5, 2015

*Japanese class; Intermediate Japanese (3 credits)

Students who feel that the class does not match their Japanese abilities may instead select 3 subjects (3 credits) from the General Education Japanese A-J classes (1 credit each; aimed at advanced JLPT N1-level students). These subjects are held for privately financed international students belonging to degree courses taught in Japanese.

If you wish to do this, speak to your Japanese language instructor in advance to confirm that your abilities will be sufficient before registering. Inquire with the FGL staff in the Student Exchange Division or General Education Operating Section in the Educational Affairs Division for the Japanese A-J timetable.

III Examinations, Grading and Reports

1. Exam Schedule, Methods

Examinations will be conducted by class instructors during the course. Please follow your instructor's directions when taking examinations. Information on examinations may sometimes be announced on bulletin boards, so please check them carefully.

Grading methods for each subject are described in the syllabus.

2. Notes on Examinations

Please observe the following when taking examinations. Engaging in misconduct, such as using unauthorized textbooks, dictionaries, reference materials, notes, memos etc., looking at other students' answers, or exchanging answers during the examination will be severely punished (**indefinite suspension etc.**) as a violation of student regulations. **Do not, under any circumstance, engage in such activities.**

- (1) Follow the instructions given by the supervising instructor in the examination room.
- (2) In the examination room, fill seats from the front of the room, and place your Student ID on your desk during the examination.
- (3) Do not place anything else on your desk except writing utensils and other items explicitly permitted by the supervising instructor. (Confirm in advance whether notes/references can be used.)
- (4) If you require a desk mat/underlay when writing, ask for permission from the supervising instructor.

3. Makeup Examinations

If you are unable to take an examination due to illness, accident, or bereavement (loss of an immediate family member), you can apply through the Student Affairs Division to take a makeup examination for up to three days after the end of the relevant examination, excluding Saturdays, Sundays, and national holidays. The following documents are required.

- For illness: Doctor's diagnosis
- For accidents: Accident Report Form
- For bereavement: Corroborating documentation

4. Grading

Grading is described in the syllabus for each subject.

However, grading for General Education subjects is handled as follows.

1. Grading for General Education subjects is as follows.

Grade	Description of Evaluation	Criteria for Points (out of 100)
AA	The student's performance was particularly exceptional.	90 – 100 points
A	The student's performance was excellent.	80 – 89 points
B	The student's performance was above average.	70 – 79 points
C	The student passed.	60 – 69 points.
D	The student failed or quit the class.	59 points or below
E	The student deregistered as per the proscribed procedures.	—

Comments

- 1) Grading and evaluation will take into account examination performance, reports submitted, attendance, and registration status.
 - 2) The "AA" grade was implemented for incoming students in the 2004 academic year onward; for students who enrolled prior to 2004, there is no distinction between the "AA" and "A" grades.
 - 3) The grade designated as "E" will be given under the following conditions.
 - a) If the student deregisters at the Student Affairs Division during a designated period.
 - b) The student takes a leave of absence, or withdraws, from the university
 - 4) This grading system is effective as of the subjects taught in the 2013 academic year onward.
2. The syllabus will provide descriptions of educational goals (academic achievement goals) and specific evaluation methods for each subject; in general, absolute evaluations will be based on the correspondence of student performance with the educational goals set for each subject.
 3. Class instructors shall store student examination answer sheets for one year from the date of the examination, and reports etc. for one year from their due date, to serve as a basis for grading and to respond to any requests for information disclosure from students. However, this requirement does not apply to reports that are returned to the students with grades/comments; in the case of examination answer sheets, it is recommended that the instructor store the original and return a copy. (Reference: Tohoku

University Criteria on Length of Storage Period for Documents: One year or less for examination answer sheets and reports.)

4. The Academic Affairs Division offers that students can request that the class instructor explain the grades they received, so long as they do so within a designated period of time following the announcement of grades. However, if a student is unable, for legitimate reasons, to make this request during that period, the student may receive an explanation at a later time, as long as it is within the one-year storage period.
5. If the student is still unsatisfied after hearing the class instructor's explanation regarding the grade, the Academic Affairs Division offers that student can file a petition with the chairperson of the Educational Records and Programs Committee of the Academic Affairs Council (hereafter "Educational Records and Programs Committee").
6. Upon receiving a petition of dissatisfaction, the Educational Records and Programs Committee shall set up a subcommittee, composed of several members to investigate its validity.
7. The Grading Improvement Committee of the Academic Affairs Council shall compile and analyze grades, and release their findings to the class instructors and students.

* Designated time periods is within two weeks after the announcement of grades.

* A petition of dissatisfaction should be filed when the student is still unsatisfied after hearing the class instructor's explanation regarding the grade, not when the student who failed the class wishes to take a makeup exam. Students should not visit instructor's office without an appointment.

5. GPA (Grade Point Average) System

In FY 2016, the GPA system was adopted by Tohoku University to increase the students' academic motivation, contribute to the provision of appropriate learning guidance, promote rigorous grade evaluation, and improve the quality of learning. The GPA system will be applied to undergraduate curriculum students who enter in FY 2016 and later.

Discretion on how to utilize GPA is left up to the individual faculties.

➤ Grades and GP

Grade Points (GP) will be assigned in accordance with each faculty's regulations, faculty-specific regulations on registration, and the regulations on General Education, as per the following table.

Evaluation		GP
Letter Grade	Score	
AA	100-90	4.0
A	89-80	3.0
B	79-70	2.0
C	69-60	1.0
D	59-0	0.0

➤ GPA Categories and Calculation Method

Tohoku University has two types of GPA: one that indicates learning progress and achievements for the relevant semester (hereafter "semester GPA"), and one that indicates learning progress and achievements for the entire period of enrollment at the university (hereafter "cumulative GPA").

The semester and cumulative GPAs will be calculated with the below formulas, and the resulting numbers rounded to the 3rd decimal place.

$$\text{Semester GPA} = \frac{\text{Total of (GP for each class evaluated for the semester} \times \text{the number of credits for relevant classes)}}{\text{Total credits for the classes evaluated for the semester}}$$

$$\text{Cumulative GPA} = \frac{\text{Total of (GP for each class evaluated during the entire enrollment period} \times \text{the number of credits for relevant classes)}}{\text{Total credits for the classes evaluated for the entire enrollment period}}$$

➤ Classes Affecting GPA

The below classes will be excluded from the student's semester and cumulative GPAs.

- 1) Classes for which the student has, by the prescribed date, applied, and received permission, to deregister.
- 2) Classes designated by the Chairperson of the Academic Affairs Council, or the Faculty Dean or Department Director.

IV Introduction to Class Contents

1. Course Numbering Code

A) Course Numbering

Course Numbering is a system in which codes indicating a variety of information of each class, such as subject category and levels of difficulty, in order to clarify the curriculum structure.

By assigning codes and numbers to each class has a unique code to clarify its difficulty level/characteristics, significance, and the sequence in which courses should be taken, students can understand which classes they should register for, the role of each class within the undergraduate/graduate curriculum, and each course's objectives.

Also, clarifying course levels is expected to facilitate credit transfers with overseas universities.

B) Coding Method

Course Numbering at Tohoku University is organized as follows.

In general, the codes will be fixed for each class instead of being reassigned every academic year. However, codes may be reassigned in some cases, such as when there are major revisions to the class content.

a) Example of Course Numbering Code

A BC - (hyphen) DEF 1 23 G
 ①② ③ ④ ⑤ ⑥

b) Meanings of Each Segment of the Code:

- ① Hosting Faculty/School
- ② Department/Major (for General Education etc., subject category/group)
- ③ Academic Field
- ④ Level/Characteristics
- ⑤ Classification Number
- ⑥ Language Used in Class

c) List of Each Segment Code

① List of Hosting Faculty/School Codes (single letter)

These codes are the same as the letter that indicates the student's faculty/graduate school, shown as the third letter of the student ID number; General Education Subjects (faculty code: Z) and Teacher Training Subjects (faculty code: Q) were assigned letters not already in use.

Faculty/Graduate School	Faculty Code
Faculty of Science/Graduate School of Science	S
School of Engineering/Graduate School of Engineering	T
Faculty of Agriculture/Graduate School of Agricultural Science	A

Faculty/Graduate School	Faculty Code
General Education Subjects	Z
Teacher Training Subjects	Q

② List of Department/Major Codes (two letters) *Those for only General Education are shown here.

General Education	Core Subjects	Human Studies	BH
		Social Studies	BS
		Science Studies	BN
	Expansion Subjects	Human Sciences	DH
		Social Sciences	DS
		Natural Sciences	DN
		Integrated Sciences	DG
	Common Subjects	Small-Group Freshmen Seminars	CS
		Foreign Languages	CF
		Information Sciences	CI
		Health Sciences	CP
		Subjects for International Students	CJ
	Teacher Training Subjects		TL

- ③ Academic Field Codes (three letters)
As shown in "III Course Numbering for General Education"

- ④ List of Levels/Characteristic Codes (one number) *only General Education is shown here

Class Type/Group/Subject		Code	
Core Subjects		8	
Expansion Subjects	Human Sciences, Social Sciences, Natural Sciences	1	
	Integrated Sciences	8	
Common Subjects	Introductory Seminar	8	
	Foreign Languages (English)	English A1, A2, B1, B2	1
		English C1, C2, Practical English Skills 1-2	2

	Foreign Languages (Second languages)	Introduction to Foreign Language I, II	1
		Foreign Language in Practice I, II, III, IV	2
	Others		1
Teacher Training Subjects			1

- ⑤ Classification Number (two numbers)
Classification Numbers are assigned for Course Numbering administration purposes; they are not sequential.

- ⑥ Codes for Language Used in Class (one letter)
Languages used in classes will be coded as follows.

Language Used	Code
Japanese	J
English	E
Non-English foreign languages	F
Two or more languages	B

These codes will be assigned per class instructor, in accordance with the syllabus for the relevant academic year.

(Ex.)

General Education Subject "Foundation of Calculus" taught by Professor XX (Japanese) ZDN-MAT104J

General Education Subject "Foundation of Calculus" taught by Associate Professor YY (English) ZDN-MAT104E

2. Searching Syllabus Online

Course syllabi can be viewed in the Student Affairs Information System. It requires your Tohoku University ID and password to log into the system. While syllabi may additionally be viewed in other locations such as the university websites and the QuickSyllabus, the posting in the Student Affairs Information System is the most up-to-date information.

The Student Affairs Information System:

PC, smartphone: <https://www.srp.tohoku.ac.jp/>

Top Page *These images are the ones as of February 2019. They may differ from the actual pages.

Requires Tohoku University ID and password to log in. Contact the FGL Office if you have any questions.
For more information on image-matrix authentication, please refer to the online guide (<https://www.dc.tohoku.ac.jp/guide/srp/srp.html>).

Off-campus access

Image Matrix Authentication



Change the language to English.

Click "Home" or "配置 / 言語設定", then you will see the page "配置 / 言語設定 (language settings)".

コンテンツ名	横幅	横位置	縦位置	幅可変
講義のお知らせ			2	<input checked="" type="checkbox"/>
お知らせ表示(全体)			1	<input checked="" type="checkbox"/>
お知らせ表示(個人宛)			2	<input checked="" type="checkbox"/>
スケジュール表示(日)			1	<input checked="" type="checkbox"/>
スケジュール表示(週間)	3	0	0	<input type="checkbox"/>

After selecting "English", click the button "更新 (update)". To change the language, you are required to log out, and then log in again. Click “ログアウト (log out)” on the top right.

言語設定

言語 Japanese English

推奨設定に戻す クリア 更新

- キャビネット一覧
- 個人種別選択
- ユーザー設定
- 配置/言語設定
- アカウントリセット

リンク

- 教育系情報システム
- 全学教育シラバス

Online syllabus search

HOME | School Affairs | Courses/Grades | Student Services | Job-search Support | **Syllabus** <<Usage Time 7:00>>

Search from Course

Search Condition

Search by selecting school year to search a syllabus and specifying each search conditions

Selection screen for the types of search will be displayed on the right:

- Search from Course
- Search by Instructor
- Search Entire Text
- Online Manual

School Year	2022	School Year					
Curriculum	--Not Selectd--	<input type="checkbox"/> Exc					
Field and Category	--Not Selectd--	(If you want to specify a field and category, you must select Curriculum.)					
Target Grade	--Not Selectd--	(If you want to specify a target grade, you must select curriculum.)					
Course Name	<input type="text"/>						
Instructor in Charge	<input type="text"/>						
Class Starting Time	--Not Selectd--						
	Mon	Tue	Wed	Thu	Fri	Sat	Other
1	<input type="checkbox"/>	<input type="checkbox"/>	<input type="checkbox"/>	<input type="checkbox"/>	<input type="checkbox"/>	<input type="checkbox"/>	<input type="checkbox"/>
1(First half)	<input type="checkbox"/>	<input type="checkbox"/>	<input type="checkbox"/>	<input type="checkbox"/>	<input type="checkbox"/>	<input type="checkbox"/>	<input type="checkbox"/>
1(Second half)	<input type="checkbox"/>	<input type="checkbox"/>	<input type="checkbox"/>	<input type="checkbox"/>	<input type="checkbox"/>	<input type="checkbox"/>	<input type="checkbox"/>
2	<input type="checkbox"/>	<input type="checkbox"/>	<input type="checkbox"/>	<input type="checkbox"/>	<input type="checkbox"/>	<input type="checkbox"/>	<input type="checkbox"/>
2(First half)	<input type="checkbox"/>	<input type="checkbox"/>	<input type="checkbox"/>	<input type="checkbox"/>	<input type="checkbox"/>	<input type="checkbox"/>	<input type="checkbox"/>
2(Second half)	<input type="checkbox"/>	<input type="checkbox"/>	<input type="checkbox"/>	<input type="checkbox"/>	<input type="checkbox"/>	<input type="checkbox"/>	<input type="checkbox"/>

(1) Search by Course

When planning registration this allows you to efficiently check the timetable, search for only subjects for which you are eligible to register, and browse them by day/class time. Use “Search from Course” to do this.

Search from Course

Search Condition

Search by selecting school year to search a syllabus and specifying each search conditions

Search Syllabus

School Year	2022▼ School Year																																																																																																																
Curriculum	--Not Selectd-- <input type="checkbox"/> Excluding Other Department																																																																																																																
Field and Category	--Not Selectd-- ▼ <small>(If you want to specify a field and category, you must select Curriculum.)</small>																																																																																																																
Target Year	--Not Selectd-- ▼ <small>(If you want to specify a target grade, you must select curriculum.)</small>																																																																																																																
Course Name	<input type="text"/>																																																																																																																
Instructor in Charge	<input type="text"/>																																																																																																																
Class Starting Time	--Not Selectd-- ▼																																																																																																																
Subject Numbering	<input type="text"/> P																																																																																																																
Faculty	--Not Selectd--																																																																																																																
Department	--Not Selectd-- ▼																																																																																																																
Academic Disciplines	--Not Selectd-- ▼																																																																																																																
Level	--Not Selectd-- ▼																																																																																																																
Used Language	--Not Selectd-- ▼																																																																																																																
Class Period	<table border="1" style="width: 100%; border-collapse: collapse; text-align: center;"> <thead> <tr> <th></th> <th>Mon</th> <th>Tue</th> <th>Wed</th> <th>Thu</th> <th>Fri</th> <th>Sat</th> <th>Other</th> </tr> </thead> <tbody> <tr> <td>1</td> <td><input type="checkbox"/></td> <td><input type="checkbox"/></td> <td><input type="checkbox"/></td> <td><input type="checkbox"/></td> <td><input type="checkbox"/></td> <td><input type="checkbox"/></td> <td><input type="checkbox"/></td> </tr> <tr> <td>4(Second half)</td> <td><input type="checkbox"/></td> <td><input type="checkbox"/></td> <td><input type="checkbox"/></td> <td><input type="checkbox"/></td> <td><input type="checkbox"/></td> <td><input type="checkbox"/></td> <td><input type="checkbox"/></td> </tr> <tr> <td>5</td> <td><input type="checkbox"/></td> <td><input type="checkbox"/></td> <td><input type="checkbox"/></td> <td><input type="checkbox"/></td> <td><input type="checkbox"/></td> <td><input type="checkbox"/></td> <td><input type="checkbox"/></td> </tr> <tr> <td>5(First half)</td> <td><input type="checkbox"/></td> <td><input type="checkbox"/></td> <td><input type="checkbox"/></td> <td><input type="checkbox"/></td> <td><input type="checkbox"/></td> <td><input type="checkbox"/></td> <td><input type="checkbox"/></td> </tr> <tr> <td>5(Second half)</td> <td><input type="checkbox"/></td> <td><input type="checkbox"/></td> <td><input type="checkbox"/></td> <td><input type="checkbox"/></td> <td><input type="checkbox"/></td> <td><input type="checkbox"/></td> <td><input type="checkbox"/></td> </tr> <tr> <td>6</td> <td><input type="checkbox"/></td> <td><input type="checkbox"/></td> <td><input type="checkbox"/></td> <td><input type="checkbox"/></td> <td><input type="checkbox"/></td> <td><input type="checkbox"/></td> <td><input type="checkbox"/></td> </tr> <tr> <td>6(First half)</td> <td><input type="checkbox"/></td> <td><input type="checkbox"/></td> <td><input type="checkbox"/></td> <td><input type="checkbox"/></td> <td><input type="checkbox"/></td> <td><input type="checkbox"/></td> <td><input type="checkbox"/></td> </tr> <tr> <td>6(Second half)</td> <td><input type="checkbox"/></td> <td><input type="checkbox"/></td> <td><input type="checkbox"/></td> <td><input type="checkbox"/></td> <td><input type="checkbox"/></td> <td><input type="checkbox"/></td> <td><input type="checkbox"/></td> </tr> <tr> <td>7</td> <td><input type="checkbox"/></td> <td><input type="checkbox"/></td> <td><input type="checkbox"/></td> <td><input type="checkbox"/></td> <td><input type="checkbox"/></td> <td><input type="checkbox"/></td> <td><input type="checkbox"/></td> </tr> <tr> <td>7(First half)</td> <td><input type="checkbox"/></td> <td><input type="checkbox"/></td> <td><input type="checkbox"/></td> <td><input type="checkbox"/></td> <td><input type="checkbox"/></td> <td><input type="checkbox"/></td> <td><input type="checkbox"/></td> </tr> <tr> <td>7(Second half)</td> <td><input type="checkbox"/></td> <td><input type="checkbox"/></td> <td><input type="checkbox"/></td> <td><input type="checkbox"/></td> <td><input type="checkbox"/></td> <td><input type="checkbox"/></td> <td><input type="checkbox"/></td> </tr> <tr> <td>Team lecture</td> <td><input type="checkbox"/></td> <td><input type="checkbox"/></td> <td><input type="checkbox"/></td> <td><input type="checkbox"/></td> <td><input type="checkbox"/></td> <td><input type="checkbox"/></td> <td><input type="checkbox"/></td> </tr> <tr> <td>Other</td> <td><input type="checkbox"/></td> <td><input type="checkbox"/></td> <td><input type="checkbox"/></td> <td><input type="checkbox"/></td> <td><input type="checkbox"/></td> <td><input type="checkbox"/></td> <td><input type="checkbox"/></td> </tr> </tbody> </table> <p><small>(If you want to specify the class period, you must select the class starting time.)</small></p>		Mon	Tue	Wed	Thu	Fri	Sat	Other	1	<input type="checkbox"/>	<input type="checkbox"/>	<input type="checkbox"/>	<input type="checkbox"/>	<input type="checkbox"/>	<input type="checkbox"/>	<input type="checkbox"/>	4(Second half)	<input type="checkbox"/>	<input type="checkbox"/>	<input type="checkbox"/>	<input type="checkbox"/>	<input type="checkbox"/>	<input type="checkbox"/>	<input type="checkbox"/>	5	<input type="checkbox"/>	<input type="checkbox"/>	<input type="checkbox"/>	<input type="checkbox"/>	<input type="checkbox"/>	<input type="checkbox"/>	<input type="checkbox"/>	5(First half)	<input type="checkbox"/>	<input type="checkbox"/>	<input type="checkbox"/>	<input type="checkbox"/>	<input type="checkbox"/>	<input type="checkbox"/>	<input type="checkbox"/>	5(Second half)	<input type="checkbox"/>	<input type="checkbox"/>	<input type="checkbox"/>	<input type="checkbox"/>	<input type="checkbox"/>	<input type="checkbox"/>	<input type="checkbox"/>	6	<input type="checkbox"/>	<input type="checkbox"/>	<input type="checkbox"/>	<input type="checkbox"/>	<input type="checkbox"/>	<input type="checkbox"/>	<input type="checkbox"/>	6(First half)	<input type="checkbox"/>	<input type="checkbox"/>	<input type="checkbox"/>	<input type="checkbox"/>	<input type="checkbox"/>	<input type="checkbox"/>	<input type="checkbox"/>	6(Second half)	<input type="checkbox"/>	<input type="checkbox"/>	<input type="checkbox"/>	<input type="checkbox"/>	<input type="checkbox"/>	<input type="checkbox"/>	<input type="checkbox"/>	7	<input type="checkbox"/>	<input type="checkbox"/>	<input type="checkbox"/>	<input type="checkbox"/>	<input type="checkbox"/>	<input type="checkbox"/>	<input type="checkbox"/>	7(First half)	<input type="checkbox"/>	<input type="checkbox"/>	<input type="checkbox"/>	<input type="checkbox"/>	<input type="checkbox"/>	<input type="checkbox"/>	<input type="checkbox"/>	7(Second half)	<input type="checkbox"/>	<input type="checkbox"/>	<input type="checkbox"/>	<input type="checkbox"/>	<input type="checkbox"/>	<input type="checkbox"/>	<input type="checkbox"/>	Team lecture	<input type="checkbox"/>	<input type="checkbox"/>	<input type="checkbox"/>	<input type="checkbox"/>	<input type="checkbox"/>	<input type="checkbox"/>	<input type="checkbox"/>	Other	<input type="checkbox"/>	<input type="checkbox"/>	<input type="checkbox"/>	<input type="checkbox"/>	<input type="checkbox"/>	<input type="checkbox"/>	<input type="checkbox"/>
	Mon	Tue	Wed	Thu	Fri	Sat	Other																																																																																																										
1	<input type="checkbox"/>	<input type="checkbox"/>	<input type="checkbox"/>	<input type="checkbox"/>	<input type="checkbox"/>	<input type="checkbox"/>	<input type="checkbox"/>																																																																																																										
4(Second half)	<input type="checkbox"/>	<input type="checkbox"/>	<input type="checkbox"/>	<input type="checkbox"/>	<input type="checkbox"/>	<input type="checkbox"/>	<input type="checkbox"/>																																																																																																										
5	<input type="checkbox"/>	<input type="checkbox"/>	<input type="checkbox"/>	<input type="checkbox"/>	<input type="checkbox"/>	<input type="checkbox"/>	<input type="checkbox"/>																																																																																																										
5(First half)	<input type="checkbox"/>	<input type="checkbox"/>	<input type="checkbox"/>	<input type="checkbox"/>	<input type="checkbox"/>	<input type="checkbox"/>	<input type="checkbox"/>																																																																																																										
5(Second half)	<input type="checkbox"/>	<input type="checkbox"/>	<input type="checkbox"/>	<input type="checkbox"/>	<input type="checkbox"/>	<input type="checkbox"/>	<input type="checkbox"/>																																																																																																										
6	<input type="checkbox"/>	<input type="checkbox"/>	<input type="checkbox"/>	<input type="checkbox"/>	<input type="checkbox"/>	<input type="checkbox"/>	<input type="checkbox"/>																																																																																																										
6(First half)	<input type="checkbox"/>	<input type="checkbox"/>	<input type="checkbox"/>	<input type="checkbox"/>	<input type="checkbox"/>	<input type="checkbox"/>	<input type="checkbox"/>																																																																																																										
6(Second half)	<input type="checkbox"/>	<input type="checkbox"/>	<input type="checkbox"/>	<input type="checkbox"/>	<input type="checkbox"/>	<input type="checkbox"/>	<input type="checkbox"/>																																																																																																										
7	<input type="checkbox"/>	<input type="checkbox"/>	<input type="checkbox"/>	<input type="checkbox"/>	<input type="checkbox"/>	<input type="checkbox"/>	<input type="checkbox"/>																																																																																																										
7(First half)	<input type="checkbox"/>	<input type="checkbox"/>	<input type="checkbox"/>	<input type="checkbox"/>	<input type="checkbox"/>	<input type="checkbox"/>	<input type="checkbox"/>																																																																																																										
7(Second half)	<input type="checkbox"/>	<input type="checkbox"/>	<input type="checkbox"/>	<input type="checkbox"/>	<input type="checkbox"/>	<input type="checkbox"/>	<input type="checkbox"/>																																																																																																										
Team lecture	<input type="checkbox"/>	<input type="checkbox"/>	<input type="checkbox"/>	<input type="checkbox"/>	<input type="checkbox"/>	<input type="checkbox"/>	<input type="checkbox"/>																																																																																																										
Other	<input type="checkbox"/>	<input type="checkbox"/>	<input type="checkbox"/>	<input type="checkbox"/>	<input type="checkbox"/>	<input type="checkbox"/>	<input type="checkbox"/>																																																																																																										

Search Syllabus

You can narrow the search results by curriculum, course name, instructor name, etc. Instructor name must be entered in **all capital letters**.

Select the day/time, e.g. 1 x Tue for classes held in first period on Tuesdays. When the class period is checked, the class starting time also must be selected.

After making your selections, click the search button. A list of classes for which you are eligible to register will be displayed as per your search criteria.

A list of classes will be displayed as per the search criteria.

Search from Course

[Return to Previous Screen](#)

Course List

Click the course name which you want to refer to a syllabus.

1-10/28 1 2 3 Next 10>> 10 ▾

No	Course Code	Course Name	Class Starting Period	Instructor in Charge
1	CB22119	Logic	Spring Semester Tue 2	KAZUHISA SHINOZAWA
2	CB22307	Sports A		HIGE
3	CB22308	Sports A		I
4	CB22309	Sports A	Spring Semester Tue 2	AKIRA TAMAGAWA
5	CB22310	Sports A	Spring Semester Tue 2	AKIRA SATO
6	CB22311	Sports A	Spring Semester Tue 2	TOSHIHIKO FUJIMOTO
7	CB22130	Physics A	Spring Semester Tue 2	TOMOHIKO IWASAKI
8	CB22131	Physics A	Spring Semester Tue 2	MASATOSHI ITOH
9	CB22132	Physics A	Spring Semester Tue 2	YOSHIRO HIRAYAMA
10	CB22120	Philosophy	Spring Semester Tue 2	ICHIRO MORI

You can view a class's syllabus by clicking the class title.

1-10/28 1 2 3 Next 10>> 10 ▾

Syllabus Screen

Browse Syllabus

[Return to Search Result List](#)

[Add to Your Favorite](#)

Subject	Biology B
Day/Period/Place	Spring Semester Tue 2 川北キャンパスA204
Categories	General Education Subjects - Expansion Subjects-Biology
Credit(s)	2
Object	国際学士コース(*)
Instructor (Position)	ROBERT MARTIN 所属:高度教養教育・学生支援機構
Term	3セメスター
Course Numbering	ZDN-BIO112E
Language Used in Course	English

Class Subject	Essential Biochemistry
Object and Summary of Class	Biochemistry is a vast field that covers the structure, function, and interconversion of the biomolecules that characterize living systems. The main objective of this course is for the student to acquire a fundamental understanding about biomolecules, proteins, enzymes, and catalysis as well as getting an overview of some of the central metabolic pathways.

(2) Search by Instructor

This allows you to search by class instructor. If you know the instructor name, this search is the easiest way to view the syllabus.

Search by Instructor

Search Condition

Select a year that you want to search syllabus and search instructor.

School Year	2022 ▼
Name	ROBERT
Full-time/Part-time	<input type="checkbox"/> Full-time <input type="checkbox"/> Part-time

Instructor name must be entered in all capital letters.

Search Instructor

(3) Full-Text Search

This allows you to search for words/text contained in the syllabi.

Search Entire Text

Search Condition

[Search Entire Text] then, you can search for summary of class for which you can't search by [Search from Course] and [Search by Instructor]. Select a year that you want to search syllabus and enter the search keyword.

School Year	2022 ▼
Search Keyword	organic chemistry

Including all of The

Search Sy

Multiple keywords can be entered with a space between words.

● QuickSyllabus

QuickSyllabus is a website that allows you to quickly search syllabi without logging in. The website is only available in Japanese, but the syllabus itself is available in English if the course is conducted in English. Note that the contact information of instructors is NOT posted in QuickSyllabus.

QuickSyllabus: <https://qsl.cds.tohoku.ac.jp>

V General Education Class Information (FGL Program)

1. List of Subjects (3rd and 4th Semester Classes)

(1) Expansion Subjects

Lecture Name	Hrs./Wk.	Credits	Topics	Instructor	Semester	Day/Period	Courses
Human Sciences							
History	2	2	History of Art in Ancient Eurasia ~ Diffusion of Classical Greek Art into Central Asia	Mitsuru HAGA	3	Tue./3 rd	AMC IMAC-U AMB
Natural Sciences/Mathematics							
Calculus B	2	2	Multivariate Calculus	Xavier DAHAN	3	Tue./4 th	AMC IMAC-U
Calculus C	2	2	Ordinary Differential Equations	Xavier DAHAN	4	Tue./3 rd	AMC IMAC-U
Foundation of Linear Algebra	2	2	Overview of Linear Algebra	Marcin SCHROEDER	3	Tue/4 th	AMB
Linear Algebra B	2	2	Linear Algebra B	Marcin SCHROEDER	3	Fri./2 nd	AMC IMAC-U
Probability & Statistics	2	2	TBA	TBA	4	Tue./1 st	AMC IMAC-U AMB
Natural Sciences/Physics							
Physics B	2	2	TBA	Dmytro FEDORYNENKO	3	Thu./2 nd	AMC IMAC-U AMB
Physics C	2	2	TBA	Aguiar De Souza Vinicius	3	Wed./1 st	AMC IMAC-U AMB
Natural Sciences/Chemistry							
Chemistry C	2	2	Introduction to organic chemistry	Mott Derrick	3	Wed./3 rd	AMC IMAC-U AMB
Natural Sciences/Biology							
Biology B	2	2	Essential Cell Biology (Spring 2022)	Toshiharu ICHINOSE	3	Tue./2 nd	AMC AMB
Biology C	2	2	Seeing biological world through cilia's eyes	Kazuo INABA	3	Thu./1 st	AMC AMB
Natural Sciences/Scientific Experiments							
Introductory Science Experiments -1	4	1	Introductory Science Experiments	Head: Norihiro NAKAMURA	3	Thu./3 rd , 4 th	AMC IMAC-U AMB
Introductory Science Experiments -2	4	1					
* Special Lecture of Career Education	4	2	Digital Entrepreneurship Seminar	TBA	4	Tue./5 th	AMC IMAC-U AMB

(2) Common Subjects

Lecture Name	Hrs./Wk.	Credits	Topics	Instructor	Semester	Day/Period	Courses
Small-Group Freshmen Seminars							
*Introductory Seminar	2	2	Chemistry in English	Brian Keith BREEDLOVE	3	Mon./5 th	AMC IMAC-U AMB
			Experimental discussion on origami structures	Kanjuro MAKIHARA	3 2Q	Mon./5 th Fri./5 th	AMC IMAC-U AMB
Subjects for International Students							
Basic Japanese 2	6	3	Japanese for advanced beginners	Natsue SUGAYA, Atsuko UCHIYAMA, Masako HAYASHI	3	Tue./1 st Wed./2 nd Thu./5 th	AMC IMAC-U AMB
Intermediate Japanese	6	3	Intermediate Japanese	Atsuko UCHIYAMA, Yukari AZUMI	4	Tue./2 nd , Wed./1 st Wed./2 nd	AMC IMAC-U AMB
Health Sciences							
Sports A	2	1	Tennis Table tennis Kyudo Tennis	Haruki MONMA Toshihiko FUJIMOTO Akira SATO Kiyonaga TOBINAI	4	Fri./3 rd	AMC AMB
			Table tennis Badminton Kyudo	Takeo KAI Akira TAMAGAWA Akira SATO	3	Tue./2 nd	IMAC-U
Health			Health Science	Ryoichi NAGATOMI	4	Thu./4 th	AMC IMAC-U AMB

Cooperative Innovation Program in Science, Engineering, and Agriculture for Leading Sustainable and Diverse Industry and Society by Digital Globalization

The FGL program has been selected by MEXT for a new program aimed at government-sponsored students. As a result starting in FY 2021, FGL will be able to accept 8 government-sponsored students each year for three years. The objective of this program is to create an educational system based on cooperation between three undergraduate schools that will foster leaders in the field of global sustainable and diverse industry and society while driving innovation in university education.

Those who enter FGL as government-sponsored students will also belong to this new program. Therefore, in addition to the curricula of their undergraduate schools, the government-sponsored students will have to fulfill the requirements of this program as well. The program requirements (i.e. requirements for receiving government sponsorship) consist of nine or ten credits in the below six subjects. For details of each subject, please see the syllabus. (From 1. to 4. below are General Education subjects. In the above table, they are indicated by an asterisk (*) to the right of the subject names.)

1. Fundamentals of Interdisciplinary STEM seminar [2 credits] — General Education Subjects
2. Introductory Seminar (Interdisciplinary Seminar) [2 credits] — General Education Subjects
3. Life and Nature (Study of Nature, Life and Technology) [2 credits] — General Education Subjects
4. Special Lecture of Career Education (Digital Entrepreneurship Seminar) [2 credits] — General Education Subjects
5. Science, Technology and Industry in Japan [1 credit] — Specialized Subjects
6. Multidisciplinary Internship [1 credit] — Specialized Subjects

General Education Subjects will change for students entering after April 2023.

[Those whose student ID begins with C1, C0, B9, B8... will need to transfer their subjects if they wish to retake 1st/2nd semester subjects.](#)

A list of subjects to transfer will be available on the FGL website.

2. Timetable

(1) AMC Course

General Education Subjects

Specialized Subjects

3rd Semester (April 2022 – September 2022)

	8:50 - 10:20	10:30 - 12:00	13:00 - 14:30	14:40 - 16:10	16:20 - 17:50
Mon.		専門基礎化学Ⅰ Special Class in Basic Chemistry I Eriko NANGO	生物化学概論 General Biochemistry Kenji INABA	専門基礎化学Ⅲ Special Class in Basic Chemistry III Takehiko WADA	基礎ゼミ Introductory Seminar* Brian Keith BREEDLOVE <2Q> 基礎ゼミ Introductory Seminar* Kanjuro MAKIHARA
Tue.	Basic Japanese 2 Natsue SUGAYA, Atuko UCHIYAMA, Masako HAYASHI A403	生命科学 B Biology B Toshiharu ICHINOSE C203	歴史学 History Mitsuru HAGA C204	解析学B Calculus B Xavier DAHAN R115	
Wed.	物理学 C Physics C Aguiar De Souza Vinicius C203	Basic Japanese 2 Natsue SUGAYA, Atuko UCHIYAMA, Masako HAYASHI A403	化学 C Chemistry C Mott Derrick C103		
Thu.	生命科学 C Biology C Kazuo INABA A401	物理学 B Physics B Dmytro FEDORYNENKO R115	自然科学総合実験-1, -2 Introductory Science Experiments 1, 2 Norihiko NAKAMURA et al. [A06] Student Laboratories		Basic Japanese 2 Natsue SUGAYA, Atuko UCHIYAMA, Masako HAYASHI A403
Fri.		線形代数学B Linear Algebra B Marcin SCHROEDER R115	専門基礎化学Ⅱ-2 Special Class in Basic Chemistry II, IV Brian Keith, BREEDLOVE		<2Q> 基礎ゼミ Introductory Seminar* Kanjuro MAKIHARA

4th Semester (October 2022 – March 2023)

	8:50 - 10:20	10:30 - 12:00	13:00 - 14:30	14:40 - 16:10	16:20 - 17:50
Mon.		物理化学概論B General Physical Chemistry B Hiroshi KUMIGASHIRA	物理化学演習A Exercises in Physical Chemistry A Tadahiro KOMEDA	無機分析化学概論B General Inorganic and Analytical Chemistry B Brian Keith, BREEDLOVE	
Tue.	数理統計学 Probability & Statistics TBA C204	Intermediate Japanese Atsuko UCHIYAMA Yukari AZUMI C204	解析学 C Calculus C Xavier DAHAN C401	日本の科学と産業 Science, Technology and Industry in Japan Yumiko WATANABE, Other Instructors A204	キャリア教育特別講義 Special Lecture of Career Education (Digital Entrepreneurship Seminar) TBA C205
Wed.	Intermediate Japanese Atsuko UCHIYAMA Yukari AZUMI C204	Intermediate Japanese Atsuko UCHIYAMA Yukari AZUMI C204			
Thu.		生物化学ⅠA Biochemistry IA South Multidisciplinary Research 2 Satoshi TAKAHASHI	有機化学演習 A Exercises in Organic Chemistry A Fumi NAGATSUGI, Takehiko WADA, Shin MIZUKAMI	体と健康 Health Ryouichi NAGATOMI C104	
Fri.	無機分析化学概論A General Inorganic and Analytical Chemistry A Brian Keith, BREEDLOVE	有機化学概論 A General Organic Chemistry A Shin MIZUKAMI	スポーツA Sports A* Haruki MONMA Toshihiko FUJIMOTO Akira SATO Kiyonaga TOBINAI		

Notice: *Students will choose one of the sports activities for Sports A.

*There will be announcement about Sports A for FGL students not in Japan.

*Students will choose one of Introductory Seminar.

(2) IMAC-U Course

3rd Semester (April 2022 – September 2022)
 General Education Subjects

 Specialized Subjects

	8:50 - 10:20	10:30 - 12:00	13:00 - 14:30	14:40 - 16:10	16:20 - 17:50
Mon.	<2Q> 数学 II Mathematics II Takashi FURUSAWA	<1Q>力学 Mechanics Anna SUZUKI <2Q>数理解析学 Numerical Analysis Kanjuro MAKIHARA	<1Q>数学 I Mathematics I Koji SHIMOYAMA	<1Q>数理解析学演習 Exercises in Computer-Aided Problem Solving Takayuki OKATANI Shingo KAGAMI	基礎ゼミ Introductory Seminar* Brian Keith BREEDLOVE <2Q> 基礎ゼミ Introductory Seminar* Kanjuro MAKIHARA
Tue.	日本語 Basic Japanese 2 Natsue SUGAYA, Atuko UCHIYAMA, Masako HAYASHI A403	スポーツA Sports A* Taketo KAI Akira TAMAGAWA Akira SATO	歴史学 History Mitsuru HAGA C204	解析学B Calculus B Xavier DAHAN R115	
Wed.	物理学 C Physics C Aguiar De Souza Vinicius C203	Basic Japanese 2 Natsue SUGAYA, Atuko UCHIYAMA, Masako HAYASHI A403	化学 C Chemistry C Mott Derrick C103	数学物理学演習 II Exercises in Mathematics and Physics II Ying CHEN	
Thu.		物理学 B Physics B Dmytro FEDORYNENKO R115	自然科学総合実験-1, -2 Introductory Science Experiments 1, 2 Norihiro NAKAMURA et al. [A06] Student Laboratories	Basic Japanese 2 Natsue SUGAYA, Atuko UCHIYAMA, Masako HAYASHI A403	
Fri.	<1Q>力学 Mechanics Anna SUZUKI	線形代数学B Linear Algebra B Marcin SCHROEDER R115	<1Q>数学 I Mathematics I Koji SHIMOYAMA <2Q>数学 II Mathematics II Takashi FURUSAWA	<1Q>数理解析学演習 Exercises in Computer-Aided Problem Solving Takayuki OKATANI Shingo KAGAMI <2Q>数理解析学 Numerical Analysis Kanjuro MAKIHARA	<2Q> 基礎ゼミ Introductory Seminar* Kanjuro MAKIHARA

4th Semester (October 2022 – March 2023)

	8:50 - 10:20	10:30 - 12:00	13:00 - 14:30	14:40 - 16:10	16:20 - 17:50
Mon.	<3Q>量子力学 I Quantum Mechanics I Wataru YASHIRO <4Q>材料力学 II Mechanics of Materials II Toshiyuki HASHIDA Go YAMAMOTO	<3Q>機械力学 I Mechanical Vibrations I Mitsuhiro HAYASHIBE, Fedorynenko DMYTRO <4Q>制御工学 I Control Engineering I Dai OWAKI	<3Q>材料力学 I Mechanics of Materials I Yuji ICHIKAWA Yoichi TAKEDA <4Q>流体力学 I Fluid Mechanics I Takehiko SATO		
Tue.	数理解析学 Probability & Statistics TBA C204	Intermediate Japanese Atsuko UCHIYAMA Yukari AZUMI C204	解析学 C Calculus C Xavier DAHAN C401	日本の科学と産業 Science, Technology and Industry in Japan Yumiko Watanabe, Other Instructors A204	キャリア教育特別講義 Special Lecture of Career Education (Digital Entrepreneurship Seminar) TBA C205
Wed.	Intermediate Japanese Atsuko UCHIYAMA Yukari AZUMI C204	Intermediate Japanese Atsuko UCHIYAMA Yukari AZUMI C204	機械知能・航空研修 I Seminar I	<3Q>情報処理演習 Practice of Information Processing Taku NONOMURA <4Q>コンピューター実習 I Computer Seminar I	
Thu.	<3Q>量子力学 I Quantum Mechanics I Wataru YASHIRO <4Q>材料力学 II Mechanics of Materials II Toshiyuki HASHIDA Go YAMAMOTO	<3Q>熱力学 I Thermodynamics I Takashi TOKUMASU Akihiro HAYAKAWA <4Q>材料科学 I Materials Science I Kazuhisa SATO Yuji ICHIKAWA	<3Q>材料力学 I Mechanics of Materials Yuji ICHIKAWA Yoichi TAKEDA <4Q>流体力学 I Fluid Mechanics I Takehiko SATO	体と健康 Health Ryouichi NAGATOMI C104	
Fri.	<3Q>熱力学 I Thermodynamics I Takashi TOKUMASU Akihiro HAYAKAWA <4Q>材料科学 I Materials Science I Kazuhisa SATO Yuji ICHIKAWA	<3Q>機械力学 Mechanical Vibrations I Mitsuhiro HAYASHIBE, Fedorynenko DMYTRO <4Q>制御工学 I Control Engineering I Dai OWAKI	機械知能・航空研修 I Seminar I		
Intensive	創造工学研修 Team-Based Engineering for Invention Instructor and students will arrange and decide the schedule of this lesson.				

Notice: *See the IMAC-U timetable for details of Specialized Subject Classes.

*Students will choose one of the sports activities for Sports A.

*There will be announcement about Sports A for FGL students not in Japan.

*Students will choose one of Introductory Seminar.

(3) AMB Course

General Education Subjects

Specialized Subjects

3rd Semester (April 2022 – September 2022)

	8:50 - 10:20	10:30 - 12:00	13:00 - 14:30	14:40 - 16:10	16:20 - 17:50
Mon.					基礎ゼミ Introductory Seminar* Brian Keith BREEDLOVE <2Q> 基礎ゼミ Introductory Seminar* Kanjuro MAKIHARA
Tue.	Basic Japanese 2 Natsue SUGAYA, Atuko UCHIYAMA, Masako HAYASHI A403	生命科学 B Biology B Toshiharu ICHINOSE C203	歴史学 History Mitsuru HAGA C204	線形代数学概要 Foundations of Linear Algebra Marcin SCHROEDER C204	
Wed.	物理学 C Physics C Aguiar De Souza Vinicius C203	Basic Japanese 2 Natsue SUGAYA, Atuko UCHIYAMA, Masako HAYASHI A403	化学 C Chemistry C Mott Derrick C103		
Thu.	生命科学 C Biology C Kazuo INABA C401	物理学 B Physics B Dmytro FEDORYNENKO R115	自然科学総合実験-1, -2 Introductory Science Experiments 1, 2 Norihiko NAKAMURA et al. [A06] Student Laboratories		Basic Japanese 2 Natsue SUGAYA, Atuko UCHIYAMA, Masako HAYASHI A403
Fri.	<1Q> 水圏無脊椎動物学 Aquatic Invertebrate Biology Lecture Room 8		現代における農と農学 Modern Agriculture and Agricultural Science	陸圏・水圏環境コミュニケーション論 Introduction to Aquatic Production / Introduction to Natural and Agricultural Production	<2Q> 基礎ゼミ Introductory Seminar* Kanjuro MAKIHARA
Intensive course	臨海実習 Practice on Marine Bio-resources Science				

4th Semester (October 2022 – March 2023)

	8:50 - 10:20	10:30 - 12:00	13:00 - 14:30	14:40 - 16:10	16:20 - 17:50
Mon.			<3Q> 水産遺伝育種学 Fish Genetics and Breeding science Lecture Room 9		
Tue.	数理統計学 Probability & Statistics TBA C204	Intermediate Japanese Atsuko UCHIYAMA Yukari AZUMI C204		Science, Technology and Industry in Japan Yumiko WATANABE, other Instructors A204	キャリア教育特別講義 Special Lecture of Career Education (Digital Entrepreneurship Seminar) TBA C205
Wed.	Intermediate Japanese Atsuko UCHIYAMA Yukari AZUMI C204	Intermediate Japanese Atsuko UCHIYAMA Yukari AZUMI C204			
Thu.	<4Q> 海洋生物学 Marine Biology Lecture Room 9			体と健康 Health Ryouichi NAGATOMI C104	
Fri.		水産科学概論 Introduction to Fisheries Science Lecture Room 9	スポーツ A Sports A Haruki MONMA Toshihiko FUJIMOTO Akira SATO Kiyonaga TOBINAI		

Notice: *Students will choose one of the sports activities for Sports A.

*There will be announcement about Sports A for FGL students not in Japan.

*Students will choose one of Introductory Seminar.

VI Other

1. Medical Care Required due to Accidents in Class

Students who suffer accidents during class should contact the Student Health Care Center and make arrangements to receive medical care.

2. Using Educational Facilities

Some facilities on campus may be closed or offer limited service to prevent the spread of COVID-19. Please check the university websites or inquire the FGL office for the latest information.

(1) ICL Rooms	ICL Rooms at the Multimedia Education and Research Complex can be used for self-study any time they are not being used for classes.
(2) Lounge	There is a lounge in Building B on the 1st floor. You may use it for taking online classes or resting in the time between classes etc.
(3) Study Room	The Study Room is in Building B on the 2nd floor. It is open from 8:30 to 18:00. Please refrain from making noise in the Study Room. On each desk, there is an outlet that you can use to charge your laptop.
(4) SLA Lounge	There is a SLA (Student Learning Adviser) desk, where students can go for consulting near the entrance hall on the 1st floor of the Multimedia Education and Research Complex. Older students will answer questions and provide advice on various subjects. Please see the Center for Learning Support website for details.

3. Counseling Services

Students requiring counseling from someone other than their class instructors or department staff should contact the below counseling services. The details of counseling will be kept strictly confidential. (No Charge)

(1) Center for Counseling and Disability Services	<ul style="list-style-type: none">▪ Center for Counseling and disability Services provides consulting regarding problems that arise during student life. Appropriate solutions will be discussed with the student.▪ Location: Kawauchi Kita Campus, Tel: 795-7833▪ Hours: Mon. - Fri. 9:30 - 17:00
(2) Student Health Care Center	<ul style="list-style-type: none">▪ The goal of the Student Health Care Center is to maintain and improve student health. Students who have questions, concerns or anxiety about their physical or psychological health should make use of this facility. The first aid offices at Katahira, Schools of Medicine/Dentistry, School of Engineering, and Faculty of Agriculture also provide medical consulting and care.▪ Location: Kawauchi Kita Campus, Tel: 795-7829▪ Hours: Weekdays 9:00 - 11:30, 13:00 - 16:15
(3) University-wide Harassment Counseling Center	<ul style="list-style-type: none">▪ Location: Kawauchi Kita Campus University Counseling Center, Tel: 022-795-7812▪ Hours: Mon. - Fri., 9:30 - 17:00
(4) Counseling by Phone (Provided through off-campus organization)	<ul style="list-style-type: none">▪ Counseling regarding sexual harassment, health, mental health▪ Toll-free hotline: 0120-7830-59▪ Hours: Mon., Wed., Fri., Sat., Sun. 10:00 - 21:00 Tue., Thu. 10:00 - 22:00 (not available on national holidays, Dec. 31 – Jan. 3)

4. Preventing Theft

(1) Incidences of theft in lecture halls and gymnasiums are fairly common. Do not leave bags etc. unattended in classrooms or study rooms, even for short periods of time. In the event of theft, report the incident to your Student Affairs Division or Student Services Division.

(2) There are numerous incidences of bicycle theft on Kawauchi Campus. When parking bicycles, lock them securely and do not leave them unattended for long periods of time.

● **Regulations on Tohoku University General Education Subjects**

April 1, 1993 Reg. 91

(Purport)

Article 1: These regulations specify items necessary to General Education Subjects and subjects related to education (does not include those established by the faculties; hereafter "General Education Subjects") in compliance with Article 26-2 of the Tohoku University Faculty Regulations (enacted December 18, 1952; hereafter "the Regulations").

(General Education Subjects)

Article 2: Categories of General Education Subjects are as follows.

Category	Group	
Core Subjects	Human Studies, Social Studies, Science Studies	
Expansion Subjects	Human Sciences, Social Sciences	
	Natural Sciences	Mathematics, Physics, Chemistry, Biology, Earth and Space Science, Scientific Experiments
	Integrated Sciences	Integrated Subjects, Current Topics, Modern Academics, Global Education
Common Subjects	Small-Group Freshmen Seminars	
	Foreign Languages	English, Second Languages, Other Languages
	Information Sciences	
	Health Sciences	
	Subjects for International Students	

(Course Subjects and Credits)

Article 3: Course subjects for General Education subjects and credits are as shown in Tables 1 and 2.

(Calculation of Credits)

Article 4: Calculation of credits for General Education course subjects are as follows.

I 1 (one) credit will be awarded per 15 hours of class time.

II 1 (one) credit will be awarded per 15 to 30 hours of seminar.

III 1 (one) credit will be awarded per 30 to 45 hours of experiments, laboratory work, and practical training.

(Registration Procedures)

Article 5: Students must inform the Chairperson of the Academic Affairs Council (hereafter, "the Chairperson") of the subjects for which they intend to register by the designated date.

(Examinations)

Article 6: Accreditation for course subjects for which students register will depend on examinations; those who pass their examinations shall receive the designated number of credits.

2 Regardless of the previous item, performance in classes consisting of experiments, laboratory work and practical training shall be graded based on daily performance instead of examinations.

3 For course subjects in which examinations can be given, the above article only applies to those who have enrolled in the class via the designated procedures.

(Makeup Examinations and Retesting)

Article 7: If, due to unavoidable circumstances, a student is unable to take a course subject's examination, a makeup test for that subject shall be conducted.

3. There will be no retesting for students who failed a course subject's examination.

(Grading Scale)

Article 8: Examination performance shall be evaluated as per the below scale. However, depending on the course subject, the grade may be specified as just "Pass" or "Fail."

AA The student's performance was particularly exceptional.

A The student's performance was excellent.

B The student's performance was above average.

C The student passed.

D The student failed.

2. Of the above grades, AA, A, B, and C are passing grades, while D is a failing grade.

3. Students who fail to attend a class for which they have submitted registration as per Article 5 above, shall receive a D grade on that class's examinations.

(Special Auditing Students)

Article 9: Students of other universities, junior colleges, or technical colleges who wish to enroll in General Education subjects may be permitted to enroll as Special Auditing Students, pursuant to agreements with that other university, junior college, or technical college.

(Miscellaneous Provisions)

Article 10: Any items necessary for General Education subjects, other than those specified in these regulations, will be specified by the Academic Affairs Council.

Supplementary Regulations Omitted

Table 1: General Education Subjects

Category	Group	Subject	Total class hours	Credits	Comments
Core Subjects	Human Studies	World of Thoughts and Ethics	30	2	
		World of Literature	30	2	
		World of Expression	30	2	
		World of Fine Arts	30	2	
		People and Culture	30	2	
	Social Studies	History and Human Society	30	2	
		Economy and Society	30	2	
		Law, Politics and Society	30	2	
		Study of Society	30	2	
		Gender and Human Society	30	2	
	Science Studies	Study of Nature	30	2	
		Scientific, Technology, and Energy	30	2	
		Life and Nature	30	2	
		Nature and the Environment	30	2	
		Science and Information	30	2	
Expansion Subjects	Human Sciences	Logic	30	2	
		Philosophy	30	2	
		Literature	30	2	
		Religion	30	2	
		Education	30	2	
		History	30	2	
		Linguistics	30	2	
	Social Sciences	Sociology	30	2	
		Psychology	30	2	
		Law	30	2	
		Japanese Constitutional Law	30	2	
		Politics	30	2	
		Economics	30	2	
		Cultural Anthropology	30	2	
		Human Geography	30	2	
	Natural Sciences	Mathematics	Foundations of Mathematics A	30	2
			Foundations of Mathematics B	30	2
			Foundations of Mathematics C	30	2
			Foundations of Calculus	30	2
			Calculus A	30	2
			Calculus B	30	2
			Calculus C	30	2
			Calculus D	30	2
			Foundations of Linear Algebra	30	2
			Linear Algebra A	30	2
			Linear Algebra B	30	2
			Probability & Statistics	30	2
			Physics	Foundations of Physics	30
		Physics A		30	2
		Physics B-1		15	1
		Physics B-2		15	1
		Physics C		30	2
		Chemistry	Physics D	30	2
Foundations of Chemistry			30	2	
Chemistry A			30	2	
Chemistry B	30		2		
	Chemistry C	30	2		

Category	Group		Subject	Total class hours	Credits	Comments	
Expansion Subjects	Natural Sciences	Biology	Foundations of Biology	30	2		
			Biology A	30	2		
			Biology B	30	2		
			Biology C	30	2		
		Earth and Space Science	Elementary Environmental Earth Science	30	2		
			Elementary Astronomy	30	2		
			Earth System Science	30	2		
			Mineralogy, Petrology & Geochemistry	30	2		
			Physical Geography	30	2		
			Astronomy	30	2		
			Geophysics	30	2		
		Scientific Experiments	Introductory Science Experiments-1	30	1		
			Introductory Science Experiments-2	30	1		
			Introductory Science Experiments for Humanities-1	30	1		
			Introductory Science Experiments for Humanities-2	30	1		
		Integrated Sciences	Integrated Subjects		30		2
	Current Topics			30	2		
	Modern Academics		Modern Scholarship	30	2		
	Global Education		Seminar on Global Knowledge	30	2		
			Global Studies	30	2		
			Japanese Society and Culture A	30	2		
			Japanese Society and Culture B	30	2		
			Intercultural Understanding	30	2		
			Global Communication	30	2		
			Problem / Project-Based Learning Seminar A	30	2		
			Problem / Project-Based Learning Seminar B	30	2		
			Global Career A	30	2		
			Global Career B	30	2		
			Study-abroad (Basic 1)	15~30	1		
			Study-abroad (Basic 2)	30~60	2		
	Study-abroad (Advance 1)	15~30	1				
Study-abroad (Advance 2)	30~60	2					
Common Subjects	Small-Group Freshmen Seminar	Introductory Seminar	30	2			
	Foreign Languages	English	English A1	30		1	
			English A1-1	15		0.5	
			English A1-2	15		0.5	
			English A2	30		1	
			English A2-1	15		0.5	
			English A2-2	15		0.5	
			English B1	30		1	
			English B1-1	15		0.5	
			English B1-2	15		0.5	
			English B2	30		1	
			English B2-1	15		0.5	
			English B2-2	15		0.5	
			English C1	30		1	
			English C1-1	15		0.5	
			English C1-2	15		0.5	
			English C2	30		1	
			English C2-1	15		0.5	
			English C2-2	15		0.5	

Category	Group		Subject	Total class hours	Credits	Comments
Common Subjects	Foreign Languages	Second Languages	Introduction to German I-1	30	1	
			Introduction to German I-2	30	1	
			Introduction to German II-1	30	1	
			Introduction to German II-2	30	1	
			German in Practice I-1	15	1	
			German in Practice I-2	15	1	
			German in Practice II-1	15	1	
			German in Practice II-2	15	1	
			Introduction to French I-1	30	1	
			Introduction to French I-2	30	1	
			Introduction to French II-1	30	1	
			Introduction to French II-2	30	1	
			French in Practice I-1	15	1	
			French in Practice I-2	15	1	
			French in Practice II-1	15	1	
			French in Practice II-2	15	1	
			French in Practice III-1	15	1	
			French in Practice III-2	15	1	
			French in Practice IV-1	15	1	
			French in Practice IV-2	15	1	
			Introduction to Russian I-1	30	1	
			Introduction to Russian I-2	30	1	
			Introduction to Russian II-1	30	1	
			Introduction to Russian II-2	30	1	
			Russian in Practice I-1	15	1	
			Russian in Practice I-2	15	1	
			Russian in Practice II-1	15	1	
			Russian in Practice II-2	15	1	
			Russian in Practice III-1	15	1	
			Russian in Practice III-2	15	1	
			Russian in Practice IV-1	15	1	
			Russian in Practice IV-2	15	1	
			Introduction to Spanish I-1	30	1	
			Introduction to Spanish I-2	30	1	
			Introduction to Spanish II-1	30	1	
			Introduction to Spanish II-2	30	1	
			Spanish in Practice I-1	15	1	
			Spanish in Practice I-2	15	1	
			Spanish in Practice II-1	15	1	
			Spanish in Practice II-2	15	1	
			Personalized Intermediate Spanish I-1	15	1	
			Personalized Intermediate Spanish I-2	15	1	
			Personalized Intermediate Spanish II-1	15	1	
			Personalized Intermediate Spanish II-2	15	1	
			Introduction to Chinese I-1	30	1	
			Introduction to Chinese I-2	30	1	
			Introduction to Chinese II-1	30	1	
			Introduction to Chinese II-2	30	1	
			Chinese in Practice I-1	15	1	
			Chinese in Practice I-2	15	1	
Chinese in Practice II-1	15	1				
Chinese in Practice II-2	15	1				
Chinese in Practice III-1	15	1				
Chinese in Practice III-2	15	1				
Chinese in Practice IV-1	15	1				

Category	Group		Subject	Total class hours	Credits	Comments	
Common Subjects	Foreign Languages	Second Languages	Chinese in Practice IV-2	15	1		
			Introduction to Korean I-1	30	1		
			Introduction to Korean I-2	30	1		
			Introduction to Korean II-1	30	1		
			Introduction to Korean II-2	30	1		
			Korean in Practice I-1	15	1		
			Korean in Practice I-2	15	1		
			Korean in Practice II-1	15	1		
			Korean in Practice II-2	15	1		
			Korean in Practice III-1	15	1		
			Korean in Practice III-2	15	1		
			Korean in Practice IV-1	15	1		
			Korean in Practice IV-2	15	1		
			Other Languages	Greek I	30		2
				Greek II	30		2
				Sanskrit I	30		2
				Sanskrit II	30		2
	Latin I	30		2			
	Latin II	30		2			
	Mongolian I	30		2			
	Mongolian II	30		2			
	Italian I	30		2			
	Italian II	30		2			
	Czech I	30		2			
	Czech II	30		2			
	Arabic I	30		2			
	Arabic II	30		2			
	Information Sciences	An Introduction to Information Sciences A		15	1		
		An Introduction to Information Sciences A-2		15	1		
		An Introduction to Information Sciences B		30	2		
	Health Sciences	Sports A		30	1		
		Sports B		30	1		
		Health		30	2		
Subjects for International Students	Japanese A-1		15	0.5	These subjects are for international students.		
	Japanese A-2		15	0.5			
	Japanese B-1		15	0.5			
	Japanese B-2		15	0.5			
	Japanese C-1		15	0.5			
	Japanese C-2		15	0.5			
	Japanese D-1		15	0.5			
	Japanese D-2		15	0.5			
	Japanese E-1		15	0.5			
	Japanese E-2		15	0.5			
	Japanese F-1		15	0.5			
	Japanese F-2		15	0.5			
	Japanese G-1		15	0.5			
	Japanese G-2		15	0.5			
	Japanese H-1		15	0.5			
	Japanese H-2		15	0.5			
	Japanese I-1		15	0.5			
	Japanese I-2		15	0.5			
	Japanese J-1		15	0.5			
	Japanese J-2		15	0.5			
	Basic Japanese 1		120	4		These subjects are for the FGL Undergraduate Courses.	
	Basic Japanese 2		90	3			
	Intermediate Japanese		90	3			

● Kawauchi Campus Map

(1) Campus Map

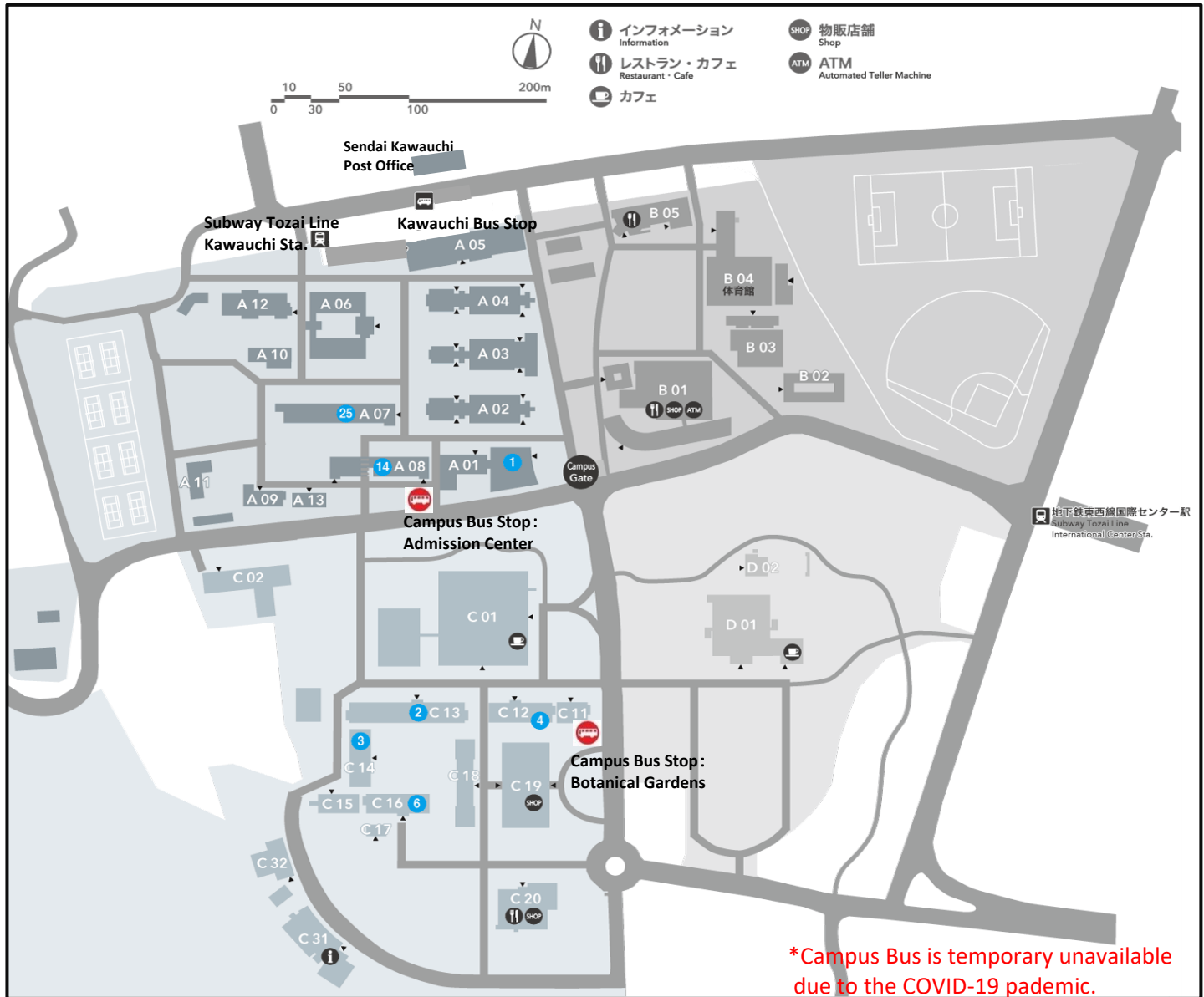

A 01	Education and Student Support Center
A 02	Lecture Rooms A
A 03	Lecture Rooms B
A 04	Lecture Rooms C
A 05	Multimedia Education and Research Complex
A 06	Student Laboratories
A 07	Center for Northeast Asian Studies, Office, Kawakita Research Forum
A 08	Graduate School of International Cultural Studies, Office
A 09	Student Health Care Center
A 10	Disability Services Office
A 12	International Exchange Building
A 13	Counseling Office
B 01	Kawauchi Welfare Facilities
B 02	Kawauchi Circle and Club Building
B 03	Kawauchi Extracurricular Activity Shared Facilities (Kawauchi Hall)
B 04	Kawauchi Gymnasium (Kawauchi Arena)
B 05	Kawauchi Sub Arena
C 01	Tohoku University Library
C 02	Admission Center
C 12	Graduate School / School of Law, Office
C 13	Graduate School / Faculty of Arts and Letters, Office
C 14	Graduate School / Faculty of Education, Office, New Humanities Building
C 16	Graduate School / Faculty of Economics and Management, Office
C 18	Lecture Rooms
C 19	Multidisciplinary Research Building, International Oasis
C 20	Welfare Facilities (Maple Park Kawauchi)
C 31	Botanical Gardens (Garden Hall)
D 01	Centennial Hall (Kawauchi Hagi Hall)

(2) Classroom

() = the seating capacity

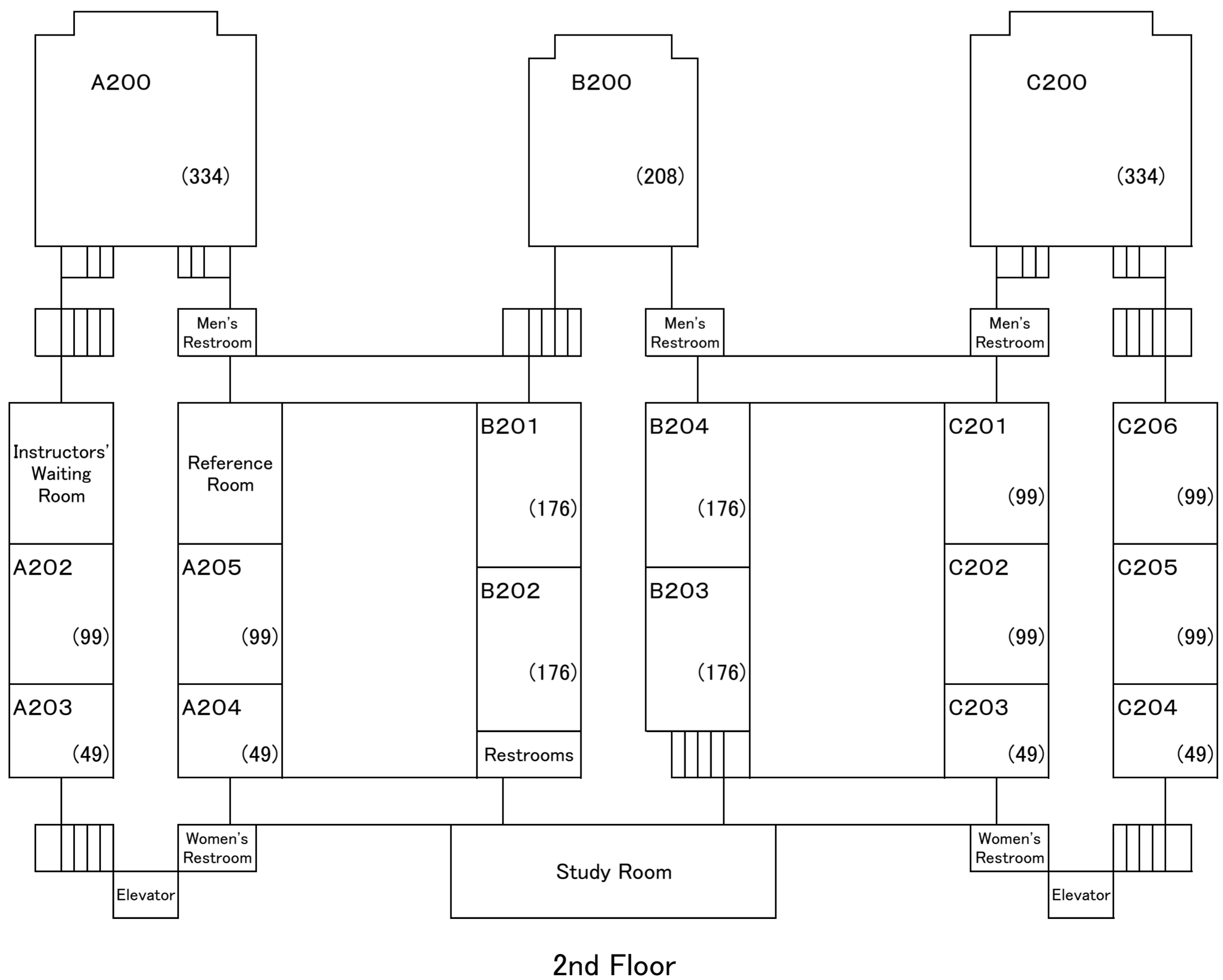
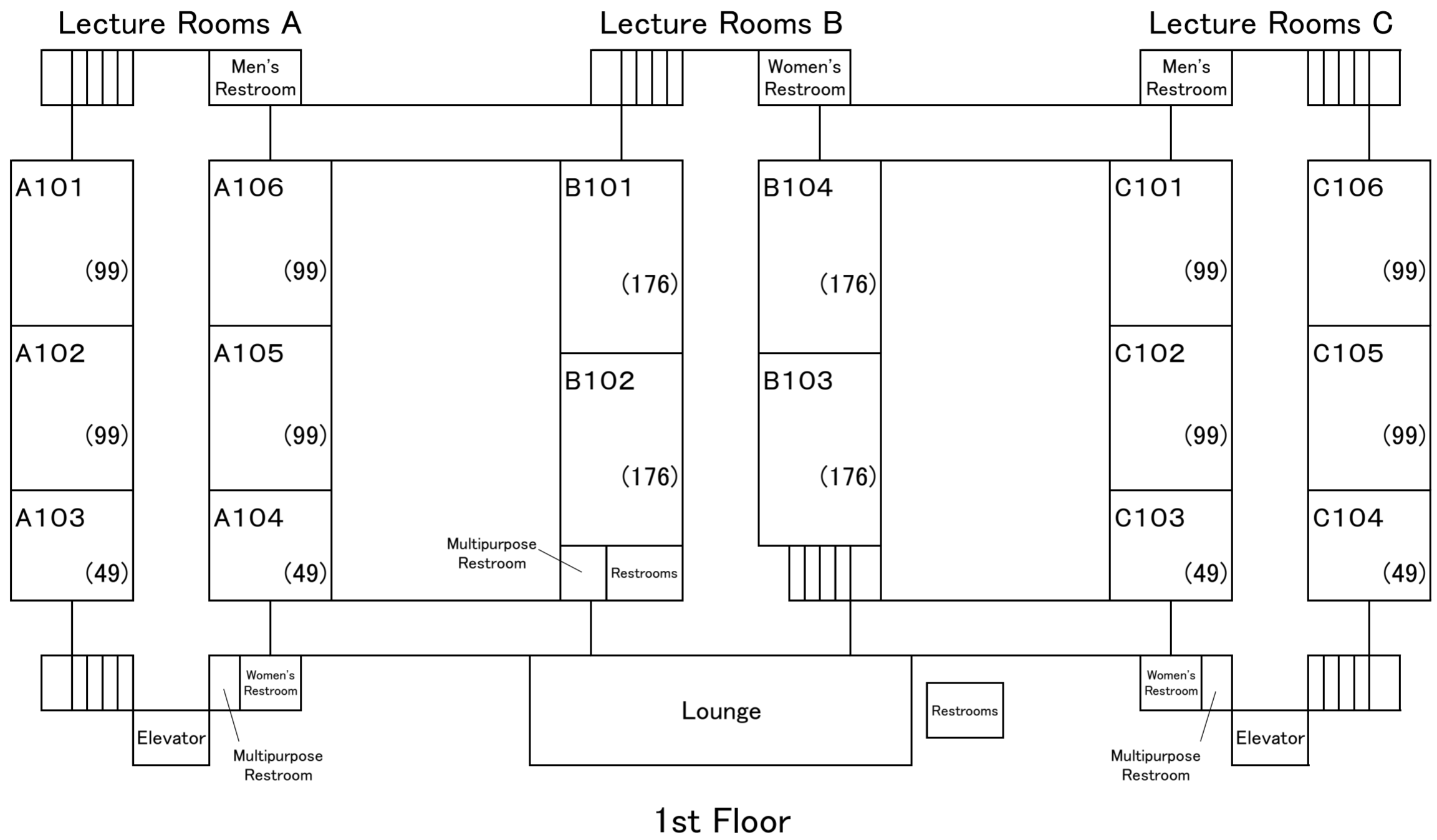

Lecture Rooms A

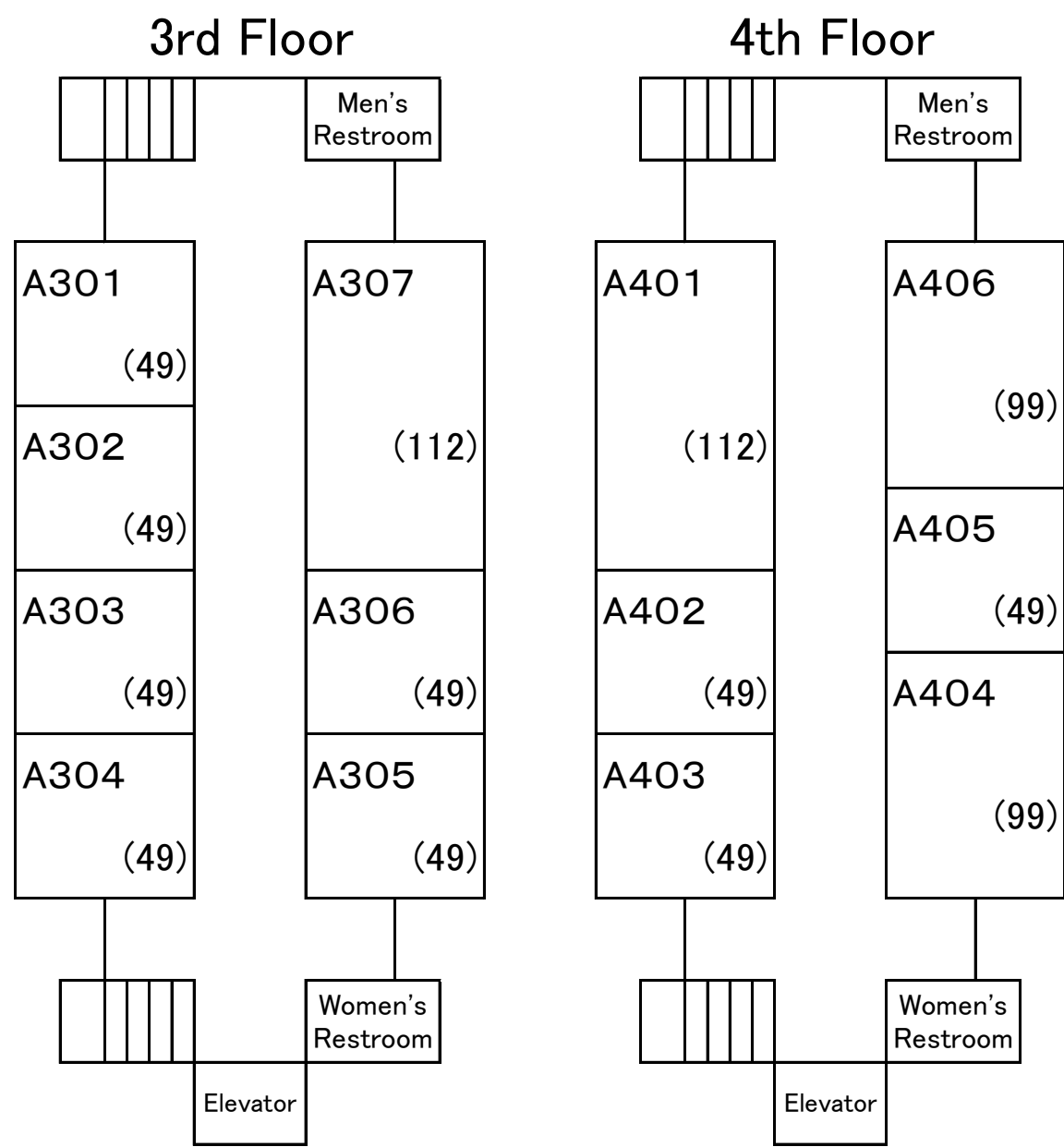

Lecture Rooms C

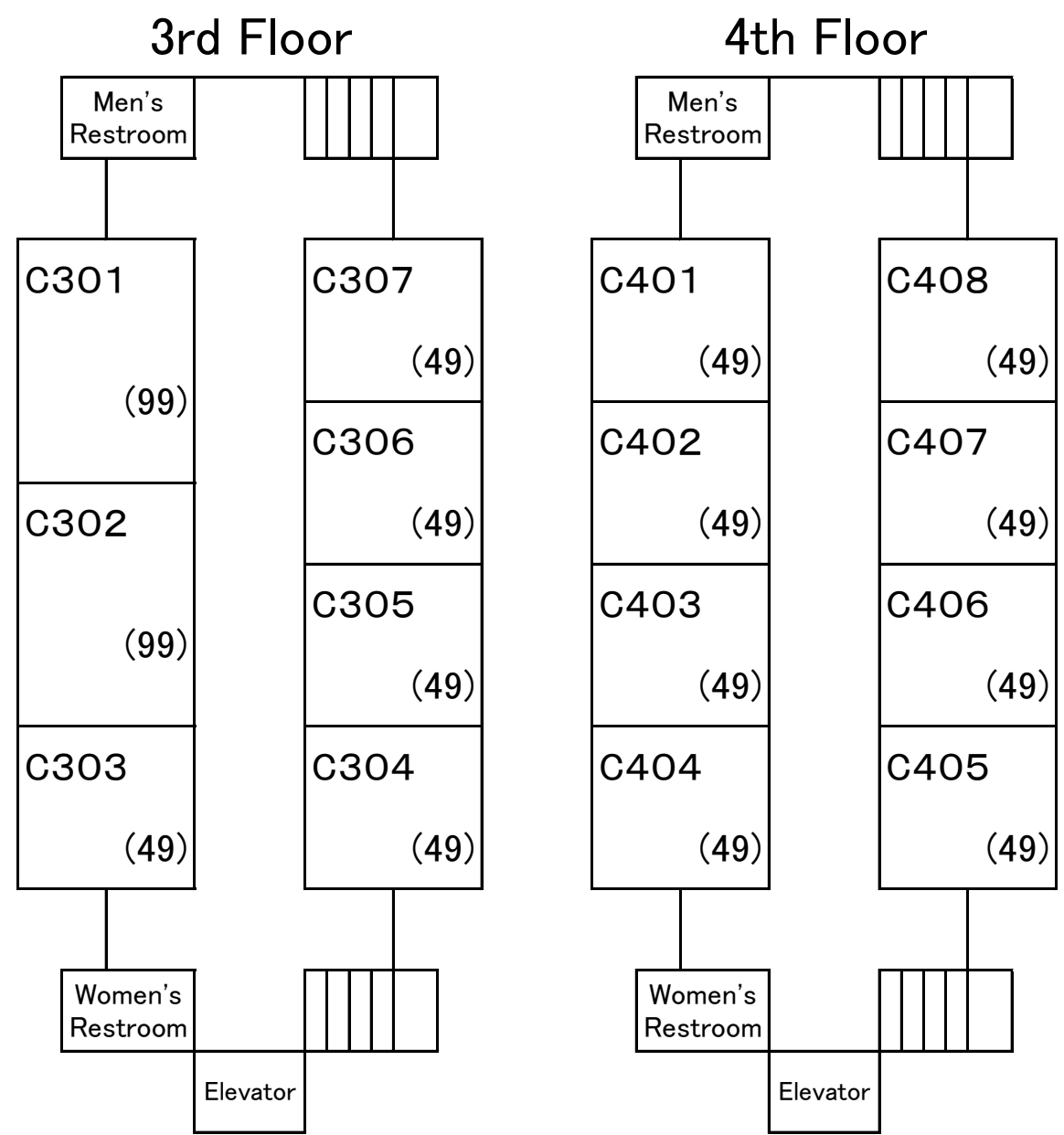

(3) Student Laboratories

1st Floor

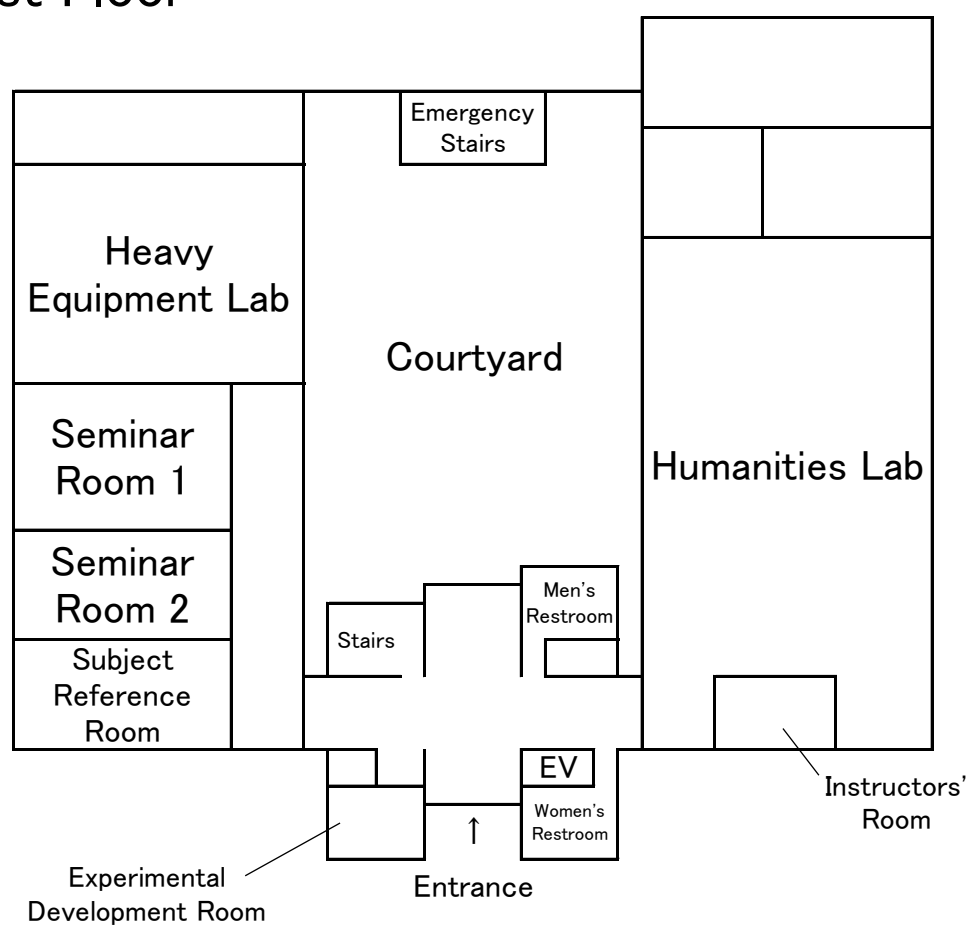

2nd Floor

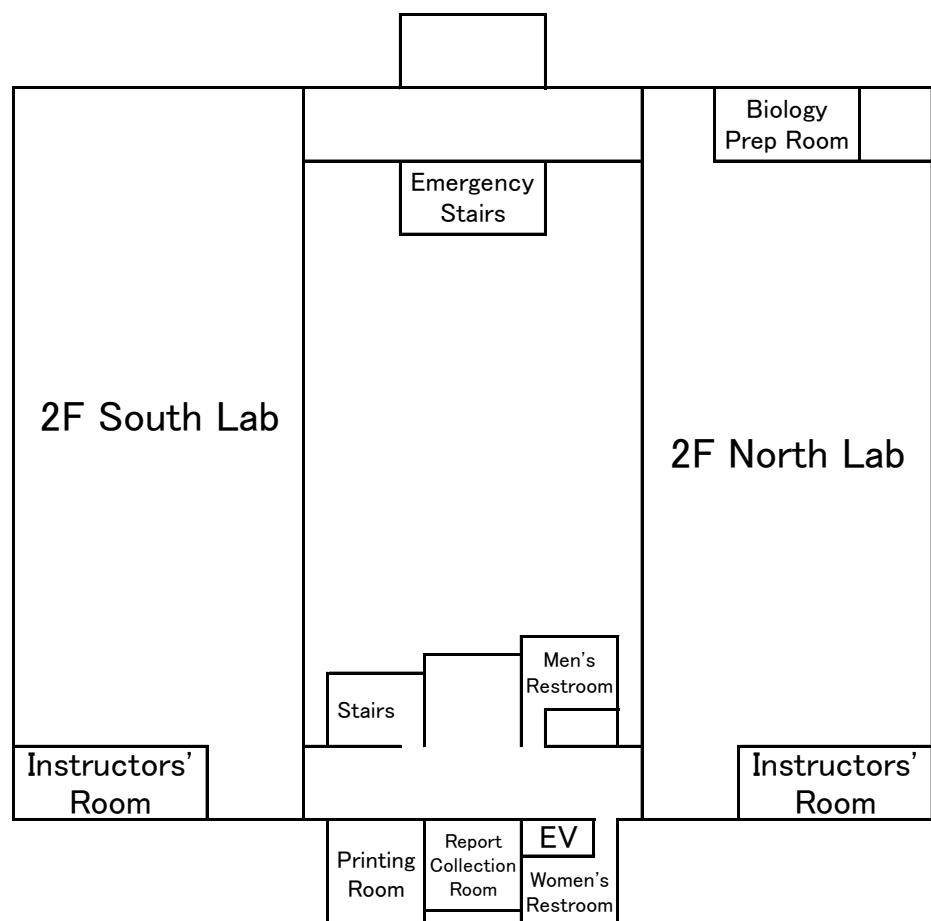

3rd Floor

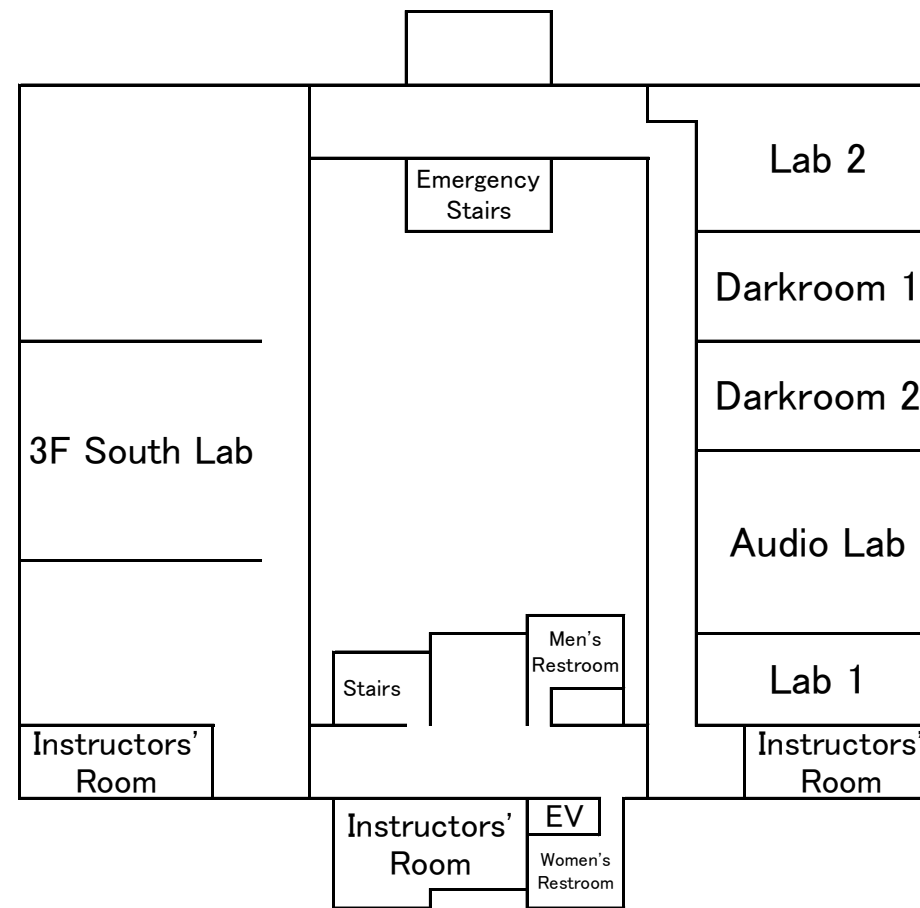

(4) Multimedia Education and Research Complex

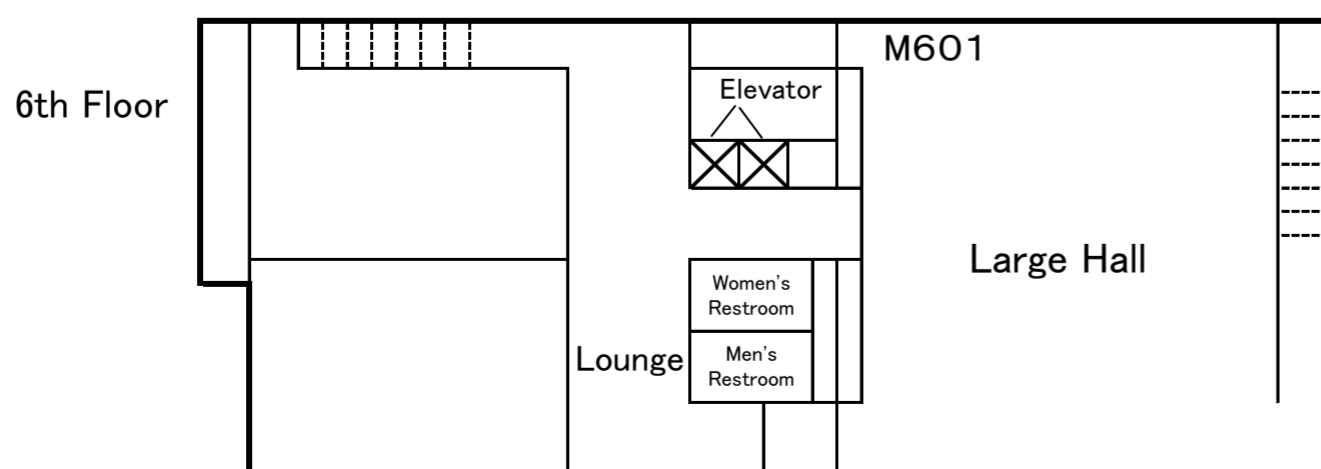
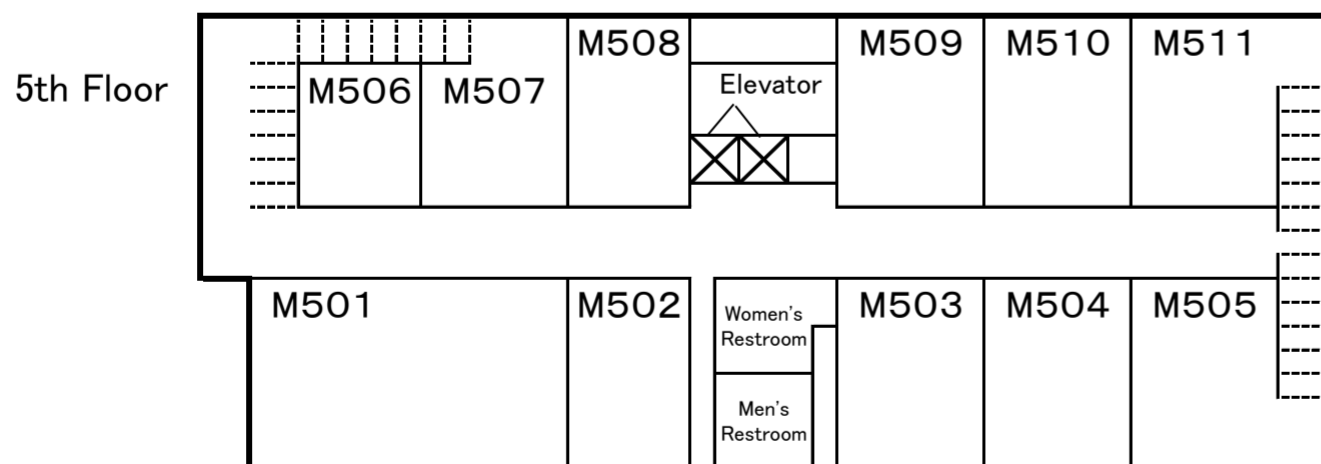
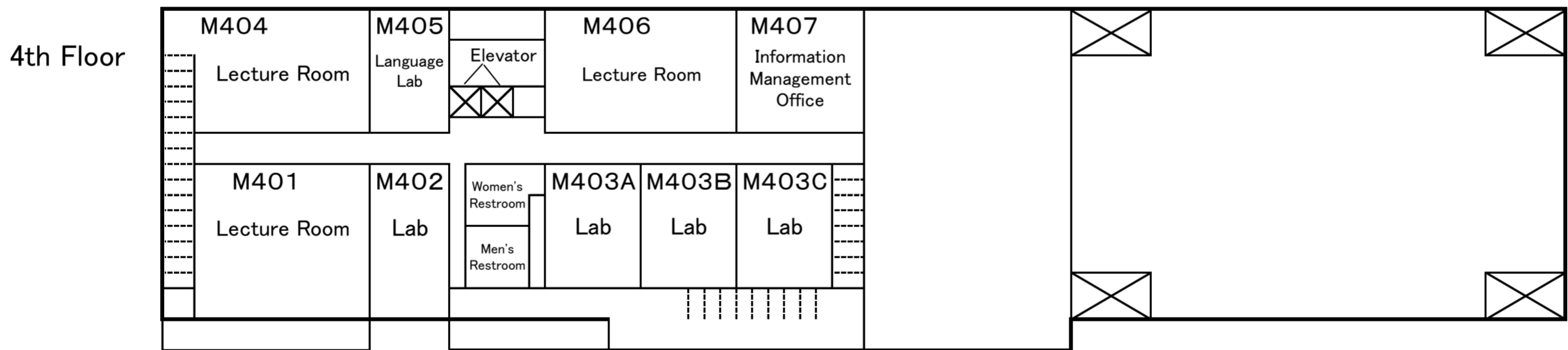
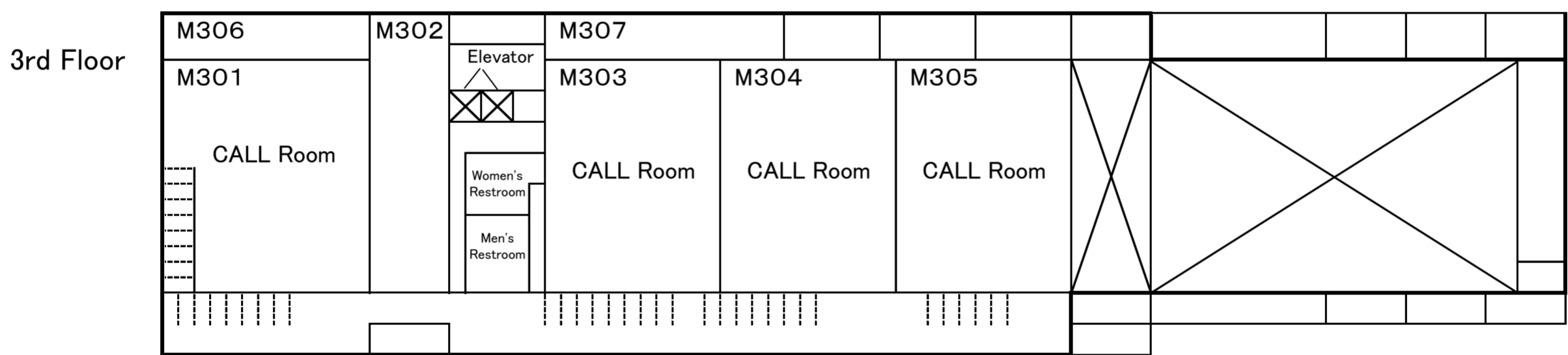
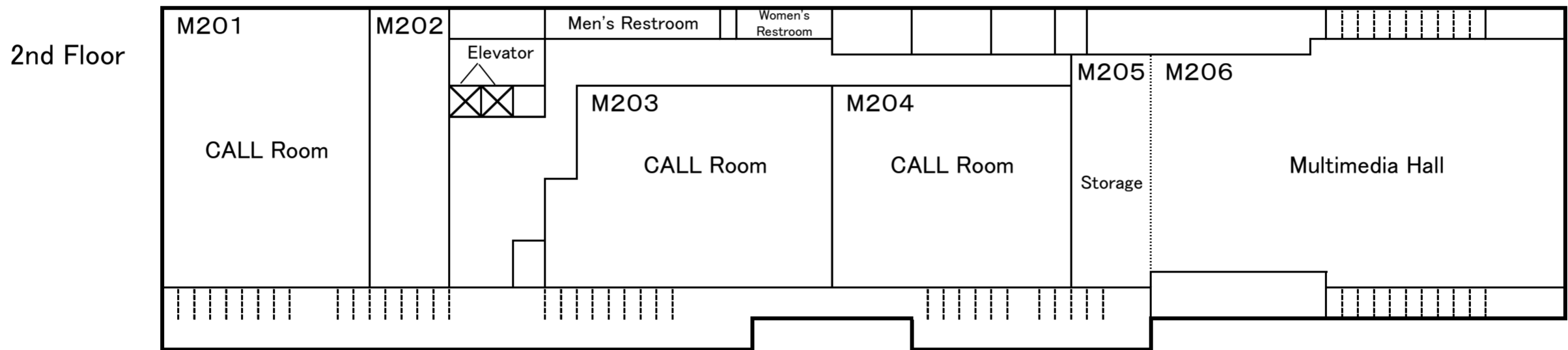
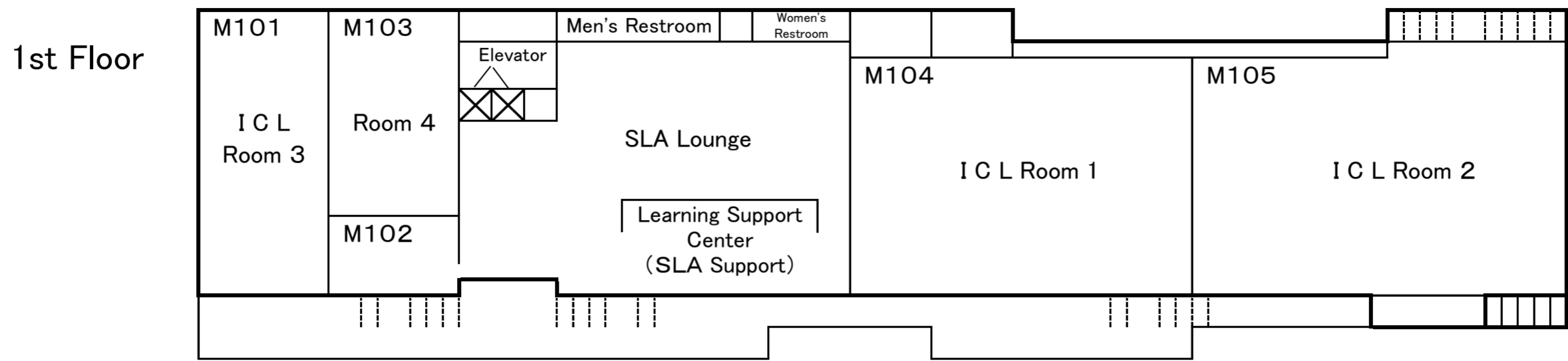

(5) Gymnasium

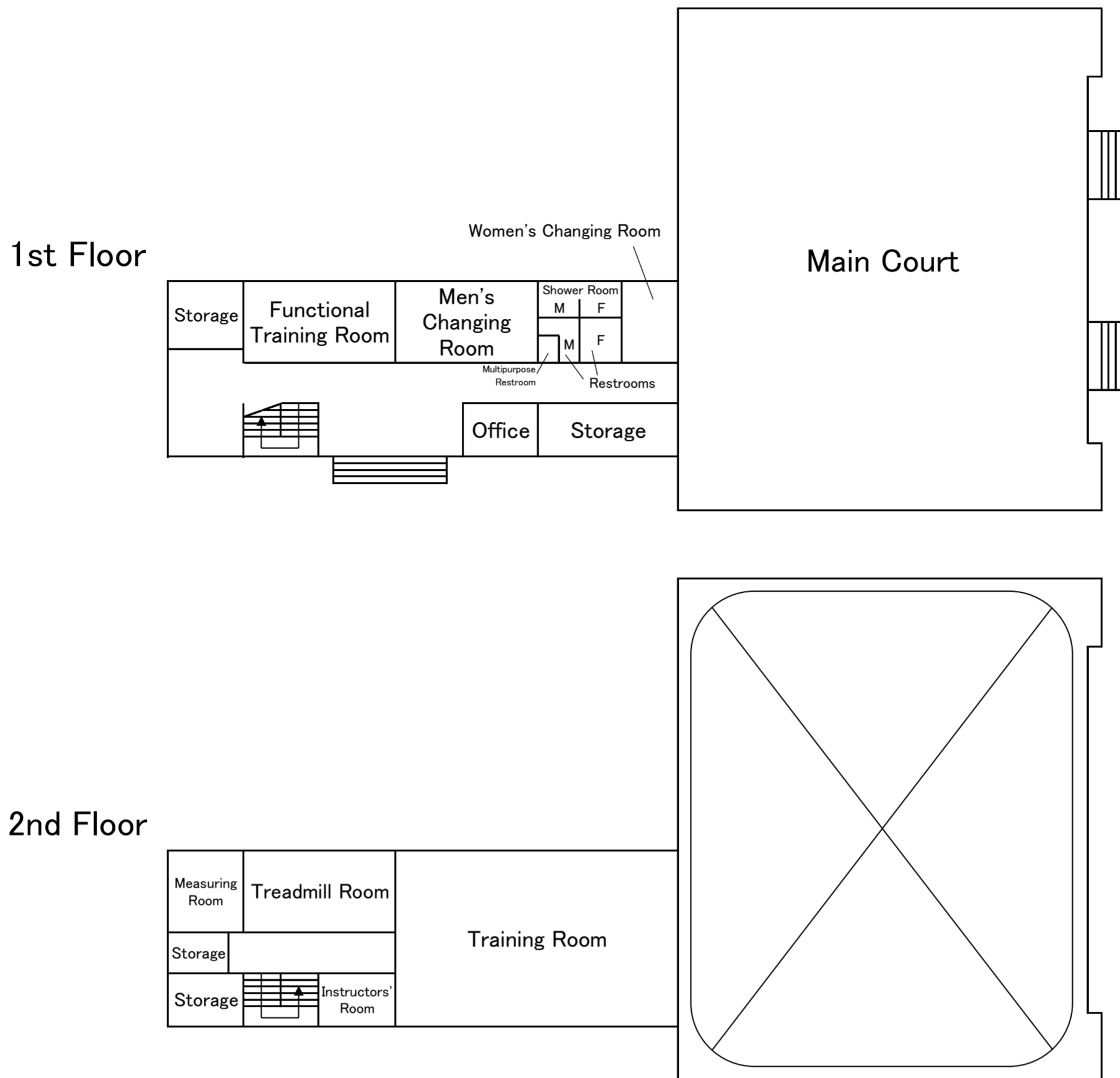

(6) Sub Arena

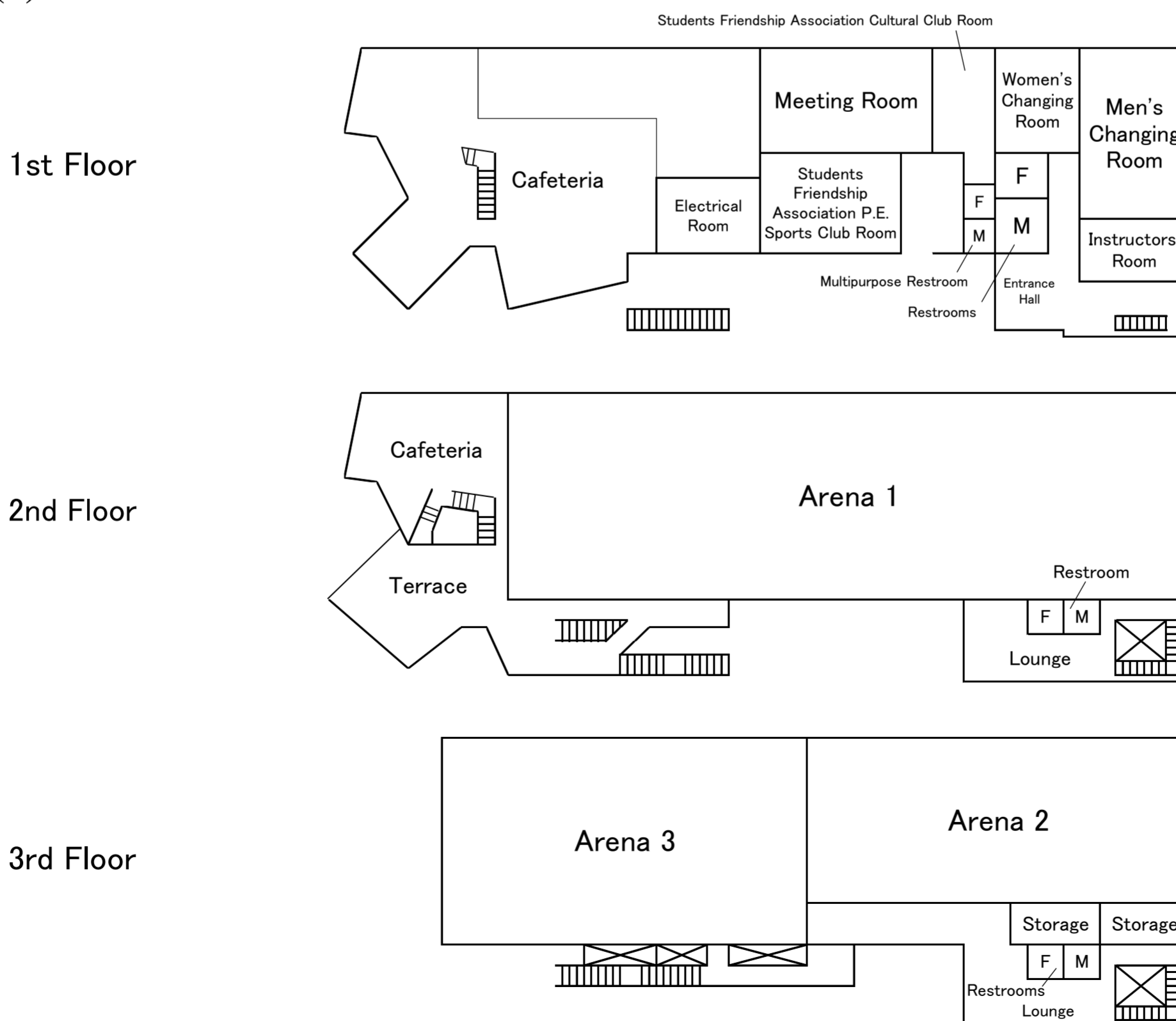

(7) Education and Student Support Center, Student Services [A01]

Student Support Division (1st floor)	
1	Support Planning Section -Lost & Found -Change of personal information (address, contact information etc.) -Thefts/crimes/accidents
2	Activity Support Section -Circles/clubs -Equipment loan
3	Life Support Section -University House, dormitories -Enrollment/invoicing for personal accident (Gakkensai) & liability (Inbound futai-gakuso) insurance -National Pension Plan
4	Financial Support Section -Waiver or deferment of entrance fee/tuition -Scholarships (for Japanese students) -Student Commuter Certificate
Educational Affairs Division (2nd floor)	
5	Educational Records and Programs Section Educational Programs Section General Education Planning Section Liberal Education Operating Section -General Education classes
Student Exchange Division (2nd floor)	
6-A	General Affairs Section -Tohoku University International House/University House
6-B	International Education Section -Future Global Leadership Undergraduate Courses (= FGL Office) -Special curriculum (Japanese language) for international students -Scholarships (Japanese Government Scholarship, Honors Scholarship etc.)
6-C	Incoming Student Exchange Section -Incoming student exchange programs -Double Degree (Joint Education) Program (incoming)
6-D	Global Programs Section -TGL Program -Outgoing overseas programs (Study Abroad Program (SAP)/exchanges/COLABS) -English language learning -Scholarships for outgoing studies abroad
7	International Support Office -Resident Status, private apartments
Center for Career Support (3rd floor)	
8	Careers Advisory Section -Counseling and information on student career paths and job-finding -Internships and part-time employment

3rd floor of the West Wing: **Global Learning Center**

(8) International Exchange Building [A12]

The offices of professors' who teach General Education Subjects are located on the second floor of the International Exchange Building.

