



**東 北 大 学**

TOHOKU UNIVERSITY

September 3, 2018

**October 2018 Admission  
FGL Program Undergraduate Courses  
General Education Guidebook**

October 2018  
Tohoku University

# Table of Contents

	Page
● Academic Calendar of 2018 General Education Program.....	1
● Class Schedule of General Education Subjects.....	2
<b>I General Education.....</b>	<b>3</b>
1. Tohoku University's Admission/Diploma/Curriculum Policies for the Undergraduate Program	
2. Goals and Mission of General Education	
3. Terms & Semesters	
4. Classes & Credits	
5. General Education System	
<b>II Registering for General Education Subjects.....</b>	<b>5</b>
1. Registration Schedule	
2. Registration Group	
3. Registration Procedures	
4. Notes on Registration and Checking Grades	
5. Enrolling for Japanese Language	
<b>III Examinations, Grading and Reports.....</b>	<b>8</b>
1. Exam Schedule, Methods	
2. Notes on Examinations	
3. Makeup Examinations	
4. Grading	
5. GPA (Grade Point Average) System	
<b>IV Introduction to Class Contents.....</b>	<b>10</b>
1. Course Numbering Code	
2. Searching Syllabus Online	
1) Search by course, 2) Search by instructor, 3) Full-text search	
<b>V General Education Class Information (FGL Program).....</b>	<b>17</b>
1. List of Subjects	
2. Timetable	
<b>VI Other.....</b>	<b>22</b>
1. Medical Care Required due to Accidents in Class	
2. Using Educational Facilities	
3. General Education Comments Box	
4. Counseling Services	
5. Preventing Theft	
● Regulations on Tohoku University General Education Subjects.....	24
● Kawauchi Campus Map.....	29
1) Campus Map, 2) Classroom, 3) Laboratories, 4) Multimedia Education and Research Complex,	
5) Gymnasium, 6) Sub Arena, 7) Education and Student Support Center, Student Service, 8) International Exchange Building	

# Academic Calendar of 2018 General Education Program

## Fall Term

Orientation for FGL Undergraduate Courses	September 26 (Wed.), 2018
Entrance Ceremony for FGL Undergraduate Courses	September 27 (Thu), 2018
Classes in Semester 2	October 1 (Mon.) – February 4 (Mon.), 2019
Class Registration by website	October 1 (Mon.) – October 15 (Mon.), 2018
Drop / Withdrawal for Class Registration	October 16 (Tue.) – October 22 (Mon.), 2018
Winter Break	December 27 (Thu.), 2018 – January 3 (Thu.), 2019
No classes due to National Center Test for University Admissions	January 18 (Fri.), 2019
Term-end Vacation	February 5 (Tue.), 2019 –

※General Education courses for FGL students will be held from the 2<sup>nd</sup> through 4<sup>th</sup> semesters.

## «For reference» Spring Term [ from April to September, 2019 ]

Orientation for the third semester (Specialized subjects for each department)	To be announced by each department
Classes in Semester 3	April 8 (Mon.) – August 8 (Thu.), 2019
Class Registration by website	TBA
Drop/ Withdrawal for Class Registration	TBA
No classes due to Open Campus	July 30 (Tue.) – July 31 (Wed.), 2019
Term-end Vacation	August 9 (Fri.) – September 30 (Mon.), 2019

## Class Timetable

Period	Class start/finish	Comments
1st Period	8:50 - 10:20	A chime will sound when classes start/finish.
2nd Period	10:30 - 12:00	
3rd Period	13:00 - 14:30	
4th Period	14:40 - 16:10	
5th Period	16:20 - 17:50	

## Class Schedule of General Education Subjects (from April, 2018 to March, 2019)

	Sun	Mon	Tue	Wed	Thu	Fri	Sat
2018 April	1	2	3	4	5	6	7
	8	9	10	11	12	13	14
	15	16	17	18	19	20	21
	22	23	24	25	26	27	28
	29	30	...	...	...	...	...
	...	...	...	...	...	...	...
May	...	...	1	2	3	4	5
	6	7	8	9	10	11	12
	13	14	15	16	17	18	19
	20	21	22	23	24	25	26
	27	28	29	30	31	...	...
	...	...	...	...	...	...	...
June	...	...	...	...	...	1	2
	3	4	5	6	7	8	9
	10	11	12	13	14	15	16
	17	18	19	20	21	22	23
	24	25	26	27	28	29	30
	...	...	...	...	...	...	...
July	1	2	3	4	5	6	7
	8	9	10	11	12	13	14
	15	16	17	18	19	20	21
	22	23	24	25	26	27	28
	29	30	31	...	...	...	...
	...	...	...	...	...	...	...
August	...	...	...	1	2	3	4
	5	6	7	8	9	10	11
	12	13	14	15	16	17	18
	19	20	21	22	23	24	25
	26	27	28	29	30	31	...
	...	...	...	...	...	...	...
September	...	...	...	...	...	...	1
	2	3	4	5	6	7	8
	9	10	11	12	13	14	15
	16	17	18	19	20	21	22
	23	24	25	26	27	28	29
	30	...	...	...	...	...	...

	Sun	Mon	Tue	Wed	Thu	Fri	Sat
October	...	1	2	3	4	5	6
	7	8	9	10	11	12	13
	14	15	16	17	18	19	20
	21	22	23	24	25	26	27
	28	29	30	31	...	...	...
	...	...	...	...	...	...	...
November	...	...	...	...	1	2	3
	4	5	6	7	8	9	10
	11	12	13	14	15	16	17
	18	19	20	21	22	23	24
	25	26	27	28	29	30	...
	...	...	...	...	...	...	...
December	...	...	...	...	...	...	1
	2	3	4	5	6	7	8
	9	10	11	12	13	14	15
	16	17	18	19	20	21	22
	23	24	25	26	27	28	29
	30	31	...	...	...	...	...
2019 January	...	...	1	2	3	4	5
	6	7	8	9	10	11	12
	13	14	15	16	17	18	19
	20	21	22	23	24	25	26
	27	28	29	30	31	...	...
	...	...	...	...	...	...	...
February	...	...	...	...	...	1	2
	3	4	5	6	7	8	9
	10	11	12	13	14	15	16
	17	18	19	20	21	22	23
	24	25	26	27	28	...	...
	...	...	...	...	...	...	...
March	...	...	...	...	...	1	2
	3	4	5	6	7	8	9
	10	11	12	13	14	15	16
	17	18	19	20	21	22	23
	24	25	26	27	28	29	30
	31	...	...	...	...	...	...

Normal classes     
  No classes (weekends, etc.)     
  No classes (holidays, etc.)

- { Makeup class for Friday will be held on January 29.
- { Makeup class for Wednesday will be held on January 30.

All offices will be closed during the New Year's season from December 29, 2018 to January 3, 2019.

# I General Education

## 1. Tohoku University's Admission/Diploma/Curriculum Policies for the Undergraduate Program

### ○Admission Policy

Tohoku University seeks students who sympathize with the university's mission, and who possess either/both of the following:

- (1) The desire to significantly contribute as researchers by seriously addressing the issues facing 21st century human society or
- (2) The desire to significantly contribute to the development of society as high-level professionals with abundant knowledge and leadership, and the strength of will, bold academic curiosity, and fundamentally excellent academic abilities to realize this desire.

### ○Diploma Policy

Tohoku University confers the bachelor's degree on students who achieve the following goals.

- (1) Obtain knowledge in their specialized fields and a multifaceted perspective based on an interest in and broad knowledge of academia in general.
- (2) Obtain the education necessary to become accomplished adults, and be able to contribute to society using expertise specific to their fields of specialization.
- (3) Have the awareness and vision to assume leadership/core roles in the global community while developing fundamental abilities.

### ○Curriculum Policy

Tohoku University structures and implements its educational curriculum as follows to ensure that students meet the goals described in the Diploma Policy.

- (1) Offer a curriculum that creates organic links between General Education Subjects to foster broad knowledge and education, and Specialized Subjects to confer basic knowledge of specialized fields.
- (2) Following the principle of "Research First," promote the development of educational methods and establishment of educational systems while implementing active learning both in and out of class.
- (3) Develop the students' ability to learn independently by evaluating learning achievements and applying the results.

## 2. Goals and Mission of General Education

The goals of this university's General Education program are to foster students who possess specialized knowledge that they can use in practical society and advanced research, comprehensive, modern knowledge and deep compassion, and an international perspective. It will fulfill basic educational requirements, providing the foundations for specialized and/or graduate education, and confer the below fundamental basic abilities, knowledge and expertise:

- 1) Basic knowledge and expertise needed for modern, international citizens to lead a social life
- 2) Basic accomplishments and skills that will provide core character-building for the modern world
- 3) Knowledge and skills related to a wide range of academic fields in order to aid understanding in specialized majors
- 4) Basic knowledge and skills required to study more specialized areas

In order to achieve these goals, the General Education curriculum is composed of three subject types: Core Subjects, Expansion Subjects, and Common Subjects. Classes comprising each subject group shall be carried out to meet the following goals:

Core Subjects	<ul style="list-style-type: none"> <li>▪ These subjects are comprised of Human Studies, Social Studies and Science Studies.</li> <li>▪ Students, regardless of major, will acquire knowledge and expertise related to topical themes in the fields of ethics, culture, linguistic expression, gender, economics, social studies, politics, history, life sciences and environmental studies. Through this they will gain a wide understanding of and flexible, multifaceted perspective on various phenomena in humanities, sociology and natural science, and cultivate knowledge and expertise that will form the foundations of their intellectual endeavors, backed by a rich set of abilities and human compassion.</li> </ul>
Expansion Subjects	<ul style="list-style-type: none"> <li>▪ These subjects are comprised of human sciences, social sciences, natural sciences (composed of six groups in mathematics, physics, chemistry, biology, earth and space science, scientific experiments), and integrated sciences.</li> <li>▪ The expansion subjects will build on the fundamental knowledge and expertise acquired in the core subjects to provide students with the perspective and learning needed to develop</li> </ul>

	foundational knowledge related to humanities, sociology, and natural sciences and find multidisciplinary solutions to topical problems. In addition, classes will introduce students to the academic careers of various researchers, thus increasing their interest in academia, providing them with the scholastic and human foundations for further specialized/graduate education.
Common Subjects	<ul style="list-style-type: none"> <li>Common Subjects are comprised of Small-Group Freshmen Seminar(Introductory Seminar) , foreign languages, information science, and health/physical education, in addition to international student subjects designed especially for international students.</li> <li>Common subjects will foster abilities and basic education and expertise that are indispensable for living in the modern world, such as subjective judgment abilities based on social ethics, decision-making and communication skills, international communication abilities and cultural understanding, basic knowledge and skills related to information science, and the knowledge and expertise needed to maintain and improve mental and physical wellness. These subjects aim to provide students with abilities and expertise that will form the starting point for self-advancement.</li> </ul>

### 3. Terms & Semesters

Tohoku University uses a two-semester system, with the period of April 1 to September 30 defined as first semester, and October 1 to March 31 as second semester. The semester comprises the basic unit of the education curriculum; General Education lasts from the 2nd to 4th semesters. **FGL Students will begin classes from the 2nd Semester.**

1st Year	2nd Year				3rd & 4th Year
Fall	Spring		Fall		5th – 8 <sup>th</sup> /9 <sup>th</sup> Semester
2nd Semester	3rd Semester		4th Semester		
	1st Quarter	2nd Quarter	3rd Quarter	4th Quarter	

### 4. Classes & Credits

Each class is held 15 times (weeks) per semester, and consists of lectures, seminars, experiments, laboratory work, skill tests, or some combination of these. Some classes may be implemented in intensive lectures. The number of credits reflects the amount of academic work performed, with one credit requiring 45 hours of study. General Education subjects confer two credits in consideration of the methods used in class, educational effect, and amount of study required outside of class, as indicated below.

Class Format	Hours of Class	Content of Study
Lectures	30 hrs.	Students take 15 ninety-minute classes, a course of four-hour lectures, a 2-4 hour seminar, experiments, laboratory work, and skill tests, requiring 2 hours per class of preparation/review.
Seminars	30 - 60 hrs.	
Experiments, Laboratory Work, Skill Tests	60 - 90 hrs.	

General Education uses the below 3 subject/class formats.

- **Introductory Seminar:** These subjects were established to introduce new students to university-level education and research, and provide them with a "shift in learning" from "high school education" to "university education." Class sizes are small (20 students or less) and incorporate autonomous learning. Students are expected to participate actively.
- **Advanced Seminar:** These build on the autonomous learning methods that students learn in the Introductory Seminars. The classes incorporate active learning through seminars, practical training, experiments, and fieldwork. They cover a wide variety of subject types and groups.
- **International Coeducational Seminar:** "International Coeducation" fosters an attitude of acceptance and understanding for diversity among students of varying languages and cultures through collaborative group work and projects. It provides learning experiences that make students reexamine their own values, and build new ones. International Coeducational Seminars provide these learning opportunities in a small-group seminar format.

### 5. General Education System

The implementation of General Education for all students at Tohoku University is carried out with support from the Institute for Excellence in Higher Education (IEHE), based on a university-wide system planned and operated by the Academic Affairs Council, which is comprised of Office of Educational Affairs representatives

from each department. The IEHE was newly established in April 2014 by merging five independent educational organizations at Tohoku University in order to implement advanced liberal arts education and provide a higher level of student support. All instructors at this university's faculties, graduate schools, research institutes/centers, the university hospital, etc., are responsible for General Education classes, and take part in a campus-wide, supportive/cooperative class-management system to enable the conducting of basic education that provides students a broad perspective.

## II Registering for General Education Subjects

### 1. Registration Schedule

Students must register for classes in compliance with rules on required subjects (subjects which students must take), recommended subjects (classes that students are urged to take) and registration prerequisites (in cases where students cannot register for one class unless they have already completed another class) as per the student handbook for their faculty, class timetables, and this guidebook.

The number of General Education subjects that are taught in English and open to Future Global Leadership Undergraduate Courses students is limited, so FGL students should register as per the Class Timetable for the FGL Courses.

Students wishing to take classes that are not listed on the FGL Class Timetable must have sufficient Japanese ability. Please contact the Student Affairs Division in advance.

#### Notes on General Education subjects Registration

- Classes that are not designated by your faculty's Student Guide will not be credited towards graduation requirements.
- Please register for classes in the appropriate semester, as listed in your faculty's Student Handbook. You cannot register for a class before the appropriate semester (advanced registration) as designated by the faculty (department/division).
- Students cannot register for two subjects with the same subject name, even if the topics, instructors, semester, and day/time of the two subjects are different. The same applies to taking a subject with the same name as one for which the student has already received credit. (Does not apply to subjects eligible for the Duplicate Registration System. See "6. Duplicate Registration System" for details.)

### 2. Registration Group

- 1) As class schedules are drawn up with consideration for class sizes in each faculty/year/division, in general you must register within groups created for your own faculty (own division). In principle, you cannot register for classes in groups other than those created for your own faculty (i.e. in other divisions).
- 2) Even in classes held for your own faculty, groups are sometimes further subdivided by Student ID Number.
- 3) For classes outside your division, it is possible that you will not be given permission to register due to the class content or class size.

### 3. Registration Procedures

- 1) In order to register for classes (and receive credits), it is necessary to complete the registration procedures. If you do not complete these procedures, you will not be able to receive credit.
- 2) The registration procedures are Web-based. In general, the classes you enter cannot be changed except during the Web-based registration confirmation/revision period. During this period, please check your registration details online, and make any necessary changes at the Student Affairs Division.
- 3) Web-based registration is performed separately for each semester. You can also check your grades and credits online.
- 4) You should inquire at the FGL office when registering for classes outside your division.

### 4. Notes on Registration and Checking Grades

In general, the classes you enter cannot be changed except during the Web-based registration confirmation/revision period. During this period, please check your registration details online, and make any necessary changes at the Student Affairs Division.

- (1) Web-based registration, confirmation/revision period  
Spring semester: April 9 (Mon.) – April 20 (Fri.)  
Fall semester: October 1 (Mon.) – October 15 (Mon.)



Educational Information System: <https://www.srp.tohoku.ac.jp/>  
Regarding Operation Manual, please refer to the following website.  
[https://www.srp.tohoku.ac.jp/gkms/manual/img/manual\\_students\\_en.pdf](https://www.srp.tohoku.ac.jp/gkms/manual/img/manual_students_en.pdf)



- ① If you do not undergo Web-based registration, you will not receive credit for classes even if you attend the lectures and take the exams.
- ② You require a Tohoku University ID and password to perform Web-based registration.
- ③ Be sure to click the "Confirm Entry" button on the Web-based registration page. After registering, you can make changes as many times as needed until the end of this registration period.
- ④ The server will receive heavy access on the final day of registration, so try to finish registering your classes before then.

(2) Procedures for deregistering classes  
Spring semester: April 23 (Mon.) – April 27 (Fri.)  
Fall semester: October 16 (Tue.) – October 22 (Mon.)



- ① By registering for a class, you commit to taking that class and being graded on it. **If you abandon a class before completing it, you will receive a D grade.**
- ② If you wish to "deregister" a class for which you have finalized registration, you must complete the necessary procedures at the Student Affairs Division by the designated date. If you perform the required procedures, you will not be graded for that class, and **your grades will show an "E" (deregistered) instead.**

(3) Confirming grades  
Spring semester: will be announced in the afternoon on August 22 (Wed.)  
Fall semester: will be announced in the afternoon on February 13 (Wed.)

- ① Please confirm your grades online using the "Grades Inquiry" screen. If you set a "Private key for the SRP image-matrix authentication" from the campus network, you will be able to check your grades from off-campus using the SRP. (For details, see: <http://www.cite.tohoku.ac.jp/srp/srp.html>)
- ② For details on grading, please see "III Examinations, Grading and Reports."

## 5. Enrolling for Japanese Language

Students on the FGL Courses are required to take 10 credits of Japanese language. Students who have taken the "Japanese Language Proficiency Test" or the "Examination for Japanese University Admission for International Students" and met certain conditions, specified elsewhere, may apply to have their test results recognized in place of coursework, and receive up to seven of the required 10 Japanese language credits.

International students at this university who have obtained a designated number of points on Japanese language tests etc. shall be considered to have completed a Japanese language class, and shall be awarded a predetermined number of credits upon application.



1. As per Articles 26-6 and 26-7 of the Tohoku University Faculty Regulations, and as elsewhere stipulated by the Minister of Education, Culture, Sports, Science and Technology, students who have obtained the specified number of points on the Japanese language tests etc., and students for whom it is recognized to be educationally beneficial by their faculty, shall be considered by this University to have completed a Japanese language class, and shall be awarded credits, as stipulated by the rules of their faculty.
2. Faculties that may approve these credits are as follows.  
Faculty of Science, School of Engineering, Faculty of Agriculture (students belonging to Future Global Leadership Undergraduate Courses)
3. Foreign language subjects for which these credits can be awarded are as follows.  
Japanese
4. Japanese language tests for which credits can be awarded, criterion for recognition, and number of credits are as follows.  
Subject: Japanese  
Name of Test:
  - i) Japanese Language Proficiency Test—JLPT (Japan Educational Exchanges and Services)
  - ii) Examination for Japanese University Admission for International Students—EJU (Japan Student Services Organization)

Criterion and Number of Credits:

Criterion	Number of Credits	Score	Subject
JLPT N3 or higher	7	AA AA AA	Basic Japanese 1 (4 Credits) Basic Japanese 2 (3 credits) Intermediate Japanese(3 credits)
JLPT N4	7	AA AA	Basic Japanese 1 (4 Credits) Basic Japanese 2 (3 credits)
JLPT N5	4	AA	Basic Japanese 1 (4 Credits)
EJU 220 points or higher (Not including Writing)	7	AA AA AA	Basic Japanese 1 (4 Credits) Basic Japanese 2 (3 credits) Intermediate Japanese(3 credits)
EJU 200 points or higher (Not including Writing)	7	AA AA	Basic Japanese 1 (4 Credits) Basic Japanese 2 (3 credits)

5. Application Instructions
  - i) Documents required for the application are the application form and a copy of the test certificate or score sheet.
  - ii) The date entered on the test certificate or score sheet must be less than two years prior to the date of application.
6. Certification Procedure
  - i) Certification of credits will be performed by the Foreign Language Committee of the Academic Affairs Council (hereafter, Foreign Language Committee) based on a copy of the test certificate or score sheet.
  - ii) Results of screenings by the Foreign Language Committee will be reported to the Educational Records and Programs Committee of the Academic Affairs Council.
  - iii) Credits for applications submitted before the end of January or the end of June will be certified the same semester; credits for applications submitted after February 1 or July 1 will be certified the following semester
7. Any items necessary for credit certification, other than those specified in this agreement, will be specified by the Foreign Language Committee.

Supplementary Regulations

Ratified on October 1, 2011

Supplementary Regulations (Revised October 5, 2015)

Made effective October 1, 2015; ratified on October 5, 2015

\*Japanese class; Intermediate Japanese (3 credits)

Students who feel that the class does not match their Japanese abilities may instead select 3 subjects (3 credits) from the General Education Japanese A-J classes (1 credit each; aimed at advanced JLPT N1-level students). These subjects are held for privately financed international students belonging to degree courses taught in Japanese.

If you wish to do this, speak to your Japanese language instructor in advance to confirm that your abilities will be sufficient before registering. Inquire with the FGL staff in the Student Exchange Division or General Education Operating Section in the Educational Affairs Division for the Japanese A-J timetable.

### III Examinations, Grading and Reports

#### 1. Exam Schedule, Methods

Examinations will be conducted by class instructors during the course or makeup period. Please follow your instructor's directions when taking examinations. Information on examinations may sometimes be announced on bulletin boards, so please check them carefully.

Grading methods for each subject are described in the syllabus.

#### 2. Notes on Examinations

Please observe the following when taking examinations. Engaging in misconduct, such as using unauthorized textbooks, dictionaries, reference materials, notes, memos etc., looking at other students' answers, or exchanging answers during the examination will be severely punished (**indefinite suspension etc.**) as a violation of student regulations. **Do not, under any circumstance, engage in such activities.**

- (1) Follow the instructions given by the supervising instructor in the examination room.
- (2) In the examination room, fill seats from the front of the room, and place your Student ID on your desk during the examination.
- (3) Do not place anything else on your desk except writing utensils and other items explicitly permitted by the supervising instructor. (Confirm in advance whether notes/references can be used.)
- (4) If you require a desk mat/underlay when writing, ask for permission from the supervising instructor.

#### 3. Makeup Examinations

If you are unable to take an examination due to illness, accident, or bereavement (loss of an immediate family member), you can apply through the Student Affairs Division to take a makeup examination for up to three days after the end of the relevant examination, excluding Saturdays, Sundays, and national holidays. The following documents are required.

- For illness: Doctor's diagnosis
- For accidents: Accident Report Form
- For bereavement: Corroborating documentation

#### 4. Grading

Grading is described in the syllabus for each subject.

However, grading for General Education subjects is handled as follows.

1. Grading for General Education subjects is as follows.

Grade	Description of Evaluation	Criteria for Points (out of 100)
AA	The student's performance was particularly exceptional.	90 – 100 points
A	The student's performance was excellent.	80 – 89 points
B	The student's performance was above average.	70 – 79 points
C	The student passed.	60 – 69 points.
D	The student failed or quit the class.	59 points or below
E	The student deregistered as per the proscribed procedures.	—

Comments

- 1) Grading and evaluation will take into account examination performance, reports submitted, attendance, and registration status.
  - 2) The "AA" grade was implemented for incoming students in the 2004 academic year onward; for students who enrolled prior to 2004, there is no distinction between the "AA" and "A" grades.
  - 3) The grade designated as "E" will be given under the following conditions.
    - a) If the student deregisters at the Student Affairs Division by the end of May (in odd-numbered semesters) or by the end of November (in even-numbered semesters).
    - b) The student takes a leave of absence, or withdraws, from the university
  - 4) This grading system is effective as of the subjects taught in the 2013 academic year onward.
2. The syllabus will provide descriptions of educational goals (academic achievement goals) and specific evaluation methods for each subject; in general, absolute evaluations will be based on the correspondence of student performance with the educational goals set for each subject.

3. Class instructors shall store student examination answer sheets for one year from the date of the examination, and reports etc. for one year from their due date, to serve as a basis for grading and to respond to any requests for information disclosure from students. However, this requirement does not apply to reports that are returned to the students with grades/comments; in the case of examination answer sheets, it is recommended that the instructor store the original and return a copy. (Reference: Tohoku University Criteria on Length of Storage Period for Documents: One year or less for examination answer sheets and reports.)
4. Students can request that the class instructor explain the grades they received, so long as they do so within a designated period of time following the announcement of grades. However, if a student is unable, for legitimate reasons, to make this request during that period, the student may request the explanation at a later time, as long as it is within the one-year storage period.
5. If the student is still unsatisfied after hearing the class instructor's explanation regarding the grade, that student can file a petition with the chairperson of the Educational Records and Programs Committee of the Academic Affairs Council (hereafter "Educational Records and Programs Committee").
6. Upon receiving a petition of dissatisfaction, the Educational Records and Programs Committee shall set up a subcommittee, composed of several members to investigate its validity.
7. The Grading Improvement Committee of the Academic Affairs Council shall compile and analyze grades, and release their findings to the class instructors and students.

\* Designated time periods is within two weeks after the announcement of grades.

\* A petition of dissatisfaction should be filed when the student is still unsatisfied after hearing the class instructor's explanation regarding the grade, not when the student who failed the class wishes to take a makeup exam. Students should not visit instructor's office without an appointment.

## 5. GPA (Grade Point Average) System

In FY 2016, the GPA system was adopted by Tohoku University to increase the students' academic motivation, contribute to the provision of appropriate learning guidance, promote rigorous grade evaluation, and improve the quality of learning. The GPA system will be applied to undergraduate curriculum students who enter in FY 2016 and later.

Discretion on how to utilize GPA is left up to the individual faculties.

### ➤ Grades and GP

Grade Points (GP) will be assigned in accordance with each faculty's regulations, faculty-specific regulations on registration, and the regulations on General Education, as per the following table.

Evaluation		GP
Letter Grade	Score	
AA	100-90	4.0
A	89-80	3.0
B	79-70	2.0
C	69-60	1.0
D	59-0	0.0

### ➤ GPA Categories and Calculation Method

Tohoku University has two types of GPA: one that indicates learning progress and achievements for the relevant semester (hereafter "semester GPA"), and one that indicates learning progress and achievements for the entire period of enrollment at the university (hereafter "cumulative GPA").

The semester and cumulative GPAs will be calculated with the below formulas, and the resulting numbers rounded to the 3rd decimal place.

$$\text{Semester GPA} = \frac{\text{Total of (GP for each class evaluated for the semester} \times \text{the number of credits for relevant classes)}}{\text{Total credits for the classes evaluated for the semester}}$$

$$\text{Cumulative GPA} = \frac{\text{Total of (GP for each class evaluated during the entire enrollment period} \times \text{the number of credits for relevant classes)}}{\text{Total credits for the classes evaluated for the entire enrollment period}}$$

➤ **Classes Affecting GPA**

Classes in the Tohoku University undergraduate curriculum that are evaluated with a letter grade or score (including classes offered by other faculties), and those that count towards graduation requirements, are applicable to the student's GPA.

However, the below classes will be excluded from the student's semester and cumulative GPAs.

- 1) Classes taken at Tohoku University deemed to fall under Articles 11-2.1, 26-5.1, 26-6.1, or 26-7.1 of the Tohoku University Faculty Regulations.
- 2) Classes for which the student has, by the prescribed date, applied, and received permission, to deregister.
- 3) Classes designated by the Chairperson of the Academic Affairs Council, or the Faculty Dean or Department Director.

➤ **Handling of Re-registration**

If a student re-registers for a required class in which she/he previously received a "D" grade or a score of less than 60, and then receives a "C" grade or a score of 60 or higher in that class, the GP and credits received for the previous "D" grade or score of less than 60, will be excluded from classes counting toward the student's cumulative GPA.

However, the above provision does not apply to the semester GPA.

## IV Introduction to Class Contents

### 1. Course Numbering Code

#### A) Course Numbering

Course Numbering is a system in which codes indicating a variety of information of each class, such as subject category and levels of difficulty, in order to clarify the curriculum structure.

By assigning codes and numbers to each class has a unique code to clarify its difficulty level/characteristics, significance, and the sequence in which courses should be taken, students can understand which classes they should register for, the role of each class within the undergraduate/graduate curriculum, and each course's objectives.

Also, clarifying course levels is expected to facilitate credit transfers with overseas universities.

#### B) Coding Method

Course Numbering at Tohoku University is organized as follows.

In general, the codes will be fixed for each class instead of being reassigned every academic year. However, codes may be reassigned in some cases, such as when there are major revisions to the class content.

##### a) Example of Course Numbering Code

A BC	- (hyphen)	DEF	1	23	G
①②		③	④	⑤	⑥

##### b) Meanings of Each Segment of the Code:

- ① Hosting Faculty/School
- ② Department/Major (for General Education etc., subject category/group)
- ③ Academic Field
- ④ Level/Characteristics
- ⑤ Classification Number
- ⑥ Language Used in Class

##### c) List of Each Segment Code

###### ① List of Hosting Faculty/School Codes (single letter)

These codes are the same as the letter that indicates the student's faculty/graduate school, shown as the third letter of the student ID number; General Education Subjects (faculty code: Z) and Teacher Training Subjects (faculty code: Q) were assigned letters not already in use.

Faculty/Graduate School	Faculty Code
Faculty of Science/Graduate School of Science	S
School of Engineering/Graduate School of Engineering	T
Faculty of Agriculture/Graduate School of Agricultural Science	A

Faculty/Graduate School	Faculty Code
General Education Subjects	Z
Teacher Training Subjects	Q

② List of Department/Major Codes (two letters) \*Those for only General Education are shown here.

General Education	Core Subjects	Human Studies	BH
		Social Studies	BS
		Science Studies	BN
	Expansion Subjects	Human Sciences	DH
		Social Sciences	DS
		Natural Sciences	DN
		Integrated Sciences	DG
	Common Subjects	Small-Group Freshmen Seminars	CS
		Foreign Languages	CF
		Information Sciences	CI
		Health Sciences	CP
		Subjects for International Students	CJ
	Teacher Training Subjects	TL	

③ Academic Field Codes (three letters)

As shown in "III Course Numbering for General Education"

④ List of Levels/Characteristic Codes (one number) \*only General Education is shown here

Class Type/Group/Subject		Code	
Core Subjects		8	
Expansion Subjects	Human Sciences, Social Sciences, Natural Sciences	1	
	Integrated Sciences	8	
Common Subjects	Introductory Seminar	8	
	Foreign Languages (English)	English A1, A2, B1, B2	1
		English C1, C2, Practical English Skills 1-2	2

	Foreign Languages (Second languages)	Introduction to Foreign Language I, II	1
		Foreign Language in Practice I, II, III, IV	2
	Others		1
Teacher Training Subjects			1

⑤ Classification Number (two numbers)

Classification Numbers are assigned for Course Numbering administration purposes; they are not sequential.

⑥ Codes for Language Used in Class (one letter)

Languages used in classes will be coded as follows.

Language Used	Code
Japanese	J
English	E
Non-English foreign languages	F
Two or more languages	B

These codes will be assigned per class instructor, in accordance with the syllabus for the relevant academic year.

(Ex.)

General Education Subject "Foundation of Calculus" taught by Professor XX (Japanese) ZDN-MAT104J

General Education Subject "Foundation of Calculus" taught by Associate Professor YY (English) ZDN-MAT104E

## 2. Searching Syllabus Online

URLs to access the Student Affairs Information System.

PC, smartphone: <https://www.srp.tohoku.ac.jp/>

Mobile phone: [https://www.srp.tohoku.ac.jp/sa\\_mb/ktop.do](https://www.srp.tohoku.ac.jp/sa_mb/ktop.do)

Top Page

Requires Tohoku University ID and password.

Contact one of the below if you have any questions.

1st/2nd year students: General Education Operating Section or your faculty's Office of Educational Affairs

Others: Your faculty's or graduate school's Office of Educational Affairs

For questions on Image Matrix Authentication, contact the Center for Information Technology in Education, Division for Technical Support.

Image Matrix Authentication

Off-campus access



Change the language to English.

TOHOKU UNIVERSITY Student Affairs Information System

HOME 教務 履修・成績 学生支援 就職支援 シラバス << 利用可能時間 7:00~24:00 >>

週間スケジュール

2014/03/06 ~ 2014/03/12

3/6 (木) 3/7 (金) 3/8 (土) 3/9 (日) 3/10 (月) 3/11 (火) 3/12 (水)

本日のスケジュール

本日の時間割はありません。

本日のスケジュールはありません。

本日が期日のToDoはありません。

講義のお知らせ

2/4 (火) 2講時 地球物質科学

あなた宛のお知らせ

あなた宛のお知らせはありません。

配置／言語設定

コンテンツ名	横幅	横位置	縦位置	幅可変
講義のお知らせ			2	<input checked="" type="checkbox"/>
お知らせ表示(全体)			1	<input checked="" type="checkbox"/>
お知らせ表示(個人宛)			2	<input checked="" type="checkbox"/>
スケジュール表示(日)			1	<input checked="" type="checkbox"/>
スケジュール表示(週間)	3	0	0	<input type="checkbox"/>

After selecting "English", click the button "更新 (update)". To change the language, you are required to **log out**, and then **log in** again. Click “ログアウト (log out)” on the top right.

言語設定

言語  Japanese  English

推奨設定に戻す クリア 更新

- キャビネット一覧
- 個人種別選択
- パスワード再設定
- 配置/言語設定
- オフラインメール

リンク

- センター
- 教育系情報システム
- 全学教育シラバス

### Online syllabus search

HOME | School Affairs | Courses/Grades | Student Services | Job-search Support | **Syllabus** <<Usage Time 7:00>>

Search from Course

**Search Condition**

Search by selecting school year to search a syllabus and specifying each search conditions

Selection screen for the types of search will be displayed.  
 (1) Search by course  
 (2) Search by instructor  
 (3) Search entire text  
 (4) Online Manual

School Year	2014	School Year					
Curriculum	--Not Selectd--	<input type="checkbox"/> Excluding Other Department					
Field and Category	--Not Selectd--	(If you want to specify a field and category, you must select Curriculum.)					
Target Grade	--Not Selectd--	(If you want to specify a target grade, you must select curriculum.)					
Course Name	<input type="text"/>						
Instructor in Charge	<input type="text"/>						
Class Starting Time	--Not Selectd--						
	Mon	Tue	Wed	Thu	Fri	Sat	Other
1	<input type="checkbox"/>	<input type="checkbox"/>	<input type="checkbox"/>	<input type="checkbox"/>	<input type="checkbox"/>	<input type="checkbox"/>	<input type="checkbox"/>
1(First half)	<input type="checkbox"/>	<input type="checkbox"/>	<input type="checkbox"/>	<input type="checkbox"/>	<input type="checkbox"/>	<input type="checkbox"/>	<input type="checkbox"/>
1(Second half)	<input type="checkbox"/>	<input type="checkbox"/>	<input type="checkbox"/>	<input type="checkbox"/>	<input type="checkbox"/>	<input type="checkbox"/>	<input type="checkbox"/>
2	<input type="checkbox"/>	<input type="checkbox"/>	<input type="checkbox"/>	<input type="checkbox"/>	<input type="checkbox"/>	<input type="checkbox"/>	<input type="checkbox"/>
2(First half)	<input type="checkbox"/>	<input type="checkbox"/>	<input type="checkbox"/>	<input type="checkbox"/>	<input type="checkbox"/>	<input type="checkbox"/>	<input type="checkbox"/>
2(Second half)	<input type="checkbox"/>	<input type="checkbox"/>	<input type="checkbox"/>	<input type="checkbox"/>	<input type="checkbox"/>	<input type="checkbox"/>	<input type="checkbox"/>

## (1) Search by course

When planning registration this allows you to efficiently check the timetable, search for only subjects for which you are eligible to register, and browse them by day/class time. Use the syllabus search (search by class) to do this.

### Search from Course

#### Search Condition

Search by selecting school year to search a syllabus and specifying each search conditions

Search Syllabus

School Year	2014 School Year																																																																																																																
Curriculum	--Not Selectd-- <input type="checkbox"/> Excluding Other Department																																																																																																																
Field and Category	--Not Selectd-- (If you want to specify a field and category, you must select Curriculum.)																																																																																																																
Target Grade	--Not Selectd-- (If you want to specify a target grade, you must select curriculum.)																																																																																																																
Course Name	<input type="text"/>																																																																																																																
Instructor in Charge	<input type="text"/>																																																																																																																
Class Starting Time	Previous period																																																																																																																
Class Period	<table border="1"> <thead> <tr> <th></th> <th>Mon</th> <th>Tue</th> <th>Wed</th> <th>Thu</th> <th>Fri</th> <th>Sat</th> <th>Other</th> </tr> </thead> <tbody> <tr> <td>1</td> <td><input type="checkbox"/></td> <td><input checked="" type="checkbox"/></td> <td><input type="checkbox"/></td> <td><input type="checkbox"/></td> <td><input type="checkbox"/></td> <td><input type="checkbox"/></td> <td><input type="checkbox"/></td> </tr> <tr> <td>1(First half)</td> <td><input type="checkbox"/></td> <td><input type="checkbox"/></td> <td><input type="checkbox"/></td> <td><input type="checkbox"/></td> <td><input type="checkbox"/></td> <td><input type="checkbox"/></td> <td><input type="checkbox"/></td> </tr> <tr> <td>1(Second half)</td> <td><input type="checkbox"/></td> <td><input type="checkbox"/></td> <td><input type="checkbox"/></td> <td><input type="checkbox"/></td> <td><input type="checkbox"/></td> <td><input type="checkbox"/></td> <td><input type="checkbox"/></td> </tr> <tr> <td>2</td> <td><input type="checkbox"/></td> <td><input type="checkbox"/></td> <td><input type="checkbox"/></td> <td><input type="checkbox"/></td> <td><input type="checkbox"/></td> <td><input type="checkbox"/></td> <td><input type="checkbox"/></td> </tr> <tr> <td>4(Second half)</td> <td><input type="checkbox"/></td> <td><input type="checkbox"/></td> <td><input type="checkbox"/></td> <td><input type="checkbox"/></td> <td><input type="checkbox"/></td> <td><input type="checkbox"/></td> <td><input type="checkbox"/></td> </tr> <tr> <td>5</td> <td><input type="checkbox"/></td> <td><input type="checkbox"/></td> <td><input type="checkbox"/></td> <td><input type="checkbox"/></td> <td><input type="checkbox"/></td> <td><input type="checkbox"/></td> <td><input type="checkbox"/></td> </tr> <tr> <td>5(First half)</td> <td><input type="checkbox"/></td> <td><input type="checkbox"/></td> <td><input type="checkbox"/></td> <td><input type="checkbox"/></td> <td><input type="checkbox"/></td> <td><input type="checkbox"/></td> <td><input type="checkbox"/></td> </tr> <tr> <td>5(Second half)</td> <td><input type="checkbox"/></td> <td><input type="checkbox"/></td> <td><input type="checkbox"/></td> <td><input type="checkbox"/></td> <td><input type="checkbox"/></td> <td><input type="checkbox"/></td> <td><input type="checkbox"/></td> </tr> <tr> <td>6</td> <td><input type="checkbox"/></td> <td><input type="checkbox"/></td> <td><input type="checkbox"/></td> <td><input type="checkbox"/></td> <td><input type="checkbox"/></td> <td><input type="checkbox"/></td> <td><input type="checkbox"/></td> </tr> <tr> <td>6(First half)</td> <td><input type="checkbox"/></td> <td><input type="checkbox"/></td> <td><input type="checkbox"/></td> <td><input type="checkbox"/></td> <td><input type="checkbox"/></td> <td><input type="checkbox"/></td> <td><input type="checkbox"/></td> </tr> <tr> <td>6(Second half)</td> <td><input type="checkbox"/></td> <td><input type="checkbox"/></td> <td><input type="checkbox"/></td> <td><input type="checkbox"/></td> <td><input type="checkbox"/></td> <td><input type="checkbox"/></td> <td><input type="checkbox"/></td> </tr> <tr> <td>7</td> <td><input type="checkbox"/></td> <td><input type="checkbox"/></td> <td><input type="checkbox"/></td> <td><input type="checkbox"/></td> <td><input type="checkbox"/></td> <td><input type="checkbox"/></td> <td><input type="checkbox"/></td> </tr> <tr> <td>7(First half)</td> <td><input type="checkbox"/></td> <td><input type="checkbox"/></td> <td><input type="checkbox"/></td> <td><input type="checkbox"/></td> <td><input type="checkbox"/></td> <td><input type="checkbox"/></td> <td><input type="checkbox"/></td> </tr> </tbody> </table>		Mon	Tue	Wed	Thu	Fri	Sat	Other	1	<input type="checkbox"/>	<input checked="" type="checkbox"/>	<input type="checkbox"/>	<input type="checkbox"/>	<input type="checkbox"/>	<input type="checkbox"/>	<input type="checkbox"/>	1(First half)	<input type="checkbox"/>	<input type="checkbox"/>	<input type="checkbox"/>	<input type="checkbox"/>	<input type="checkbox"/>	<input type="checkbox"/>	<input type="checkbox"/>	1(Second half)	<input type="checkbox"/>	<input type="checkbox"/>	<input type="checkbox"/>	<input type="checkbox"/>	<input type="checkbox"/>	<input type="checkbox"/>	<input type="checkbox"/>	2	<input type="checkbox"/>	<input type="checkbox"/>	<input type="checkbox"/>	<input type="checkbox"/>	<input type="checkbox"/>	<input type="checkbox"/>	<input type="checkbox"/>	4(Second half)	<input type="checkbox"/>	<input type="checkbox"/>	<input type="checkbox"/>	<input type="checkbox"/>	<input type="checkbox"/>	<input type="checkbox"/>	<input type="checkbox"/>	5	<input type="checkbox"/>	<input type="checkbox"/>	<input type="checkbox"/>	<input type="checkbox"/>	<input type="checkbox"/>	<input type="checkbox"/>	<input type="checkbox"/>	5(First half)	<input type="checkbox"/>	<input type="checkbox"/>	<input type="checkbox"/>	<input type="checkbox"/>	<input type="checkbox"/>	<input type="checkbox"/>	<input type="checkbox"/>	5(Second half)	<input type="checkbox"/>	<input type="checkbox"/>	<input type="checkbox"/>	<input type="checkbox"/>	<input type="checkbox"/>	<input type="checkbox"/>	<input type="checkbox"/>	6	<input type="checkbox"/>	<input type="checkbox"/>	<input type="checkbox"/>	<input type="checkbox"/>	<input type="checkbox"/>	<input type="checkbox"/>	<input type="checkbox"/>	6(First half)	<input type="checkbox"/>	<input type="checkbox"/>	<input type="checkbox"/>	<input type="checkbox"/>	<input type="checkbox"/>	<input type="checkbox"/>	<input type="checkbox"/>	6(Second half)	<input type="checkbox"/>	<input type="checkbox"/>	<input type="checkbox"/>	<input type="checkbox"/>	<input type="checkbox"/>	<input type="checkbox"/>	<input type="checkbox"/>	7	<input type="checkbox"/>	<input type="checkbox"/>	<input type="checkbox"/>	<input type="checkbox"/>	<input type="checkbox"/>	<input type="checkbox"/>	<input type="checkbox"/>	7(First half)	<input type="checkbox"/>	<input type="checkbox"/>	<input type="checkbox"/>	<input type="checkbox"/>	<input type="checkbox"/>	<input type="checkbox"/>	<input type="checkbox"/>
	Mon	Tue	Wed	Thu	Fri	Sat	Other																																																																																																										
1	<input type="checkbox"/>	<input checked="" type="checkbox"/>	<input type="checkbox"/>	<input type="checkbox"/>	<input type="checkbox"/>	<input type="checkbox"/>	<input type="checkbox"/>																																																																																																										
1(First half)	<input type="checkbox"/>	<input type="checkbox"/>	<input type="checkbox"/>	<input type="checkbox"/>	<input type="checkbox"/>	<input type="checkbox"/>	<input type="checkbox"/>																																																																																																										
1(Second half)	<input type="checkbox"/>	<input type="checkbox"/>	<input type="checkbox"/>	<input type="checkbox"/>	<input type="checkbox"/>	<input type="checkbox"/>	<input type="checkbox"/>																																																																																																										
2	<input type="checkbox"/>	<input type="checkbox"/>	<input type="checkbox"/>	<input type="checkbox"/>	<input type="checkbox"/>	<input type="checkbox"/>	<input type="checkbox"/>																																																																																																										
4(Second half)	<input type="checkbox"/>	<input type="checkbox"/>	<input type="checkbox"/>	<input type="checkbox"/>	<input type="checkbox"/>	<input type="checkbox"/>	<input type="checkbox"/>																																																																																																										
5	<input type="checkbox"/>	<input type="checkbox"/>	<input type="checkbox"/>	<input type="checkbox"/>	<input type="checkbox"/>	<input type="checkbox"/>	<input type="checkbox"/>																																																																																																										
5(First half)	<input type="checkbox"/>	<input type="checkbox"/>	<input type="checkbox"/>	<input type="checkbox"/>	<input type="checkbox"/>	<input type="checkbox"/>	<input type="checkbox"/>																																																																																																										
5(Second half)	<input type="checkbox"/>	<input type="checkbox"/>	<input type="checkbox"/>	<input type="checkbox"/>	<input type="checkbox"/>	<input type="checkbox"/>	<input type="checkbox"/>																																																																																																										
6	<input type="checkbox"/>	<input type="checkbox"/>	<input type="checkbox"/>	<input type="checkbox"/>	<input type="checkbox"/>	<input type="checkbox"/>	<input type="checkbox"/>																																																																																																										
6(First half)	<input type="checkbox"/>	<input type="checkbox"/>	<input type="checkbox"/>	<input type="checkbox"/>	<input type="checkbox"/>	<input type="checkbox"/>	<input type="checkbox"/>																																																																																																										
6(Second half)	<input type="checkbox"/>	<input type="checkbox"/>	<input type="checkbox"/>	<input type="checkbox"/>	<input type="checkbox"/>	<input type="checkbox"/>	<input type="checkbox"/>																																																																																																										
7	<input type="checkbox"/>	<input type="checkbox"/>	<input type="checkbox"/>	<input type="checkbox"/>	<input type="checkbox"/>	<input type="checkbox"/>	<input type="checkbox"/>																																																																																																										
7(First half)	<input type="checkbox"/>	<input type="checkbox"/>	<input type="checkbox"/>	<input type="checkbox"/>	<input type="checkbox"/>	<input type="checkbox"/>	<input type="checkbox"/>																																																																																																										

You can also narrow the search results by subject group, subject name, and instructor name.

Select the day/time. For example, for classes held 1st period on Tuesdays, check the corresponding box.

After making your selections, click the search button. A list of classes for which you are eligible to register will be displayed as per your search criteria.

Search Syllabus



A list of classes will be displayed as per the search criteria.

Search from Course

[Return to Previous Screen](#)

Course List

Click the course name which you want to refer to a syllabus.

1-10/19 1 2 Next 10>> 10

No	Course Code	Course Name	Class Starting Period	Instructor in Charge
1	SB1167		Previous period Tue 2	null
2	SD1104	<a href="#">Special Topics in Analysis D I</a>	Previc	
3	SB1156	<a href="#">Algebra B</a>	Previc	
4	SB3307	<a href="#">Algebra B</a>	Previous period Tue 2	null
5	SB2114	<a href="#">Quantum Mechanics II</a>	Previous period Tue 2	Kouichi Hagino
6	SB3124	<a href="#">Quantum Mechanics II</a>	Previous period Tue 2	Kouichi Hagino
7	SB2146	<a href="#">Relativistic Quantum Mechanics</a>	Previous period Tue 2	null
8	SB3149	<a href="#">Relativistic Quantum Mechanics</a>	Previous period Tue 2	null
9	SB3128	<a href="#">Physics of Earthquake Source</a>	Previous period Tue 2	Yasuo Yabe
10	SB4104	<a href="#">General Organic Chemistry C</a>	Previous period Tue 2	Masahiro Terada

You can view a class's syllabus by clicking the class title.

1-10/19 1 2 Next 10>> 10

Syllabus Screen

シラバス参照

[Return to Search Result List](#)

[Add to Your Favorite](#)

KougiName	General Biochemistry
KaikdInfo	Previous period Mon 3 null
Tani	2
Tantokyo	

in advance	General Biochemistry (生物化学概論)
Outline	To study the basic general knowledge of molecular biology, biochemistry and biophysics and to understand biological phenomena at the molecular level, students will learn the following contents. 1) Structures and chemical properties of nucleotides and nucleic acids 2) Structures and chemical properties of amino acids and proteins 3) Structures and chemical properties of sugars and lipids 4) Mechanisms of enzyme catalysis and their analysis method
Target	Students will gain deep insights into physiological functions of nucleic acids, proteins, sugars, lipids and other important biomolecules. Also, students will understand mechanisms of operations of several important enzymes on the basis of their molecular structures.
Naiyo	Lectures will follow the textbook indicated below. Especially, we will focus upon Chapters 1-9 of it.
Method	Attendance, attitude in Class and results of examinations will be taken into consideration for evaluation.
Kyokasyo	Berg, Tymoczko and Stryer, Biochemistry, 7th international edition.
Sonota	
LastUpdate	2014/02/19 16:26



## (2) Search by instructor

This allows you to search by class instructor.

**Search by Instructor**

**Search Conditions**

 Select a year that you want to search syllabus and search instructor.

 School Year	<input type="text" value="2014"/>
 Name	<input type="text"/>
 Full-time/Part-time	<input type="checkbox"/> Full-time <input type="checkbox"/> Part-time





## (3) Full-text search

This allows you to search for words/text contained in the syllabuses.

**Search Entire Text**

**Search Condition**

 Select a year that you want to search syllabus and enter the search keyword.

 School Year	<input type="text" value="2014"/>
 Search Keyword	<input type="text"/>

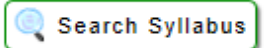

## V General Education Class Information (FGL Program)

### 1. List of Subjects (2<sup>nd</sup>, 3<sup>rd</sup>, and 4<sup>th</sup> Semester Classes)

#### (1) Core Subjects

Lecture Name	Hrs./Wk.	Credits	Topics	Instructor	Sem ester	Day/Period	Courses
Human Studies							
World of Fine Arts	2	2	Japanese Art History	Mitsuru HAGA	2	Thu./2 <sup>nd</sup>	AMC IMAC-U AMB
Social Studies							
History and Human Society	2	2	History of Tohoku University	Manabu NAKAGAWA	2	Wed./1 <sup>st</sup>	AMC IMAC-U AMB
Science Studies							
Life and Nature	2	2	Study of Nature, Life and Technology: The organization and evolution of the universe	Martin ROBERT	2	Mon./4 <sup>th</sup>	AMC IMAC-U AMB

#### (2) Expansion Subjects

Lecture Name	Hrs./Wk.	Credits	Topics	Instructor	Sem ester	Day/Period	Courses
Human Sciences							
History	2	2	History of Art in Ancient Eurasia: Diffusion of Classical Greek Art into Central Asia	Mitsuru HAGA	3	Wed./5 <sup>th</sup>	AMC IMAC-U AMB
Linguistics	2	2	TBA	TBA	3	TBA	AMC IMAC-U AMB
Social Sciences							
Economics	2	2	Japanese Business and Economy A	Dan QIN	2 (4)	Tue./1 <sup>st</sup>	AMC IMAC-U (AMB)
Natural Sciences/Mathematics							
Foundations of Calculus	2	2	Foundations of Calculus	Frank HANSEN	2	Fri./3 <sup>rd</sup>	AMB
Calculus A	2	2	Calculus of functions of one variable	Igor TRUSHIN	2	Fri./2 <sup>nd</sup>	AMC IMAC-U
Calculus B	2	2	Calculus of function of two variables	Igor TRUSHIN	3	Tue./4 <sup>th</sup>	AMC IMAC-U
Calculus C	2	2	Calculus C. Ordinary differential equations	Frank HANSEN	4	Tue./1 <sup>st</sup>	AMC IMAC-U
Foundations of Linear Algebra	2	2	Foundations of Linear Algebra	Frank HANSEN	2	Mon./3 <sup>rd</sup>	AMB
Linear Algebra A	2	2	Fundamentals of Linear Algebra	Igor TRUSHIN	2	Tue./3 <sup>rd</sup>	AMC IMAC-U
Linear Algebra B	2	2	Basics of Linear Algebra	Igor TRUSHIN	3	Fri./2 <sup>nd</sup>	AMC IMAC-U
Probability & Statistics	2	2	Probability and Statistics	Frank HANSEN	4	Wed./2 <sup>nd</sup>	AMC IMAC-U AMB
Natural Sciences/Physics							
Physics A	2	2	Classical Mechanics	Takeshi KOIKE	2	Fri./4 <sup>th</sup>	AMC IMAC-U AMB
Physics B	2	2	Oscillations, waves, propagation of waves in media, stress and strain, fluid dynamics	Takeshi KOIKE	3	Thu./2 <sup>nd</sup>	AMC IMAC-U AMB
Physics C	2	2	Electromagnetism	Takeshi KOIKE	3	Wed./1 <sup>st</sup>	AMC IMAC-U AMB

Natural Sciences/Chemistry							
Chemistry A	2	2	Fundamentals of chemical bond theory	Nurbosyn U. ZHANPEISOV	2	Wed./2 <sup>nd</sup>	AMC IMAC-U AMB
Chemistry B	2	2	Fundamentals of Physical Chemistry	Nurbosyn U. ZHANPEISOV	2	Thu./3 <sup>rd</sup>	AMC IMAC-U AMB
Chemistry C	2	2	Fundamentals of basic organic chemistry	Nurbosyn U. ZHANPEISOV	3	Wed./3 <sup>rd</sup>	AMC IMAC-U AMB
Natural Sciences/Biology							
Biology A	2	2	Essential Cell Biology	Martin ROBERT	2	Tue./2 <sup>nd</sup>	AMC IMAC-U AMB
Biology B	2	2	Essential Biochemistry	Martin ROBERT	3	Tue./2 <sup>nd</sup>	AMC AMB
Biology C	2	2	Elements of Physiology and Systems biology: Integrative and systems principles in biology	Martin ROBERT	3	Wed./4 <sup>th</sup>	AMC AMB
Natural Sciences/ Earth and Space Science							
Mineralogy, Petrology & Geochemistry	2	2	Fundamentals of Crystal Structures of Solids	Nurbosyn U. ZHANPEISOV	2	Mon./2 <sup>nd</sup>	AMC IMAC-U AMB
Natural Sciences/Scientific Experiments							
Introductory Science Experiments	4	2	Introductory Science Experiments	Head: Norihiko NAKAMURA	3	Thu./3 <sup>rd</sup> ·4 <sup>th</sup>	AMC IMAC-U AMB
Integrated Sciences							
Current Topics	2	2	Course subjects to be taught will be determined yearly. Use syllabus search of Student Affairs Information System to check class topics and timetable.		2,3		AMC IMAC-U AMB

### (3) Common Subjects

Lecture Name	Hrs./Wk.	Credits	Topics	Instructor	Sem ester	Day/Period	Courses
Small-Group Freshmen Seminars							
Introductory Seminar*	2	2	Fundamental mathematics seminar on selected topics of calculus	Igor TRUSHIN	3	Intensive courses	AMC IMAC-U AMB
			Fundamental chemistry seminar on selected topics	Nurbosyn U. ZHANPEISOV	3	Intensive courses	
			Advanced calculus for functions of several variables	Frank HANSEN	3	Intensive courses	
			Interactive Short Course in Marine Biology	Martin ROBERT, Gaku KUMANO, Ayaki NAKAMOTO	3	Intensive courses	
Subjects for International Students							
Basic Japanese 1	8	4	Japanese for beginners	Natsue SUGAYA, Kei YOSHIMOTO, Atsuko UCHIYAMA	2	Mon./5 <sup>th</sup> Tue./5 <sup>th</sup> Thu./5 <sup>th</sup> Fri./5 <sup>th</sup>	AMC IMAC-U AMB
Basic Japanese 2	6	3	Japanese for advanced beginners	Natsue SUGAYA, Kei YOSHIMOTO	3	Tue./5 <sup>th</sup> Wed./2 <sup>nd</sup> Thu./5 <sup>th</sup>	AMC IMAC-U AMB
Intermediate Japanese	6	3	Intermediate Japanese	Atsuko UCHIYAMA, Yukari AZUMI	4	Tue./2 <sup>nd</sup> ·3 <sup>rd</sup> Wed./1 <sup>st</sup>	AMC IMAC-U AMB
Information Sciences							
An Introduction to Information Science B	2	2	Information Fundamentals B	Takeshi TOKUYAMA Matias KORMAN	2	Mon./1 <sup>st</sup>	AMC IMAC-U AMB

Health Sciences							
Sports A	2	1	Kyudo (Japanese Archery – Rules of Shooting and Etiquette) Softball Badminton	Akira SATO Toshihiko FUJIMOTO Akira TAMAGAWA	2	Fri./3 <sup>rd</sup>	AMC
	2	1	Badminton Kyudo (Japanese Archery – Rules of Shooting and Etiquette) Softball Soccer	Akira TAMAGAWA Akira SATO Toshihiko FUJIMOTO Ryoichi NAGATOMI	2	Tue./3 <sup>rd</sup>	AMB
	2	1	TBA	TBA	3	Tue./2 <sup>nd</sup>	IMAC-U
Health	2	2	Health Science	Ryoichi NAGATOMI	2	Thu./4 <sup>th</sup>	AMC IMAC-U AMB

Syllabuses for 3rd and 4th semester classes will be announced in March 2019.

### **Cooperative Innovation Program in Science, Engineering, and Agriculture for Leading Sustainable Industry and Society**

The FGL program has been selected by MEXT for a new program aimed at government-sponsored students. As a result starting in FY 2015, FGL will be able to accept 10 government-sponsored students each year for three years. The objective of this program is to create an educational system based on cooperation between three undergraduate schools that will foster leaders in the field of global sustainable industry and society while driving innovation in university education.

Those who enter FGL as government-sponsored students will also belong to this new program. Therefore, in addition to the curricula of their undergraduate schools, the government-sponsored students will have to fulfill the requirements of this program as well. The program requirements (i.e. requirements for receiving government sponsorship) consist of six credits in the below four subjects. For details of each subject, please see the syllabus. (1 and 2 below are General Education subjects. In the above table, they are indicated by an asterisk (\*) to the right of the subject names.)

1. Introductory Seminar (Interdisciplinary Seminar) [2 credits] — General Education Subjects
2. Life and Nature (Study of Nature, Life and Technology) [2 credits] — General Education Subjects
3. Science, Technology and Industry in Japan [1 credit] — Specialized Subjects
4. Multidisciplinary Internship [1 credit] — Specialized Subjects

## 2. Timetable

2nd Semester (October 2018 - March 2019)

  General Education Subjects

  Specialized Subjects

AMC Course

	8:50 - 10:20	10:30 - 12:00	13:00 - 14:30	14:40 - 16:10	16:20 - 17:50
Mon.	情報基礎 B <b>An Introduction to Information Science B</b> Shuji ISOBE, Eisuke KOIZUMI Multimedia Education and Research Complex M101	地球物質科学 <b>Mineralogy, Petrology &amp; Geochemistry</b> Nurbosyn U. Zhanpeisov C305		生命と自然 <b>Life and Nature</b> Martin ROBERT A301	<b>Basic Japanese 1</b> Atsuko UCHIYAMA A402
Tue.	経済学 <b>Economics</b> Dan QIN Multidisciplinary Research Bldg [C19] No.2 Small Lecture Room	生命科学 A <b>Biology A</b> Martin ROBERT C104	線形代数学 A <b>Linear Algebra A</b> Igor TRUSHIN C301		<b>Basic Japanese 1</b> Kei YOSHIMOTO A402
Wed.	歴史と人間社会 <b>History and Human Society</b> Manabu NAKAGAWA A203	化学 A <b>Chemistry A</b> Nurbosyn U. Zhanpeisov C204	(HR 13:30-)	<b>Introduction to Basic Chemistry 14:30-</b> Kenji INABA, Other AMC Course Professors Laboratory of Katahira Campus	
Thu.	[If applicable] <b>Supplementary Lessons of Calculus</b> Oct. 11, 12, 18, 19, 25, 26 Igor TRUSHIN, Frank HANSEN C304	芸術の世界 <b>World of Fine Arts</b> Mitsuru HAGA C202	化学 B <b>Chemistry B</b> Nurbosyn U. Zhanpeisov C301	体と健康 <b>Health</b> Ryoichi NAGATOMI C105	<b>Basic Japanese 1</b> Natsue SUGAYA A402
Fri.		解析学 A <b>Calculus A</b> Igor TRUSHIN C302	<b>Sports A</b> *see below Akira SATO, Toshihiko FUJIMOTO, Akira TAMAGAWA Haruki MOMMA	物理学 A <b>Physics A</b> Takeshi KOIKE C301	<b>Basic Japanese 1</b> Natsue SUGAYA A402

\*Students will choose one of the sports activities on the first day of Sports A. It is not required to wear sportswear or gym shoes on the date below. Date: Oct. 5 (Fri.) 3rd period Location: Gymnasium, Kawauchi Campus Main court

## IMAC-U Course

	8:50 - 10:20	10:30 - 12:00	13:00 - 14:30	14:40 - 16:10	16:20 - 17:50
Mon.	情報基礎 B <b>An Introduction to Information Science B</b> Shuji ISOBE, Eisuke KOIZUMI Multimedia Education and Research Complex M101	地球物質科学 <b>Mineralogy, Petrology &amp; Geochemistry</b> Nurbosyn U. Zhanpeisov C305		生命と自然 <b>Life and Nature</b> Martin ROBERT A301	<b>Basic Japanese 1</b> Atsuko UCHIYAMA A402
Tue.	経済学 <b>Economics</b> Dan QIN Multidisciplinary Research Bldg [C19] No.2 Small Lecture Room	生命科学 A <b>Biology A</b> Martin ROBERT C104	線形代数学 A <b>Linear Algebra A</b> Igor TRUSHIN C301		<b>Basic Japanese 1</b> Kei YOSHIMOTO A402
Wed.	歴史と人間社会 <b>History and Human Society</b> Manabu NAKAGAWA A203	化学 A <b>Chemistry A</b> Nurbosyn U. Zhanpeisov C204		数学物理学演習 I <b>Exercises in Mathematics and Physics I</b> Ying CHEN C104	
Thu.	[If applicable] <b>Supplementary Lessons of Calculus</b> Oct. 11, 12, 18, 19, 25, 26 Igor TRUSHIN, Frank HANSEN C304	芸術の世界 <b>World of Fine Arts</b> Mitsuru HAGA C202	化学 B <b>Chemistry B</b> Nurbosyn U. Zhanpeisov C301	体と健康 <b>Health</b> Ryoichi NAGATOMI C105	<b>Basic Japanese 1</b> Natsue SUGAYA A402
Fri.		解析学 A <b>Calculus A</b> Igor TRUSHIN C302		物理学 A <b>Physics A</b> Takeshi KOIKE C301	<b>Basic Japanese 1</b> Natsue SUGAYA A402

## AMB Course

	8:50 - 10:20	10:30 - 12:00	13:00 - 14:30	14:40 - 16:10	16:20 - 17:50
Mon.	情報基礎 B <b>An Introduction to Information Science B</b> Shuji ISOBE, Eisuke KOIZUMI Multimedia Education and Research Complex <b>M101</b>	地球物質科学 <b>Mineralogy, Petrology &amp; Geochemistry</b> Nurbosyn U. Zhanpeisov <b>C305</b>	線形代数数学概要 <b>Foundations of Linear Algebra</b> Frank HANSEN <b>A301</b>	生命と自然 <b>Life and Nature</b> Martin ROBERT <b>A301</b>	<b>Basic Japanese 1</b> Atsuko UCHIYAMA <b>A402</b>
Tue.		生命科学 A <b>Biology A</b> Martin ROBERT <b>C104</b>	<b>Sports A</b> *see below Akira SATO, Toshihiko FUJIMOTO, Akira TAMAGAWA, Ryoichi NAGATOMI		<b>Basic Japanese 1</b> Kei YOSHIMOTO <b>A402</b>
Wed.	歴史と人間社会 <b>History and Human Society</b> Manabu NAKAGAWA <b>A203</b>	化学 A <b>Chemistry A</b> Nurbosyn U. Zhanpeisov <b>C204</b>	<b>(Lab Tour on Aobayama campus)</b>		
Thu.	[If applicable] <b>Supplementary Lessons of Calculus</b> Oct. 11, 12, 18, 19, 25, 26 Igor TRUSHIN, Frank HANSEN <b>C304</b>	芸術の世界 <b>World of Fine Arts</b> Mitsuru HAGA <b>C202</b>	化学 B <b>Chemistry B</b> Nurbosyn U. Zhanpeisov <b>C301</b>	体と健康 <b>Health</b> Ryoichi NAGATOMI <b>C105</b>	<b>Basic Japanese 1</b> Natsue SUGAYA <b>A402</b>
Fri.		生理生態学概論 <b>Introduction to Physiology and Ecology</b> Ian GLEADALL <b>C303</b>	解析学概要 <b>Foundations of Calculus</b> Frank HANSEN <b>C301</b>	物理学 A <b>Physics A</b> Takeshi KOIKE <b>C301</b>	<b>Basic Japanese 1</b> Natsue SUGAYA <b>A402</b>

\*Students will choose one of the sports activities on the first day of Sports A. It is not required to wear sportswear or gym shoes on the date below. Date: Oct. 2 (Tue.) 3rd period Location: Gymnasium, Kawauchi Campus Main court

### 3. Syllabus (2<sup>nd</sup> Semester) – See the additional booklet.

## VI Other

### 1. Medical Care Required due to Accidents in Class

Students who suffer accidents during class should contact the Student Health Care Center and make arrangements to receive medical care.

### 2. Using Educational Facilities

(1) CALL System and ICL Rooms	The CALL System and ICL Rooms at the Multimedia Education and Research Complex can be used for self-study any time they are not being used for classes.
(2) Lounge	There is a lounge in Building B on the 1st floor. You may use it to rest and relax in the time between classes etc.
(3) Study Room	The Study Room is in Building B on the 2nd floor. It is open from 8:30 to 18:00. Please refrain from making noise in the Study Room.
(4) SLA Lounge	There is a SLA (Student Learning Adviser) desk, where students can go for consulting near the entrance hall on the 1st floor of the Multimedia Education and Research Complex. Older students will answer questions and provide advice on various subjects. Please see the Center for Learning Support bulletin board for details.

### 3. General Education Comments Box

In order to improve and enhance the General Education system, comment boxes have been provided to allow students to submit their written opinions and requests.

(1) Comment boxes can be found on Kawauchi-Kita campus in front of the report box on the 2nd floor of the Education and Student Support Center, and in the lounge on the first floor of Building B.
(2) Please use the provided comment forms. Please enter your department, name, and student number when submitting comments. (Anonymous opinions/requests may not be honored as their circumstances cannot be verified.)
(3) Submitted opinions and requests will be collected twice a month (at the beginning and middle of each month), and responses will be posted, without revealing the identity of the submitter, about one month later on the "Tohoku University General Education" website.

### 4. Counseling Services

Students requiring counseling from someone other than their class instructors or department staff should contact the below counseling services. The details of counseling will be kept strictly confidential. (No Charge)

(1) Center for Counseling and Disability Services	<ul style="list-style-type: none"> <li>▪ Center for Counseling and disability Services provides consulting regarding problems that arise during student life. Appropriate solutions will be discussed with the student.</li> <li>▪ Location: Kawauchi Kita Campus, Tel: 795-7833</li> <li>▪ Hours: Mon. - Fr. 9:30 - 17:00</li> </ul>
(2) Student Health Care Center	<ul style="list-style-type: none"> <li>▪ The goal of the Student Health Care Center is to maintain and improve student health. Students who have questions, concerns or anxiety about their physical or psychological health should make use of this facility. The first aid offices at Katahira, Schools of Medicine/Dentistry, School of Engineering, and Faculty of Agriculture also provide medical consulting and care.</li> <li>▪ Location: Kawauchi Kita Campus, Tel: 795-7829</li> <li>▪ Hours: Weekdays 9:00 - 11:30, 13:00 - 16:15</li> </ul>
(3) International Students' Advising	<ul style="list-style-type: none"> <li>▪ The International Students' Advising conducts counseling provided by a third party.</li> <li>E-mail: advising-f@insc.tohoku.ac.jp (female professor)</li> <li style="padding-left: 20px;">advising-m@insc.tohoku.ac.jp (male professor)</li> <li>Postal Address: 980-8576 Aoba-ku, Kawauchi 41</li> <li style="padding-left: 40px;">3rd floor, West Building, Education and Student Support Center</li> </ul>
(4) University-wide Harassment Counseling Center	<ul style="list-style-type: none"> <li>▪ Location: Kawauchi Kita Campus University Counseling Center, Tel: 022-795-7812</li> <li>▪ Hours: Mon. - Fri., 9:30 - 17:00</li> </ul>
(5) Counseling by Phone (Provided through off-campus organization)	<ul style="list-style-type: none"> <li>▪ Counseling regarding sexual harassment, health, mental health</li> <li>▪ Toll-free hotline: 0120-7830-59</li> <li>▪ Hours: Mon., Wed., Fri., Sat., Sun. 10:00 - 21:00</li> <li style="padding-left: 20px;">Tue., Thu. 10:00 - 22:00 (not available on national holidays, Dec. 31 – Jan. 3)</li> </ul>

### 5. Preventing Theft

(1) Incidences of theft in lecture halls and gymnasiums are fairly common. Do not leave bags etc. unattended in classrooms or study rooms, even for short periods of time. In the event of theft, report the incident to your Student Affairs Division or Student Services Division.



(2) There are numerous incidences of bicycle theft on Kawauchi Campus. When parking bicycles, lock them securely and do not leave them unattended for long periods of time.

● **Regulations on Tohoku University General Education Subjects**

April 1, 1993 Reg. 91

(Purport)

Article 1: These regulations specify items necessary to General Education Subjects and subjects related to education (does not include those established by the faculties; hereafter "General Education Subjects") in compliance with Article 26-2 of the Tohoku University Faculty Regulations (enacted December 18, 1952; hereafter "the Regulations").

(General Education Subjects)

Article 2: Categories of General Education Subjects are as follows.

Category	Group	
Core Subjects	Human Studies, Social Studies, Science Studies	
Expansion Subjects	Human Sciences, Social Sciences	
	Natural Sciences	Mathematics, Physics, Chemistry, Biology, Earth and Space Science, Scientific Experiments
	Integrated Sciences	Integrated Subjects, Current Topics, Modern Academics
Common Subjects	Small-Group Freshmen Seminars	
	Foreign Languages	English, Second Languages, Other Languages
	Information Sciences	
	Health Sciences	
	Subjects for International Students	

(Course Subjects and Credits)

Article 3: Course subjects for General Education subjects and credits are as shown in Tables 1 and 2.

(Calculation of Credits)

Article 4: Calculation of credits for General Education course subjects are as follows.

I 1 (one) credit will be awarded per 15 hours of class time.

II 1 (one) credit will be awarded per 15 to 30 hours of seminar.

III 1 (one) credit will be awarded per 30 to 45 hours of experiments, laboratory work, and practical training.

(Registration Procedures)

Article 5: Students must inform the Chairperson of the Academic Affairs Council (hereafter, "the Chairperson") of the subjects for which they intend to register by the designated date.

(Examinations)

Article 6: Accreditation for course subjects for which students register will depend on examinations; those who pass their examinations shall receive the designated number of credits.

2 Regardless of the previous item, performance in classes consisting of experiments, laboratory work and practical training shall be graded based on daily performance instead of examinations.

3 For course subjects in which examinations can be given, the above article only applies to those who have enrolled in the class via the designated procedures.

(Makeup Examinations and Retesting)

Article 7: If, due to unavoidable circumstances, a student is unable to take a course subject's examination, a makeup test for that subject shall be conducted.

3. There will be no retesting for students who failed a course subject's examination.

(Grading Scale)

Article 8: Examination performance shall be evaluated as per the below scale. However, depending on the course subject, the grade may be specified as just "Pass" or "Fail."

AA The student's performance was particularly exceptional.

A The student's performance was excellent.

B The student's performance was above average.

C The student passed.

D The student failed.

2. Of the above grades, AA, A, B, and C are passing grades, while D is a failing grade.

3. Students who fail to attend a class for which they have submitted registration as per Article 5 above, shall receive a D grade on that class's examinations.

(Special Auditing Students)

Article 9: Students of other universities, junior colleges, or technical colleges who wish to enroll in General Education subjects may be permitted to enroll as Special Auditing Students, pursuant to agreements with that other university, junior college, or technical college.

(Miscellaneous Provisions)

Article 10: Any items necessary for General Education subjects, other than those specified in these regulations, will be specified by the Academic Affairs Council.

Supplementary Regulations Omitted

**Table 1: General Education Subjects**

Category	Group	Subject	Total class hours	Credits	Comments
Core Subjects	Human Studies	World of Thoughts and Ethics	30	2	
		World of Literature	30	2	
		World of Expression	30	2	
		World of Fine Arts	30	2	
		People and Culture	30	2	
	Social Studies	History and Human Society	30	2	
		Economy and Society	30	2	
		Law, Politics and Society	30	2	
		Study of Society	30	2	
		Gender and Human Society	30	2	
	Science Studies	Study of Nature	30	2	
		Scientific, Technology, and Energy	30	2	
		Life and Nature	30	2	
		Nature and the Environment	30	2	
		Science and Information	30	2	
Expansion Subjects	Human Sciences	Logic	30	2	
		Philosophy	30	2	
		Literature	30	2	
		Religion	30	2	
		Education	30	2	
		History	30	2	
		Linguistics	30	2	
	Social Sciences	Sociology	30	2	
		Psychology	30	2	
		Law	30	2	
		Japanese Constitutional Law	30	2	
		Politics	30	2	
		Economics	30	2	
		Cultural Anthropology	30	2	
		Human Geography	30	2	
	Natural Sciences	Mathematics	Foundations of Mathematics A	30	2
			Foundations of Mathematics B	30	2
			Foundations of Mathematics C	30	2
			Foundations of Calculus	30	2
			Calculus A	30	2
			Calculus B	30	2
			Calculus C	30	2
			Calculus D	30	2
			Foundations of Linear Algebra	30	2
			Linear Algebra A	30	2
			Linear Algebra B	30	2
			Probability & Statistics	30	2
			Physics	Foundations of Physics	30
		Physics A		30	2
		Physics B-1		15	1
		Physics B-2		15	1
		Physics C		30	2
		Chemistry	Physics D	30	2
Foundations of Chemistry			30	2	
Chemistry A			30	2	
Chemistry B	30		2		
	Chemistry C	30	2		

Category	Group		Subject	Total class hours	Credits	Comments
Expansion Subjects	Natural Sciences	Biology	Foundations of Biology	30	2	
			Biology A	30	2	
			Biology B	30	2	
			Biology C	30	2	
		Earth and Space Science	Elementary Environmental Earth Science	30	2	
			Elementary Astronomy	30	2	
			Earth System Science	30	2	
			Mineralogy, Petrology & Geochemistry	30	2	
			Physical Geography	30	2	
			Astronomy	30	2	
		Scientific Experiments	Geophysics	30	2	
			Introductory Science Experiments-1	30	1	
			Introductory Science Experiments-2	30	1	
			Introductory Science Experiments for Humanities-1	30	1	
	Integrated Sciences	Integrated Subjects	Introductory Science Experiments for Humanities-2	30	1	
				30	2	
		Current Topics		30	2	
		Modern Academics	Modern Scholarship	30	2	
		Global Education Subjects	Seminar on Global Knowledge	30	2	
			Global Studies	30	2	
			Japanese Society and Culture A	30	2	
			Japanese Society and Culture B	30	2	
			Intercultural Understanding	30	2	
			Global Communication	30	2	
			Problem / Project-Based Learning Seminar A	30	2	
			Problem / Project-Based Learning Seminar B	30	2	
			Global Career A	30	2	
Global Career B	30		2			
Study-abroad (Basic)	30		2			
Study-abroad (Advance)	30	2				
Common Subjects	Small-Group Freshmen Seminar		Introductory Seminar	30	2	
	Foreign Languages	English	English A1	30	1	
			English A1-1	15	0.5	
			English A1-2	15	0.5	
			English A2	30	1	
			English A2-1	15	0.5	
			English A2-2	15	0.5	
			English B1	30	1	
			English B1-1	15	0.5	
			English B1-2	15	0.5	
			English B2	30	1	
			English B2-1	15	0.5	
			English B2-2	15	0.5	
			English C1	30	1	
			English C1-1	15	0.5	
			English C1-2	15	0.5	
			English C2	30	1	
			English C2-1	15	0.5	
			English C2-2	15	0.5	
			Practical English Skills 1	30	1	
			Practical English Skills 1-1	15	0.5	
			Practical English Skills 1-2	15	0.5	
			Practical English Skills 2	30	1	
			Practical English Skills 2-1	15	0.5	
			Practical English Skills 2-2	15	0.5	

Category	Group		Subject	Total class hours	Credits	Comments
Common Subjects	Foreign Languages	Second Languages	Introduction to German I-1	30	1	
			Introduction to German I-2	30	1	
			Introduction to German II-1	30	1	
			Introduction to German II-2	30	1	
			German in Practice I-1	15	1	
			German in Practice I-2	15	1	
			German in Practice II-1	15	1	
			German in Practice II-2	15	1	
			Introduction to French I-1	30	1	
			Introduction to French I-2	30	1	
			Introduction to French II-1	30	1	
			Introduction to French II-2	30	1	
			French in Practice I-1	15	1	
			French in Practice I-2	15	1	
			French in Practice II-1	15	1	
			French in Practice II-2	15	1	
			French in Practice III-1	15	1	
			French in Practice III-2	15	1	
			French in Practice IV-1	15	1	
			French in Practice IV-2	15	1	
			Introduction to Russian I-1	30	1	
			Introduction to Russian I-2	30	1	
			Introduction to Russian II-1	30	1	
			Introduction to Russian II-2	30	1	
			Russian in Practice I-1	15	1	
			Russian in Practice I-2	15	1	
			Russian in Practice II-1	15	1	
			Russian in Practice II-2	15	1	
			Russian in Practice III-1	15	1	
			Russian in Practice III-2	15	1	
			Russian in Practice IV-1	15	1	
			Russian in Practice IV-2	15	1	
			Introduction to Spanish I-1	30	1	
			Introduction to Spanish I-2	30	1	
			Introduction to Spanish II-1	30	1	
			Introduction to Spanish II-2	30	1	
			Spanish in Practice I-1	15	1	
			Spanish in Practice I-2	15	1	
			Spanish in Practice II-1	15	1	
			Spanish in Practice II-2	15	1	
			Personalized Intermediate Spanish I-1	15	1	
			Personalized Intermediate Spanish I-2	15	1	
			Personalized Intermediate Spanish II-1	15	1	
			Personalized Intermediate Spanish II-2	15	1	
			Introduction to Chinese I-1	30	1	
			Introduction to Chinese I-2	30	1	
			Introduction to Chinese II-1	30	1	
			Introduction to Chinese II-2	30	1	
			Chinese in Practice I-1	15	1	
			Chinese in Practice I-2	15	1	
Chinese in Practice II-1	15	1				
Chinese in Practice II-2	15	1				
Chinese in Practice III-1	15	1				
Chinese in Practice III-2	15	1				
Chinese in Practice IV-1	15	1				

Category	Group		Subject	Total class hours	Credits	Comments		
Common Subjects	Foreign Languages	Second Languages	Chinese in Practice IV-2	15	1			
			Introduction to Korean I-1	30	1			
			Introduction to Korean I-2	30	1			
			Introduction to Korean II-1	30	1			
			Introduction to Korean II-2	30	1			
			Korean in Practice I-1	15	1			
			Korean in Practice I-2	15	1			
			Korean in Practice II-1	15	1			
			Korean in Practice II-2	15	1			
			Korean in Practice III-1	15	1			
			Korean in Practice III-2	15	1			
			Korean in Practice IV-1	15	1			
			Korean in Practice IV-2	15	1			
			Other Languages	Greek I	30		2	
		Greek II		30	2			
		Sanskrit I		30	2			
		Sanskrit II		30	2			
		Latin I		30	2			
		Latin II		30	2			
		Mongolian I		30	2			
		Mongolian II		30	2			
		Italian I		30	2			
		Italian II		30	2			
		Czech I		30	2			
		Czech II		30	2			
		Arabic I		30	2			
		Arabic II		30	2			
		Information Sciences			An Introduction to Information Sciences A		15	1
			An Introduction to Information Sciences A-2	15	1			
			An Introduction to Information Sciences B	30	2			
	Health Sciences			Sports A	30		1	
				Sports B	30		1	
				Health	30		2	
	Subjects for International Students			Japanese A-1	15		0.5	These subjects are for international students.
				Japanese A-2	15		0.5	
				Japanese B-1	15		0.5	
				Japanese B-2	15		0.5	
				Japanese C-1	15		0.5	
				Japanese C-2	15		0.5	
				Japanese D-1	15		0.5	
				Japanese D-2	15		0.5	
				Japanese E-1	15		0.5	
		Japanese E-2	15	0.5				
		Japanese F-1	15	0.5				
		Japanese F-2	15	0.5				
		Japanese G-1	15	0.5				
		Japanese G-2	15	0.5				
		Japanese H-1	15	0.5				
		Japanese H-2	15	0.5				
		Japanese I-1	15	0.5				
		Japanese I-2	15	0.5				
		Japanese J-1	15	0.5				
		Japanese J-2	15	0.5				
		Basic Japanese 1	120	4	These subjects are for the FGL Undergraduate Courses.			
		Basic Japanese 2	90	3				
		Intermediate Japanese	90	3				

# ● Kawauchi Campus Map

## (1) Campus Map

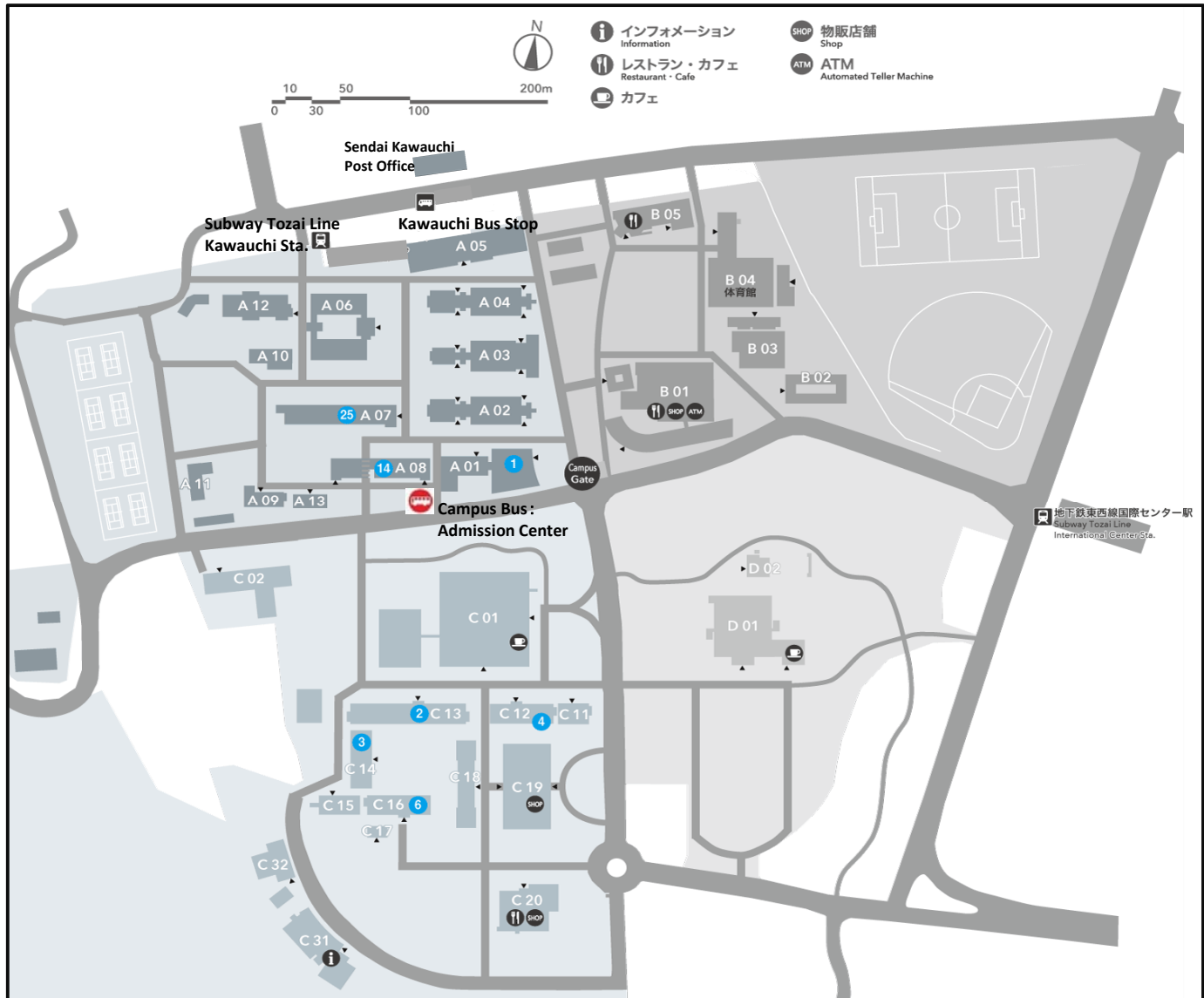

A 01	Education and Student Support Center
A 02	Lecture Rooms A
A 03	Lecture Rooms B
A 04	Lecture Rooms C
A 05	Multimedia Education and Research Complex
A 06	Student Laboratories
A 07	Center for Northeast Asian Studies, Office, Kawakita Research Forum
A 08	Graduate School of International Cultural Studies, Office
A 09	Student Health Care Center
A 10	Disability Services Office
A 12	International Exchange Building
A 13	Counseling Office
B 01	Kawauchi Welfare Facilities
B 02	Kawauchi Circle and Club Building
B 03	Kawauchi Extracurricular Activity Shared Facilities (Kawauchi Hall)
B 04	Kawauchi Gymnasium (Kawauchi Arena)
B 05	Kawauchi Sub Arena
C 01	Tohoku University Library
C 02	Admission Center
C 12	Graduate School / School of Law, Office
C 13	Graduate School / Faculty of Arts and Letters, Office
C 14	Graduate School / Faculty of Education, Office, New Humanities Building
C 16	Graduate School / Faculty of Economics and Management, Office
C 18	Lecture Rooms
C 19	Multidisciplinary Research Building, International Oasis
C 20	Welfare Facilities (Maple Park Kawauchi)
C 31	Botanical Gardens (Garden Hall)
D 01	Centennial Hall (Kawauchi Hagi Hall)

## (2) Classroom

( ) = the seating capacity

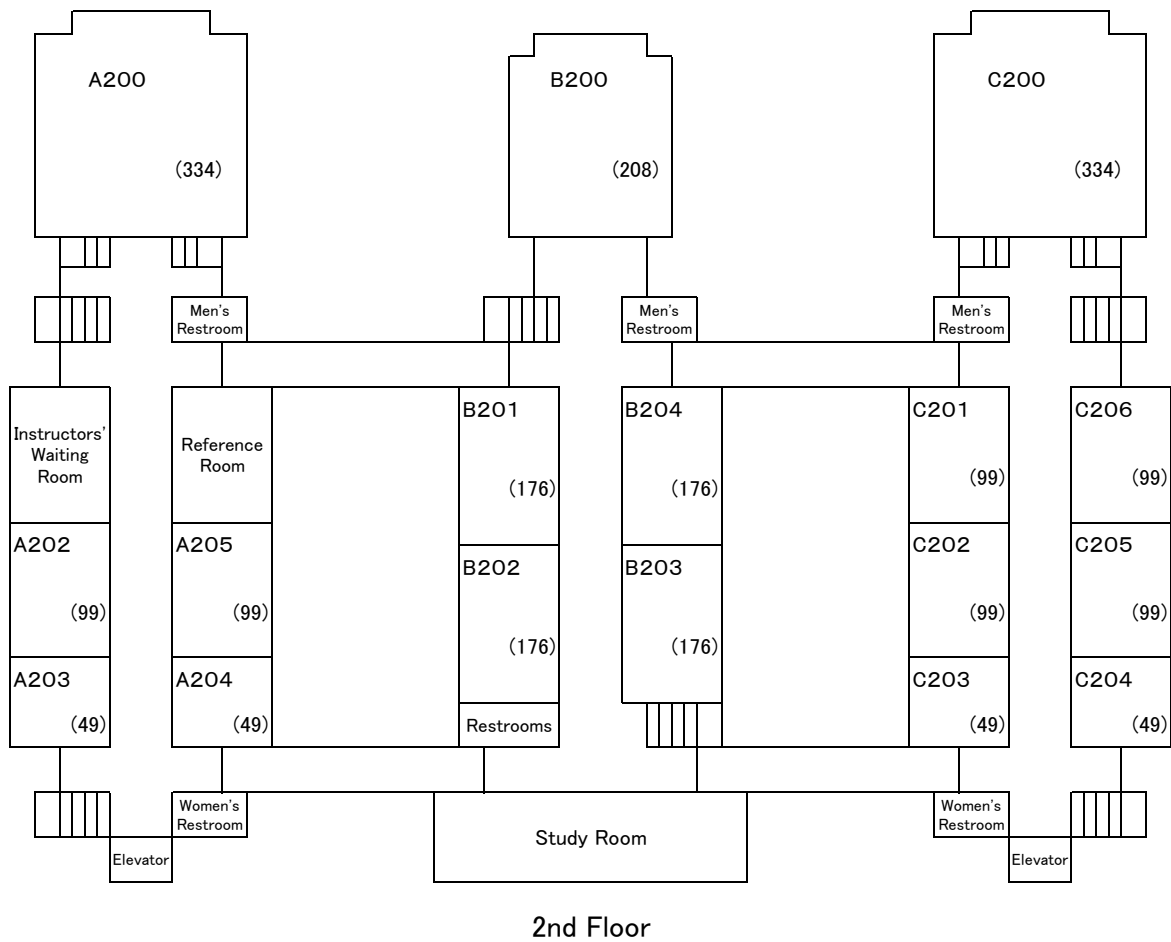
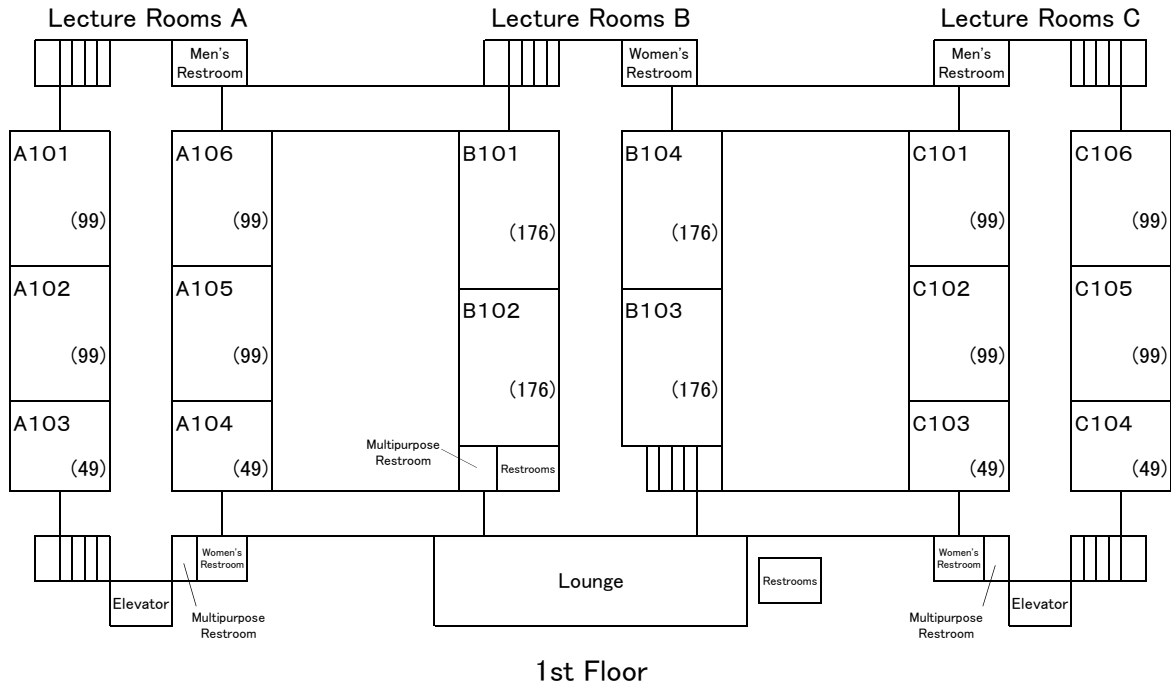



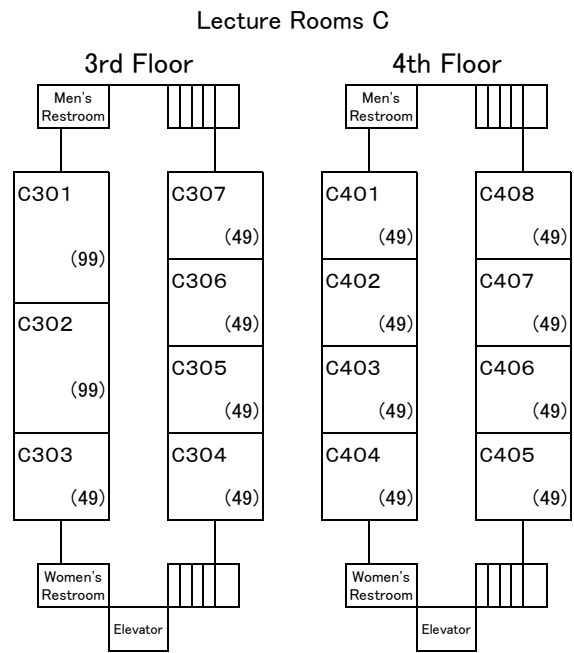
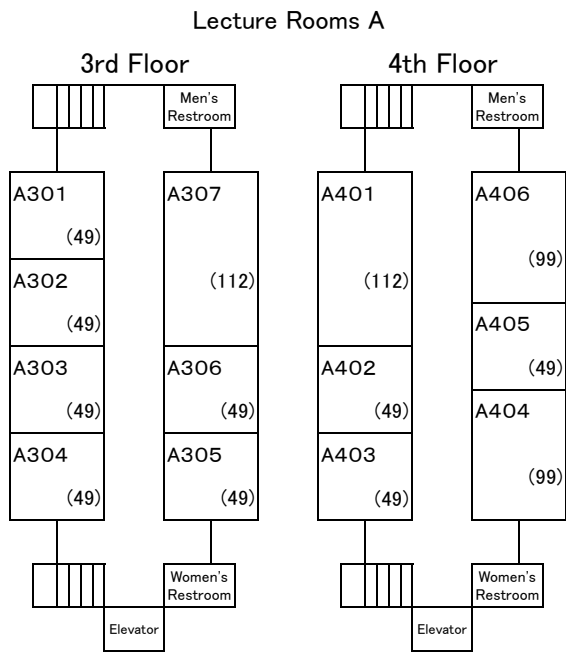

### (3) Student Laboratories

#### 1st Floor

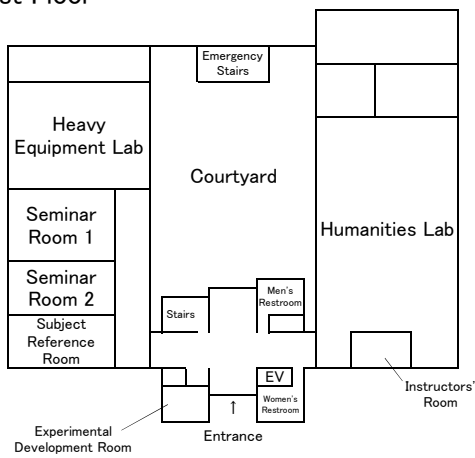

#### 2nd Floor

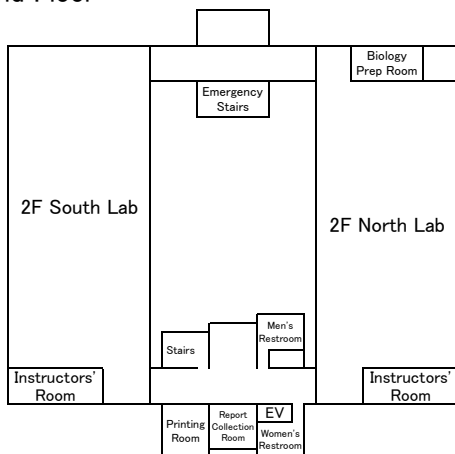

#### 3rd Floor

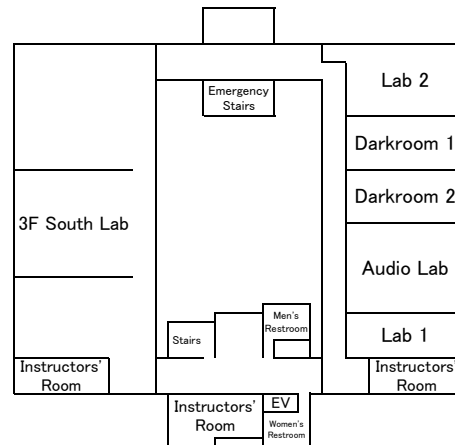

### (4) Multimedia Education and Research Complex

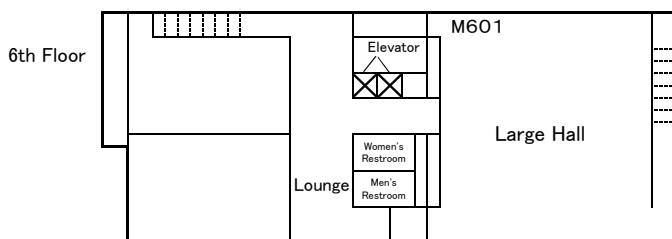
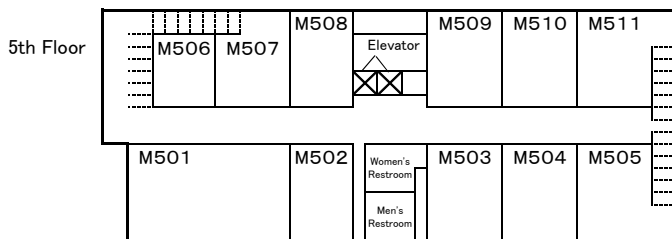
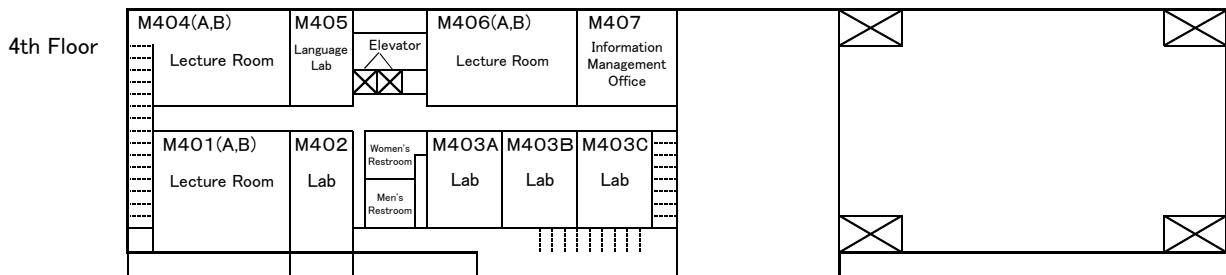
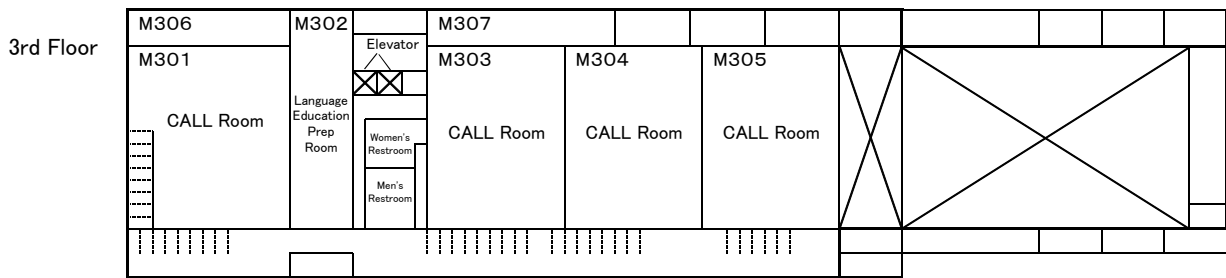
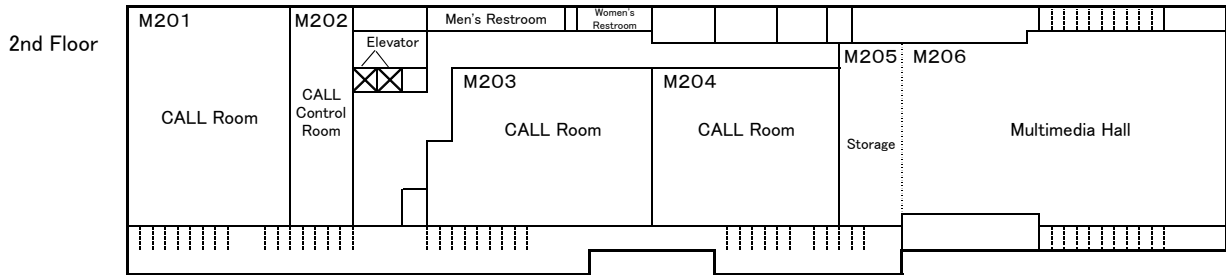
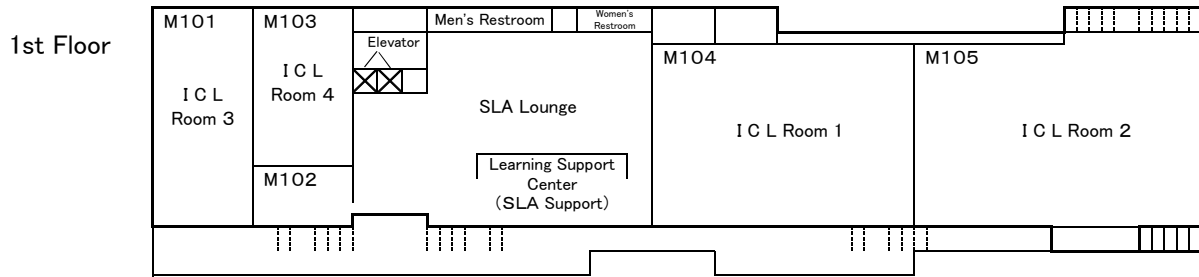

## (5) Gymnasium

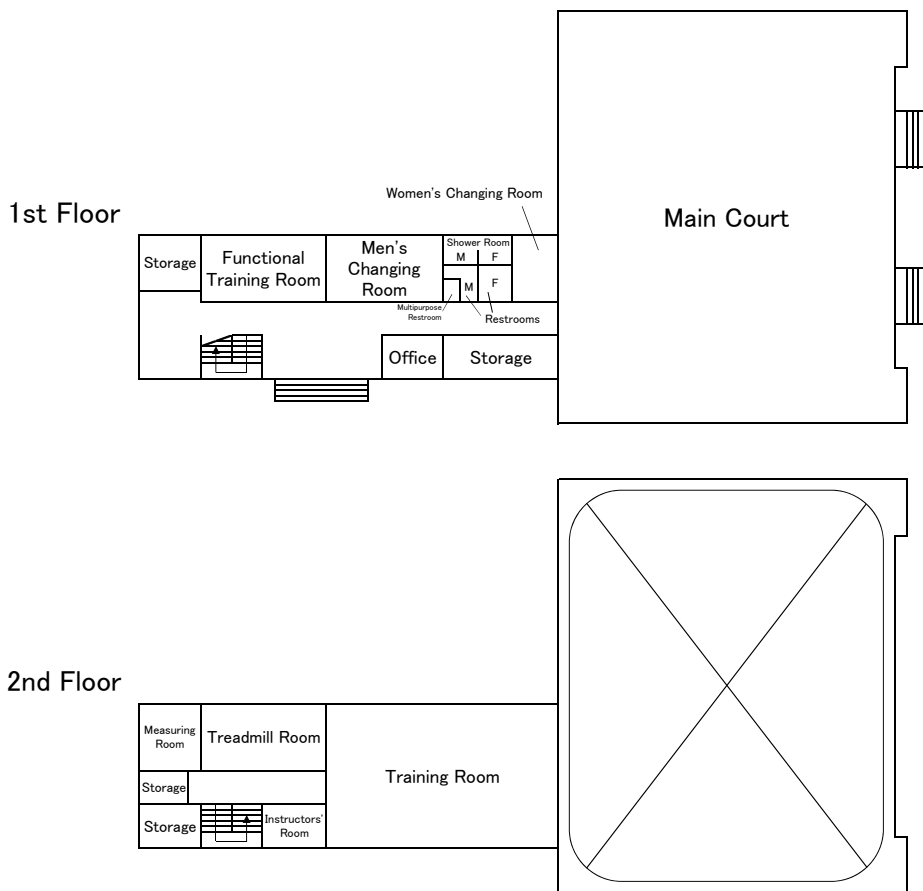

## (6) Sub Arena

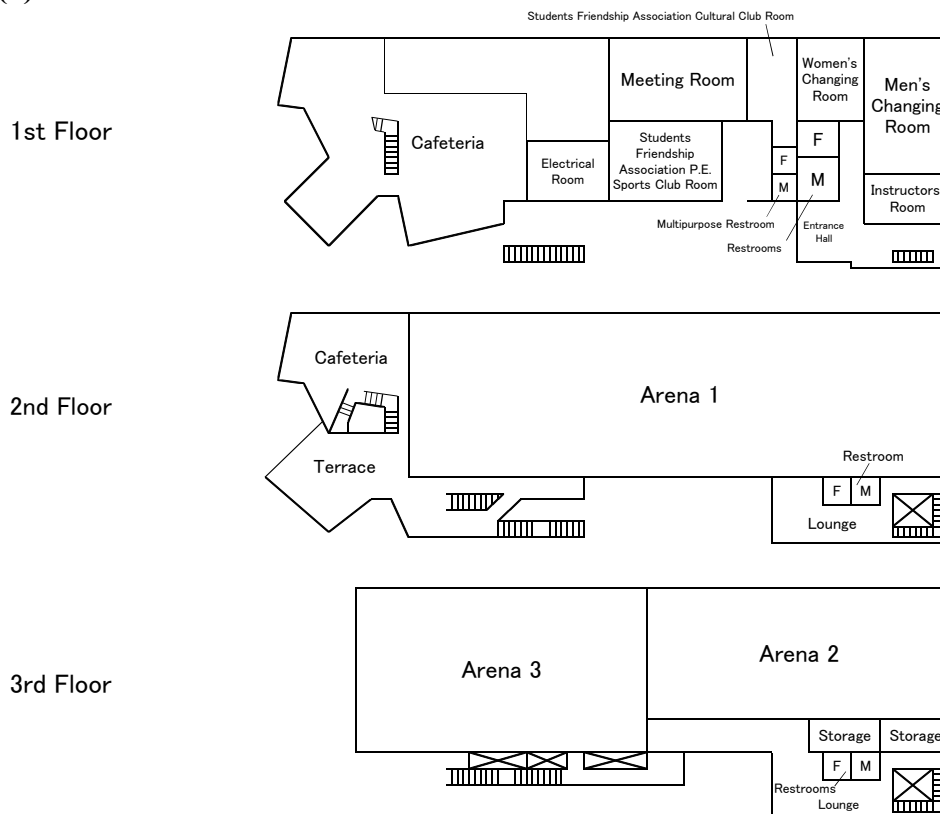

## (7) Education and Student Support Center, Student Services

<b>Student Support Division (1<sup>st</sup> floor)</b>	
1	Support Planning Section -Lost & Found -Change of personal information (address, contact information etc.) -Thefts/crimes/accidents
2	Activity Support Section -Circles/clubs -Equipment loan
3	Life Support Section -University House, dormitories -Enrollment/invoicing for personal accident (Gakkensai) & liability (Gakkenbai) insurance -National Pension Plan
4	Financial Support Section -Waiver or deferment of entrance fee/tuition -Scholarships (for Japanese students) -Student Commuter Certificate
<b>Educational Affairs Division (2<sup>nd</sup> floor)</b>	
5	Educational Records and Programs Section Educational Programs Section General Education Planning Section Liberal Education Operating Section -General Education classes
<b>Student Exchange Division (2<sup>nd</sup> floor)</b>	
6-A	General Affairs Section -Tohoku University International House/University House
6-B	International Education Section -Future Global Leadership Undergraduate Courses -Special curriculum (Japanese language) for international students -Scholarships (Japanese Government Scholarship, Honors Scholarship etc.)
6-C	Incoming Student Exchange Section -Incoming student exchange programs -Double Degree (Joint Education) Program (incoming)
6-D	Global Programs Section -TGL Program -Outgoing overseas programs (Study Abroad Program (SAP)/exchanges/COLABS ) -English language learning -Scholarships for outgoing studies abroad
7	International Support Office -Resident Status, private apartments
<b>Center for Career Support (3<sup>rd</sup> floor)</b>	
8	Careers Advisory Section -Counseling and information on student career paths and job-finding -Internships and part-time employment

3<sup>rd</sup> floor of the West Wing: **Global Learning Center**

## (8) International Exchange Building [A12]

The offices of professors' who teach General Education Subjects are located on the second floor of the International Exchange Building.

